

B.M. 109.12 'D' Top Curb N Side 2nd St. 15' East of Alley
 B.M. 109.31 'D' Top Curb S. Side 3rd St. 15' East of Alley
 R is E Alley

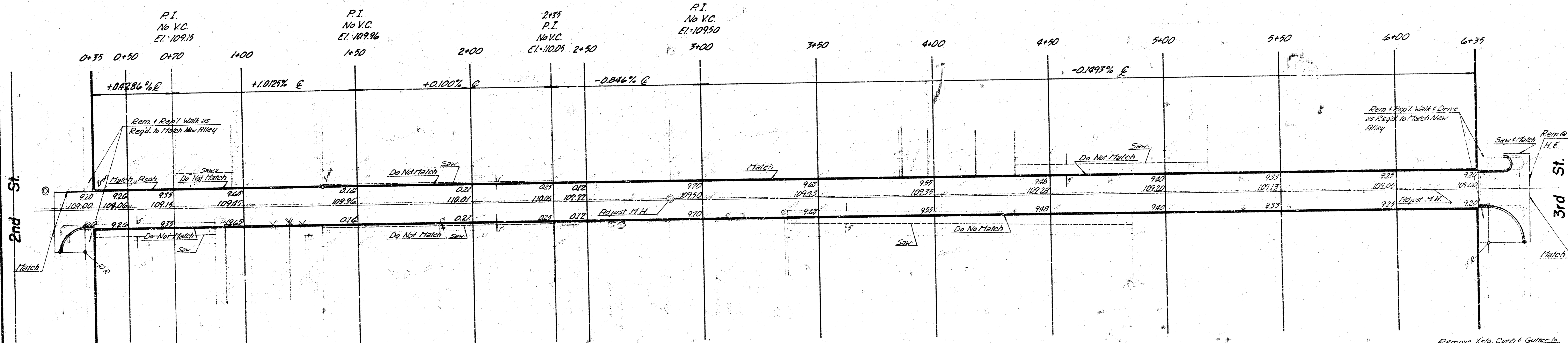

Remove 1/2" Top Curb & Gutter to 1st Vent beyond End of Return

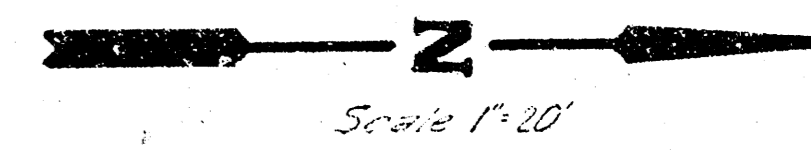
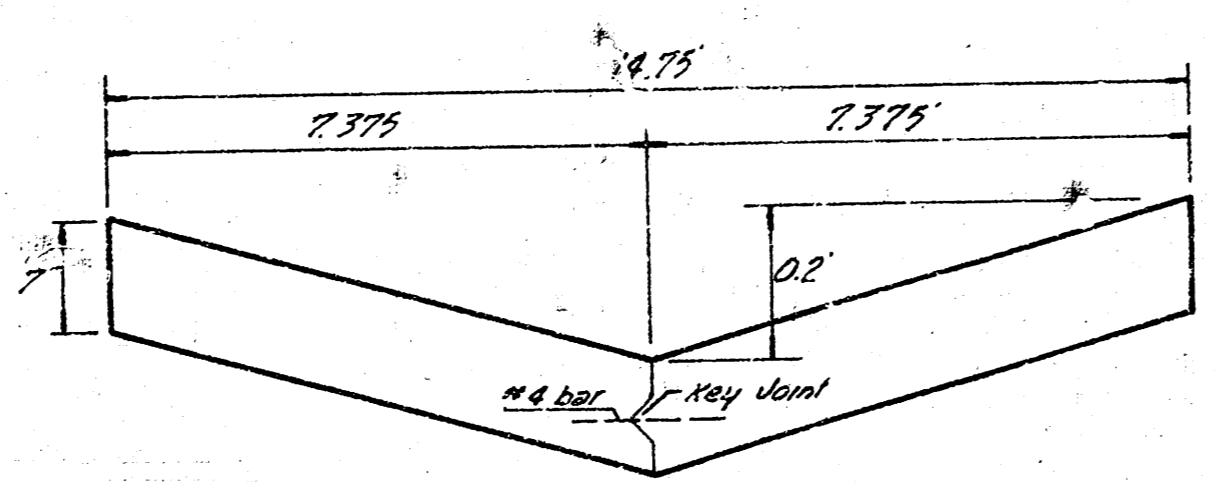

TYPICAL SECTION
No Scale

EARTHWORK

	Property	City
Excav	284.8	4.1
+10%	28.5	0.4
Total	313.3 C.Y.	4.5 C.Y.
Comp. Fill	0.0	0.0
Manp.	983.35 X	873.5 X

GENERAL NOTES

1. Removal Limits Shown are Approx. only. Removal Limits are to be Determined in Field by Field Engineer.
2. Parking Lots Removed behind Property Line are to be Replaced with Like Material. No Removal is to Take Place behind Property Line without Written Approval of Property Owner.
3. Concrete Parking Lots are to be Replaced as S.F.G Concrete Drive. Asphalt Parking Lots are to be Replaced as S.Y. 5' Asphalt Surface Mix.
4. Tree Removal is Marked thus , except that any Tree which in the Opinion of the Field Engineer can be Saved shall be Saved.
5. Alley is not to be Paved until San Sewer has been Reconstructed.
6. Paving Contractor to use Caution when Working Subgrade Due to Extremely Shallow San Sewer.

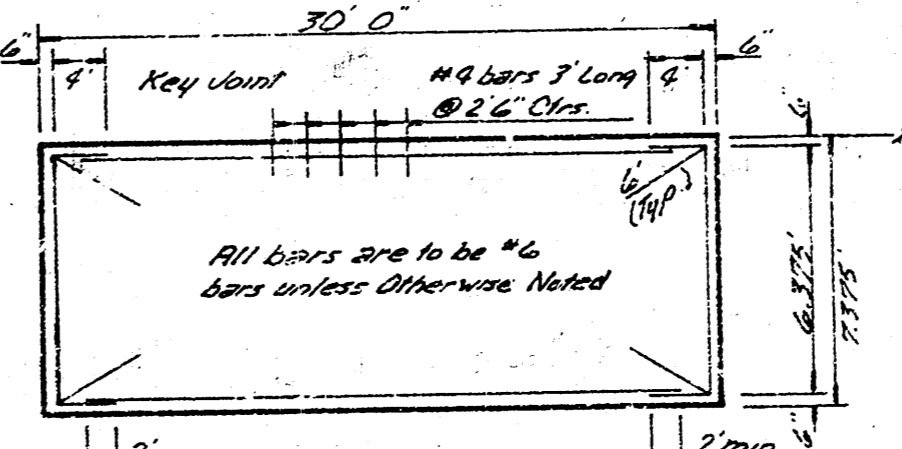

STEEL PATTERN
No Scale

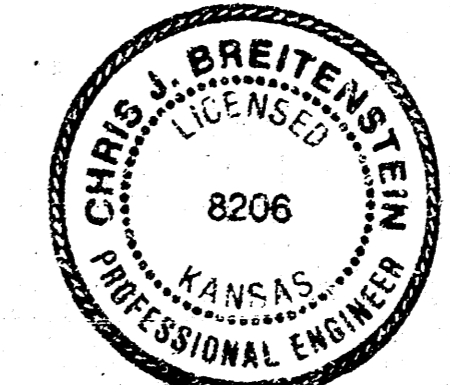

'ALLEY' between Wabash & Ohio
 N.L. 2nd - S.L. 3rd

CITY of WICHITA, KANSAS
 R. W. LINN - City Engineer

DATE _____

472-76-245-80805-000-000-001