

S.M. 12311 "G" in Globe C. 12. E. B. Co. NE Cor. Fairview & 21st

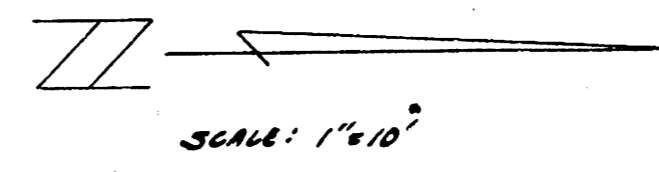

NOTE TO CONTRACTOR
 This project will be constructed under the supervision of the CITY ENGINEER and conforming to the SPECIFICATIONS of the CITY OF WICHITA. THE CONTRACTOR will reimburse the City of Wichita for all cost of Engineering, Plans, and Inspection.

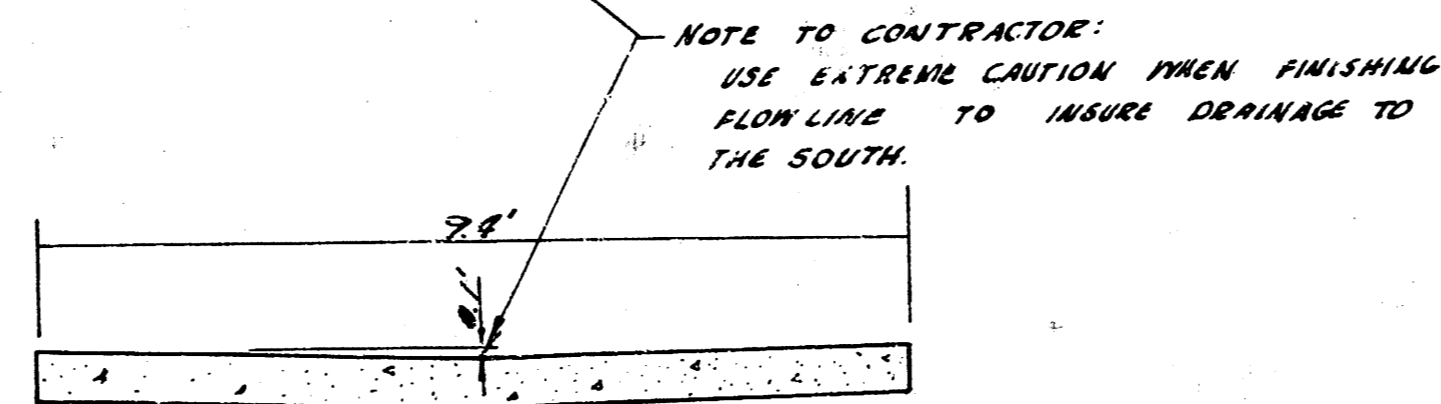
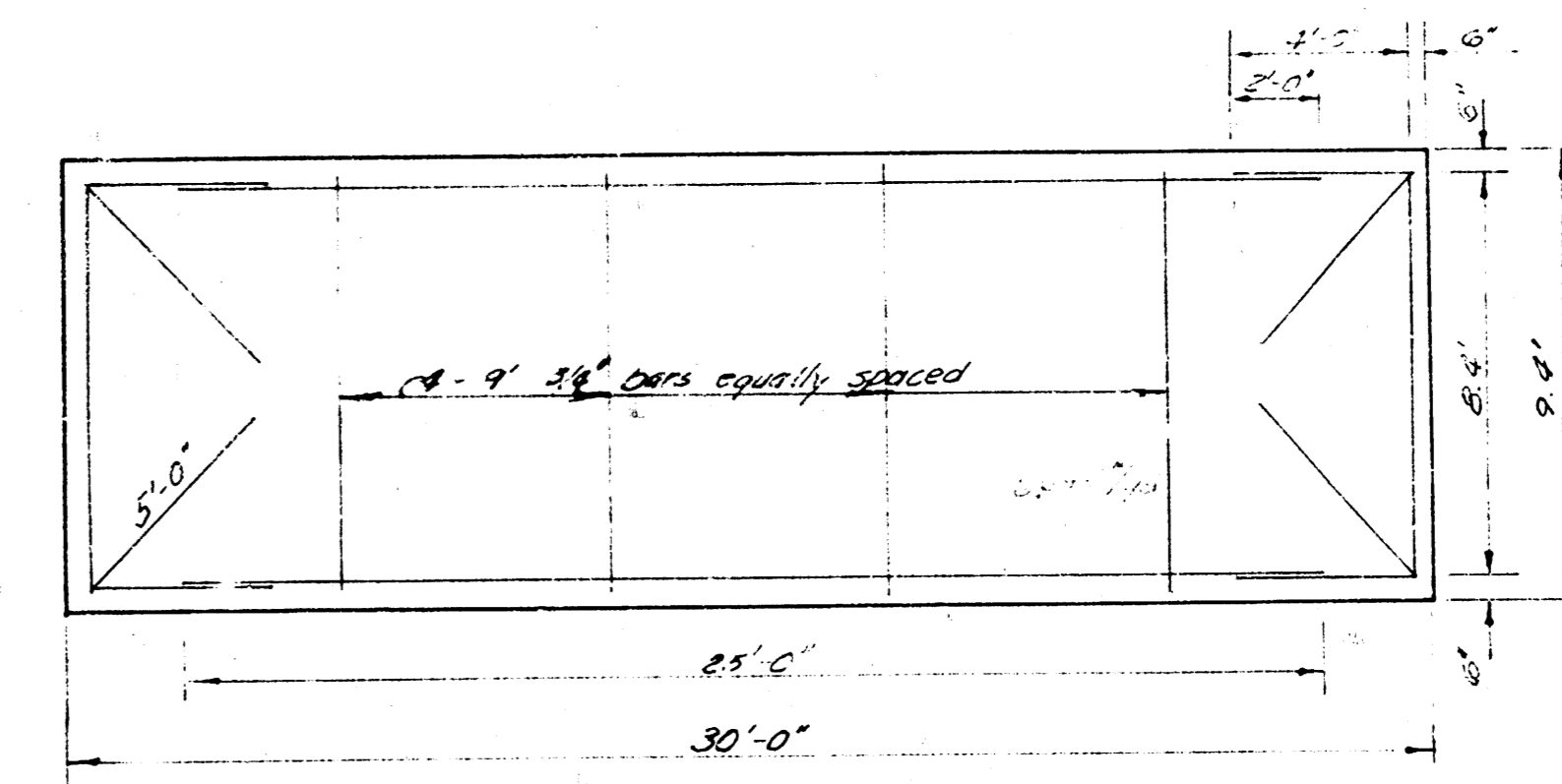
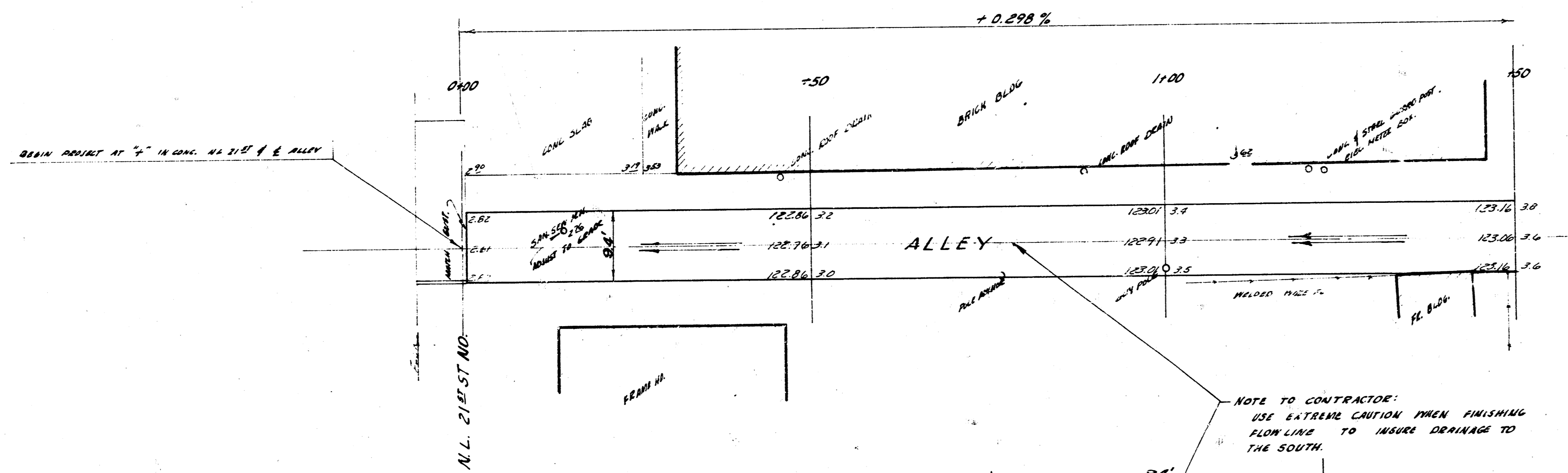

ESTIMATE OF QUANTITIES			
QUANTITY	UNIT	ITEM	FINAL
150	SQ YDS	6" CONC. PAV.	
68	SQ YDS	EXCAVATION	
1400	LOS	REINF STEEL	

9'4" CONC. ALLEY
 N.L. 21st TO 150th N.L. 21st
 WACO - FAIRVIEW
 CITY OF WICHITA KANSAS
 B. E. SMITH CITY ENGINEER
 PRIVATE CONTRACT

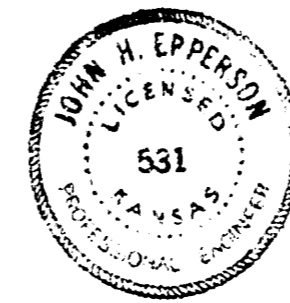

DRAWN BY: J. W. LIPPERTON
 CHECKED BY: B. E. SMITH
 DATE: 12/11/11