

B.M. 115.71 Iron in Thumb C. Edwards & N.L. 2nd
 B.M. 115.38 x on back of W.L. Gordon (Alley N Douglas)
 B.M. 114.56 G in Globe 3 Co Alley (N Douglas) 25 St. Paul
 Stationing on E

Survey No. 46
 Plan No. 135
 City of Wichita
 By order of
 City Engineer

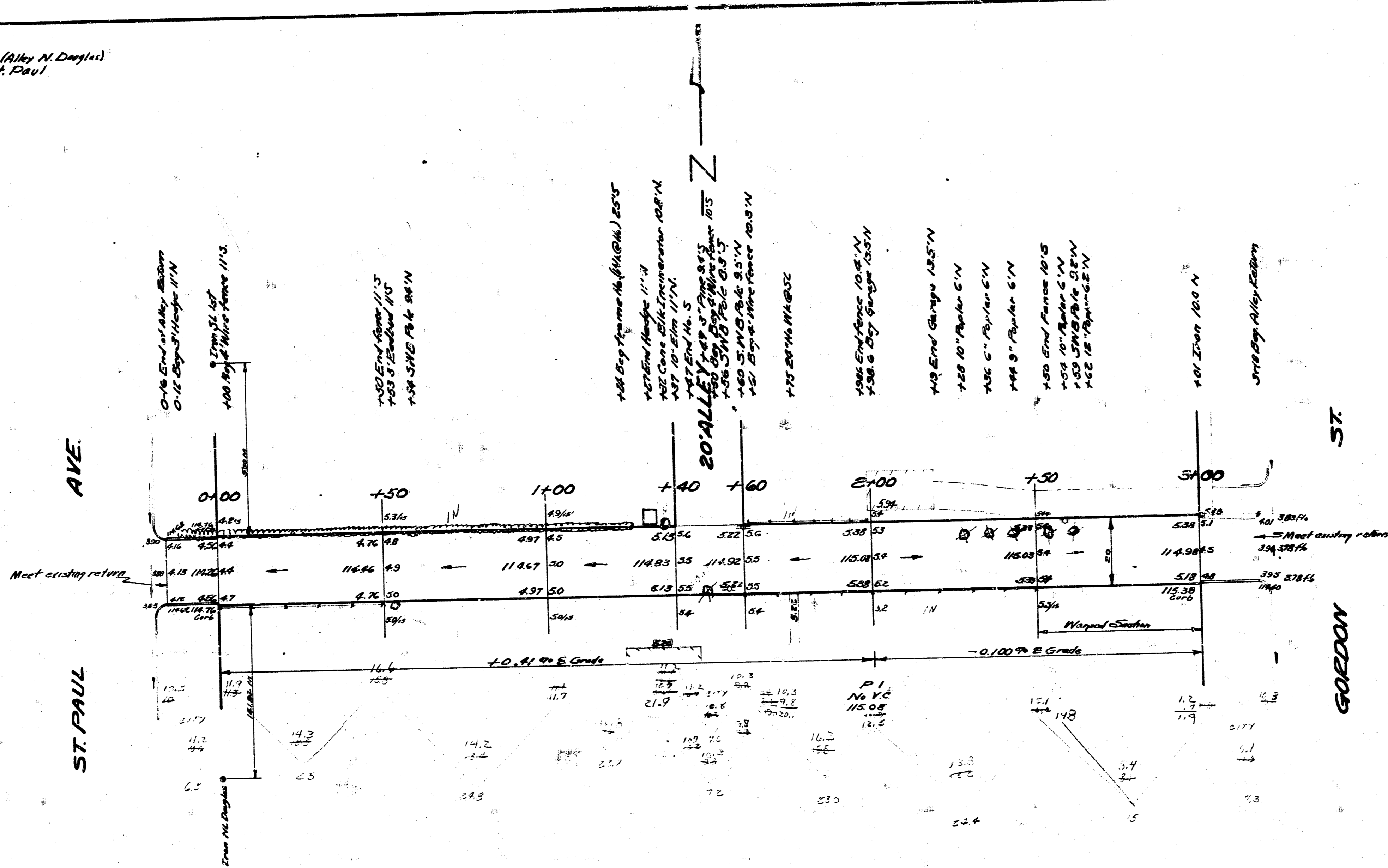

ALLEY N DOUGLAS
 W. L. GORDON TO E. L. ST. PAUL
 6" CONCRETE 20' WIDE
 CITY OF WICHITA
 BE SMITH CITY ENGINEER
 SEPT 1953 FROM No. C13-142

