

B.M. 2.1 SW cor. conc. step. Ho# 2446 So Minneapolis.

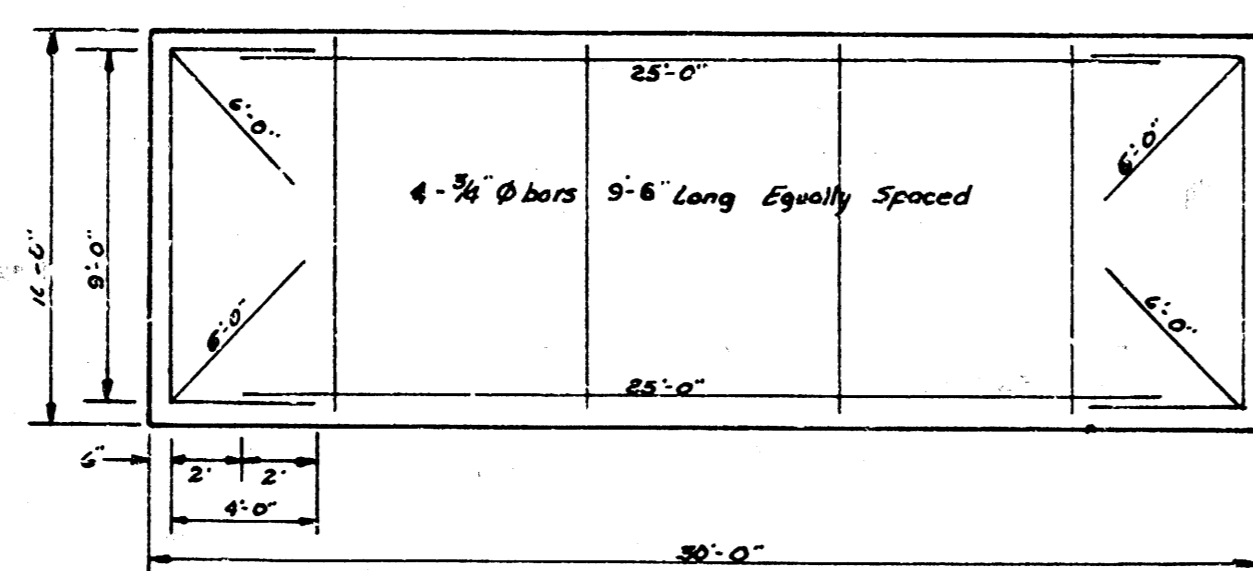

TYPICAL STEEL PATTERN
NO SCALE

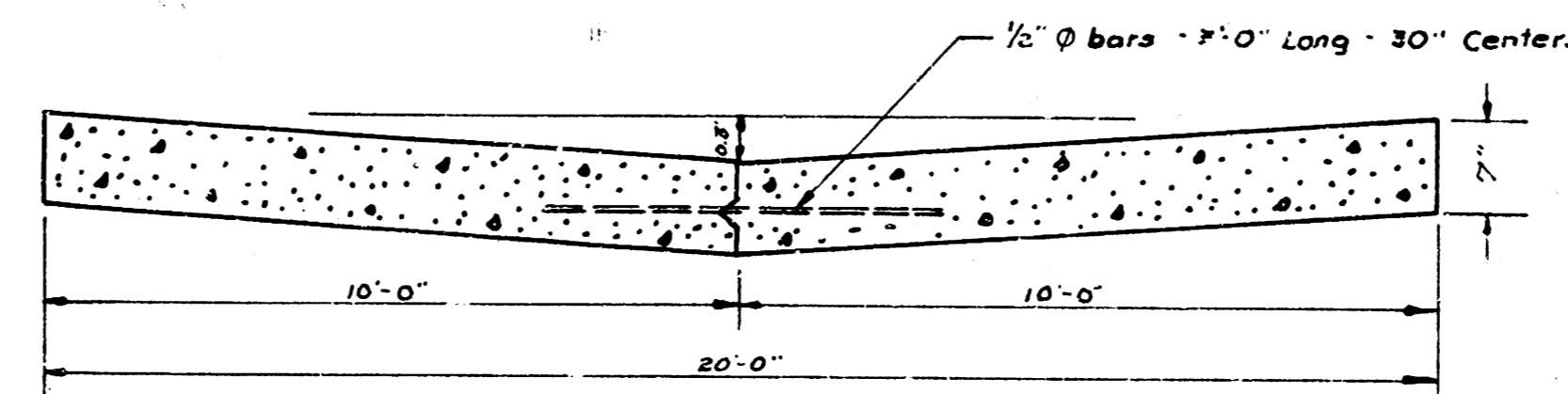

TYPICAL SECTION
NO SCALE

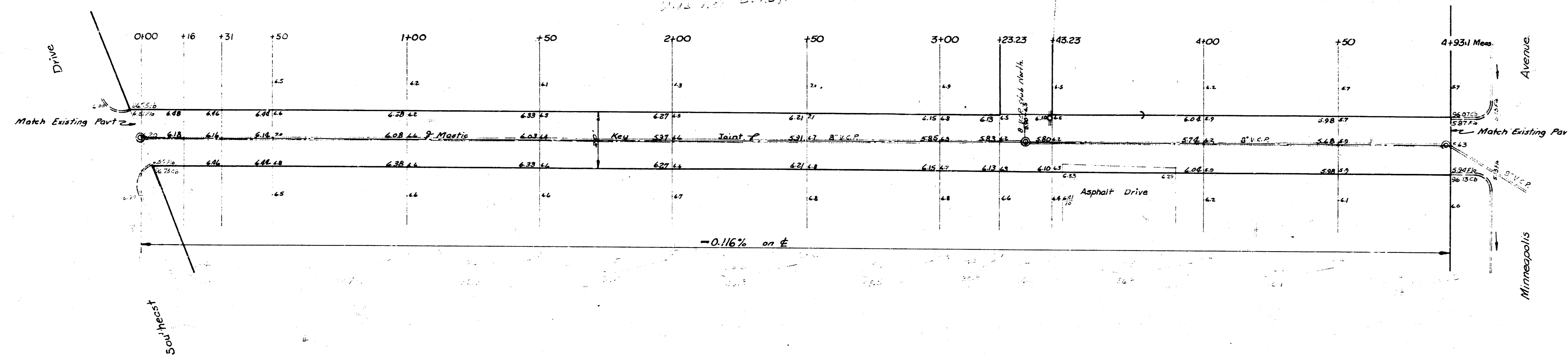

LIST OF QUANTITIES	
1095.8	Sq yds 7" Concrete Pavement
359.0	Cu yds Excavation
7605.0	lbs Reinforcing Steel
493.1	Linff Mastic Joint

FIRST ALLEY SOUTH OF PAWNEE

EL Southeast Dr to WL Minneapolis

20'-7" Conc.

CITY OF WICHITA, KANSAS

B. E. SMITH CITY ENGINEER

Oct. 1957 PRIVATE JOB

