

3. M. 93.99 W. rim MH c. of this alley & c. of Walnut St.
 3. M. 96.458 "4" on SE cor. conc. Lamp post base NW Seneca & 31st. St. So.
 3. M. 96.42 SE cor. Conc. Base Lamp post WL Seneca NE cor. Seneca Sq.
 Base Line and Stationing on South P.E.

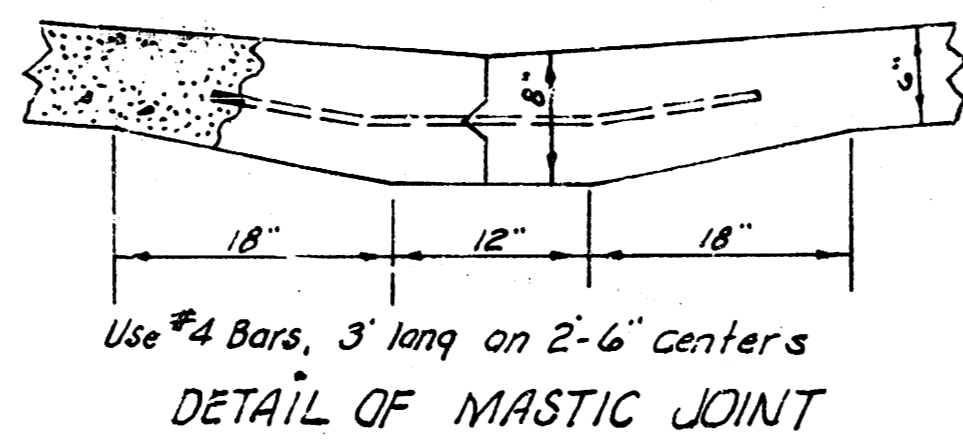

EARTH WORK		EXCAV.	
EXCAVATION	PROP.	CITY	2010
217.8	217	20	
239.0	239.0	20	20
		20	20



NOTE:
 Construct asphalt
 hook - 4"
 Extend existing 24" P.C.P.
 20' to the south.

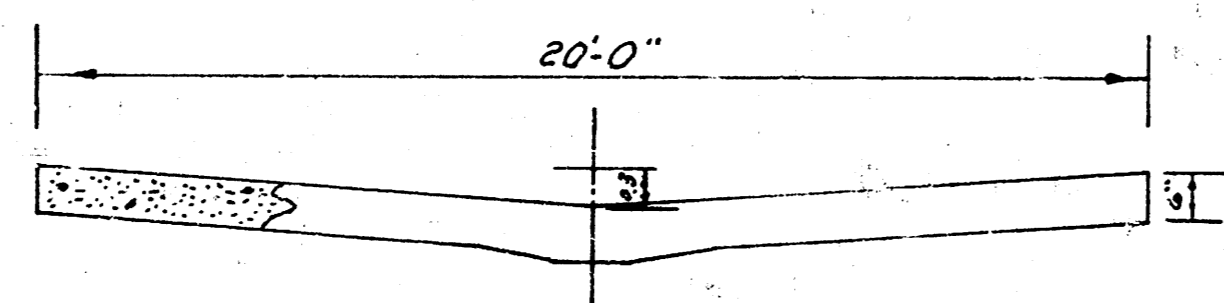
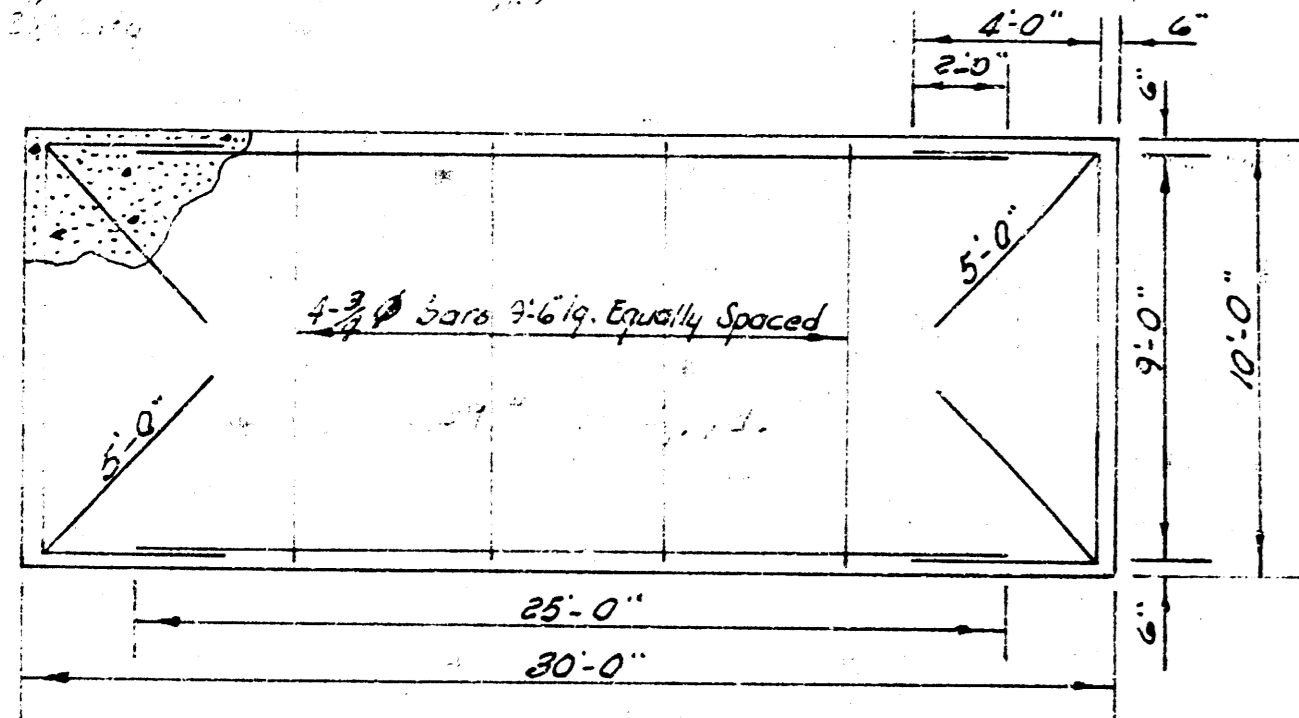
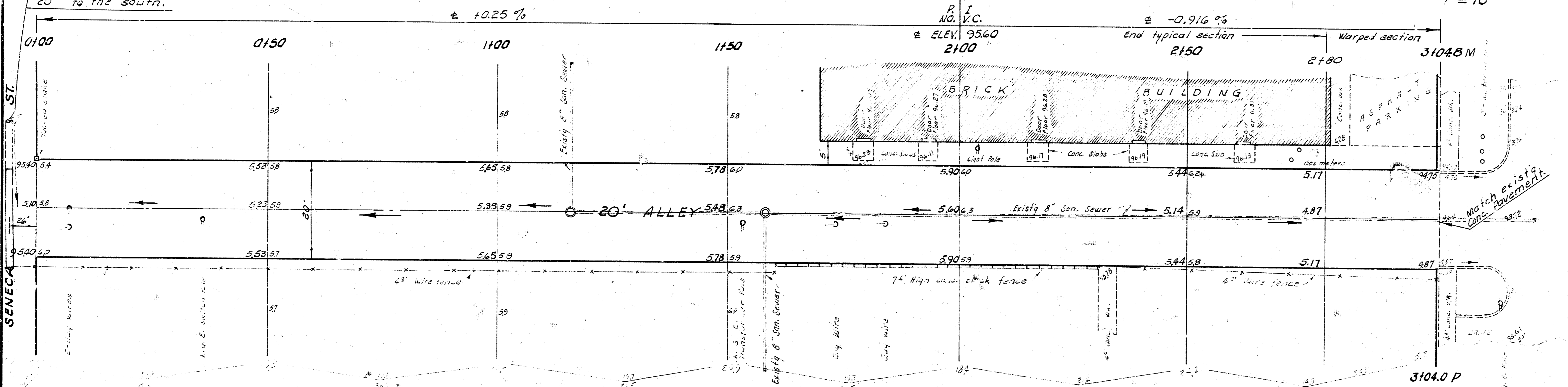

TYPICAL SECTION
 (Exception at warped sections)
 1/4" scale

ALLEY
 South of 31st. St. So.
 EL SENECA TO WL WALNUT
20' CONC. - 6"
 CITY OF WICHITA, KANSAS
 B. E. SMITH CITY ENGINEER
 PROJ. NO. C19-227

