

B.M. 105.06 "□" Top of Cb. So. Ret. S.E. Cor. Orient & Meridian

B.M. 105.52 "□" Top E-Cb. of Sedgwick at N.L. Esthner

B.L. is S.L. of Alley, being 40' So. of N.L. Esthner.

SCALE: 1"=20'

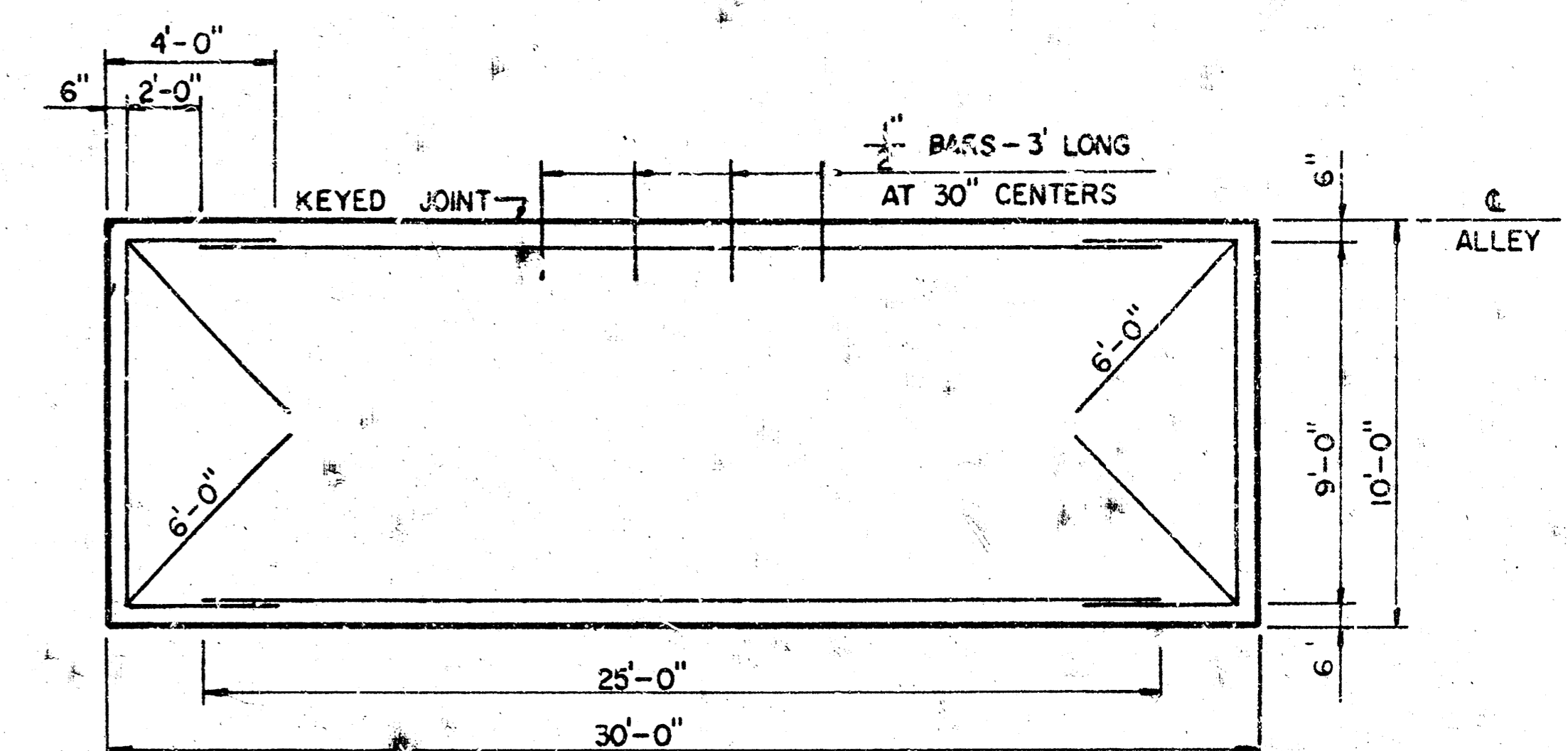
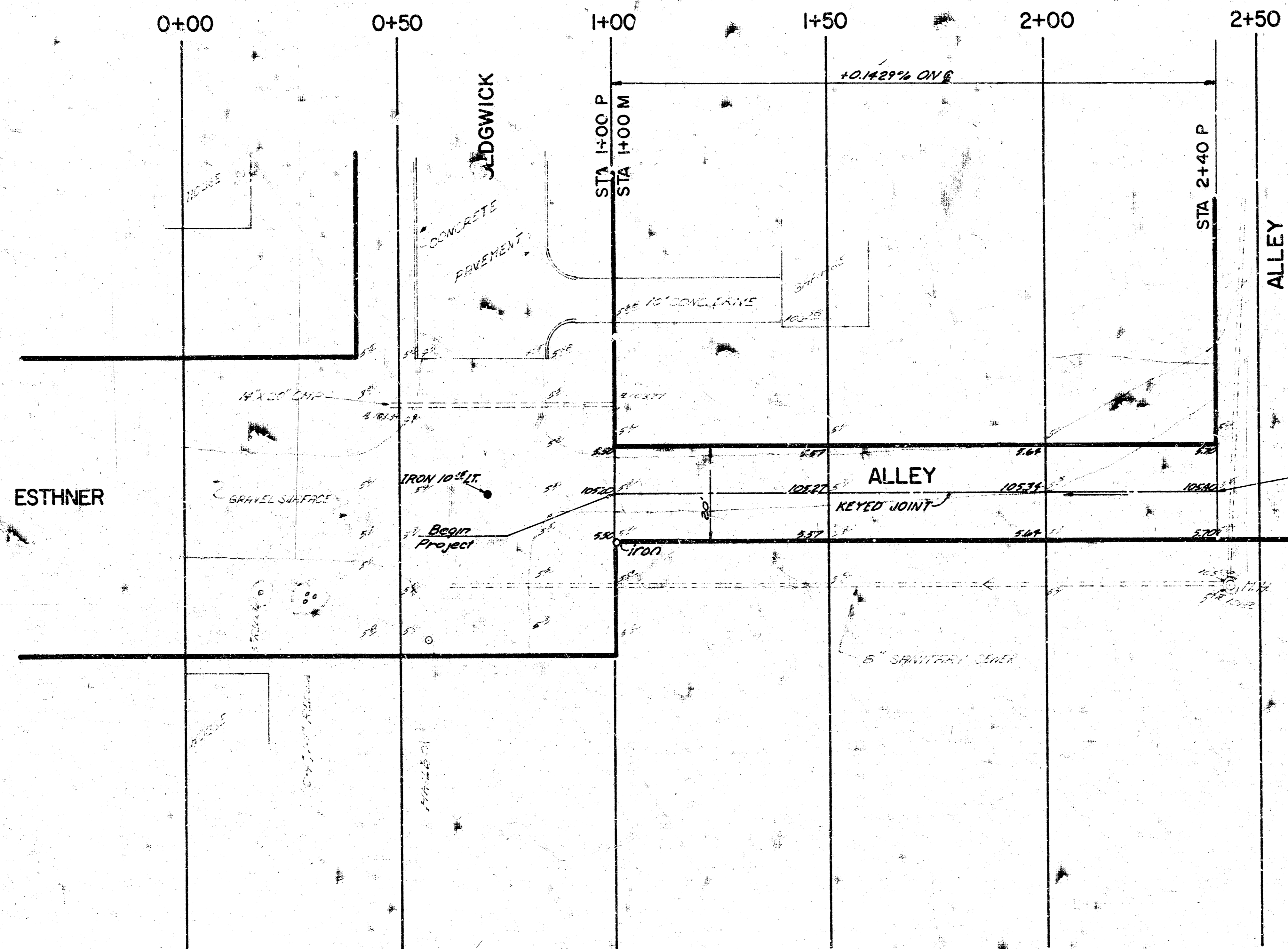
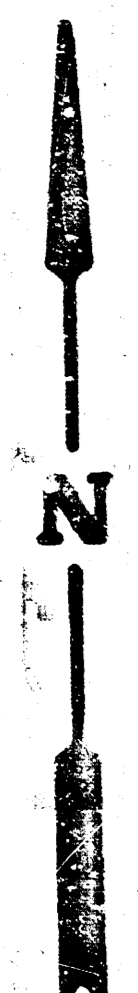

STEEL PATTERN
 ALL REINFORCING STEEL TO BE #6 BARS EXCEPT DOWEL BARS.

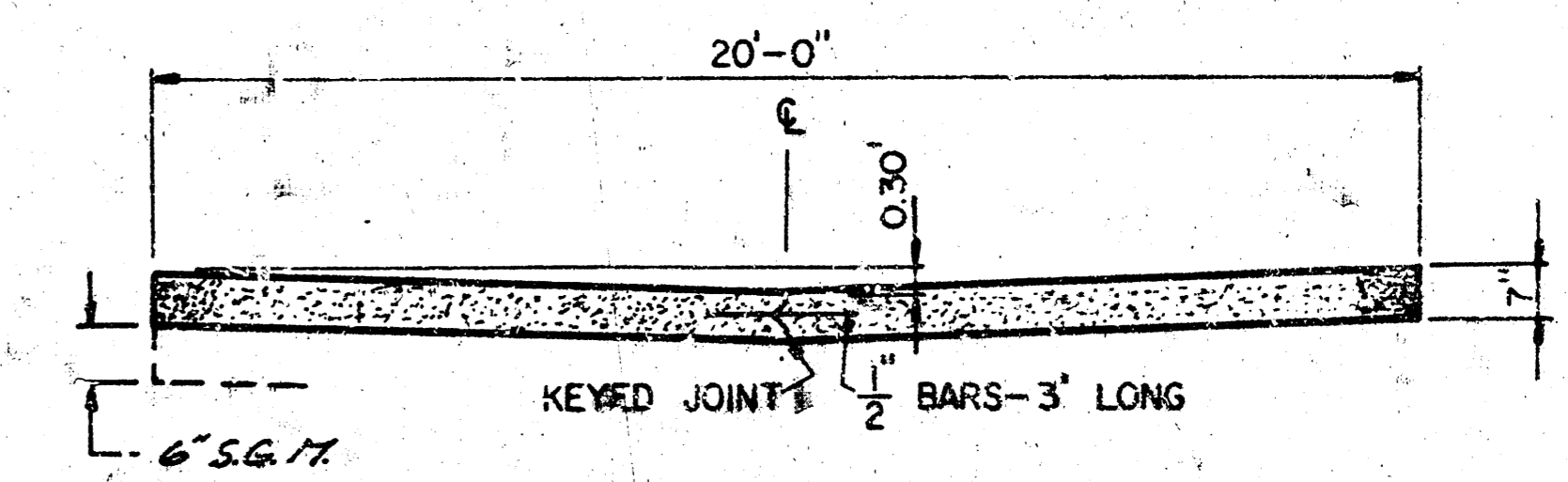

TYPICAL SECTION

EARTHWORK		MANIPULATION	
PROPERTY		CALC.	S.Y.
EXCAVATION	43.4 C.Y.		
+10%	43		
TOTAL	47.7 C.Y.	311	

SUB-GRADE
 TYPE OF SUB-GRADE TREATMENT SHALL BE DETERMINED BY THE FIELD ENGINEER. SUB-GRADE TREATMENT MAY CONSIST OF LIME TREATMENT, CEMENT TREATMENT, SUB-GRADE MODIFICATION, OR ANY COMBINATION OF THESE.

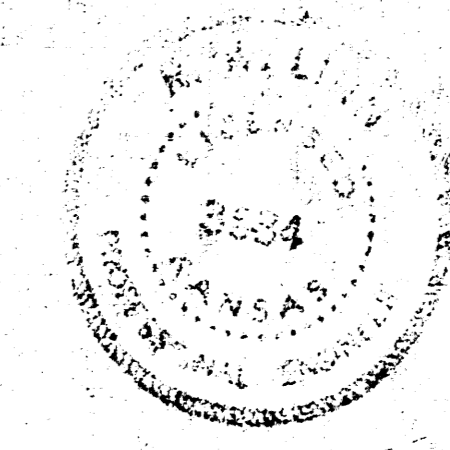

'ALLEY'
 EAST of ESTHNER
 E.L. SEDGWICK-W.L. ALLEY E. of SEDGWICK
CITY OF WICHITA, KANSAS
 R.W. LINN - CITY ENGINEER
 DATE: June 1976
 PROJ. NO. DAKA574110