

CURVE DATA
Sta. 0+00 to Sta. 2+45.95
Stationing on South B

STATION	Arc length South B R = 828.79'	Chord length of offset from face of S. C. to R = 828.79'	Chord length of offset from face of N. curb R = 775.79'	DEFLECTION	TOTAL DEFLECTIONS
0+00					
0+50	50.00'	49.57'	46.80'	1° 43' 41"	1° 43' 41"
1+00	50.00'	49.57'	46.79'	1° 43' 42"	3° 27' 21"
1+50	50.00'	49.57'	46.80'	1° 43' 41"	5° 11' 02"
2+00	50.00'	49.57'	46.79'	1° 43' 41"	6° 54' 43"
2+45.95	45.95'	45.54'	42.99'	1° 35' 17"	8° 30' 00"

2.03359 min. per running ft. along south property line.

Base Line and stationing on south property line.
B. M. 100.30 SE cor. conc. step No. # 2701 Martinson Ave.

EXCAVATION
PROPERTY
+10% 1680.6
168.7
1855.3 cu. yds.

Survey of Martinson St. L. & S.
 Plan of W.
 D. J. W. 4-5-60
 Checked

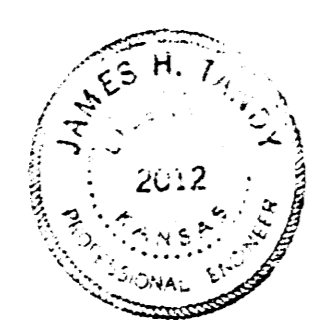

CRAWFORD ST.
 W. MARTINSON TO W. SENECA
 26 - 2 - 30 A. C.
 CITY OF WICHITA, KANSAS
 B. E. SMITH CITY ENGINEER
 APRIL 1960, PROJ. NO. C16-126

B.M. 99.08 "G" in Globe So. curb Dallas & W. Seneca St.

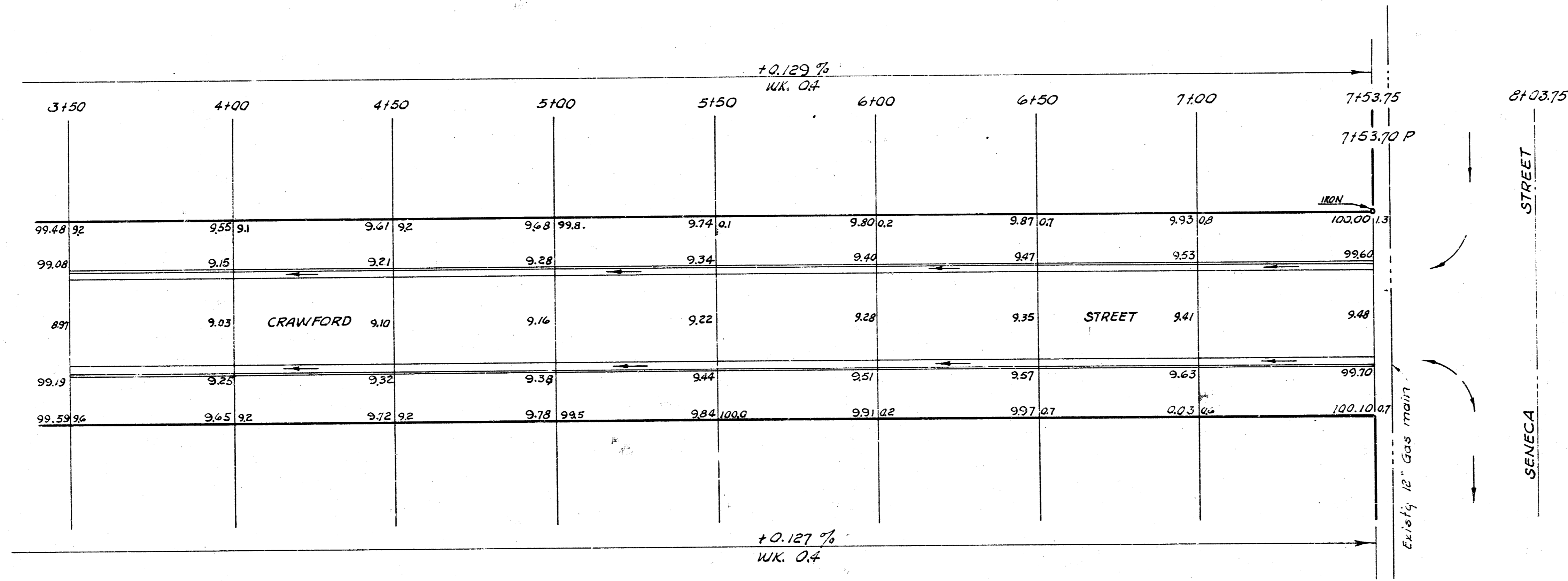

CRAWFORD ST.
MARTINSON TO SENECA

(2/3)

PROJ. NO. C16-126