

Supervisors
 Bill A.R. 53
 Ex. Henry
 Chetnic

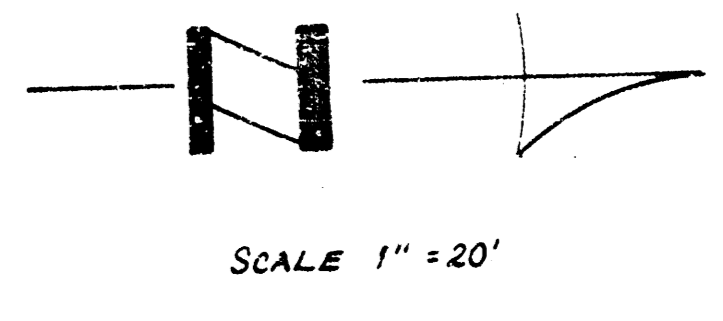
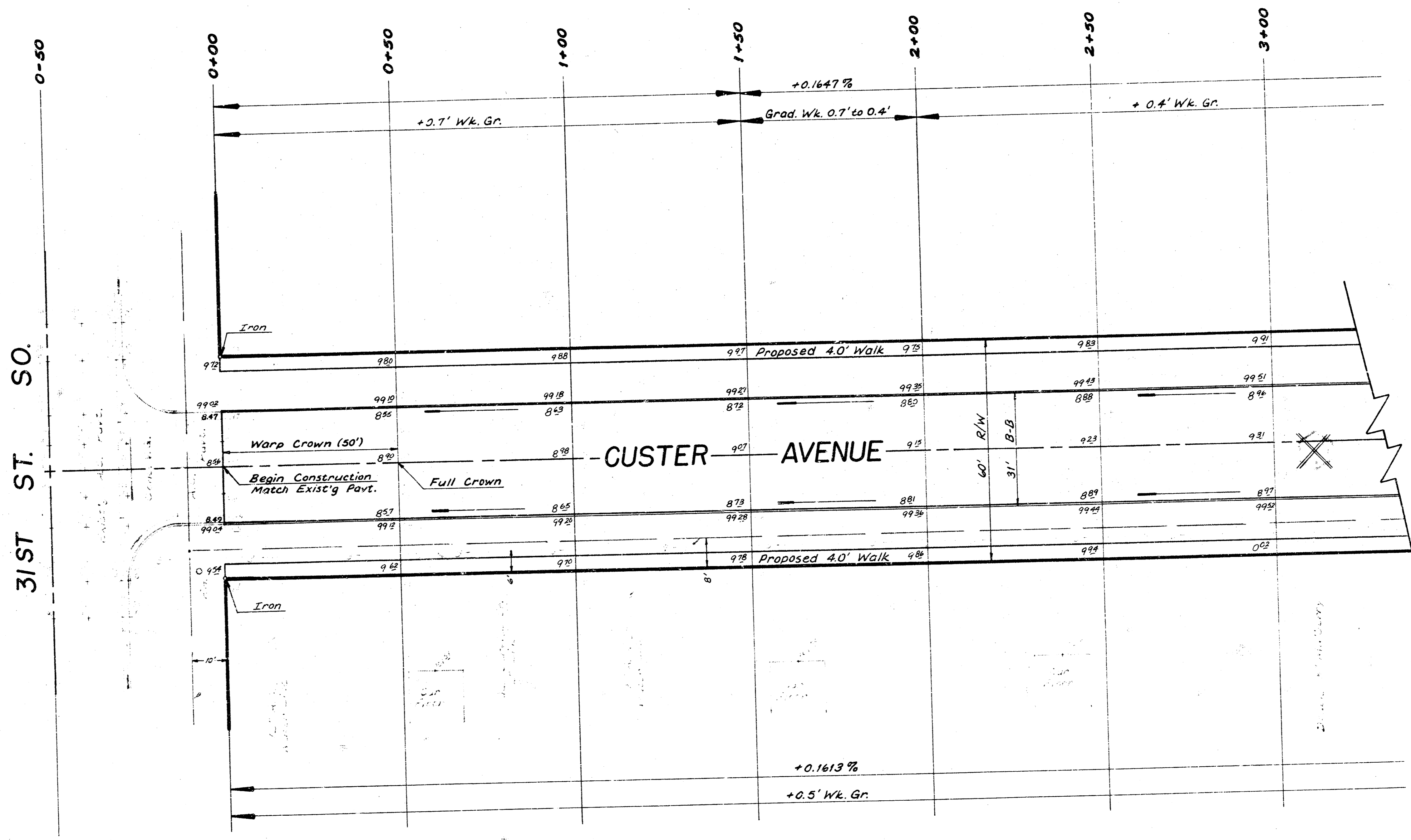

B.M. = 103.52 City Std. Disc. E. End Handrail to R.C.B.C. @ Sheridan & 31st St. So.
 2 is @ Custer

= Tree Removal

NOTE TO FIELD ENGINEER & CONTRACTOR
 Grade paving and clear right-of-way for proposed sidewalks. Compact fill in sidewalk area. TO BE CONSTRUCTED BY "OTHERS".

SUB-GRADE
 TYPE OF SUB-GRADE TREATMENT SHALL BE DETERMINED BY THE FIELD ENGINEER. SUB-GRADE TREATMENT MAY CONSIST OF LIME TREATMENT, CEMENT TREATMENT, SUB-GRADE MODIFICATION, OR ANY COMBINATION OF THESE.

EARTHWORK:

	Prop.	Chg.
Excavation =	1435.4 C.Y.	40.7 C.Y.
+10% =	163.5 C.Y.	4.1 C.Y.
Total =	1598.9 C.Y.	44.8 C.Y.
Compacted Fill =	35.0 C.Y.	---
+10% =	3.8 C.Y.	---
Total =	38.8 C.Y.	---

NOTE: EXCAVATION FROM PROJECT 575033 TO BE USED AS BORROW ON PROJECT 575033 AND PROJECT 575042.
MANIPULATION = 2558 S.Y.

CUSTER AVE.
 N.L. 31st ST. SO. to N.L. 30th ST. SO.
 (6" Conc. Pavt. 30' & Cb.)
CITY of WICHITA, KANSAS
 R.W. Linn City Engineer
 Proj. No. DAKS575033
 Date _____

2/13

