

CYPRESS

N. L. MT. VERNON TO S. L. SKINNER

CITY OF WICHITA, KANSAS

R. W. BRUGGEMAN - DIRECTOR OF ENGINEERING/CITY ENGINEER

DATE: PROJ. No. 472 76 245 81084 000 000 001

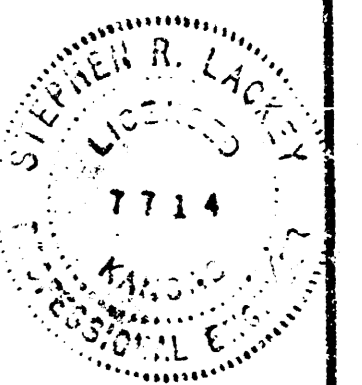
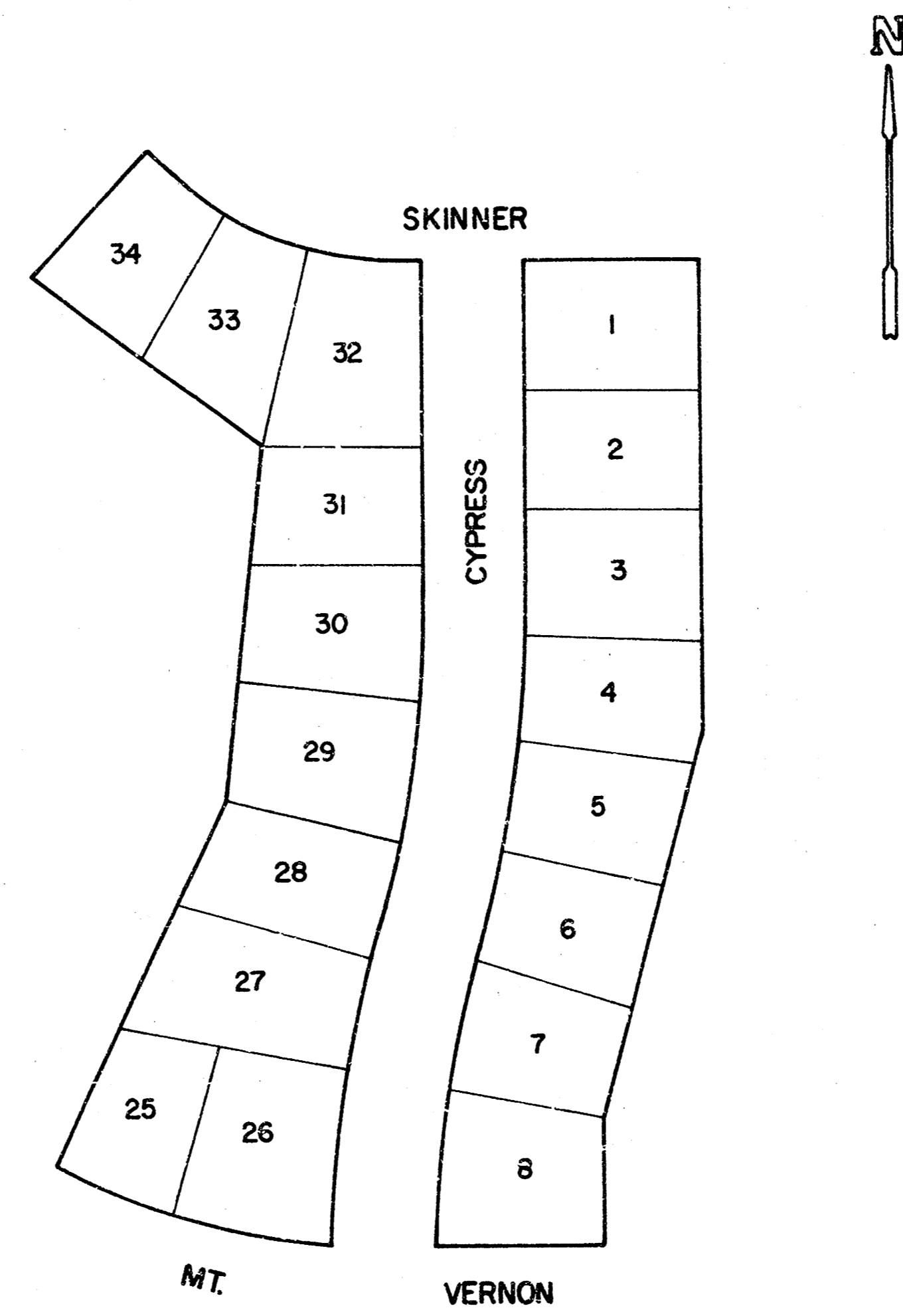

Manipulation = 2,970 S.Y.

CYPRESS

N. L. MT. VERNON TO S. L. SKINNER

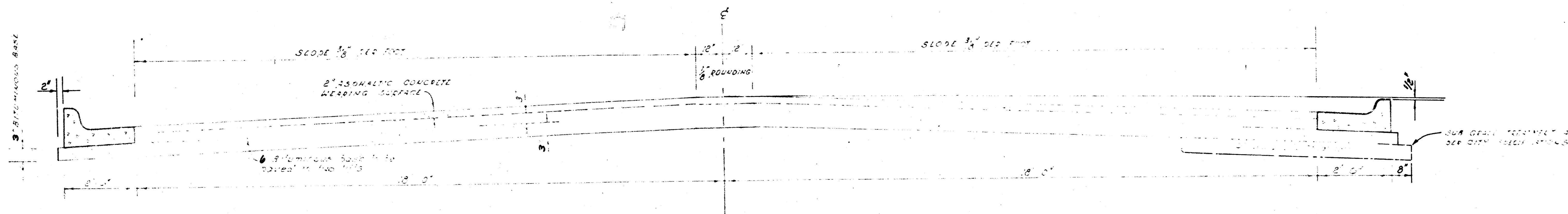

TYPICAL SECTION

The pavement between the curb & gutter shall be paved as shown in detail. The Bituminous Base shall be placed as shown in detail. The Bituminous Base shall be placed as shown in detail.

4' ASPHALTIC CONCRETE PAVEMENT WITH BITUMINOUS BASE

A TACK COAT OF EMULSIFIED ASPHALT (SE-1H) SHALL BE APPLIED AT AN APPROXIMATE RATE 0.05 GALLONS PER SQ YD BETWEEN LIFTS OF ASPHALTIC MATERIALS WHEN ORDERED BY THE ENGINEER. TACK COAT WILL NOT BE PAID FOR DIRECTLY AND SHALL BE CONSIDERED AS SUBSIDIARY TO PRICE BID FOR ASPHALTIC PAVEMENT.

BITUMINOUS BASE AND ASPHALTIC CONCRETE WEARING SURFACE SHALL BE PLACED WITH A LAYDOWN MACHINE HAVING AUTOMATIC CONTROLS FOR CROWN AND GRADE. CONSTRUCTION JOINTS IN EACH LIFT SHALL BE STAGGERED A MINIMUM DISTANCE OF 1' WITH JOINTS IN PRECEDING LIFTS AND SUCH THAT A JOINT WILL BE CONSTRUCTED ON THE PAVEMENT CENTERLINE IN THE TOP LIFT.

COMBINED CURB & GUTTER

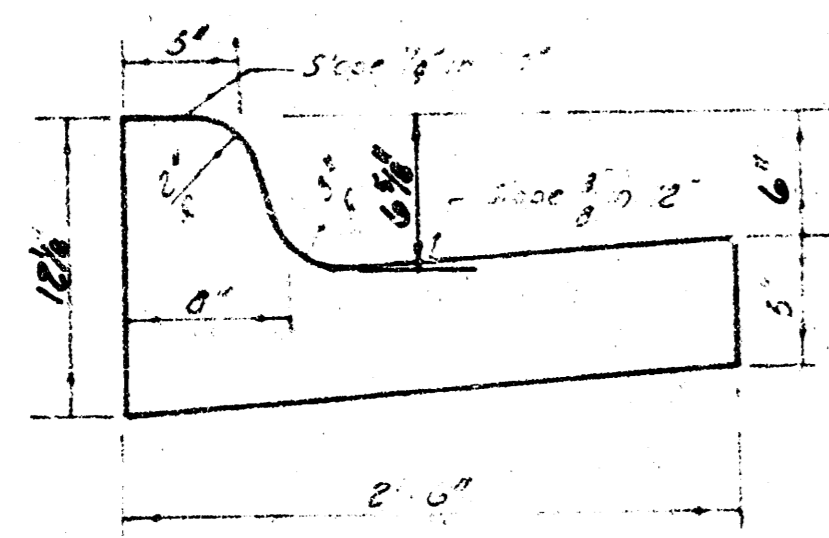

ROLL TYPE CURB & GUTTER

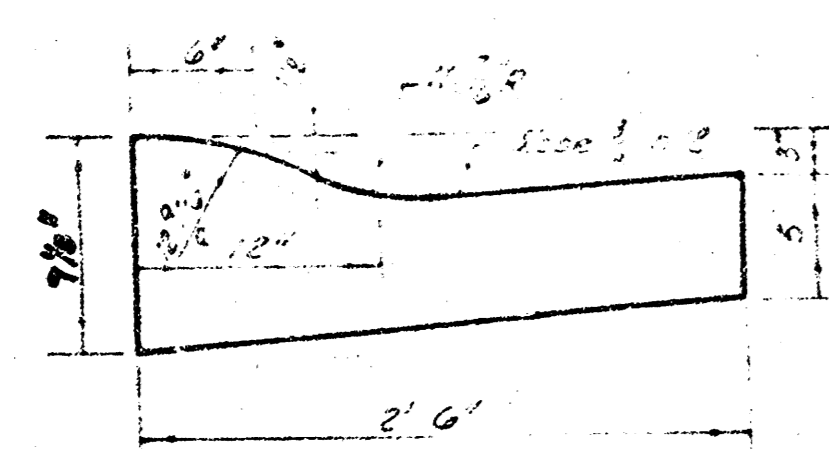

DETAIL OF TRANSVERSE CONSTRUCTION JOINTS

TRANSVERSE CONSTRUCTION JOINTS SHALL BE CONSTRUCTED IN FLEXIBLE BASE PAVEMENTS AT LOCATIONS WHERE PAVEMENT TEMPORARILY ENDS TO FACILITATE FUTURE PAVEMENT CONSTRUCTION AS SHOWN BY DETAIL. THE COST OF CONSTRUCTING THE TRANSVERSE CONSTRUCTION JOINTS SHALL NOT BE MEASURED OR PAID FOR DIRECTLY BUT SHALL BE INCLUDED IN THE BID PRICE FOR SQUARE YARDS OF ASPHALTIC CONCRETE PAVEMENT.

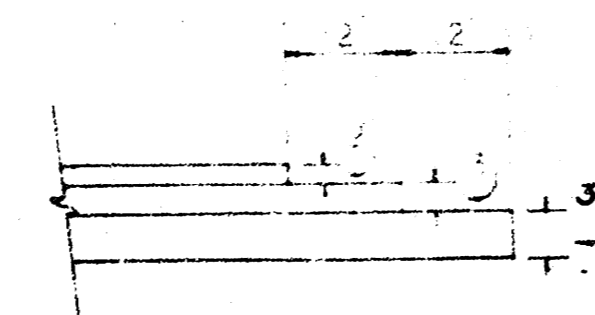

CITY OF WICHITA, KANSAS

DEPARTMENT OF ENGINEERING

R. W. BRUGGEMAN

DIRECTOR OF ENGINEERING/CITY ENGINEER

DATE _____ PROJ. NO. 472762-15 81084000 000 000

(2)

BM = 169.52 - R.R. Spk. SW E. HLP NE Cor. Mt. Vernon & Cypress.
 BM = 169.60 - R.R. Spk. E E. Life Pile NW Cor. Cypress & Skinner.

Δ = 16°40'17" R. = 784.87' T. = 115.00' L. = 228.37' LC. = 227.57'

CURVE DATA BASED ON E RAD. Δ = 8°20'08"

STA	ARC	δ W	δ E	CHORD	TOTAL
1+94.82 PC	---	---	---	0°-00'-00"	0°-00'-00"
2+25	30.05'	28.18'	31.12'	1°-05'-49"	1°-05'-49"
2+50	25'	24.11'	25.81'	0°-58'-45"	2°-00'-34"
2+75	"	"	"	"	2°-55'-19"
3+00	"	"	"	"	3°-50'-04"
3+25	"	"	"	"	4°-44'-47"
3+50	"	"	"	"	5°-39'-34"
3+75	"	"	"	"	6°-34'-21"
4+00	25'	24.11'	25.81'	0°-58'-45"	7°-29'-06"
4+23.32 PT	23.32'	22.49'	24.15'	0°-51'-04"	8°-20'-08"

Defl./ft. = 2.19001 Min.

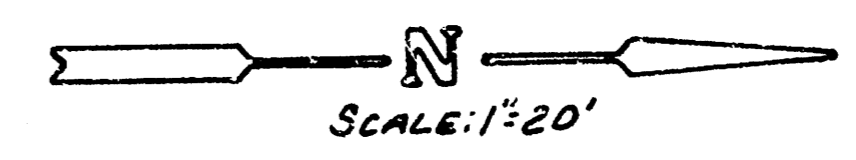

SUB-GRADE
 TYPE OF SUB-GRADE TREATMENT SHALL BE DETERMINED BY THE FIELD ENGINEER. SUB-GRADE TREATMENT MAY CONSIST OF LIME TREATMENT, SUB-GRADE MODIFICATION, OR ANY COMBINATION OF THESE.

THE CONTRACTOR SHALL BE RESPONSIBLE FOR INTERFERING WITH THE CENTER LINE OF THE ROAD AND FOR THE PROTECTION OF THE SAME. THE CONTRACTOR SHALL BE RESPONSIBLE FOR THE PROTECTION OF ALL UTILITIES AND STRUCTURES UNDER THE ROAD AND FOR THE PROTECTION OF THE SAME. THE CONTRACTOR SHALL BE RESPONSIBLE FOR THE PROTECTION OF ALL UTILITIES AND STRUCTURES UNDER THE ROAD AND FOR THE PROTECTION OF THE SAME.

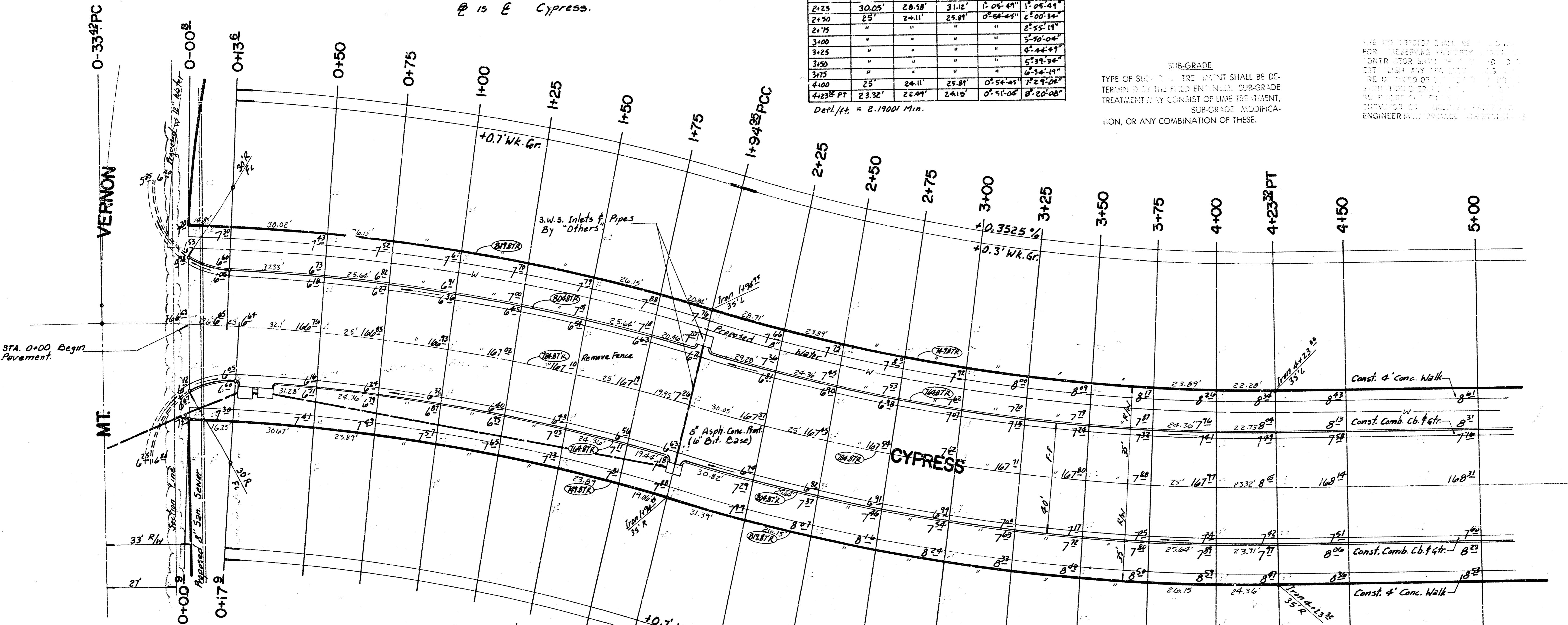

Δ = 16°40'17" R. = 784.87' T. = 115.00' L. = 228.37' LC. = 227.57'

CURVE DATA BASED ON E RAD. Δ = 8°20'08"

STA	ARC	δ W	δ E	CHORD	TOTAL
0-33.42 PC	---	---	---	0°-00'-00"	0°-00'-00"
0+13.5	47.0'	48.07'	---	1°-42'-36"	1°-42'-36"
0+50 Bk	30.4'	37.70'	---	1°-19'-45"	3°-02'-42"
0-33.42 PC	---	---	---	0°-00'-00"	0°-00'-00"
0+17.2	51.3'	---	49.46'	1°-52'-21"	1°-52'-22"
0+50 Bk	32.1'	---	30.75'	1°-10'-20"	3°-02'-42"
0+50 Ah	---	---	---	0°-00'-00"	3°-02'-42"
1+00	25'	25.81'	24.11'	0°-58'-45"	3°-57'-19"
1+25	"	"	"	"	4°-52'-02"
1+50	"	"	"	"	5°-46'-49"
1+75	25'	25.81'	24.11'	0°-58'-45"	6°-41'-34"
1+94.82 PC	19.75'	20.66'	19.26'	0°-43'-41"	8°-20'-08"

Defl./ft. = 2.19001 Min.

EARTHWORK

X-SECTION	EXCAVATION	COMP. FILL (10%)
10%	2,288.7 C.Y.	17.1 C.Y.
TOTAL	2,528.7 C.Y.	21.0 C.Y.

Contractor to coordinate work with Storm Sewer Contractor. Note: Const. not more than 15-20' Drives.

Note: Lime application rate = 25#/S.Y.
 Preheater Fines application rate = 35#/S.Y.

CYPRESS

472 76 245 81084 000 000 001

SURVEY: BANBAK
 DATE: 11/24/04
 CHECKED:

