

CURVE DATA BASED ON N.P.L. R=285.08 Δ=15°40'

STATION	CHORD OFFSET N.C.	CHORD OFFSET S.C.	DEF. L.	TOTAL DEF.
0+00	P.C.			
0+25	25.78	29.46	2° 30' 44"	2° 30' 44"
0+50	25.78	29.46	2° 30' 44"	5° 1' 28"
0+77.95	28.82	32.94	2° 48' 31"	7° 50'

BM 91.22 4' IN P.K.S. 70° E OF 100' S. CR. CATALINA
 BM 90.27 4' IN P.K.S. S. CR. CATALINA & S.W. COR. PATTIE.
 STATIONING & BASE LINE NORTH PROP. LINE

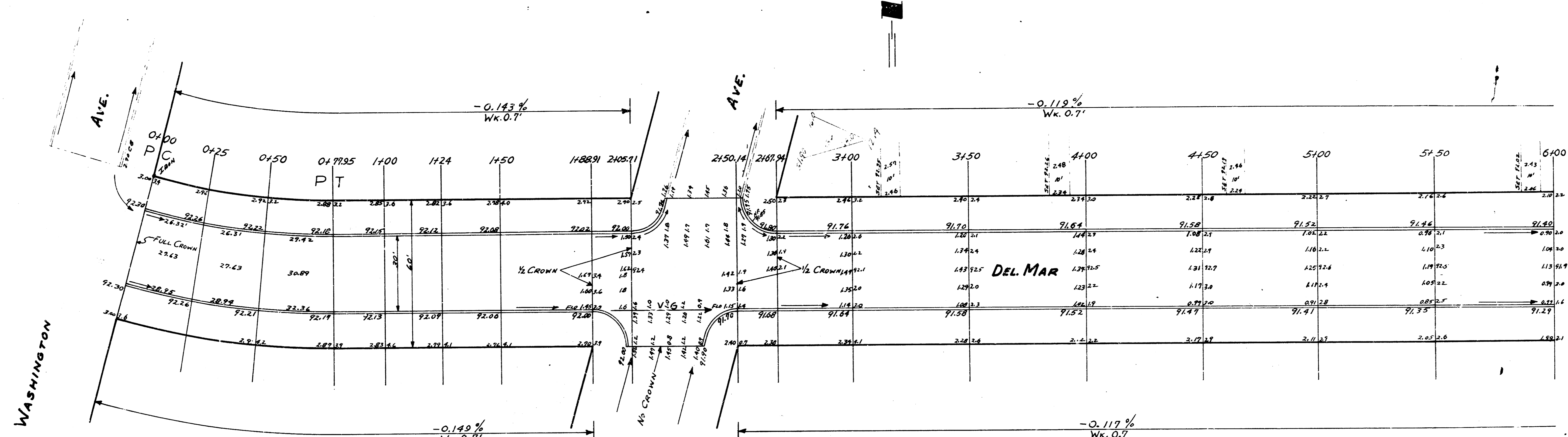

NOTE: TO FIELD ENG. & CONTRACTOR
 MATCH ALL DRIVES SHOWN ON THIS PLAN

DEL MAR
 EL. WASHINGTON TO W.L. PATTIE
 30' CONC. CURB
 CITY OF WICHITAKAN
 B.E. SMITH CITY ENGINEER
 APRIL 1955 PROJ. NO. C14-141

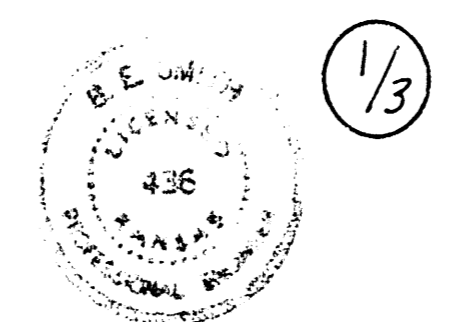

1/3

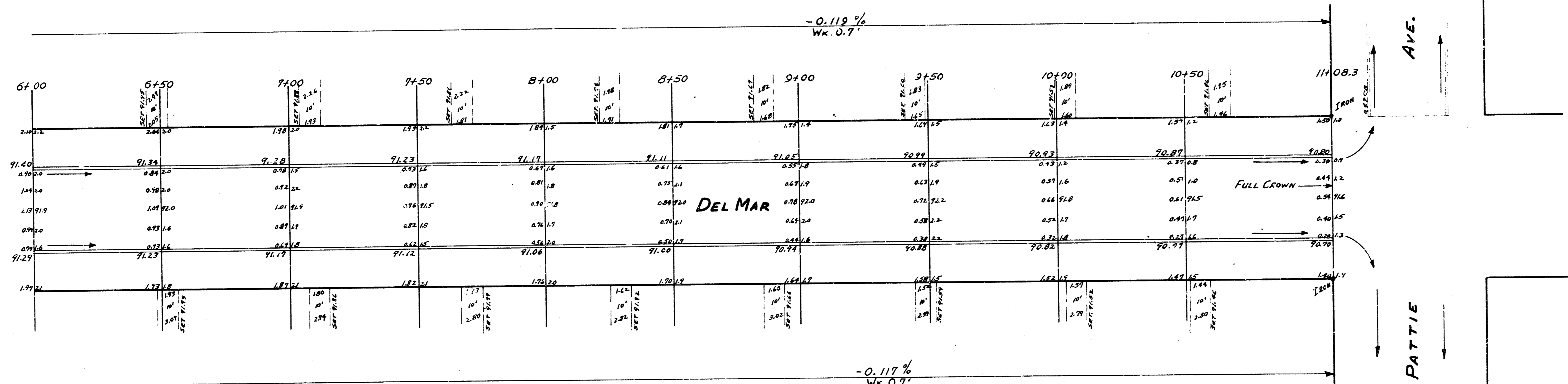

DEL MAR
EL WASHINGTON TO W.L. PATTIE