

BM 36.81 N.E. COR. CONC. PORCH HOUSE #2501 SOUTH WASHINGTON
 BM 35.52 #60 SPIKE W.S. N.L.P. SOUTH SIDE DENKER 118' E OF PATTIE
 STATIONING: BASE LINE ON NORTH PROP. LINE

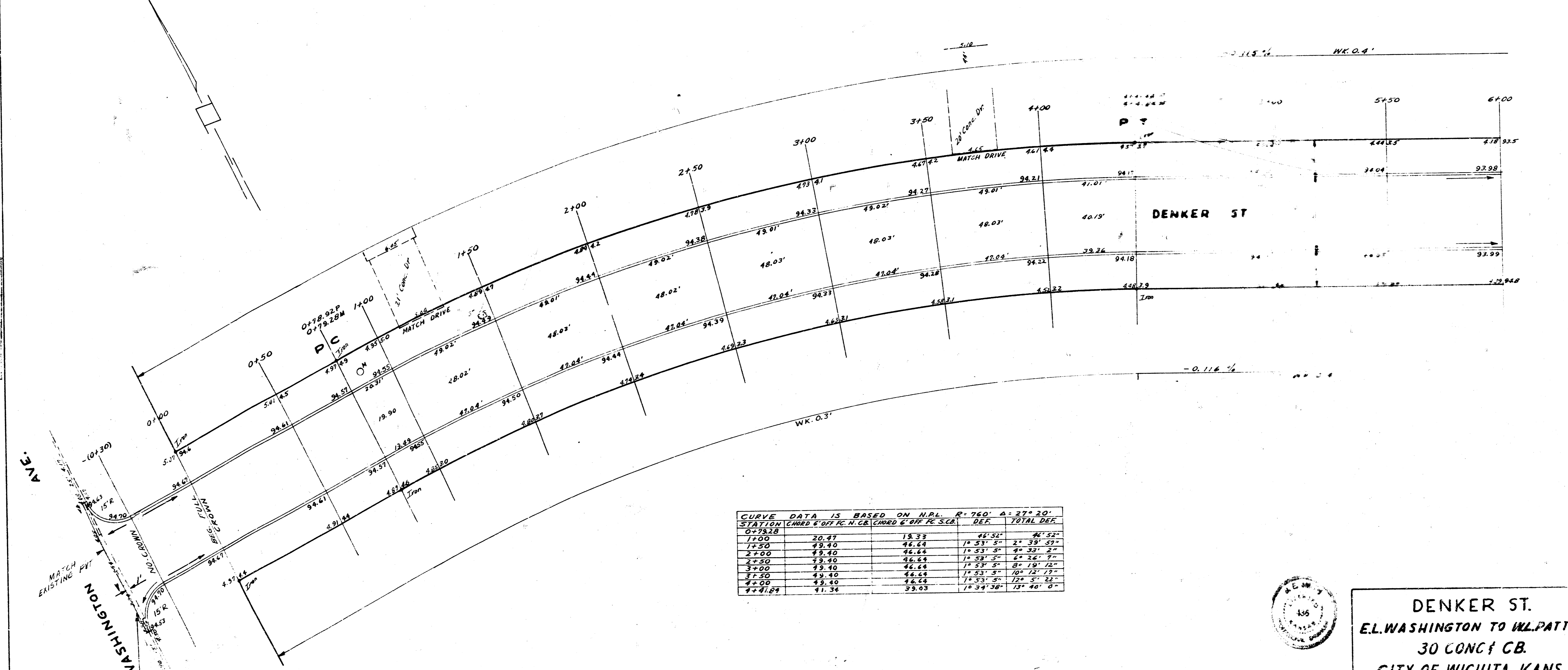

CURVE DATA IS BASED ON H.P.L. R=760' Δ=27° 20'

STATION	CHORD E. OF PC	H.C.B. (CHORD E. OF P.C.)	DEG.	TOTAL DEG.
0+78.28				
1+00	20.47	15.33	46° 52'	46° 52'
1+25	45.40	46.64	1° 53' 5"	2° 39' 57"
2+00	45.40	46.64	1° 53' 5"	4° 23' 2"
2+25	20.47	15.33	46° 52'	8° 16' 0"
3+00	45.40	46.64	1° 53' 5"	10° 19' 15"
3+25	45.40	46.64	1° 53' 5"	12° 12' 15"
4+00	20.47	15.33	46° 52'	16° 04' 0"
4+21.82	41.36	35.03	10° 34' 38"	15° 40' 0"

DENKER ST.
 E.L. WASHINGTON TO W.L. PATTIE
 30 CONC. CB.
 CITY OF WICHITA KANS.
 B.E. SMITH CITY ENGINEER
 JULY 1957 PROJ. NO C13-168

Survey Young Bk 195-14
 B.E. SMITH
 City Engineer

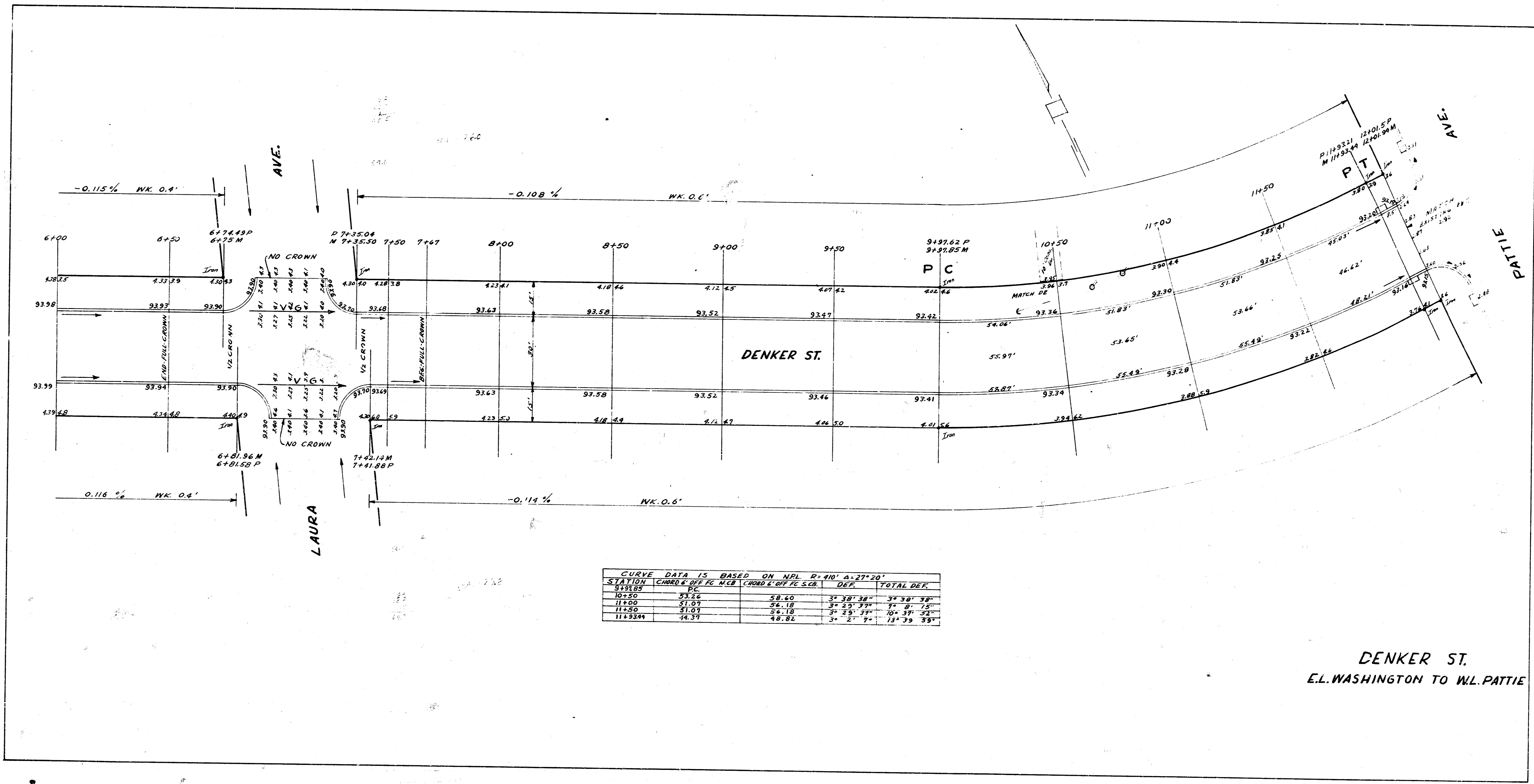

CURVE DATA IS BASED ON NPL R=410' Δ=27°20'

STATION	CURVE	CHORD	OFF TO CURVE	CHORD	OFF TO CURVE	DEF.	TOTAL DEF.
9+53.82	PC	58.60	3' 38" 38"	71	8' 15"		
10+50		56.18	3' 25" 39"	71	8' 15"		
11+50		56.18	3' 25" 39"	71	8' 15"		
11+52.44	PT	48.82	3' 2" 7"	13' 39"	33"		

DENKER ST.
E.L. WASHINGTON TO W.L. PATTIE