

B.M. 1 96.79 Step Bench N.S. High Line Pole 1st Pole W. of Canal S.S. Wassal
 B.M. 2 96.72 "X" on Top & Ctr. of Outfall Structure 82° S. & 65° N. of S.E. Cor. Denker & Southeast Dr.

Chain E. on S. R.

NOTE

START CONSTRUCTION ON THIS PROJECT AT STA 0+05.8
 STA 0+00 TO STA 0+05.8 TO BE BUILT WITH RETURN OF
 SOUTHEAST BLVD PER NO C13-160.

Begin PROJECT

SOUTHEAST DR.
 Intersection on Proj. No. C13-160.

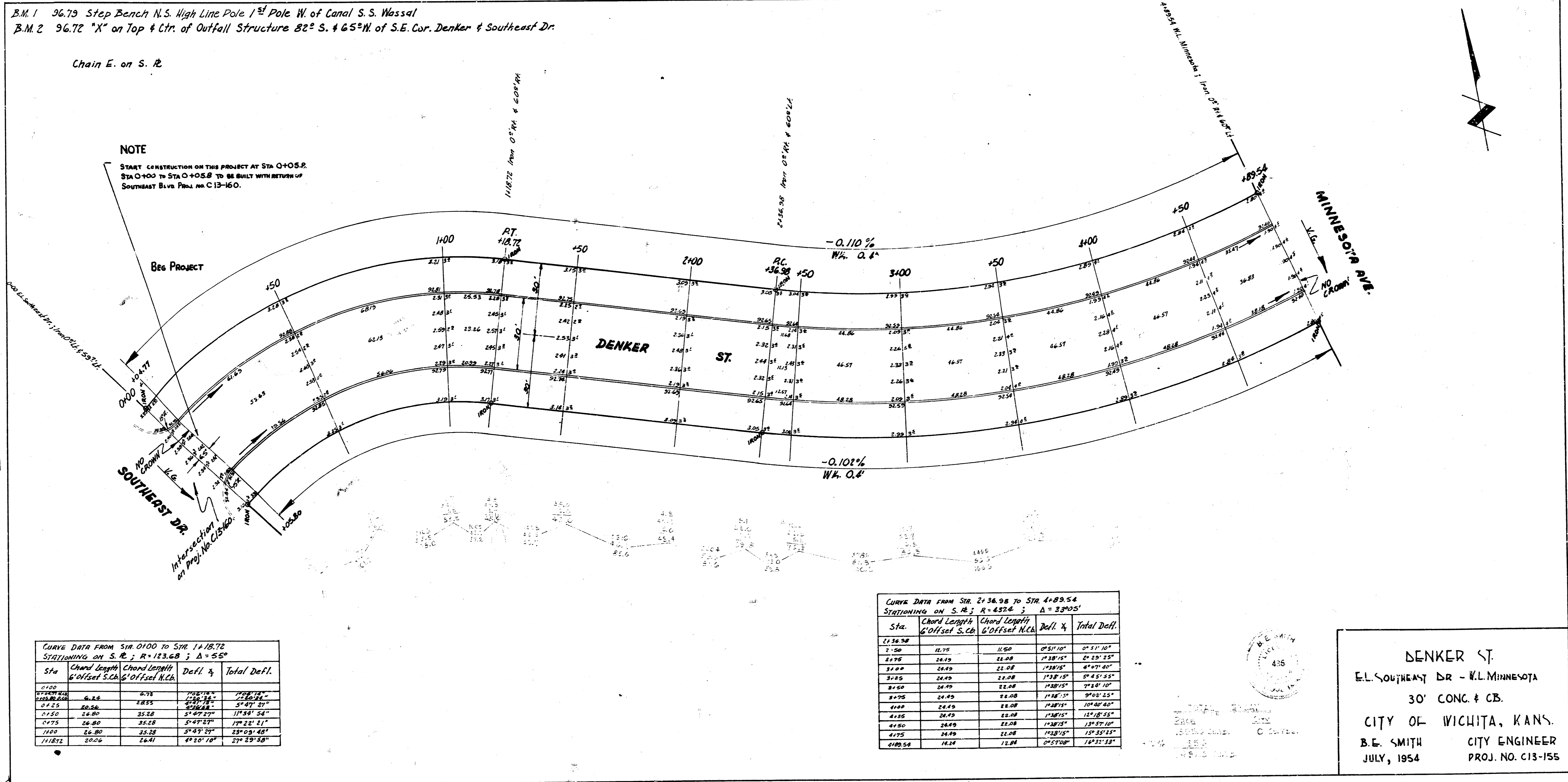

DENKER ST. 30' CONC. & C.B.
 L.S. 11/27/54
 C. 11/27/54

CURVE DATA FROM STA 0+00 TO STA 1+18.72
 STATIONING ON S. R.; R=123.68; Δ=55°

Sta	Chord Length	Chord Length	Defl. ∠	Total Defl.
	6' Offset S. Ch.	6' Offset N. Ch.		
0+00	6.24	6.78	102°18'44"	102°18'44"
0+12.5	20.56	22.55	102°18'44"	5°47'22"
0+25	34.80	37.58	5°47'22"	17°38'54"
0+37.5	48.80	52.58	5°47'22"	29°22'11"
0+50	62.40	66.72	5°47'22"	40°59'40"
0+62.5	75.60	80.41	6°10'10"	47°29'58"

CURVE DATA FROM STA 2+36.98 TO STA 4+00.54
 STATIONING ON S. R.; R=437.6; Δ=39°05'

Sta	Chord Length	Chord Length	Defl. ∠	Total Defl.
	6' Offset S. Ch.	6' Offset N. Ch.		
2+36.98	12.75	13.60	0°51'10"	0°51'10"
2+49.73	24.49	25.80	1°38'15"	2°29'25"
2+62.48	36.24	38.08	1°38'15"	4°07'40"
2+75.23	48.00	50.08	1°38'15"	5°45'55"
2+87.98	59.75	62.08	1°38'15"	7°24'10"
3+00.73	71.50	73.60	1°38'15"	9°02'25"
3+13.48	83.25	85.60	1°38'15"	10°40'40"
3+26.23	95.00	97.60	1°38'15"	12°18'55"
3+38.98	106.75	109.60	1°38'15"	14°00'10"
3+51.73	118.50	121.60	1°38'15"	15°45'25"
3+64.48	130.25	133.60	1°38'15"	17°34'40"
3+77.23	142.00	146.00	1°38'15"	19°27'55"
3+89.98	153.75	158.40	1°38'15"	21°25'10"
4+02.73	165.50	169.60	1°38'15"	23°26'25"



DENKER ST.
 E.L. SOUTHEAST DR. - W.L. MINNESOTA
 30' CONC. & C.B.
 CITY OF WICHITA, KANS.
 B.E. SMITH CITY ENGINEER
 JULY, 1954 PROJ. NO. C13-155