

**DODGE AVENUE**

**S.L. LOT 6, BLOCK D, VILM GARDENS SECOND  
ADDITION TO S.L. 43RD STREET SOUTH  
472 76 245 80397 000 000 001**

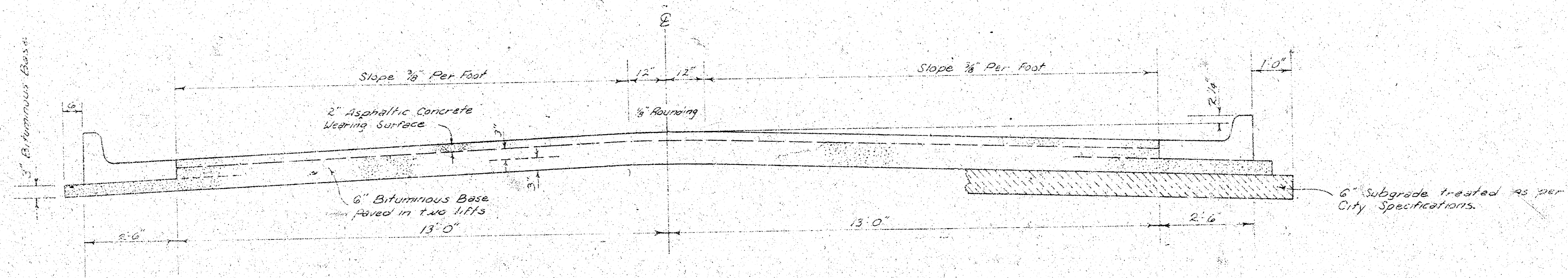

**TYPICAL SECTION**

**3' ASPHALTIC CONCRETE PAVEMENT WITH BITUMINOUS BASE**

*The A.C. pavement between the Comb. Curb & Gutter and the 6" Bituminous Base shall be paid as 3" A.C. Pavement (6 Bituminous Base). The Bituminous Base under the Comb. Curb & Gutter shall be paid as 3" Bituminous Base.*

COMBINED CURB & GUTTER

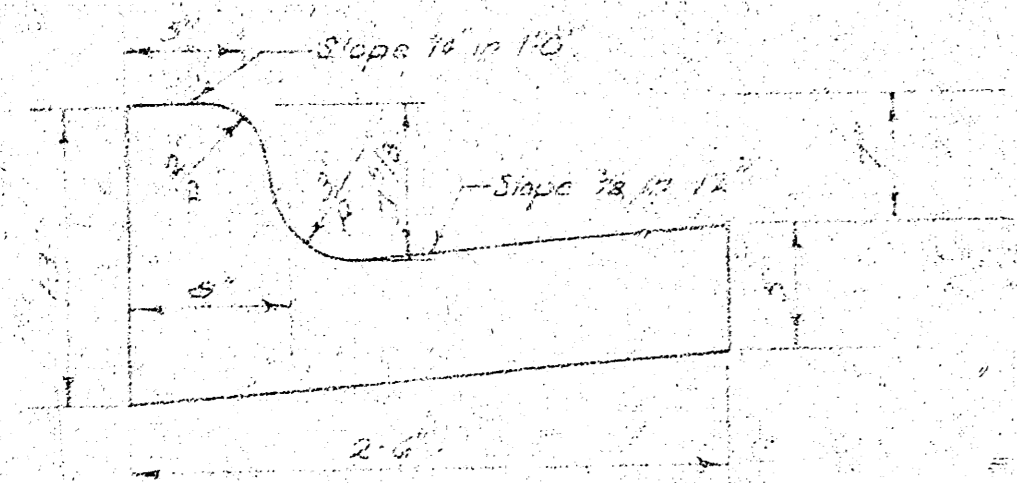

ROLL TYPE CURB & GUTTER

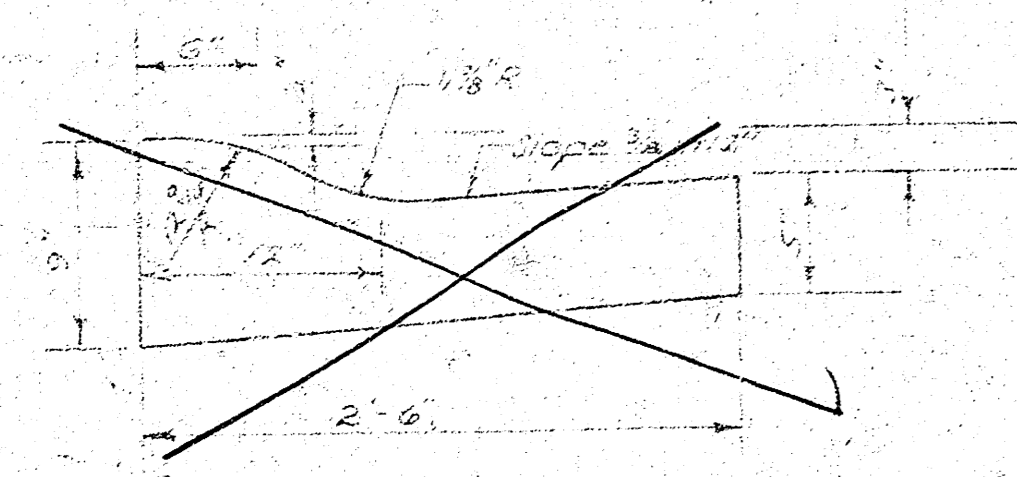

A TACK COAT OF EMULSIFIED ASPHALT (SS-1H) SHALL BE APPLIED AT AN APPROXIMATE RATE OF 0.05 GALLONS PER SQ. YD. BETWEEN LIFTS OF ASPHALTIC MATERIALS WHEN ORDERED BY THE ENGINEER. TACK COAT WILL NOT BE PAID FOR DIRECTLY AND SHALL BE CONSIDERED AS SUBSIDIARY TO PRICE BID FOR ASPHALTIC PAVEMENT. BITUMINOUS BASE AND ASPHALTIC CONCRETE WEARING SURFACE SHALL BE PLACED WITH A LAYDOWN MACHINE HAVING AUTOMATIC ELECTRONIC CONTROLS FOR CROWN AND GRADE. CONSTRUCTION JOINTS IN EACH LIFT SHALL BE STAGGERED A MINIMUM DISTANCE OF 1' WITH JOINTS IN PRECEDING LIFTS AND SUCH THAT A JOINT WILL BE CONSTRUCTED ON THE PAVEMENT CENTERLINE IN THE TOP LIFT.

**DETAIL OF TRANSVERSE CONSTRUCTION JOINTS**

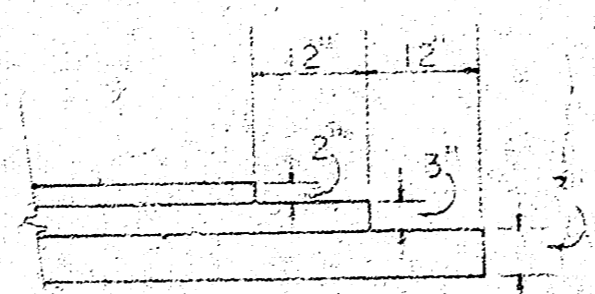

TRANSVERSE CONSTRUCTION JOINTS SHALL BE CONSTRUCTED IN FLEXIBLE BASE PAVEMENTS AT LOCATIONS WHERE PAVEMENT TEMPORARILY ENDS TO FACILITATE FUTURE PAVEMENT CONSTRUCTION AS SHOWN BY DETAIL. THE COST OF CONSTRUCTING THE TRANSVERSE CONSTRUCTION JOINTS SHALL NOT BE MEASURED OR PAID FOR DIRECTLY BUT SHALL BE INCLUDED IN THE BID PRICE FOR SQUARE YARDS OF ASPHALTIC CONCRETE PAVEMENT.

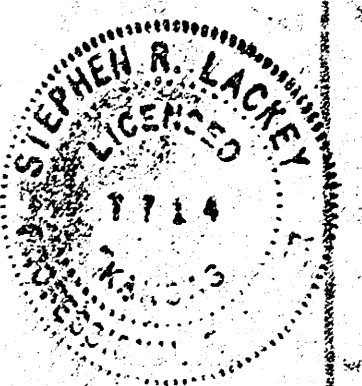

**CITY OF WICHITA, KANSAS**

DEPARTMENT OF PUBLIC WORKS — ENGINEERING

R. W. LINN CITY ENGINEER

DATE: \_\_\_\_\_ PROJ. NO. **DAKS 576036**

(1/2)

B.M. 89.47 Northwest corner of porch to house at 4400 South Dodge.  
 B.M. 91.48 Southwest corner of porch to house at 4444 Dodge.  
 B.M. 88.28 RR Spike in South side of power pole on the Southwest corner of 44th Street South and Dodge.  
 @ is C of Dodge.

2-15' DRIVES

Scale: 1" = 20'

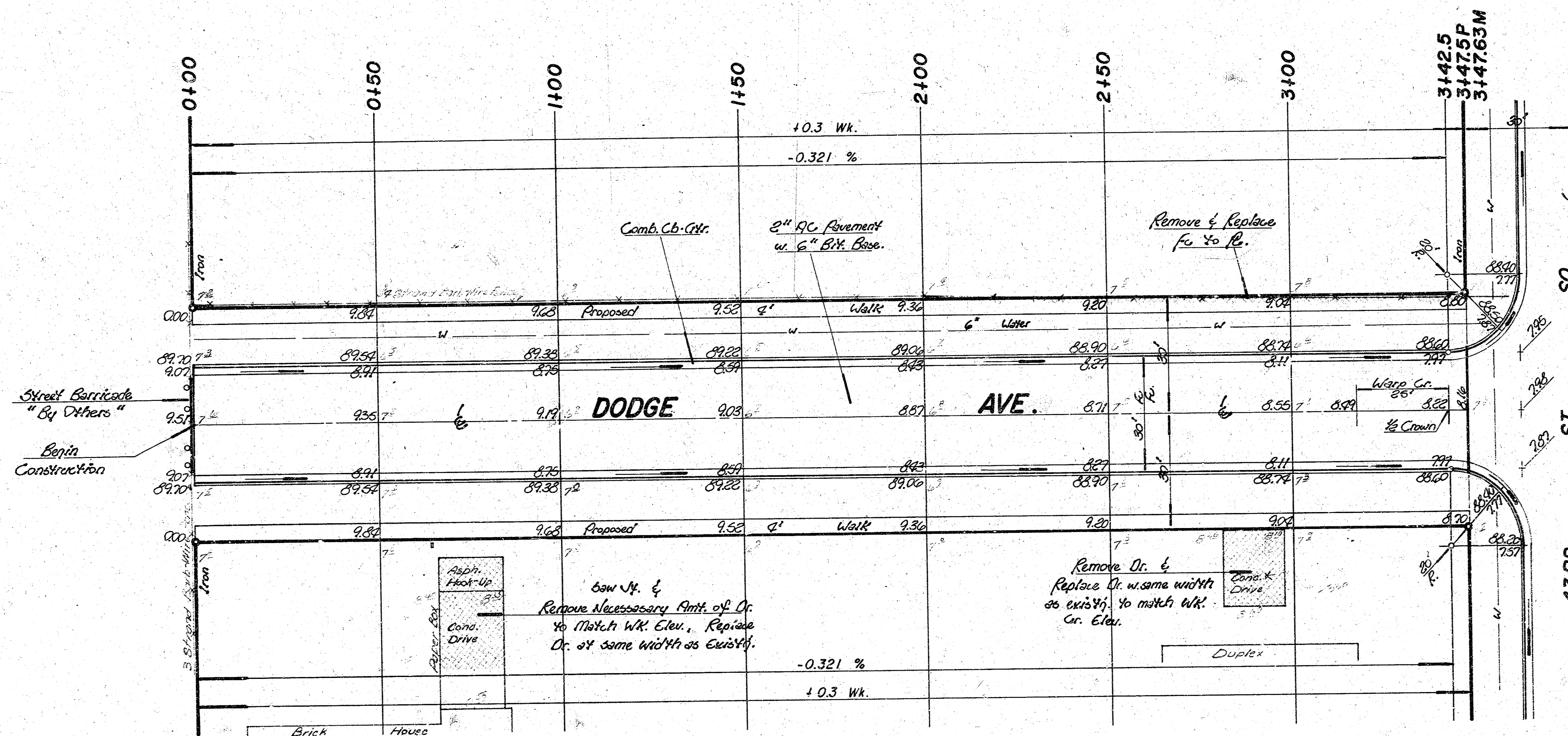

Survey  
 Plan  
 Exc.  
 Checked

Indicates Dr. or Asphalt Mat. to be Removed.

Indicates fence to be Removed & Replaced.

Note: Excess Earthwork from Construction of Proj. No. DAKS 576035 is to be used for Construction of Proj. No. DAKS 576036.

**SUBGRADE**  
 TYPE OF SUBGRADE SHALL BE DETERMINED BY FIELD ENGINEER. SUBGRADE TREATMENT MAY CONSIST OF LIMESTONE, CEMENT TREATMENT, SUB-GRADE MODIFICATION, OR ANY COMBINATION OF THESE.

**NOTE TO FIELD ENGINEER & CONTRACTOR**  
 Grade parking and clear right-of-way for proposed sidewalk. Compact fill in sidewalk areas to be constructed by CONTRACTOR.

**Earthwork Quantities**

Property	
Excavation = 0.6 cy.	Comp. fill = 615.5 cy.
+10% = 0.1 cy.	+10% = 61.6 cy.
Total = 0.7 cy.	Total = 677.1 cy.
Manipulation = 1272.2 cy.	

**DODGE AVENUE**  
 S.L. Lot 6, Block D, Vilm Gardens Second  
 Addition to S.L. 43rd Street South  
 (26-2-30 Asphaltic Concrete Pav't.)

**CITY OF WICHITA, KANSAS**  
 472 76 245 80397 000 000 001  
 RW. LINN CITY ENGINEER  
 PROJECT NUMBER: DAKS57607  
 DATE: \_\_\_\_\_