

B. M. 107.44 "M" IN MUELLER FIRE HYDRANT N.E. COR. DODGE & WALKER.
 B. M. 106.72 N.W. COR. 1ST CONC. STEP HOUSE NO. 1334 SOUTH DODGE.
 B. M. 106.95 "O" IN GLOBE W END RADIUS N.W. DODGE & STILLWELL.

N
 SCALE: 1"=20'

Survey Kraus
 Checked
 JAK:42

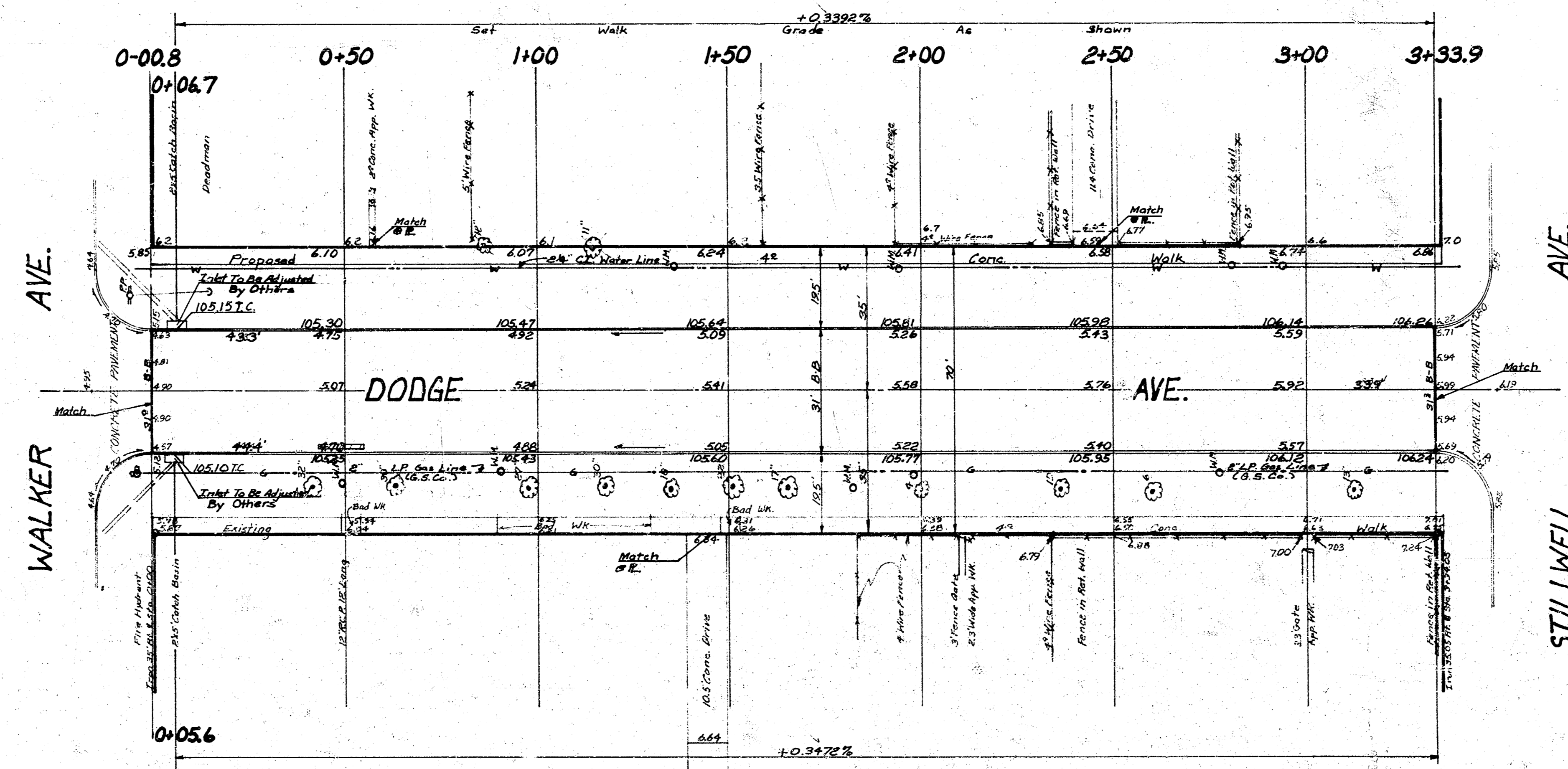

- GENERAL NOTES:
1. THE TYPE OF SUB-GRADE TREATMENT SHALL BE DETERMINED BY THE FIELD ENGINEER. THIS SUB-GRADE TREATMENT MAY CONSIST OF LIME TREATMENT, CEMENT TREATMENT, SUB-GRADE MODIFICATION, OR ANY COMBINATION OF THESE.
 2. CONTRACTOR TO CLEAR RIGHT-OF-WAY, GRADE PARKING, AND COMPACT FILL IN SIDEWALK AREAS. SIDEWALK TO BE CONSTRUCTED BY "OTHERS".
 3. CONCRETE WALK TO BE REMOVED ONLY WHERE A NEW DRIVE APPROACH IS TO BE CONSTRUCTED. MINIMUM AMOUNT OF 4" WALK IS TO BE CONSTRUCTED ON EITHER SIDE OF NEW DRIVES.

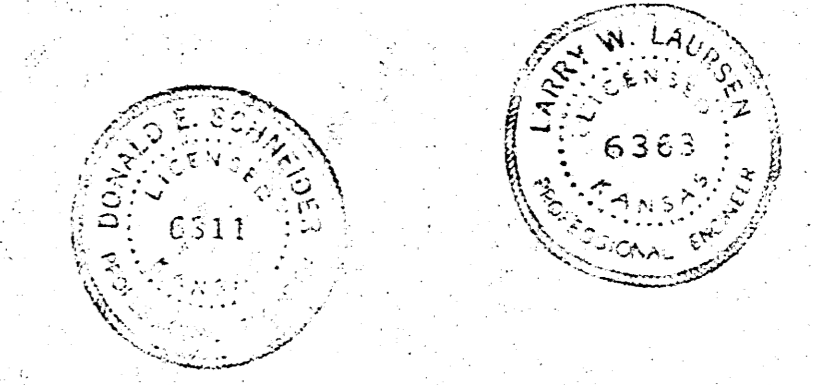

DODGE AVE. FROM N.L.
 WALKER AVE. TO S.L. STILLWELL AVE.
 6" CONC. 30" CL/RB
 CITY OF WICHITA, KANSAS
 R.W. LINN CITY ENGINEER

PROJ. NO. DAKS 572059
 DATE: April 1973

EXCAVATION = 418.4 CU YDS.
 + 0% = 41.8 CU YDS.
 TOTAL = 460.2 CU YDS.