

BM 10395 "G" IN GLOBE TOP OF CURB N.L. DORA E.S. FEEN

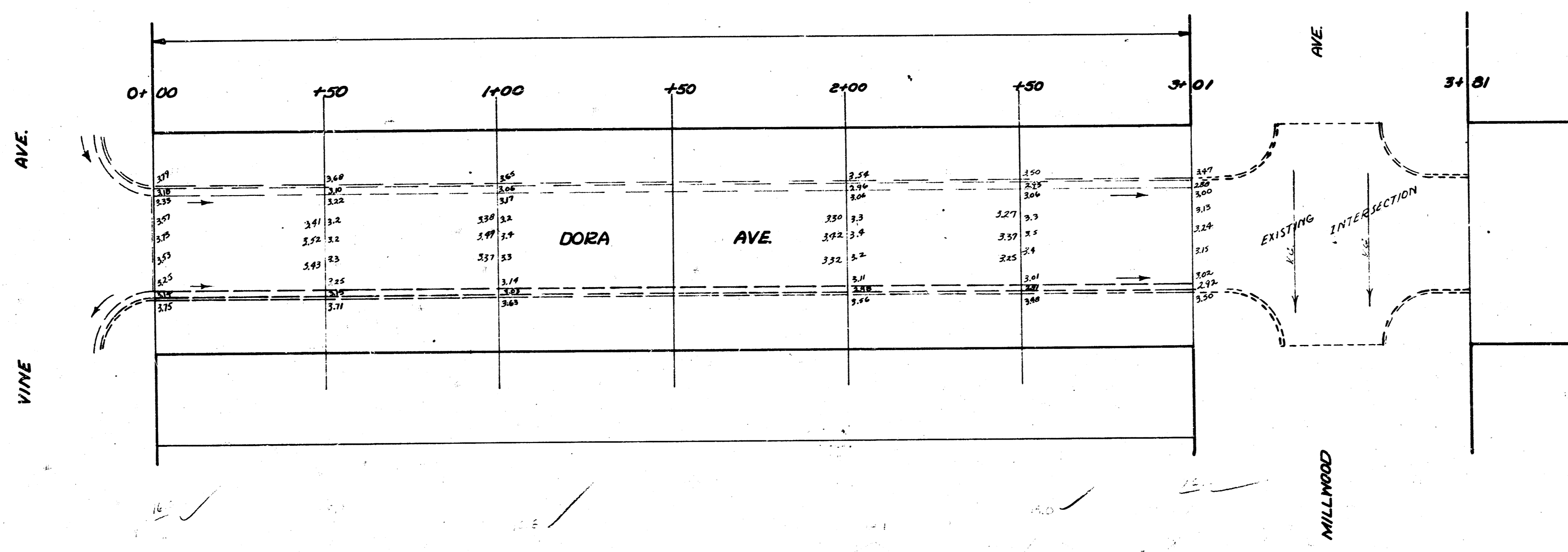

1
2

DOBA
E.L. VINE TO N.L. FEEN
26' CONC.
CITY OF WICHITA
L.K. WHITE CITY ENGINEER
SEPT. 1952 P&M. No. C12-111

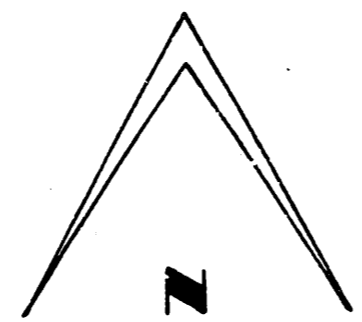
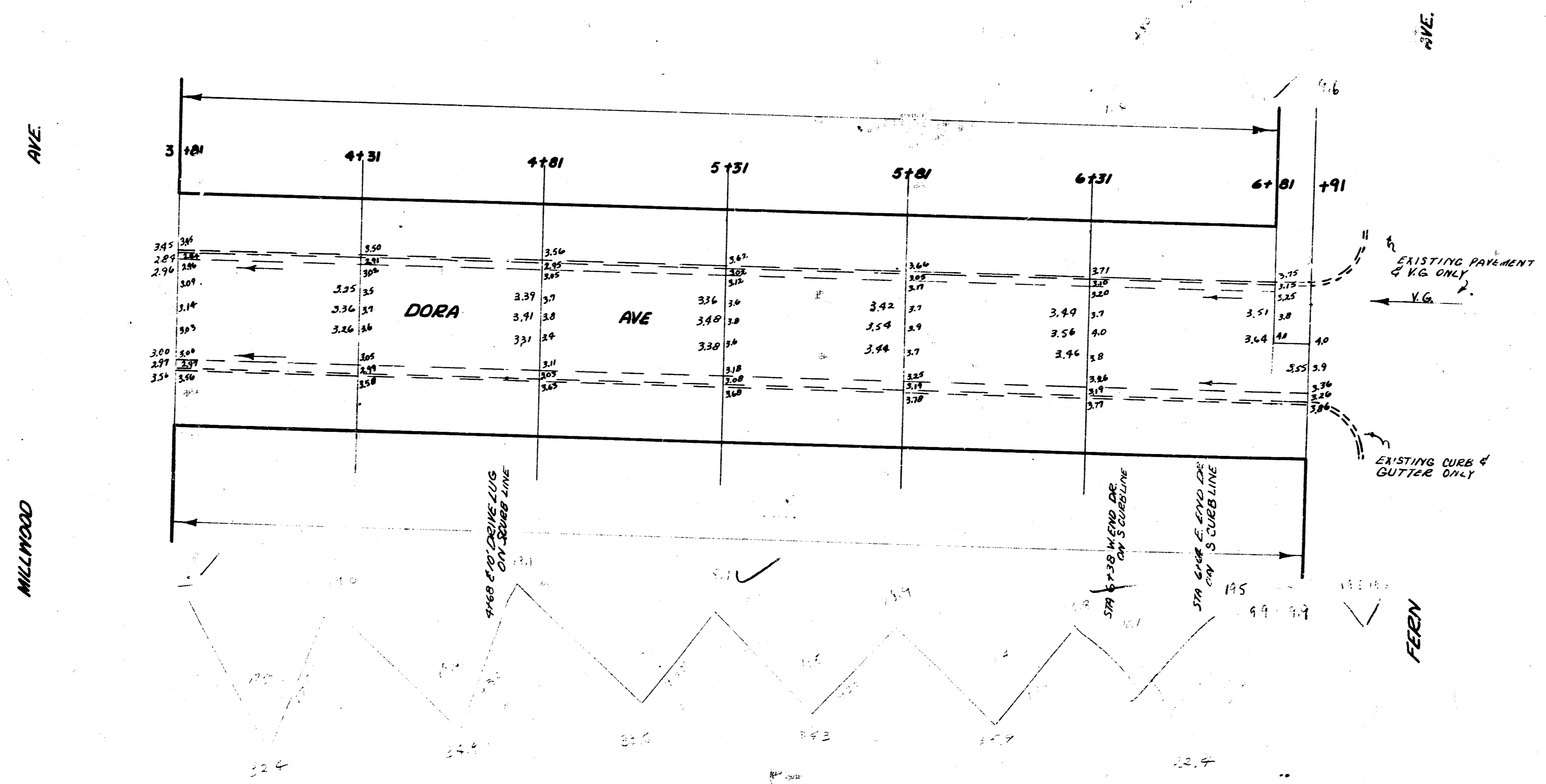

DOBA

2
2

1 1 1 0