

B.M. 103.45'6" in Globe E. cb. Millwood & N.L. Dora.

B.M. 104.23'8" in Globe W. cb. Elizabeth & N.L. Dora.

Note: V.B's. N.S. Both sides Millwood

B.M. 103.95'6" in Globe E. cb. Ferry & N.L. Dora.

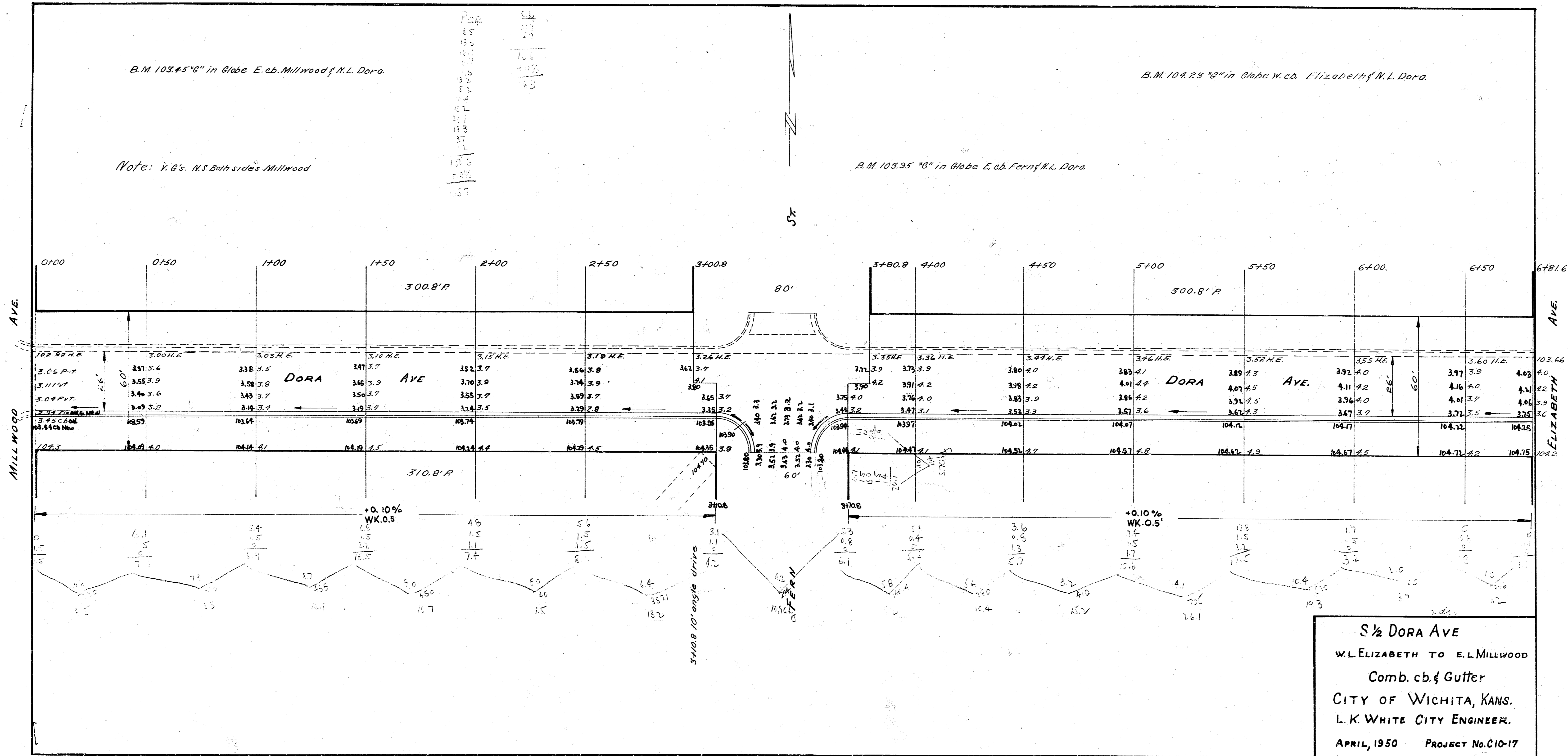

S 1/2 DORA AVE
 W.L. ELIZABETH TO E.L. MILLWOOD
 Comb. cb. & Gutter
 CITY OF WICHITA, KANS.
 L. K. WHITE CITY ENGINEER.
 APRIL, 1950 PROJECT No. C10-17