

B.M. 11970 SW Cor. Conc. Porch
No. * 50.6 W Douglas

Ref. Points to Stone & Douglas & Doris
1. 4435' NW to 3 Nails in SW Side Light Pole
2. 60.8' S to N. Face garage W.
3. 4393' SE to ctr. of top fire plug.

B.M. 12136 R.R. Spk. E.S.P. Pole
N.E. Cor. Bebe & Douglas

B.M. 11927 SW Cor. Approach Walk
No. * 170 N. Doris SW Cor. 1st & Doris

Scale: 1"=20'

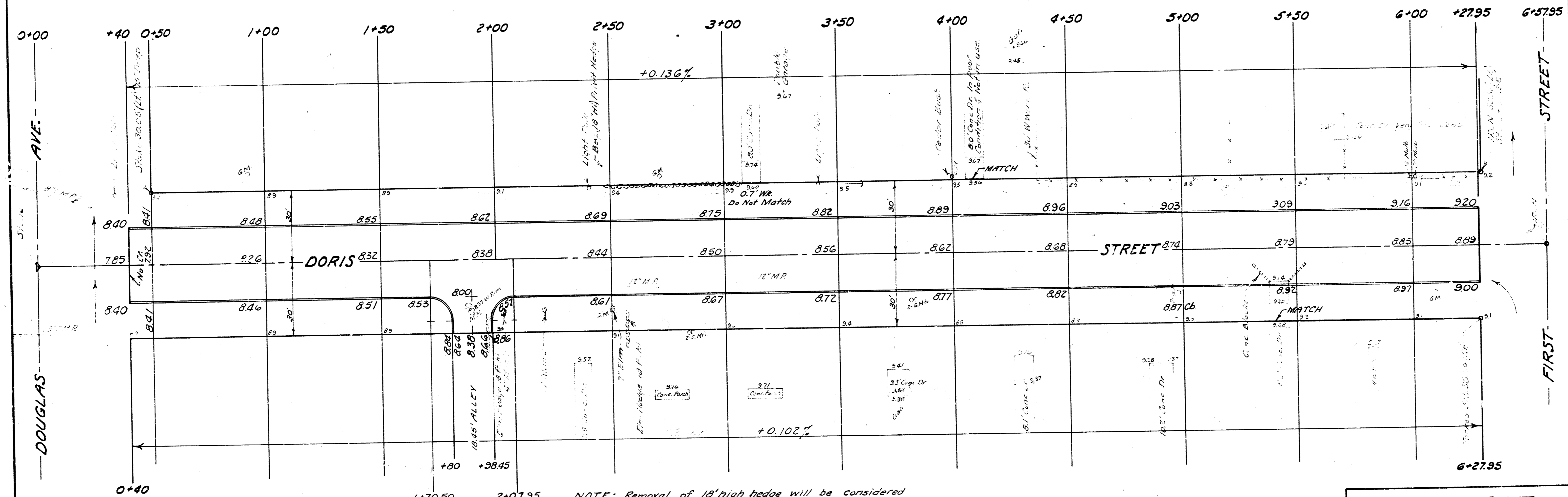

EXCAVATION		
	PROPERTY	CITY
Cu. Yds.	830	20
+10%	83	2
Totals	913	22 Cu. Yds.

NOTE: Removal of 18' high hedge will be considered and paid as Small Trees Removed.

NOTE-CONTRACTOR: Utility service lines may be located unusually close to the surface. Therefore extreme care shall be used in excavating & grading in connection with this project.

DORIS STREET
From N.L. DOUGLAS AVE.
To S.L. FIRST STREET
30'-6" Conc. & Int. Curb
B.E. SMITH CITY ENGINEER
CITY OF WICHITA, KANSAS
AUG. 1962
Project No. C11-62

