

IMPROVING DOUGLAS AVENUE

FROM EAST OF BYRON ROAD TO TYLER ROAD

GENERAL NOTES

Underground utility service lines and overhead utility pole lines are to be adjusted as necessary by other prior to construction unless the plans specifically call for their adjustment by the Contractor or unless the plans specifically identify a utility to be adjusted by its owner during construction. Existing utilities and their location, as shown on the plans, represent the best information obtainable for design. The Contractor will be required to work around existing utilities within the right-of-way which do not conflict with proposed construction.

A saw cut of at least one-half the depth of existing surface courses or one-fourth the depth of the existing total pavement thickness shall be provided at locations where proposed construction abuts an existing surface course or pavement for which partial removal of that surface or pavement is required. Saved joint to facilitate removal within 3 feet (3') of existing joints will not be permitted and for such instances the limits of removal shall extend to the existing joint. Such saw cuts will not be paid for directly and this cost shall be considered as subsidiary to the removal of the surface or pavement.

ubble from the removal of miscellaneous structures and excess excavation which is to be wasted shall be disposed of on sites to be provided by the Contractor. These sites shall be approved by the Engineer as to suitability, appearance and site location. Locations that, in the opinion of the Engineer, will leave an unsightly appearance will not be approved.

All disposal sites must be approved by the Kansas Department of Health and Environment. Material either stockpiled or disposed of in a flood plain would require a Kansas State Board of Agriculture permit. Any material dumped in waters of the United States or wetlands is subject to U.S. Corps of Engineers permitting regulations. Any material buried or stockpiled beyond approved construction limits would require additional archaeological investigations unless buried in a previously approved borrow location.

Mailboxes within the limits of the project shall be removed and replaced by the Contractor as approved by the Engineer. Contractor will be required to make satisfactory provisions for mail delivery to properties affected by this project during its construction.

The contractor shall give all property owners and/or tenants of developed property affected by this project a minimum of ten (10) days advance notice prior to start of construction.

CONTRACTOR WILL BE REQUIRED TO PROVIDE LOCAL VEHICULAR ACCESS TO WOOD LANE DURING CONSTRUCTION OF THIS PROJECT.

NOTE: ALL EARTHWORK IS TO BE SUBSIDIARY TO THIS PROJECT

PROJECT NO. 472-82075

INDEX NO. 760736

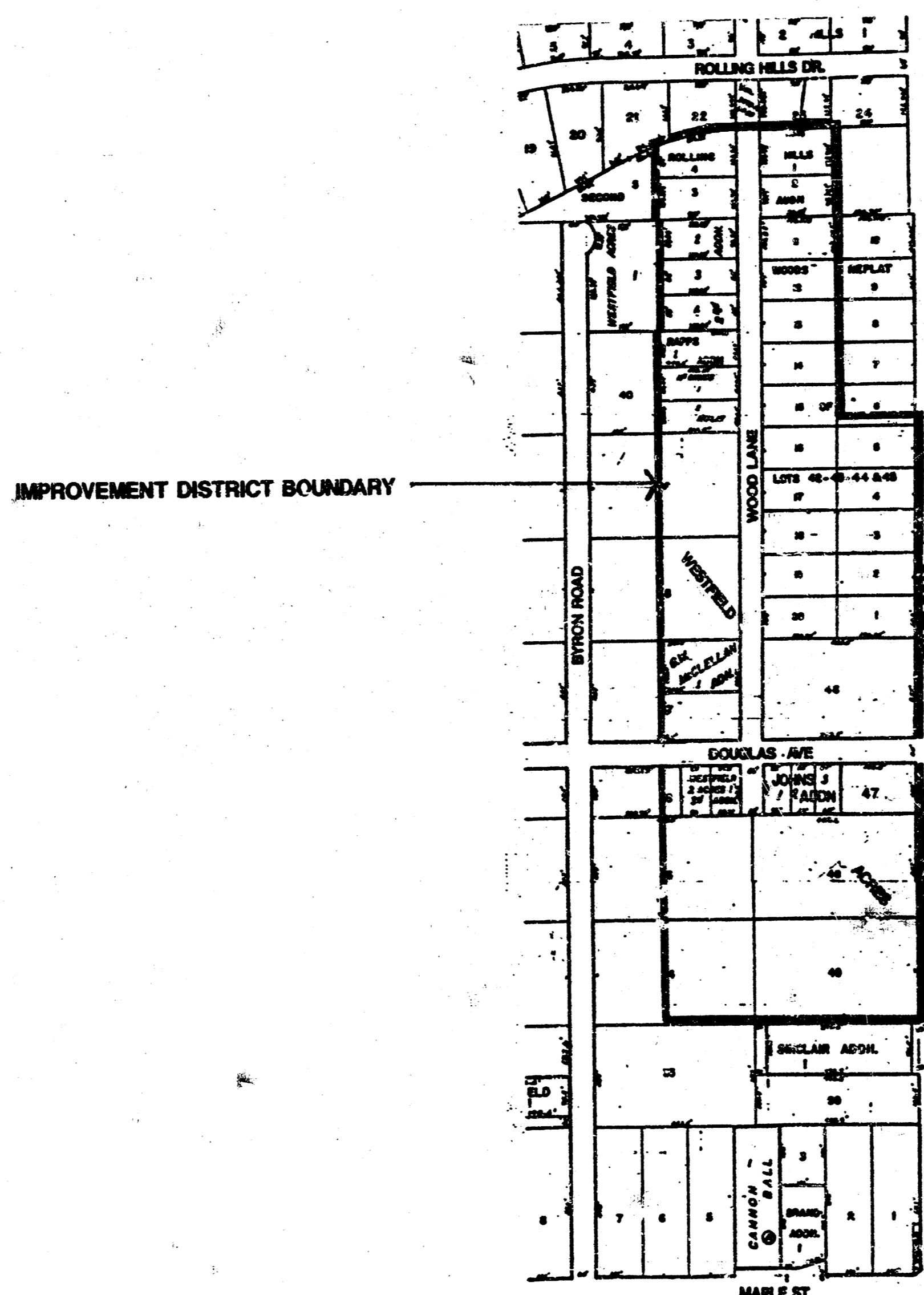

INDEX TO DRAWINGS

SHEET NO.	DESCRIPTION
1	TITLE SHEET
2	TYPICAL SECTION
3	PAVING PLAN
4	CROSS SECTIONS

M. E. LINDEBAK -- CITY ENGINEER
WICHITA, KANSAS



TYPICAL SECTION

24' ASPHALTIC CONCRETE ROADWAY WITH REINFORCED CRUSHED ROCK BASE

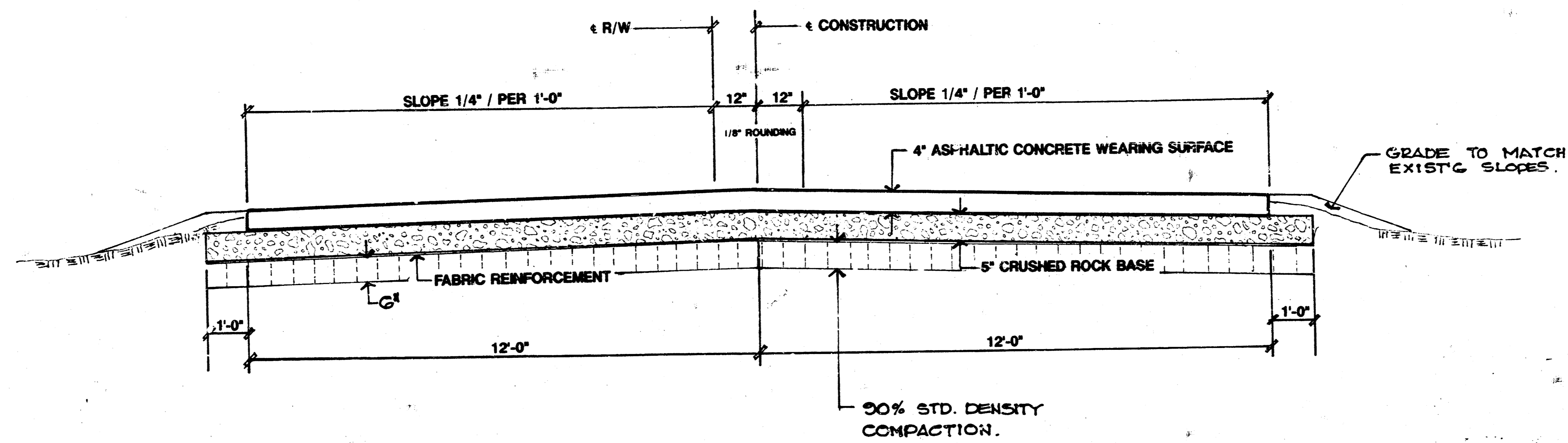

GENERAL NOTES

FABRIC BASE REINFORCEMENT SHALL BE 8 X 1100 GEOGRID AS MANUFACTURED BY TENSAR CORPORATION OR APPROVED EQUAL. FABRIC BASE REINFORCEMENT SHALL BE INSTALLED IN ACCORDANCE WITH MANUFACTURER'S RECOMMENDATIONS. CRUSHED ROCK SHALL BE UNIFORMLY GRADED AND CONFORM TO THE FOLLOWING GRADATION.

PER CENT OF AGGREGATE RETAINED	
1-1/2"	0
3/4"	15-60
#4	40-80
#40	74-82
P200	4-12

ROCK QUALITY SHALL BE THE SAME AS SPECIFIED FOR COARSE AGGREGATE FOR ASPHALT MIXES.

ROCK EDGE IS TO BE COMPACTED AND SMOOTHED WITH A STEEL FACED ROLLER PRIOR TO PLACEMENT OF ASPHALT. TACK COAT WILL NOT BE APPLIED TO ROCK BASE.

REINFORCED CRUSHED ROCK BASE WILL BE PAID FOR AT THE SQUARE YARD PRICE FOR 5" THICKNESS

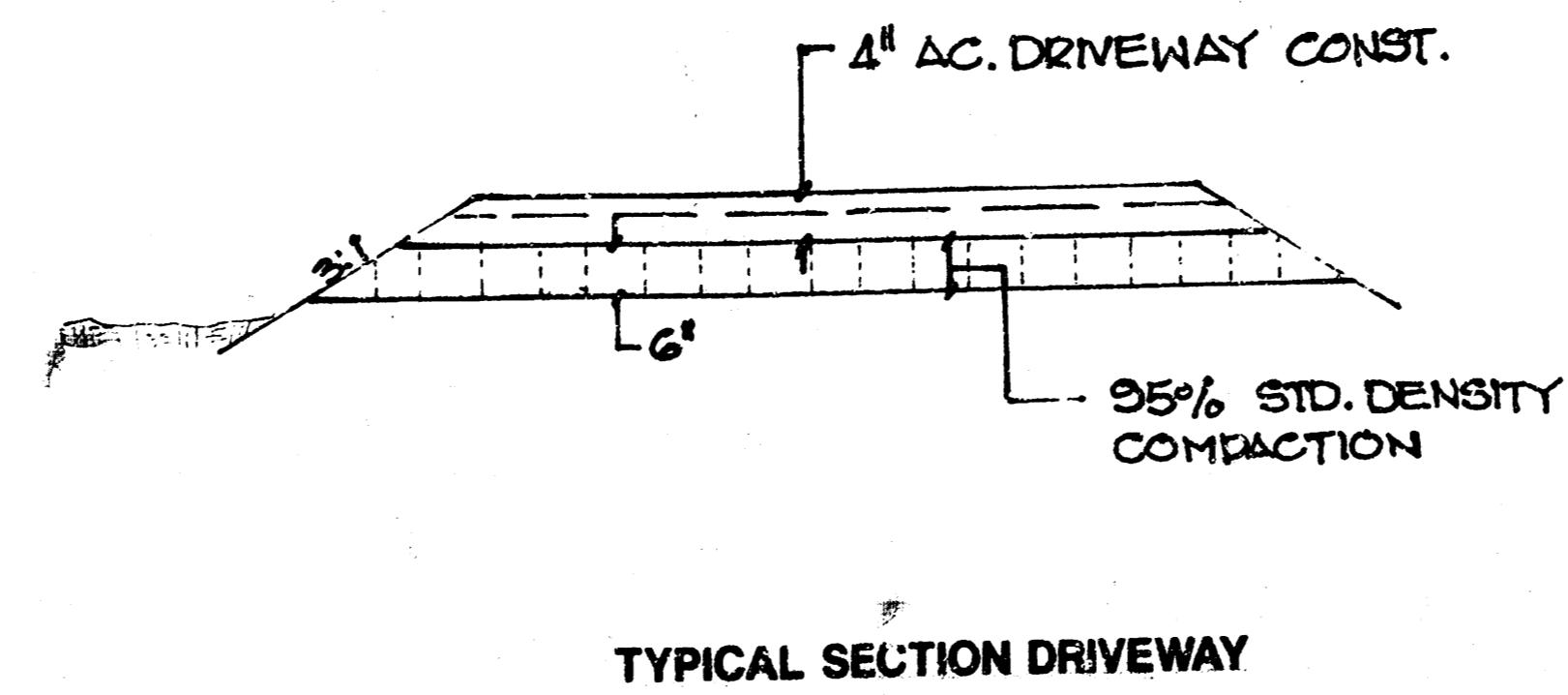
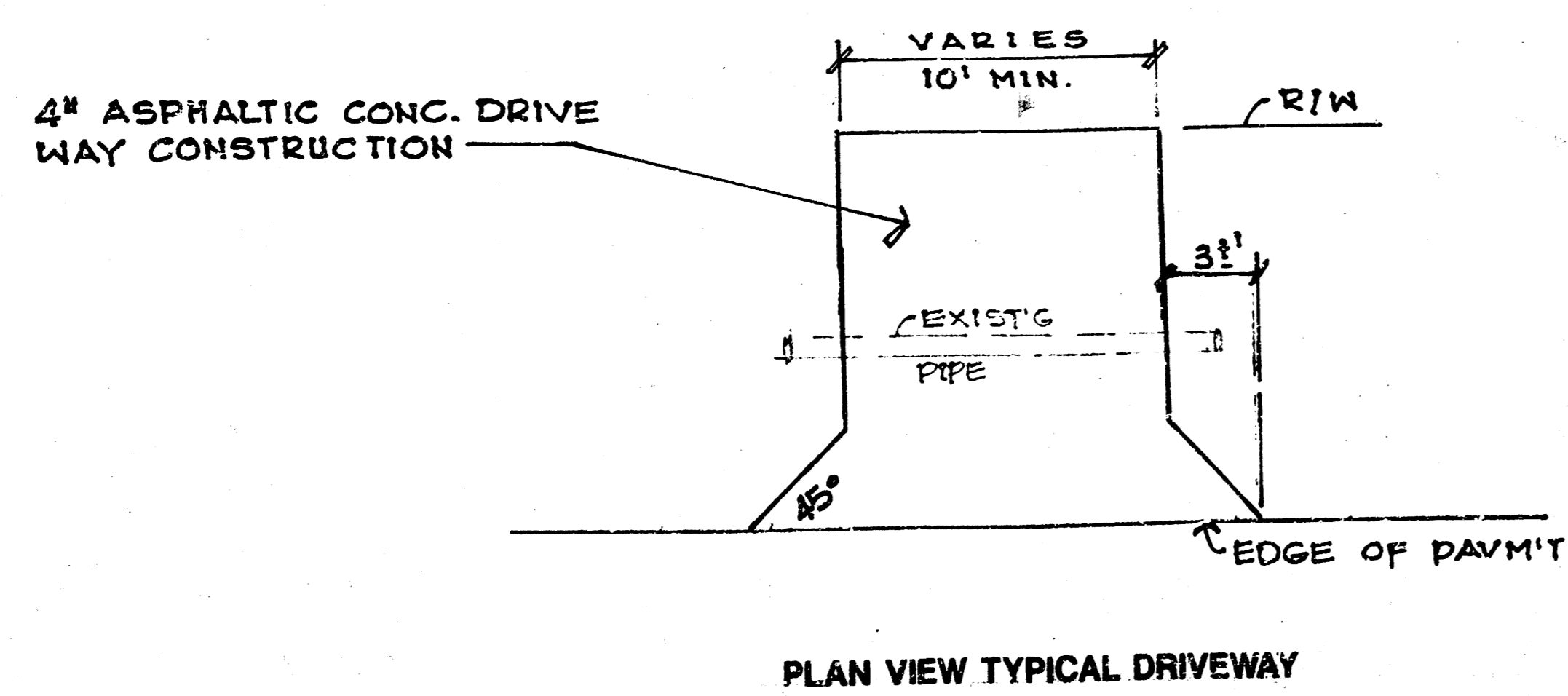

B.M. = 144.12 C.O.W. DISC. 39.3' E. & 50.7' N. & BOTH TYLER ROAD AND MAPLE
 B.M. = 143.98 H.R. SPIKE S.E. FACE P.P. STA. 0+00 19' LEFT.
 B.M. = 142.70 SOUTH END RETURN WEST SIDE OF TYLER ROAD AT DOUGLAS AVENUE

Scale: 1" = 20'

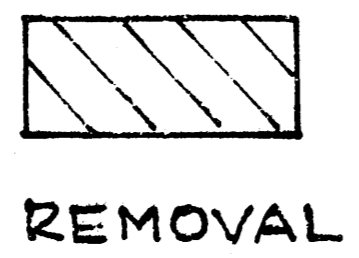
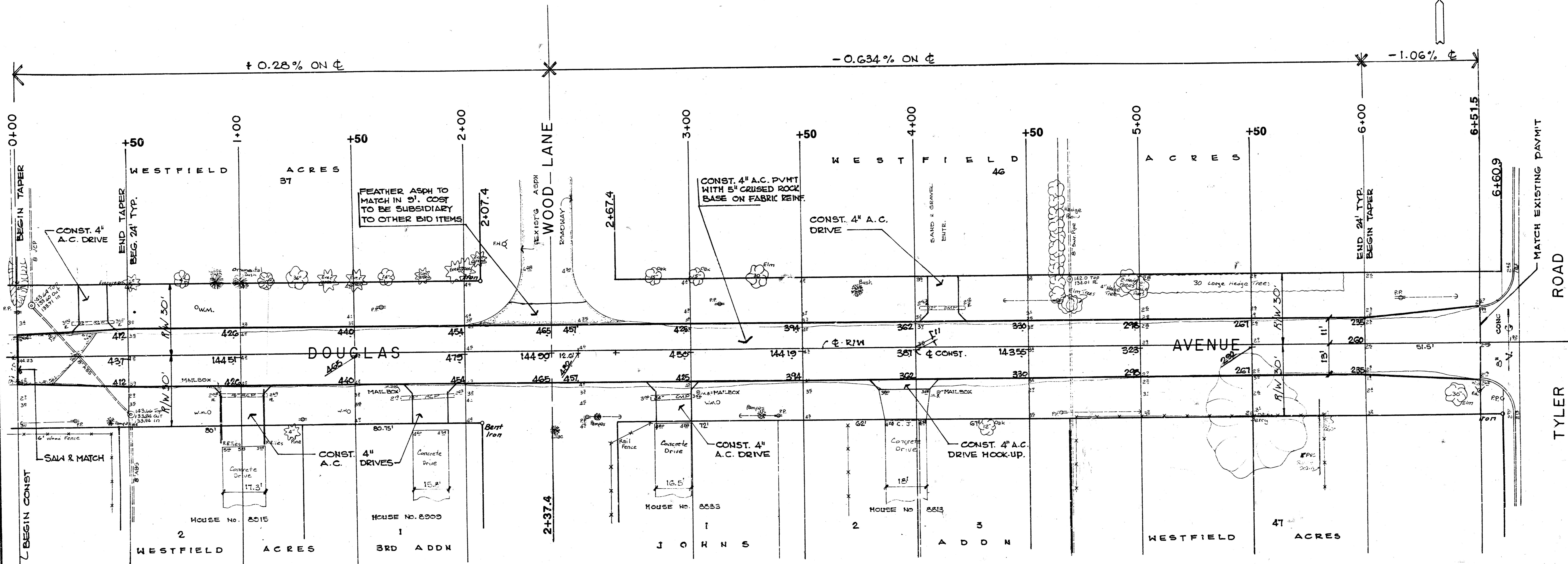
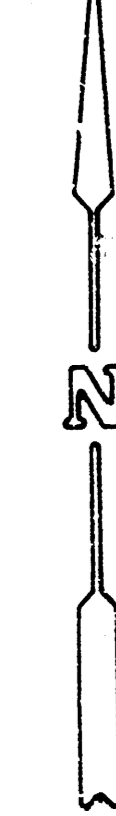

EXCAVATION
 356.3 CU YDS
 +10% 35.6 " "
 391.9 CU YDS
 FOR INFORMATION ONLY

3
4

DOUGLAS AVE. EAST OF BYRON TO TYLER RD.	
SCALE: 1" = 20'	APPROVED BY _____
DATE _____	DRAWN BY _____
472-82075 INDEX NO. 760736	
DRAWING NUMBER	

