

BM 14611 Top S. Bolt W. Hubward SS Bridge on Eastern Avenue.
 Stationing on a line 3000' W of E.L. Eastern Avenue.

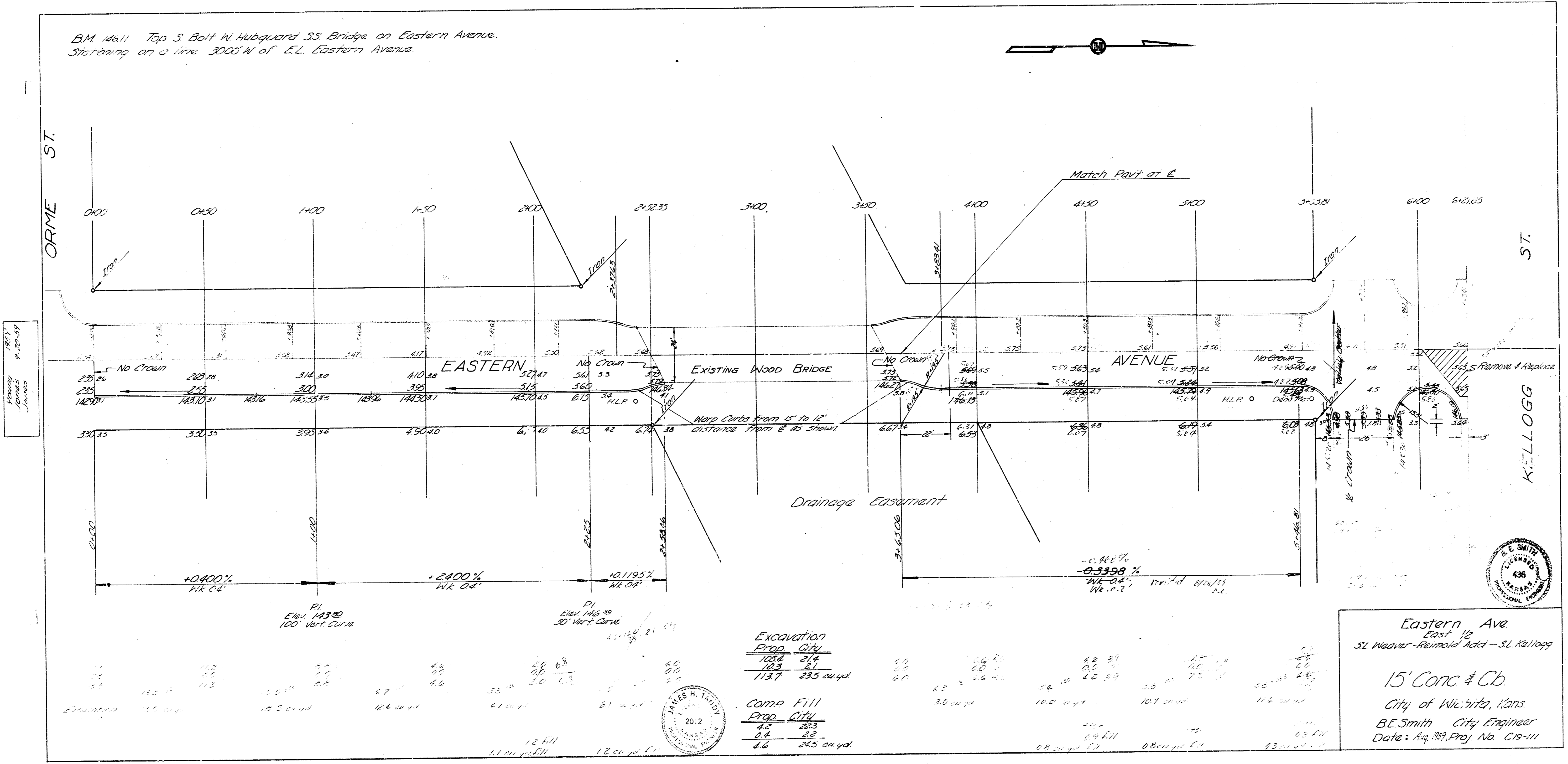

1853
 James
 Jones
 P. 20-59
 Engineer



Excavation	
Prop.	Qty.
1024	214
1023	21
1137	235 cu yd

Comp. Fill	
Prop.	Qty.
42	213
04	22
46	215 cu yd

Eastern Ave.
 East 1/2
 SL Waiver-Remold Add - SL Kellogg
 15' Conc # Cb.
 City of Wichita, Kans.
 B.E. Smith City Engineer
 Date: Aug. 1939, Proj. No. C19-111

