

EDGEMOOR DRIVE
 S.L. Orme Street to N.L. Waterman Street
 Improve & Reimprove 7' 8" A.C. & 8" Conc. Pavt.
 City of Wichita, Kansas
 R.M. Linn City Engineer
 Date: Dec. 1973, Proj. No. DAKM 576015

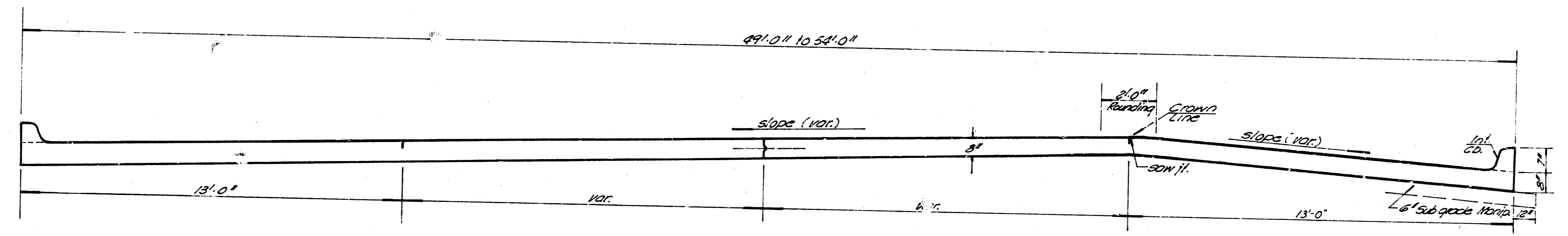

**PAVEMENT SECTION
STA. 0+65.5 TO 1+50**

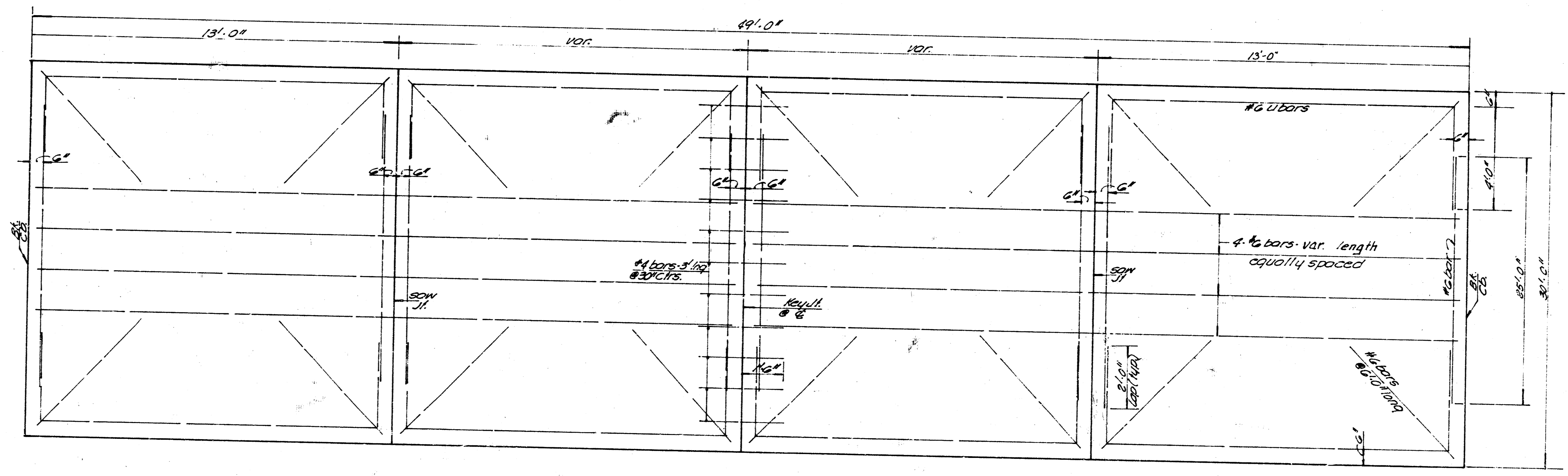

**STEEL PATTERN
STA. 0+65.5 TO 1+50**

EDGEWOOD DRIVE
PROJ. NO. DAKM 572015

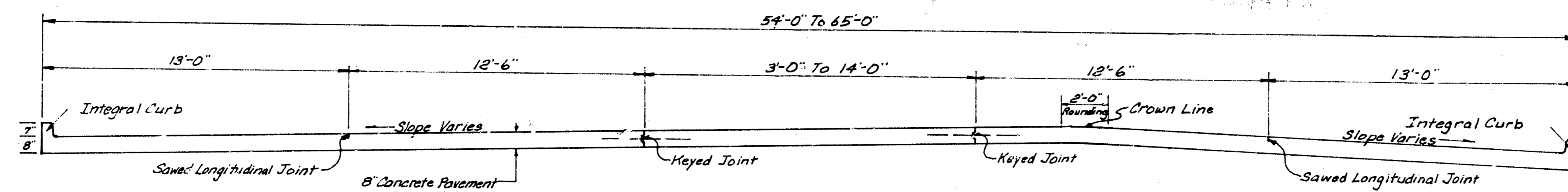

**PAVEMENT SECTION
STA 1+50 TO 5+60**

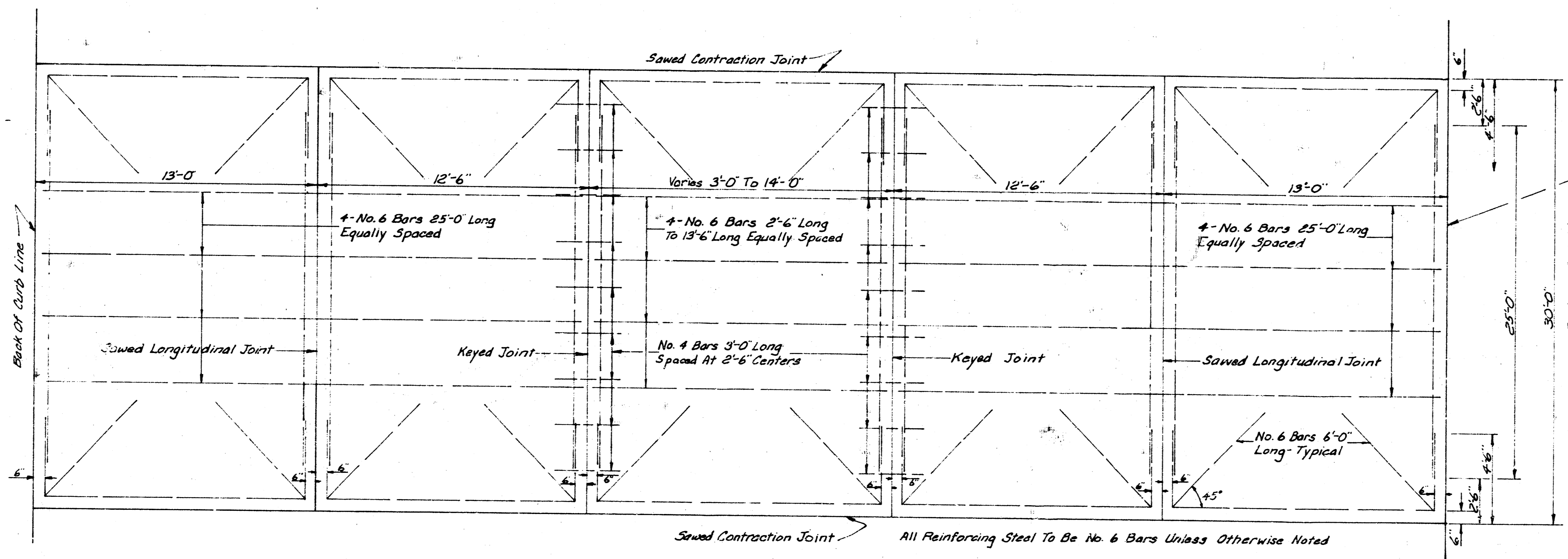

**STEEL PATTERN
STA. 1+50 TO 5+60**

EDGEMOOR DRIVE
PROJ. NO. DAKM 572015

Note: Field Engineer To Take Cross-Sections After Removal Has Been Completed. Take Cross-Sections On Plan Stationing And Other Stations Where Necessary.

NOTE TO FIELD ENGINEER & CONTRACTOR

1. EXACT LIMITS OF REMOVAL OF CONCRETE PARKING LOTS & DRIVEWAYS IS TO BE DETERMINED BY THE FIELD ENGINEER.
2. CONTRACTOR IS TO CONTACT PROPERTY OWNERS & GET THEIR PERMISSION TO WORK ON PRIVATE PROPERTY BEFORE ANY WORK IS STARTED ON PRIVATE PROPERTY.
3. DRIVEWAY WIDTHS & LOCATIONS SHOWN ARE FOR INFORMATION ONLY. CONTRACTOR IS TO CONTACT PROPERTY OWNERS FOR EXACT LOCATIONS AND WIDTHS OF DRIVEWAYS.
4. NO DRIVE SHALL HAVE AN OPENING GREATER THAN 40' FROM END OF RAMP TO END OF RAMP UNLESS OTHERWISE APPROVED BY THE FIELD ENGINEER.

P.I. ELEV.
153.15
NO V.C.

B.M. 163.83 N.E. cor. conc. porch Ho. M.E. Cor. Orme & Edgemoor.
165.53 (2) N.W. cor. 3'x3' conc. base for sign S.E. cor. Kellogg & Edgemoor.
Base Line = S.E. & 75' N.W. E. Edgemoor Dr.
-0.7119%

P.I. ELEV.
162.40
NO V.C.

+0.2508%

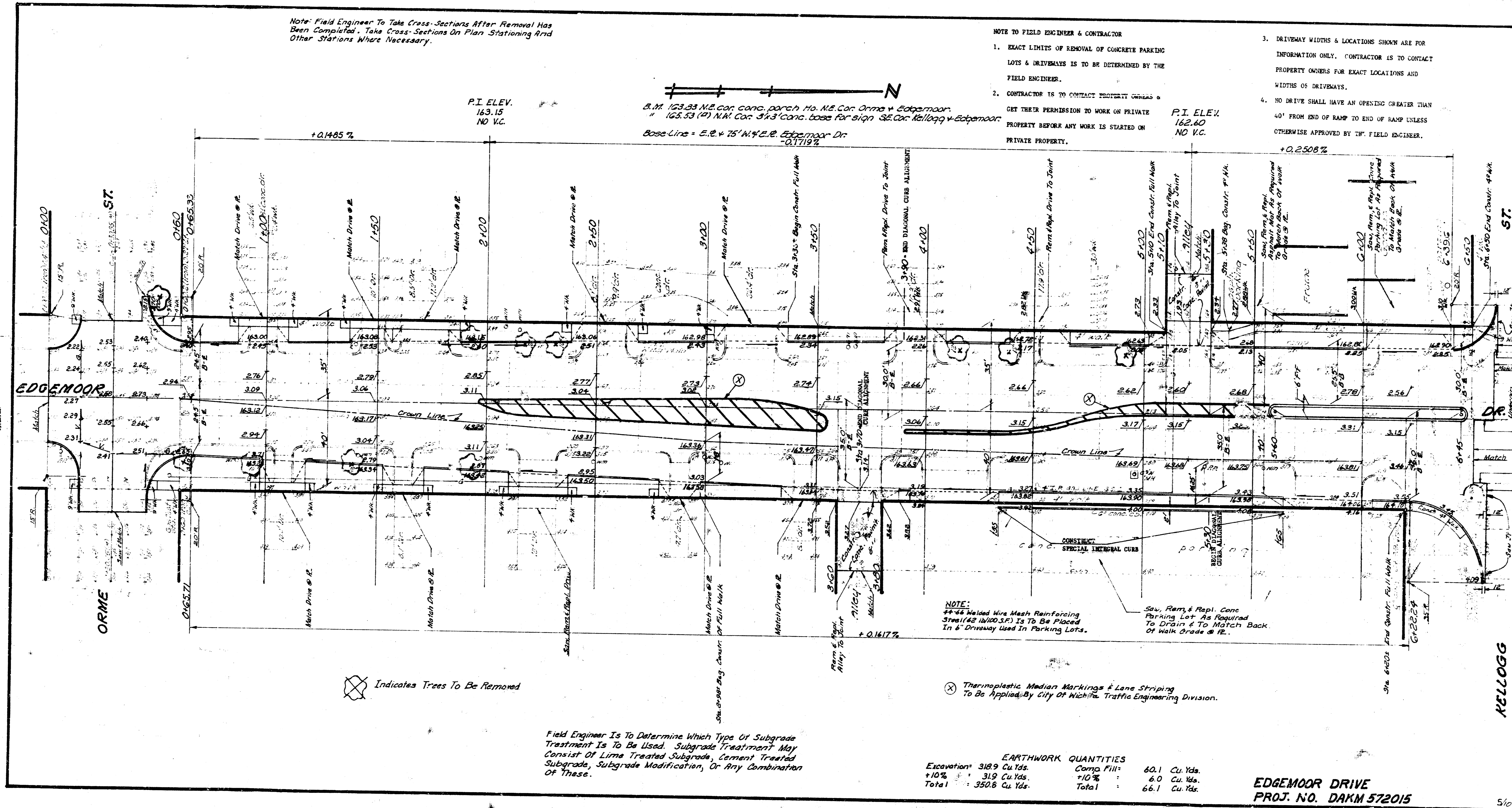

⊗ Indicates Trees To Be Removed

NOTE:
#4 Welded Wire Mesh Reinforcing Steel (42 lb/100 S.F.) Is To Be Placed In & Driveway Used In Parking Lots.
Saw, Rem. & Repl. Conc. Parking Lot As Required To Drain & To Match Back Of Walk Grade @ I.E.

⊗ Thermoplastic Median Markings & Lane Striping To Be Applied By City Of Wash. Traffic Engineering Division.

Field Engineer Is To Determine Which Type Of Subgrade Treatment Is To Be Used. Subgrade Treatment May Consist Of Lime Treated Subgrade, Cement Treated Subgrade, Subgrade Modification, Or Any Combination Of These.

EARTHWORK QUANTITIES	
Excavation: 318.9 Cu. Yds.	Comp. Fill: 60.1 Cu. Yds.
+10% : 319 Cu. Yds.	+10% : 6.0 Cu. Yds.
Total : 350.8 Cu. Yds.	Total : 66.1 Cu. Yds.

EDGEMOOR DRIVE
PROJ. NO. DAKM 572015

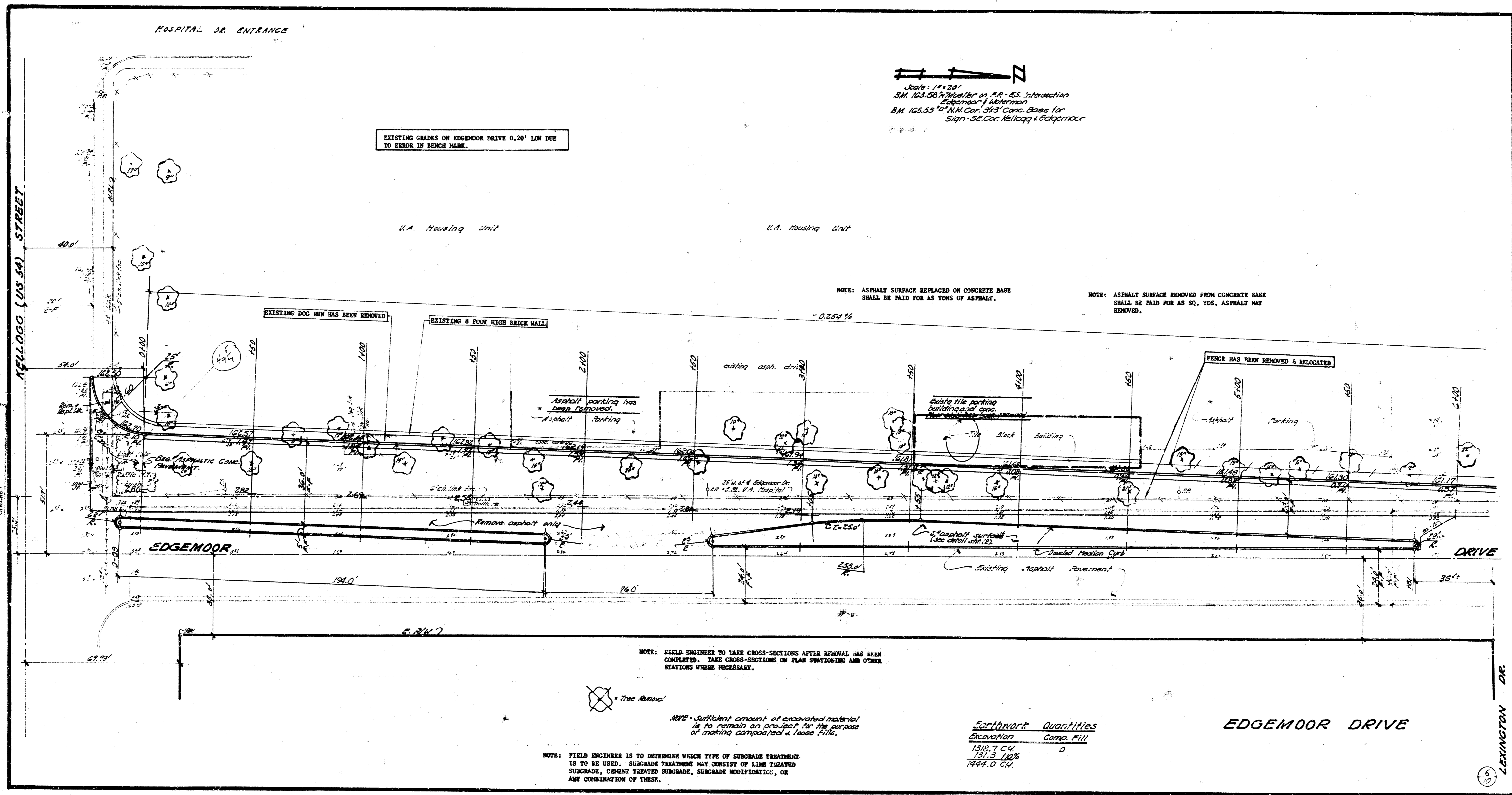

Scale: 1"=20'
 S.M. 103.58' Intersect on P.D. Intersection
 Edgemoor & Lexington
 B.M. 105.53' N.N. Cor. 313' Conc. Base for
 Sign - SE. Cor. Kellogg & Edgemoor

EXISTING GRADES ON EDGE MOOR DRIVE 0.20' LOW DUE TO ERROR IN BENCH MARK.

NOTE: ASPHALT SURFACE REPLACED ON CONCRETE BASE SHALL BE PAID FOR AS TONS OF ASPHALT.

NOTE: ASPHALT SURFACE REMOVED FROM CONCRETE BASE SHALL BE PAID FOR AS SQ. YDS. ASPHALT NOT REMOVED.

NOTE: FIELD ENGINEER TO TAKE CROSS-SECTIONS AFTER REMOVAL HAS BEEN COMPLETED. TAKE CROSS-SECTIONS ON PLAN STATIONING AND OTHER STATIONS WHERE NECESSARY.

Tree Retain

NOTE: Sufficient amount of excavated material is to remain on project for the purpose of meeting transportation & loose fill.

NOTE: FIELD ENGINEER IS TO DETERMINE WHICH TYPE OF SURGRADE TREATMENT IS TO BE USED. SURGRADE TREATMENT MAY CONSIST OF LIME TREATED SURGRADE, CEMENT TREATED SURGRADE, SURGRADE MODIFICATION, OR ANY COMBINATION OF THESE.

Earthwork Quantities

Excavation	Comp. Fill
1310.7 C.Y.	0
131.3 100%	
1444.0 C.Y.	

EDGE MOOR DRIVE

Survey License B-1127
 State of Missouri
 (Check)

LEXINGTON DR.

