

BM = 196.14 NE cor conc. porch Ho # 635 N Edgemoor.  
 Stationing on Center Line

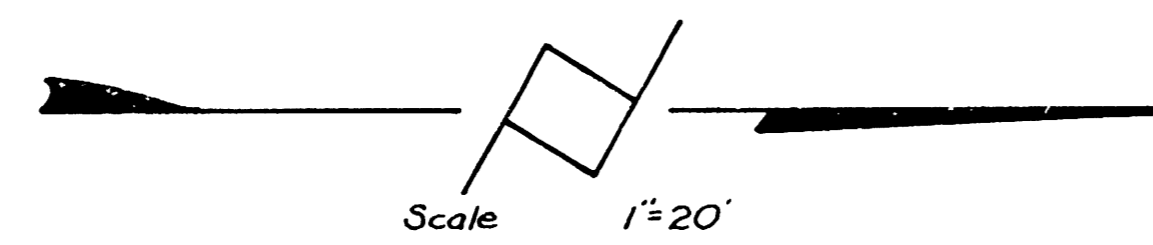

**NOTICE TO FIELD ENGINEER & CONTRACTOR:-**  
 Cross-hatched pavement to be removed and replaced to  
 grades as shown. Measure amount of pavement removed.

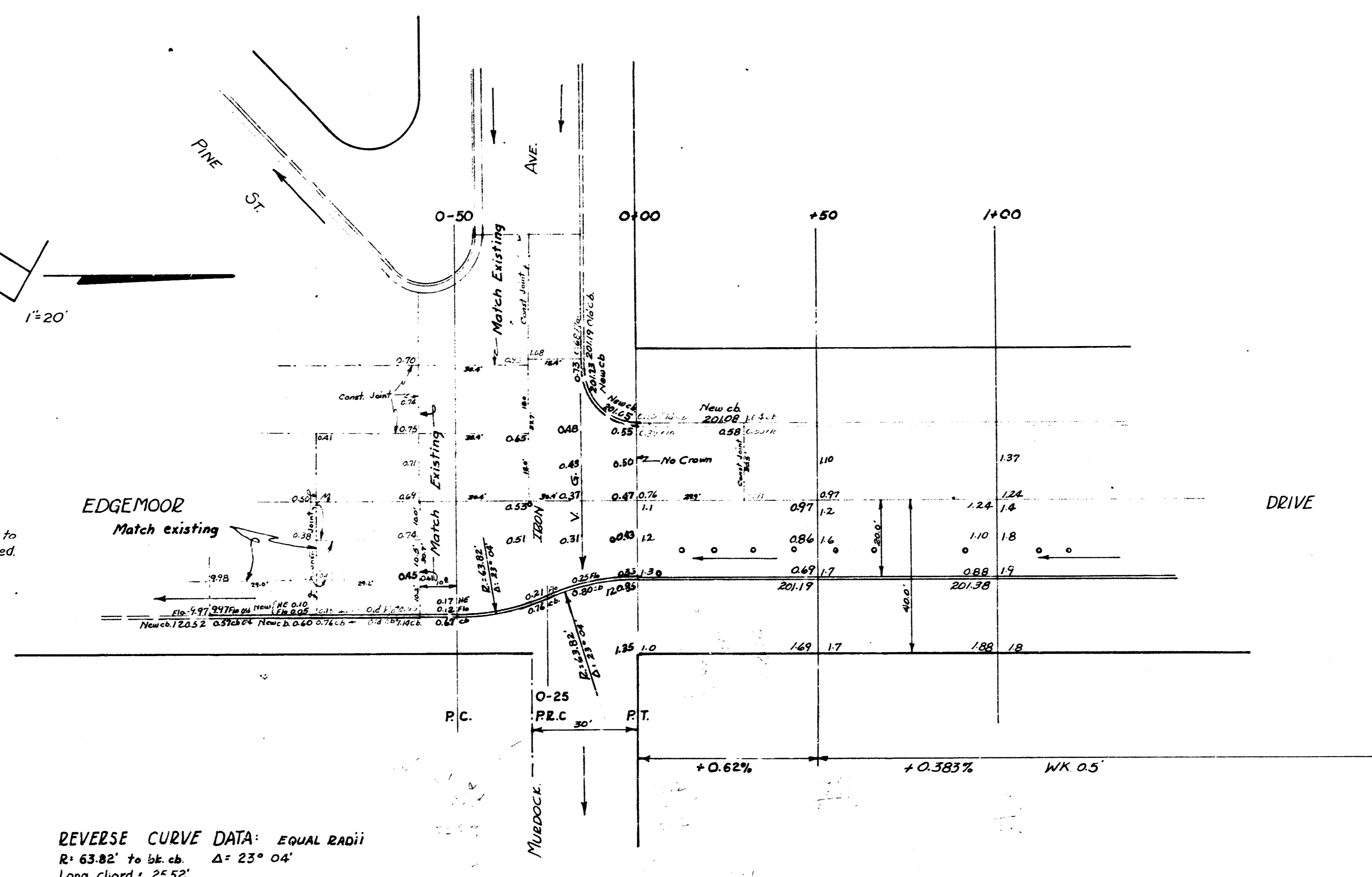

REVERSE CURVE DATA: EQUAL RADII  
 $R = 63.82'$  to bk. cb  $\Delta = 23^\circ 04'$   
 Long chord = 25.52'

Property	Excavation	City
1410		
141		
1527		

1/3

E 1/2 Edgemoor Drive  
 SL Murdock to E 9th St  
 20' Conc. & Cb.  
 B. E. Smith City Engineer  
 Jan. 1956 Proj. No. C15-211



No. 1 Approved by 1/21/57  
 State Engineer  
 State of Missouri

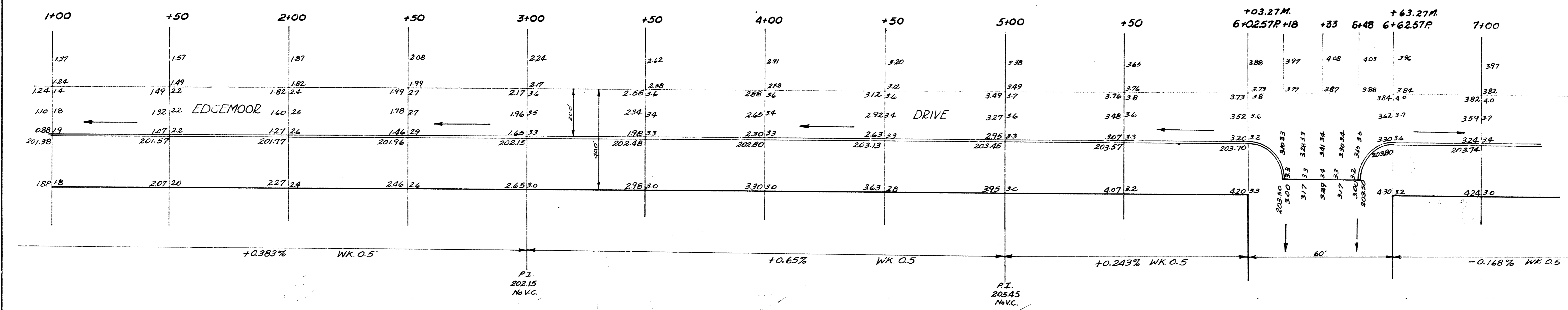
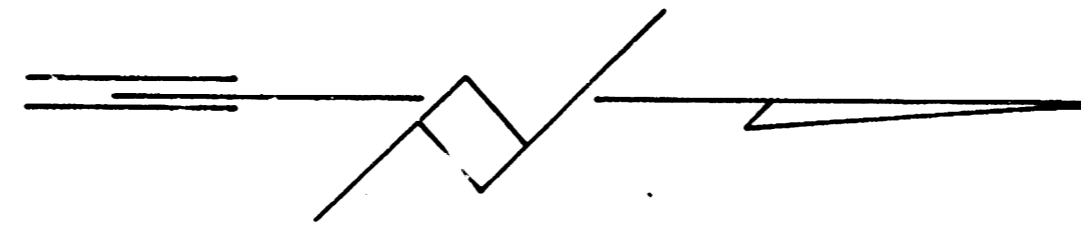

E 1/2 Edgemoor Drive  
 SL Murdock to E 9th St  
 20' Conc. & Cb.  
 B.E. Smith City Engineer  
 Jan. 1955 Proj. No. C15-211

