

Survey DRH
Plan RAH 5/80
EJO
Checked

EISENHOWER AVENUE From S.L. Airport Industrial Park to S.L. Harry

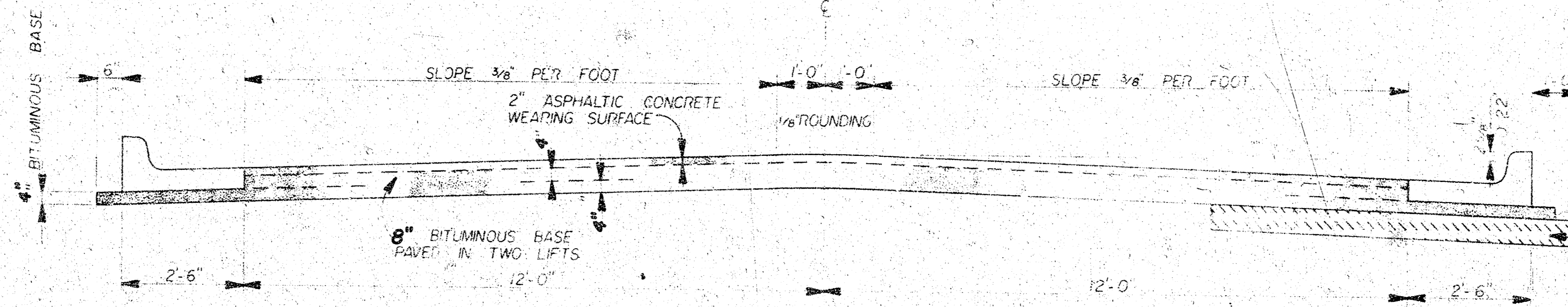

- GENERAL NOTES**
- 1) ENGINEER SHALL TAKE TIES TO ALL IRONS AND THIMBLES THAT MAY BE DESTROYED AND REPLACE THOSE THAT ARE DESTROYED.
 - 2) NO MORE THAN FOUR (4) DRIVES TO BE CONSTRUCTED THIS JOB.

TYPICAL SECTION

29' ASPHALTIC CONCRETE PAVEMENT WITH BITUMINOUS BASE

A TACK COAT OF EMULSIFIED ASPHALT (SS-H) SHALL BE APPLIED AT AN APPROXIMATE RATE OF 0.05 GALLONS PER SQ YD BETWEEN LIFTS OF ASPHALTIC MATERIALS WHEN ORDERED BY THE ENGINEER. TACK COAT WILL NOT BE PAID FOR DIRECTLY AND SHALL BE CONSIDERED AS SUBSIDIARY TO PRICE BID FOR ASPHALTIC PAVEMENT.

BITUMINOUS BASE AND ASPHALTIC CONCRETE WEARING SURFACE SHALL BE PLACED WITH A LAYDOWN MACHINE HAVING AUTOMATIC CONTROLS FOR CROWN AND GRADE. CONSTRUCTION JOINTS IN EACH LIFT SHALL BE STAGGERED A MINIMUM DISTANCE OF 1' WITH JOINTS IN PRECEDING LIFTS AND SUCH THAT A JOINT WILL BE CONSTRUCTED ON THE PAVEMENT CENTERLINE IN THE TOP LIFT.

THE ASPHALTIC CONCRETE PAVEMENT BETWEEN THE COMBINED CURB & GUTTER SHALL BE PAID AS SQ YDS. 10" ASPHALTIC CONCRETE PAVEMENT (8" BITUMINOUS BASE) THE BITUMINOUS BASE UNDER THE COMBINED CURB & GUTTER SHALL BE PAID AS SQ YDS. 4" BITUMINOUS BASE.

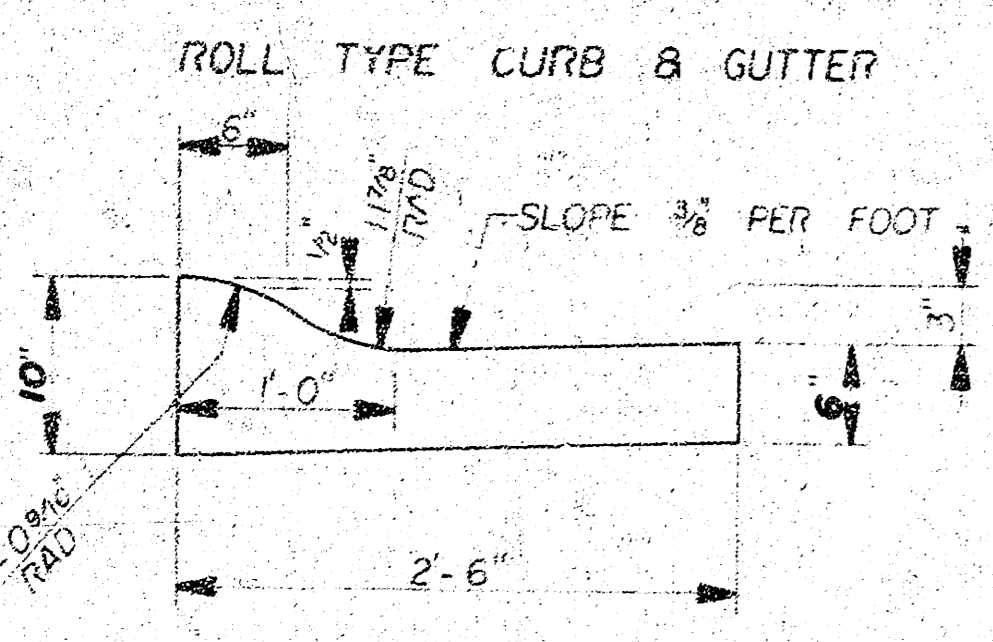
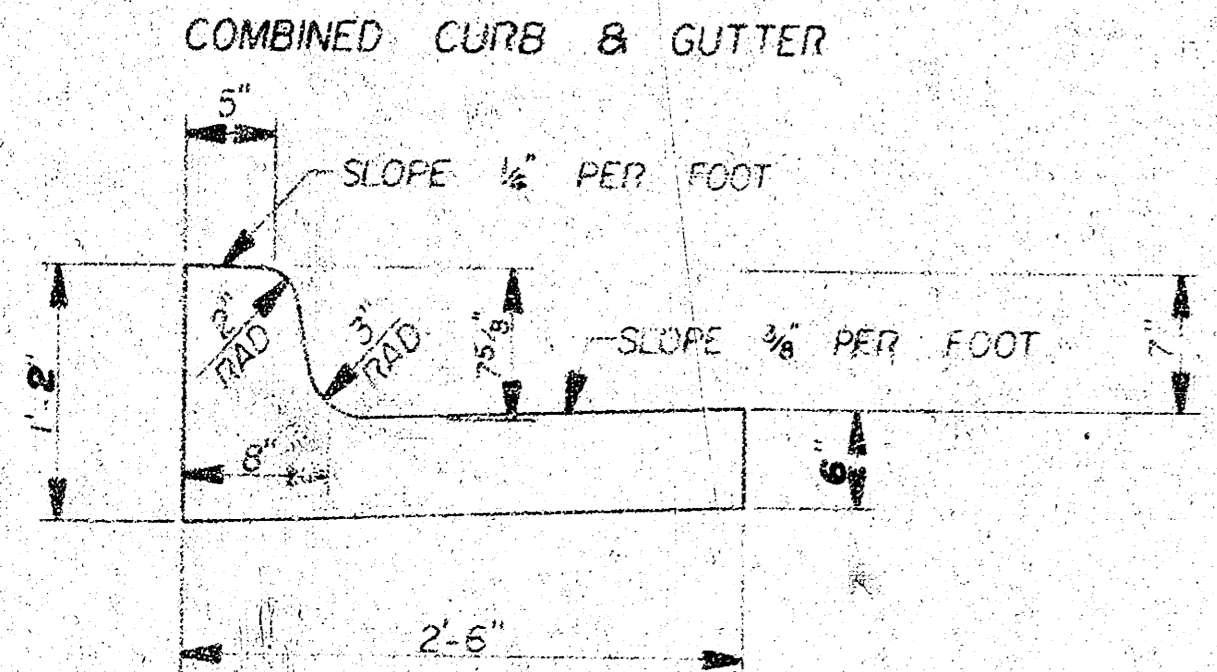

DETAIL OF TRANSVERSE CONSTRUCTION JOINTS

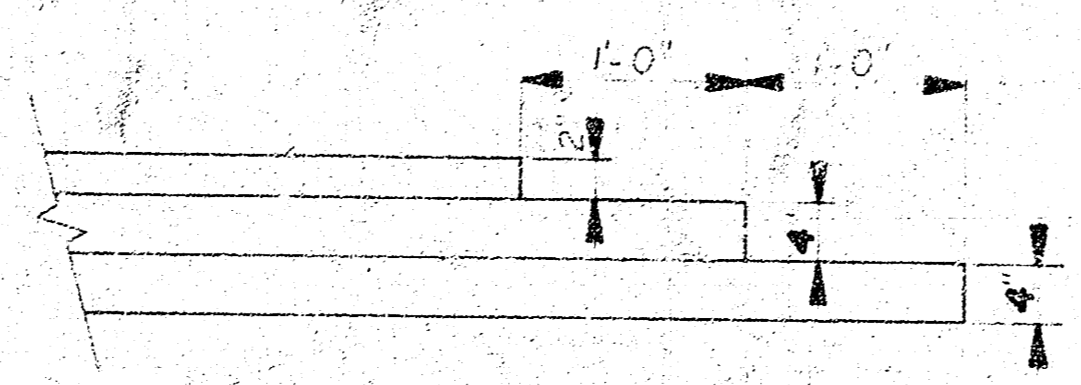

TRANSVERSE CONSTRUCTION JOINTS SHALL BE CONSTRUCTED IN FLEXIBLE BASE PAVEMENTS AT LOCATIONS WHERE PAVEMENT TEMPORARILY ENDS TO FACILITATE FUTURE PAVEMENT CONSTRUCTION AS SHOWN BY DETAIL. THE COST OF CONSTRUCTING THE TRANSVERSE CONSTRUCTION JOINTS SHALL NOT BE MEASURED OR PAID FOR DIRECTLY, BUT SHALL BE INCLUDED IN THE BID PRICE FOR SQ YDS OF ASPHALTIC CONCRETE PAVEMENT.

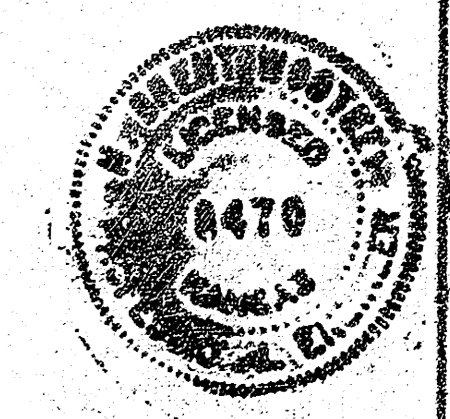

CITY OF WICHITA, KANSAS
DEPARTMENT OF PUBLIC WORKS - ENGINEERING
DEAN SELLERS CITY ENGINEER
DATE MAY 1980 PROJ. NO. 472-76-245-80915-000-000-001

FILMED FROM THE BEST AVAILABLE COPY.....

B.M. El. 111.75 R.R. Spk. E-side PP Sta. 0+51.22
 B.M. El. 113.80 R.R. Spk. E-side PP Sta. 3+23
 Baseline is @ Eisenhower

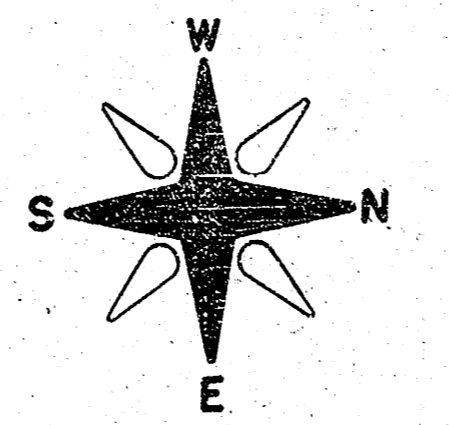

CAUTION
 UNDERGROUND
 UTILITIES
 BE CAREFUL
 TO AVOID THEM

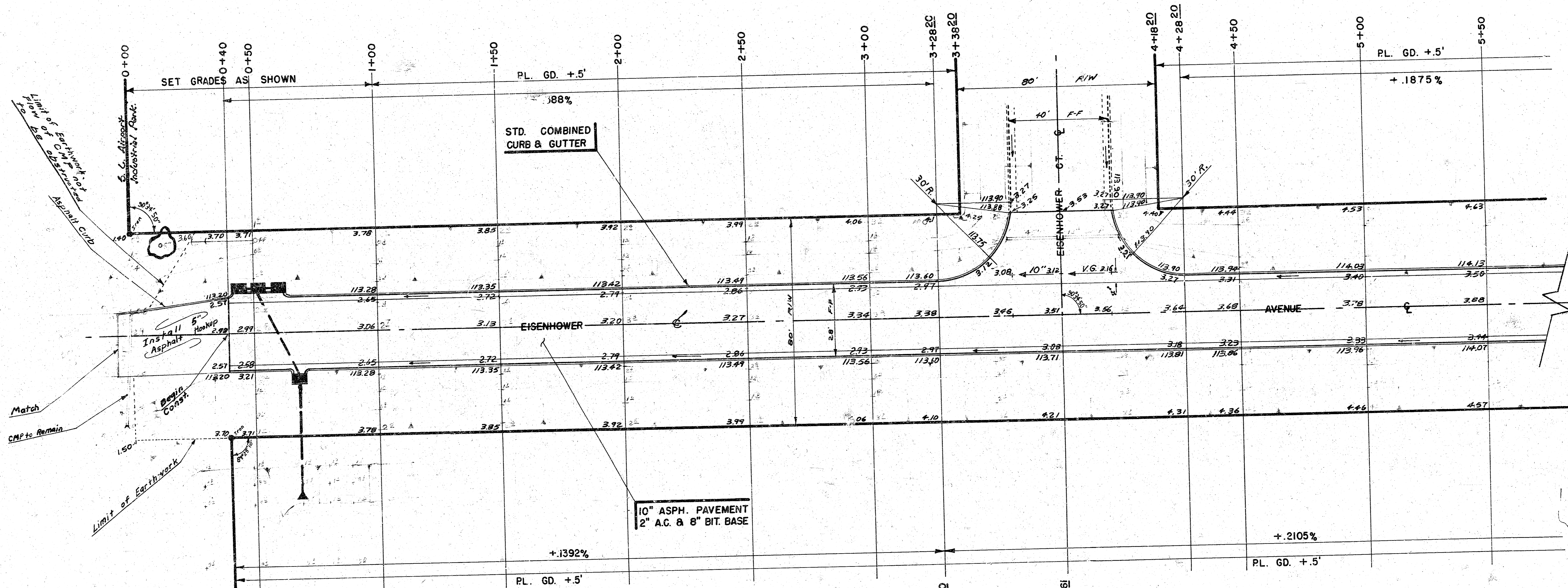

Property		Earthwork		City	
Excavation	2134.4	Excavation	1476.6	Excavation	1476.6
+10%	213.4	+10%	147.7	+10%	147.7
Total	2347.8 C.Y.	Total	1624.3 C.Y.	Total	1624.3 C.Y.
Borrow	1625.3	Borrow	2095.8	Borrow	2095.8
+10%	162.5	+10%	209.6	+10%	209.6
Total	1787.8 C.Y.	Total	2305.4 C.Y.	Total	2305.4 C.Y.
Manipulation	5514.2 S.Y.	Manipulation	3825 S.Y.	Manipulation	3825 S.Y.

SUB-GRADE
 TYPE OF SUB-GRADE TREATMENT SHALL BE DETERMINED BY THE FIELD ENGINEER. SUB-GRADE TREATMENT MAY CONSIST OF LIME TREATMENT, CEMENT TREATMENT, SUB-GRADE MODIFICATION, OR ANY COMBINATION OF THESE.

EISENHOWER - From S.L. Airport Industrial Park to S.L. Harry Street
 Proj. No. 472-76-245-80915-000-000-001

FILMED FROM THE BEST AVAILABLE COPY.....

BM. El. 113.84 RR Spk. E-side
 PP Sta. 8+85.25
 Baseline is Centerline Eisenhower

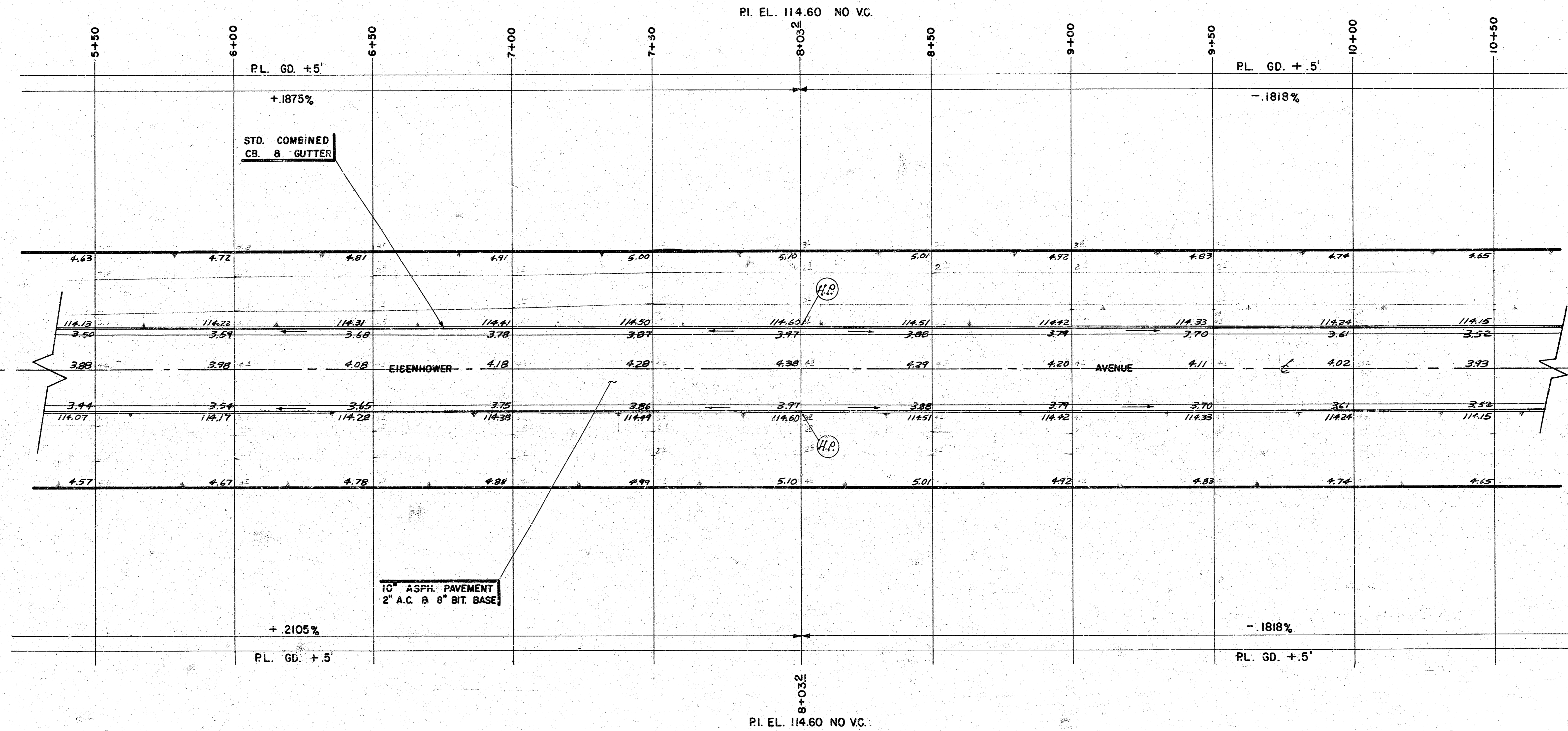
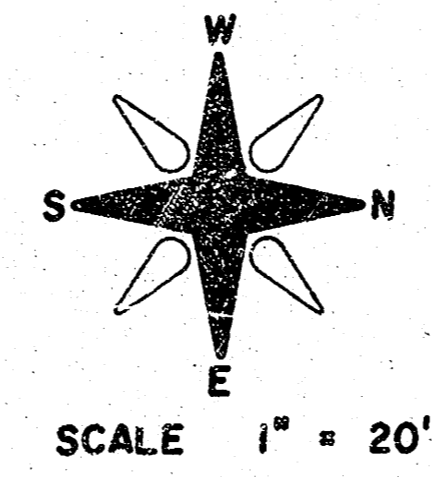

EISENHOWER - From S.L. Airport Industrial
 Park to S.L. Harry Street
 Proj. No. 472-76-245-80915-000-000-001

3/1

B.M. El. 114.75 RR. Spk. E-side PP Sta. 14+00.00
 Baseline is Centerline Eisenhower

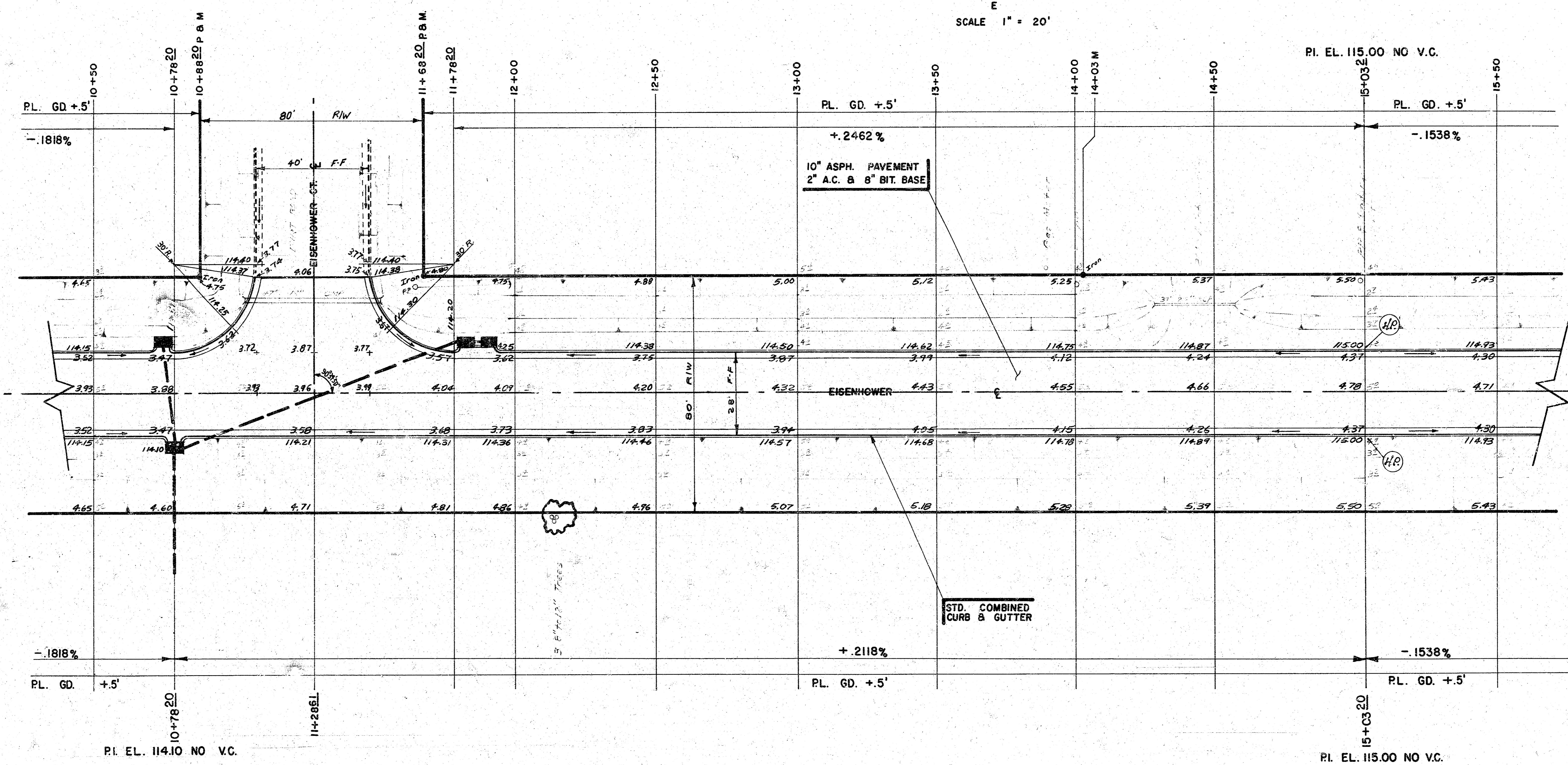
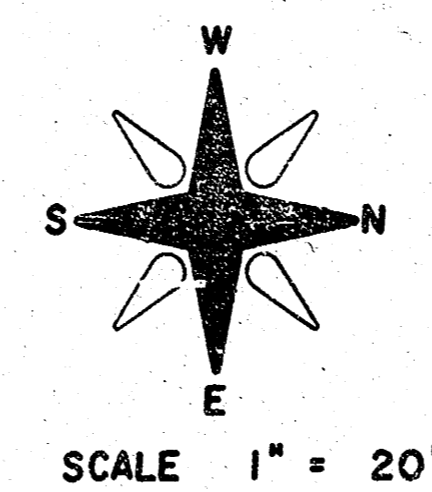

EISENHOWER - From S.L. Airport Industrial
 Park to S.L. Harry Street
 Proj. No. 472-76-245-80915-000-001

FILMED FROM THE BEST
 AVAILABLE COPY.....

B.M. EL 114.03 RR. Spk. E-side PP Sta. 20+25.42
 Baseline is Centerline Eisenhower

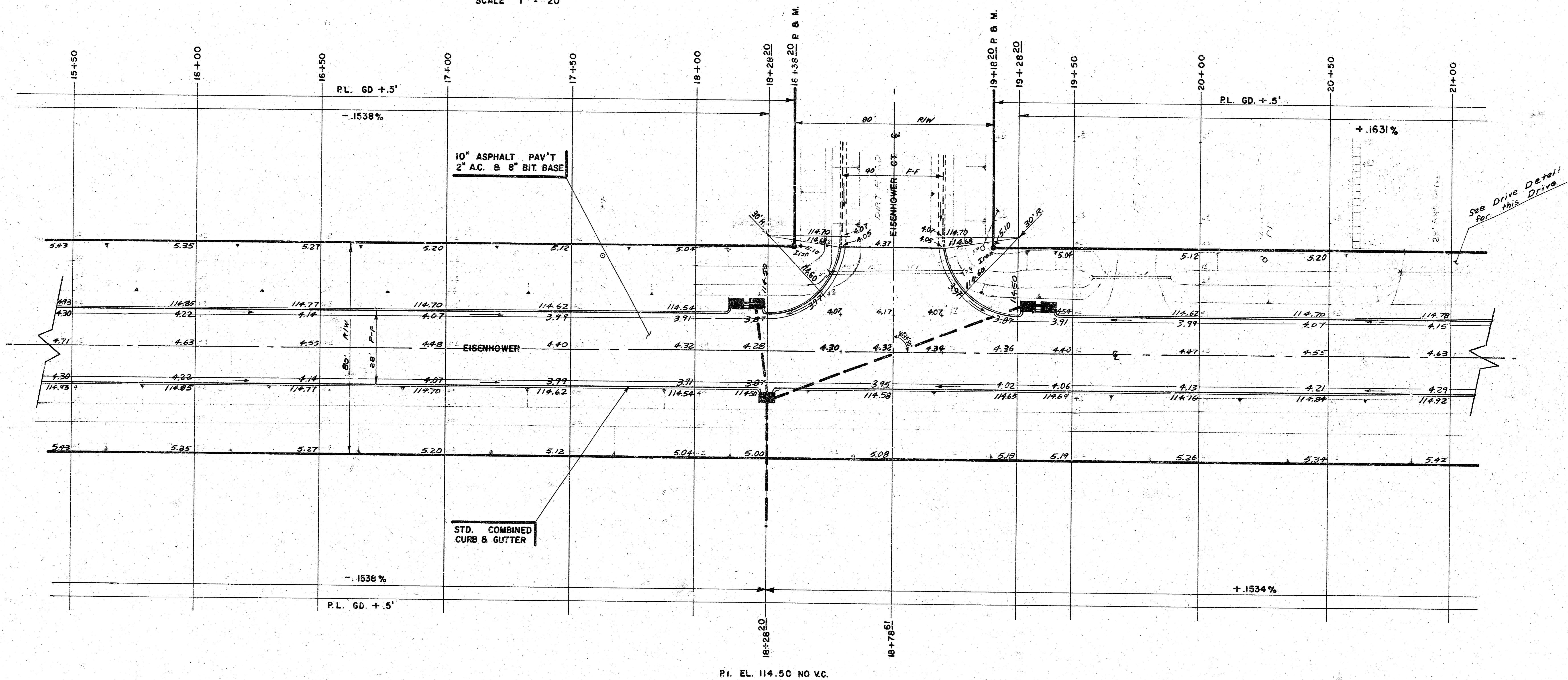
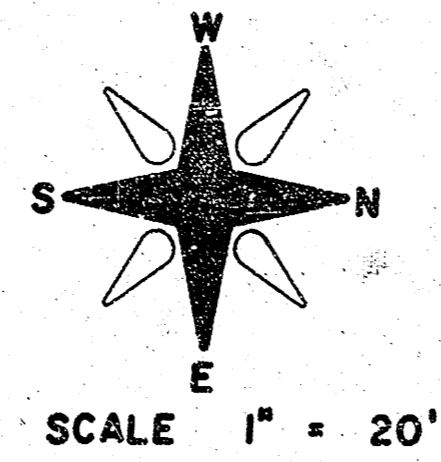

P.I. EL. 114.50 NO V.C.

EISENHOWER - From S.L. Airport Industrial
 Park to S.L. Harry Street
 Proj. No. 472-76-245-80915-000-000-001

5/9

FILMED FROM THE BEST
 AVAILABLE COPY.....

**DETAIL: DRIVES WEST SIDE EISENHOWER BETWEEN
19+18²⁰ & 25+88²⁰
SCALE 1" = 5'**

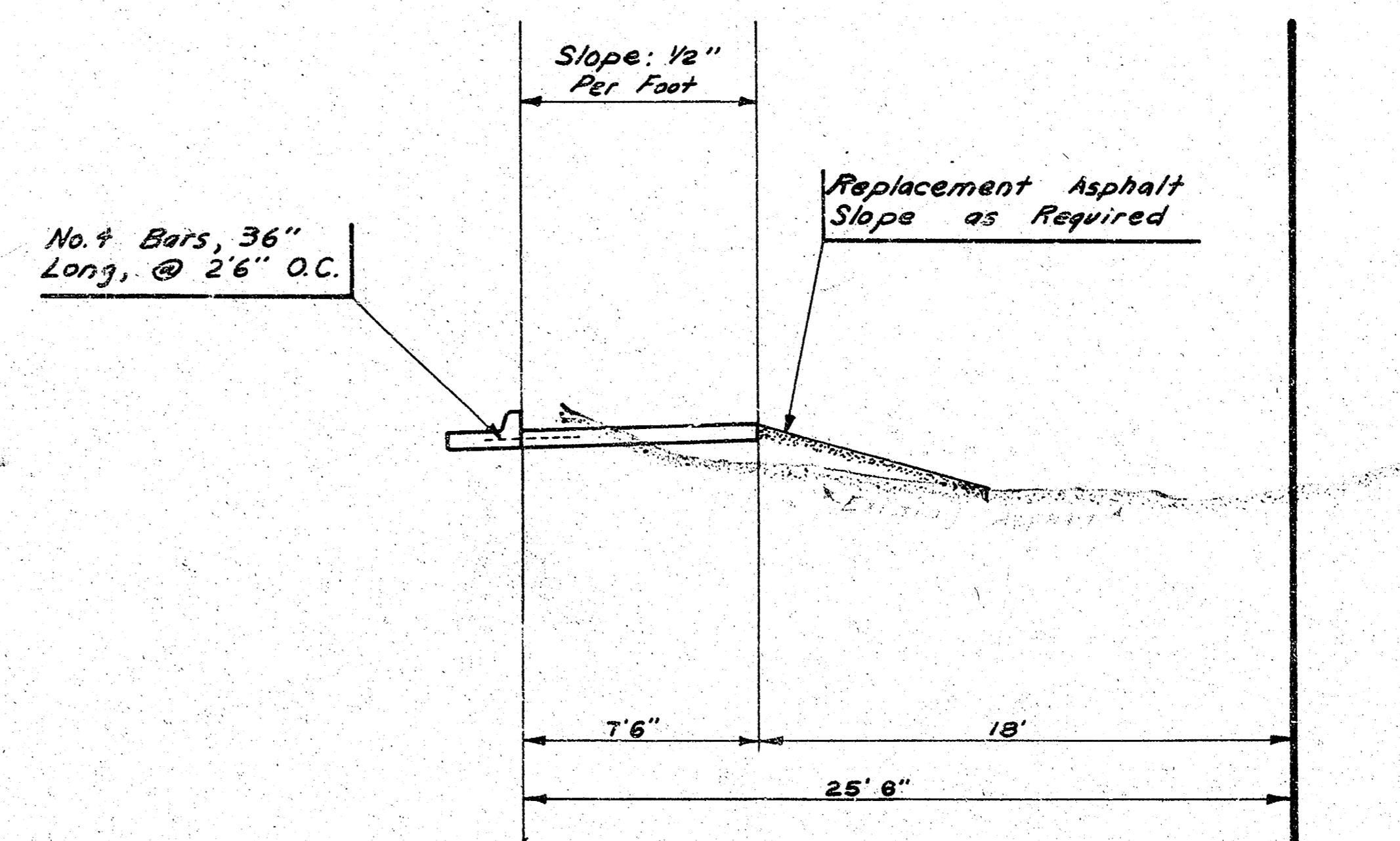

NOTE:

1. EXISTING ASPHALT DRIVES ON THE WEST SIDE OF EISENHOWER BETWEEN STATIONS 19 + 18²⁰ AND 25 + 88²⁰ SHALL BE REMOVED TO A LINE 7'6" BEHIND THE BACK OF CURB, AND IN THEIR PLACE SHALL BE CONSTRUCTED 6" CONCRETE DRIVES AS SHOWN.
2. AT THE FIELD ENGINEER'S DIRECTION, ADDITIONAL PORTIONS OF EXISTING ASPHALT DRIVES MAY BE REMOVED AS FAR BACK AS THE PROPERTY LINE AND NEW 6" ASPHALT LAYED IN THEIR PLACE, IN ORDER TO PROVIDE A SMOOTH TRANSITION BETWEEN PROPOSED CONCRETE DRIVES AND REMAINING PORTIONS OF EXISTING ASPHALT DRIVES.

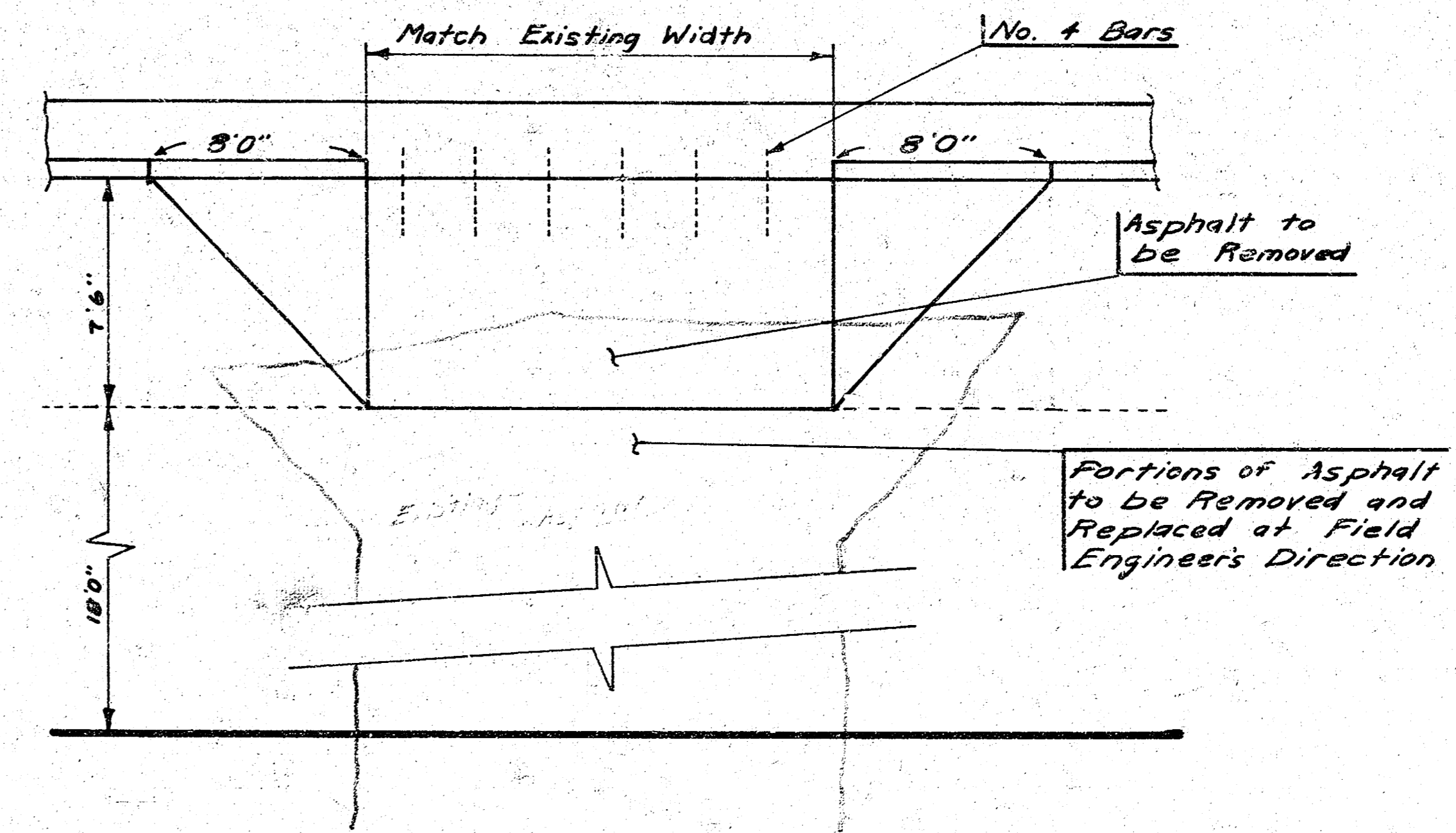

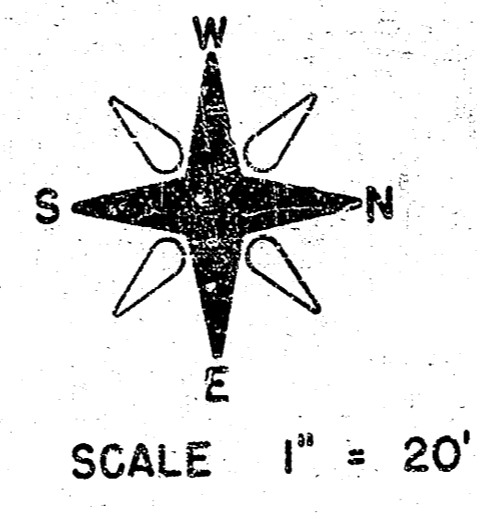
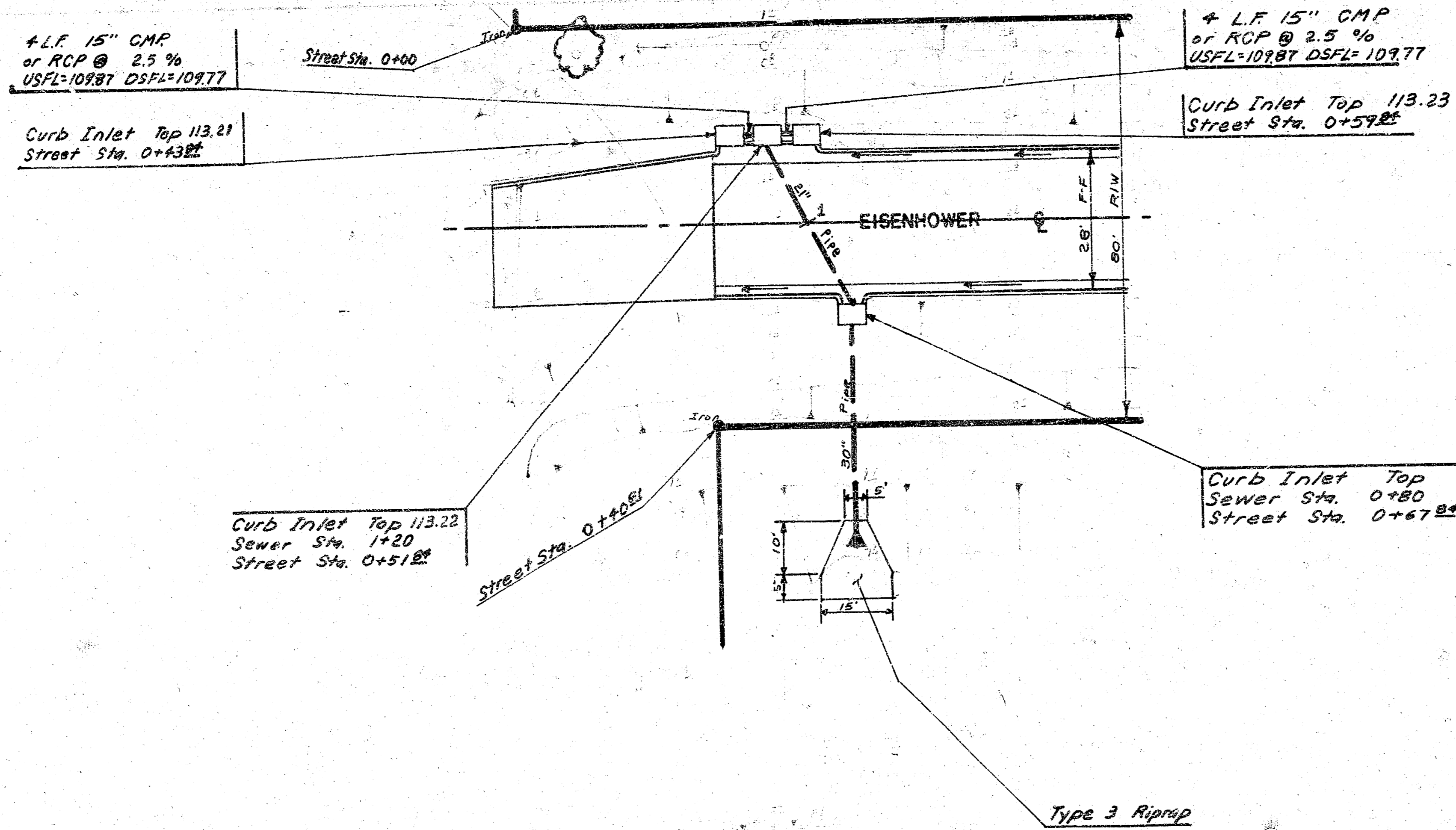

NOTE: ALL CURB INLETS CONSTRUCTED THIS PROJECT TO BE TYPE IA CURB INLETS, W= 4'2"

Line 1 Profile: Vertical Scale 1"=5' Horizontal Scale 1"=20'

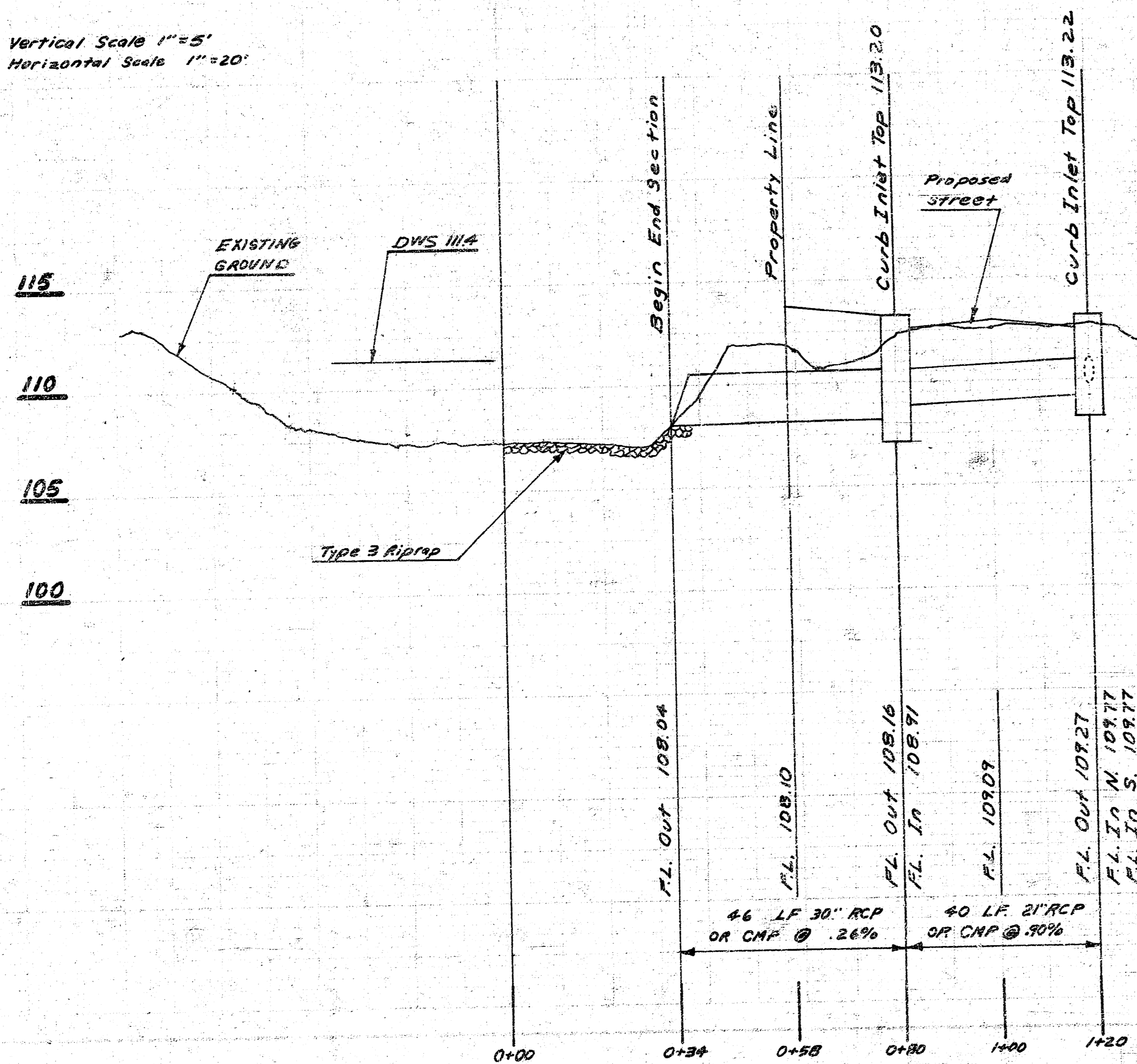

EISENHOWER-From S.L. Airport Industrial Park to S.L. Harry (INCIDENTAL DRAINAGE)
Proj. No. 472-74-245-80915-000-000-001

FILMED FROM THE BEST AVAILABLE COPY.....

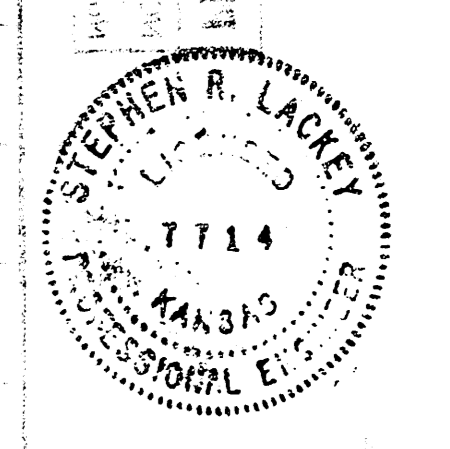
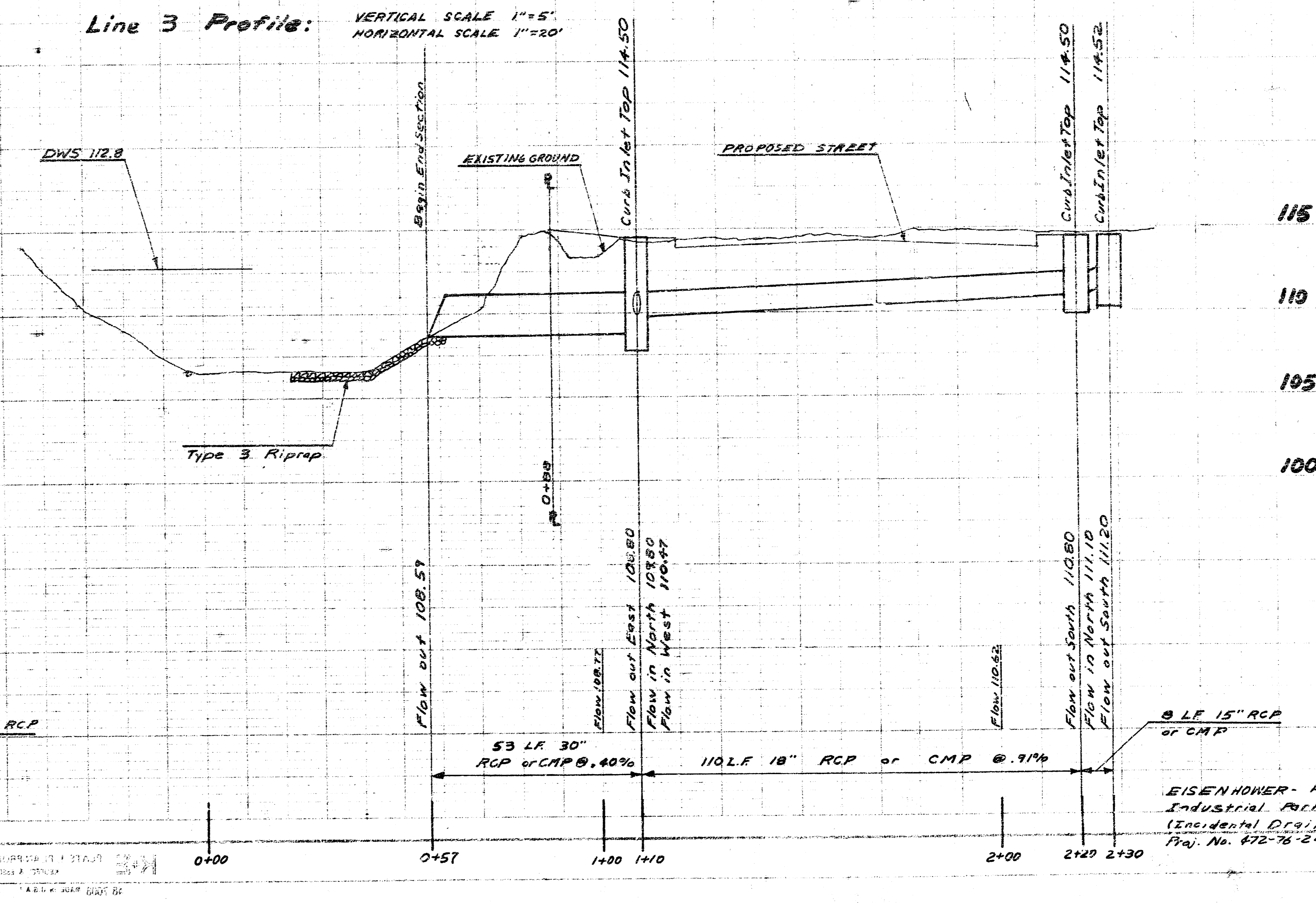
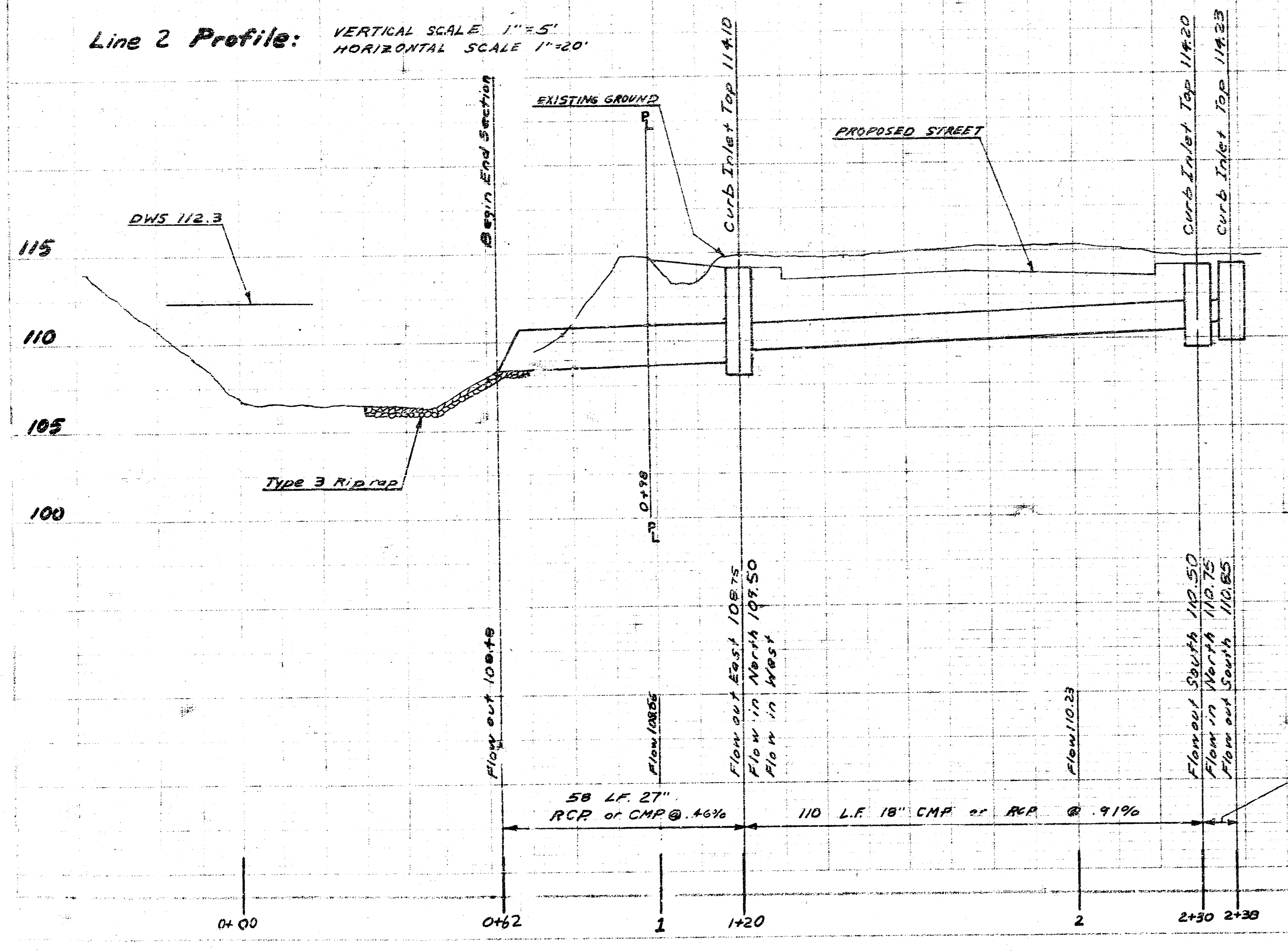
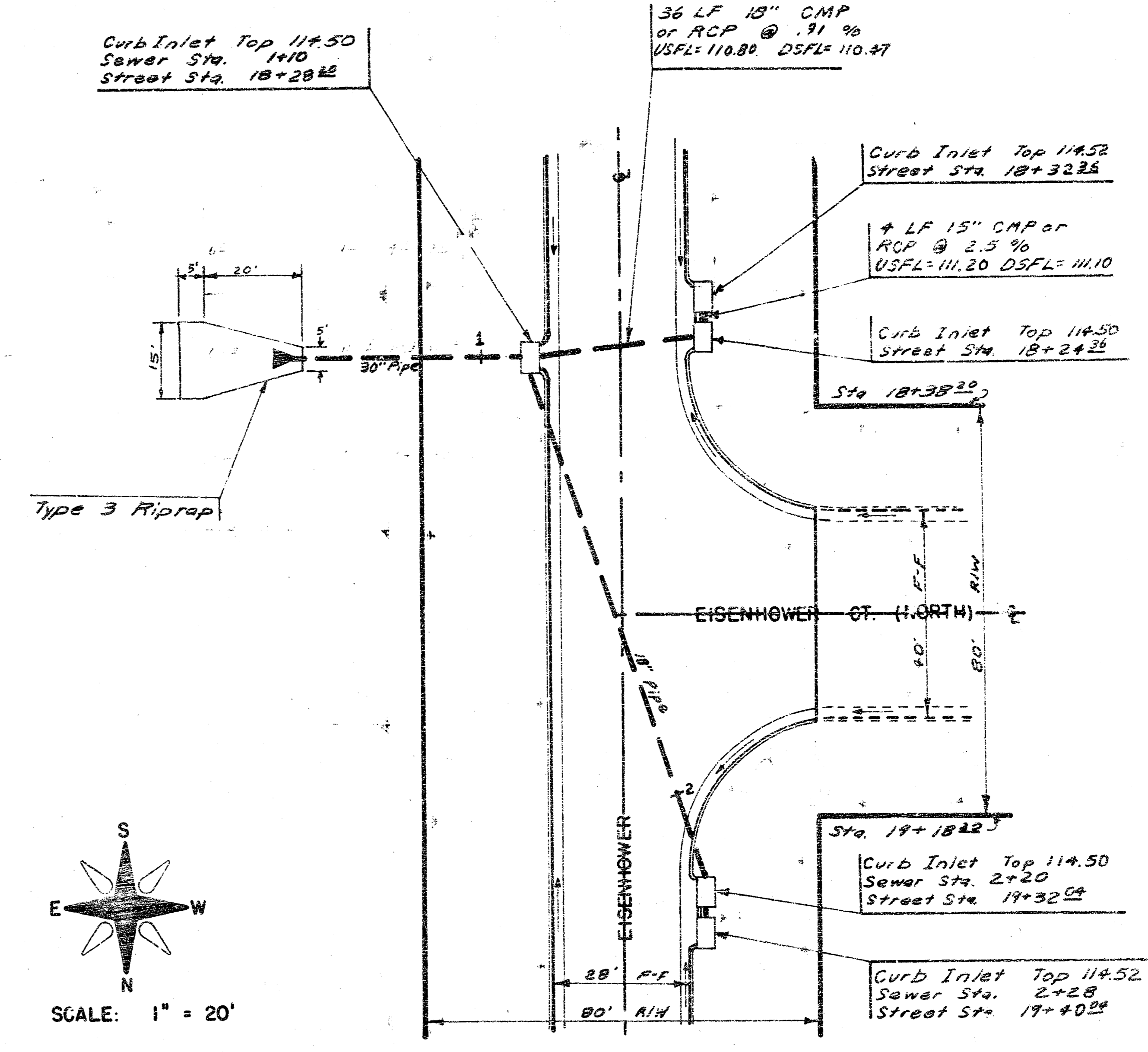
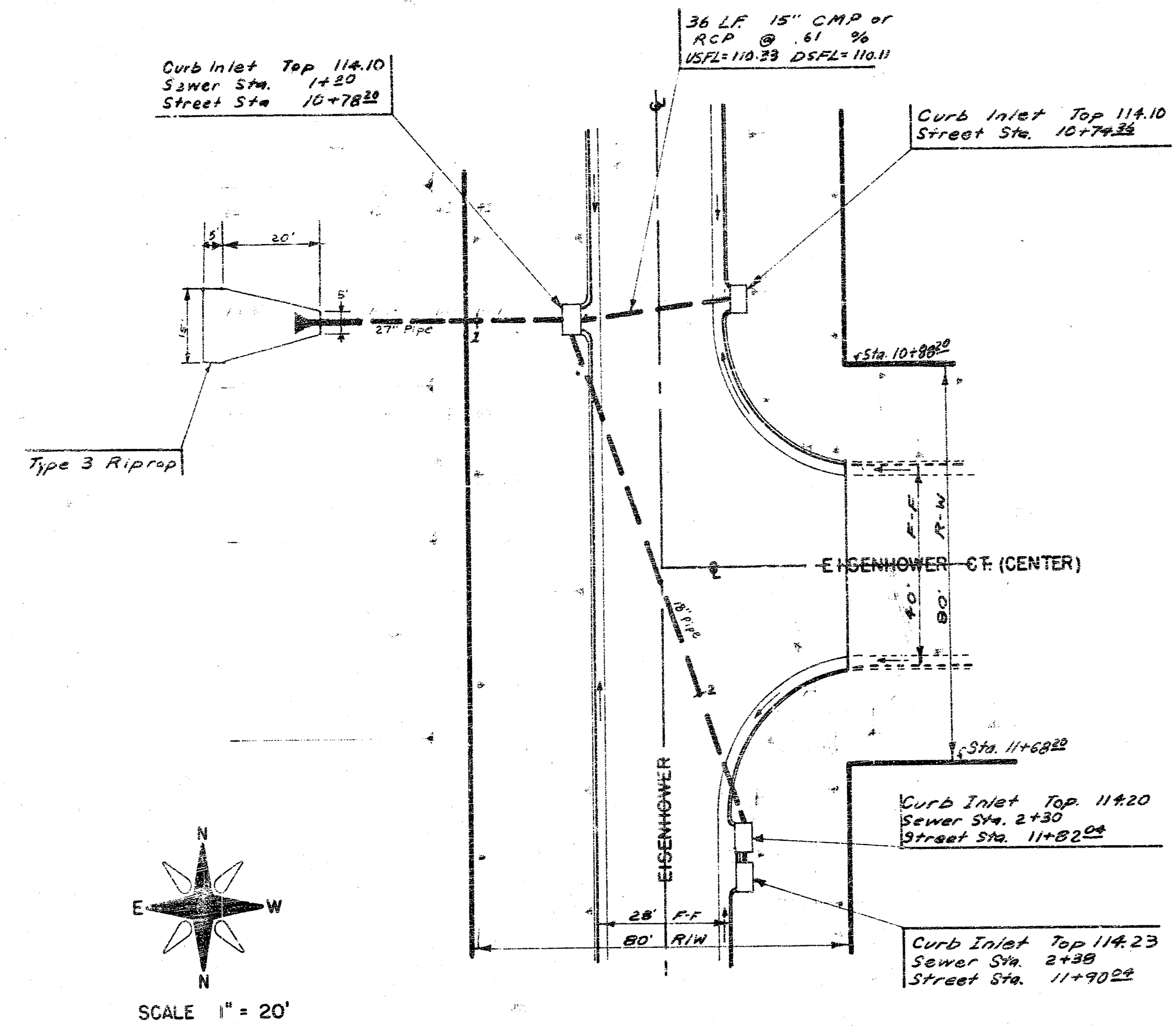

EISENHOWER - From S.L. Airport Industrial Park to S.L. Harry (Incidental Drainage)
 Proj. No. 62-76-245-80915-000-000-001

FILMED FROM THE BEST AVAILABLE COPY.....