

B.M. 130.16 City Std Top N. Hubgd. E. End Flood Control Bridge
 B.M. 118.53 S.W. Cor. Conc. Porch Ho. No. 5224 W. Maple

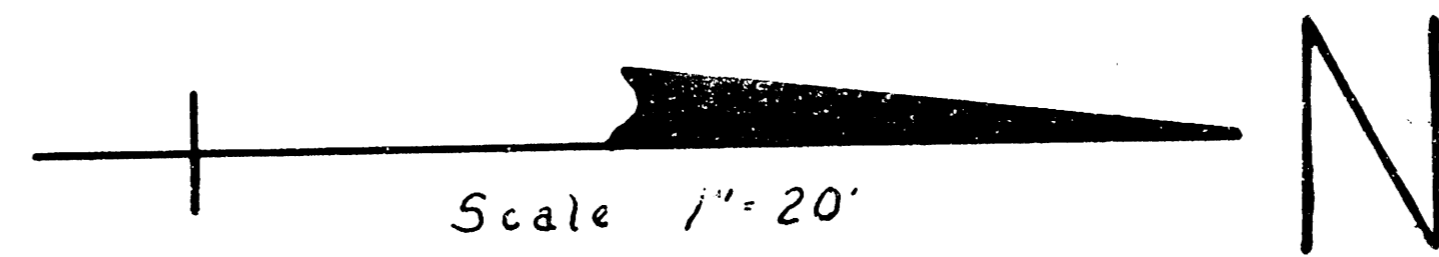

NOTE:
 Change in Steel Pattern
 See Sketch Sheet 2

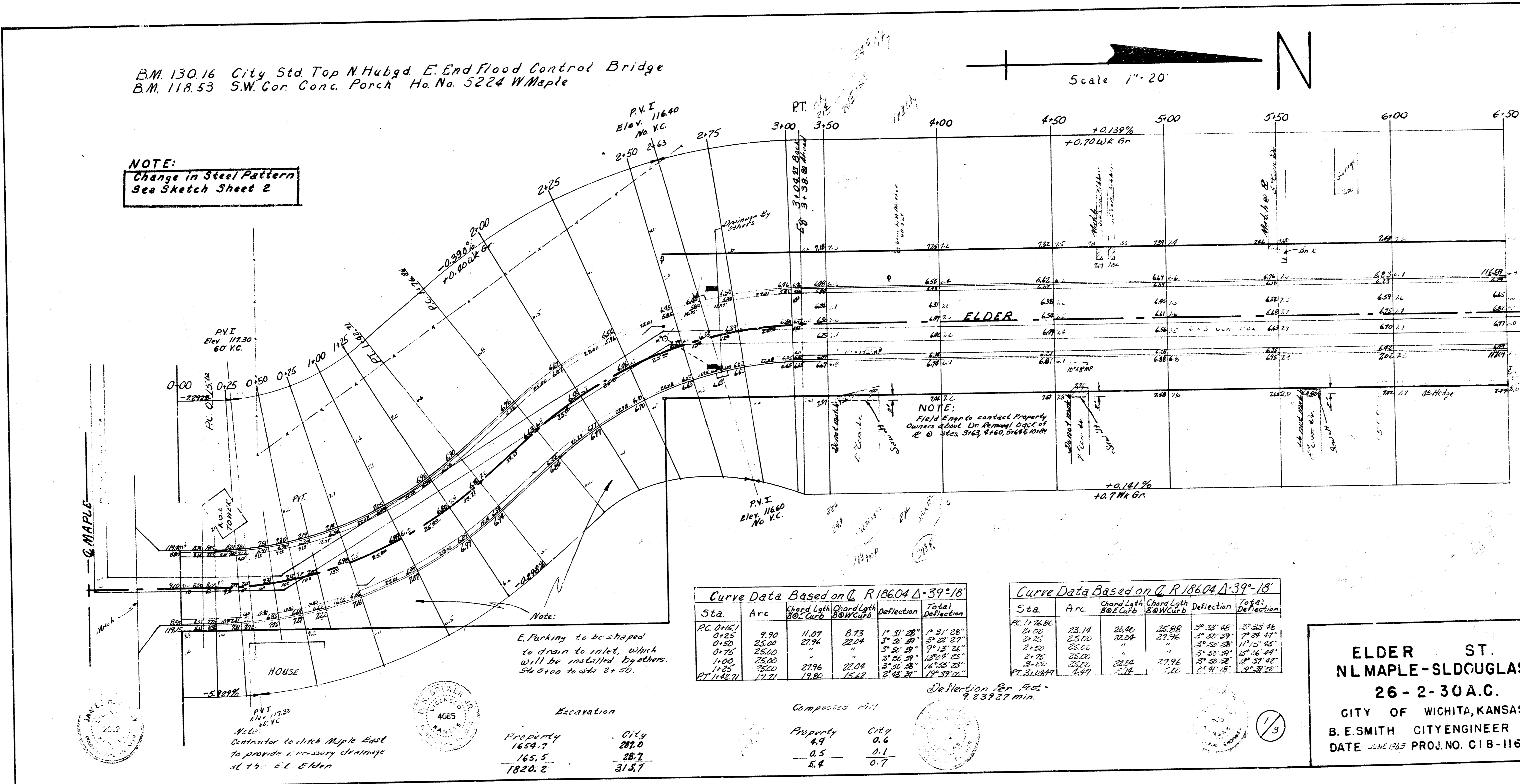

Curve Data Based on $\Delta R 186.04 \Delta 39^{\circ} 18'$

Sta	Arc	Chord Lth	Chord Lth	Deflection	Total Deflection
		80' Curve	80' Curve		
PC 0+15.1	9.90	11.07	8.73	1° 31' 28"	1° 31' 28"
0+25	25.00	27.96	21.54	5° 20' 27"	5° 20' 27"
0+50	25.00	"	"	5° 20' 27"	9° 40' 54"
0+75	25.00	"	"	5° 20' 27"	13° 01' 21"
1+00	25.00	27.96	21.54	5° 20' 27"	18° 21' 48"
1+25	25.00	"	"	5° 20' 27"	23° 42' 15"
PT 1+42.1	17.71	19.80	15.62	2° 45' 31"	26° 27' 46"

Curve Data Based on $\Delta R 186.04 \Delta 39^{\circ} 18'$

Sta	Arc	Chord Lth	Chord Lth	Deflection	Total Deflection
		80' Curve	80' Curve		
PC 1+26.6	23.14	26.40	25.88	3° 35' 45"	3° 35' 45"
0+50	25.00	27.96	27.96	5° 20' 27"	8° 56' 12"
0+75	25.00	"	"	5° 20' 27"	14° 16' 39"
1+00	25.00	27.96	27.96	5° 20' 27"	19° 37' 06"
1+25	25.00	"	"	5° 20' 27"	24° 57' 33"
PT 1+42.1	17.71	19.80	19.80	2° 45' 31"	27° 43' 04"

Note:
 E. Parking to be shaped
 to drain to inlet, which
 will be installed by others.
 Sta 0+00 to Sta 2+50.

Excavation

Property	City
1654.7	287.0
1820.2	28.7
	315.7

Compacted Fill

Property	City
4.9	0.6
0.5	0.1
5.4	0.7

ELDER ST.
N. L. MAPLE - SLDUGLAS
26-2-30 A.C.
 CITY OF WICHITA, KANSAS
 B. E. SMITH CITY ENGINEER
 DATE JUNE 1933 PROJ. NO. C18-116

