

B.M. 120.79 N.E. Cor. Conc. Ref. Wall
S.W. Cor. Elder & Third St.

B.M. 122.64 R.R. Spike W. side large
tree S.E. Cor. Elder & St. Louis

NOTE - FIELD ENGINEER: Before the
intersection of 3rd St. & Elder is staked
a straight transit line should be established
on 3rd St. from Anna to Hoover to assure
straight & continuous curb lines through
all intersections.

Scale: 1" = 20'

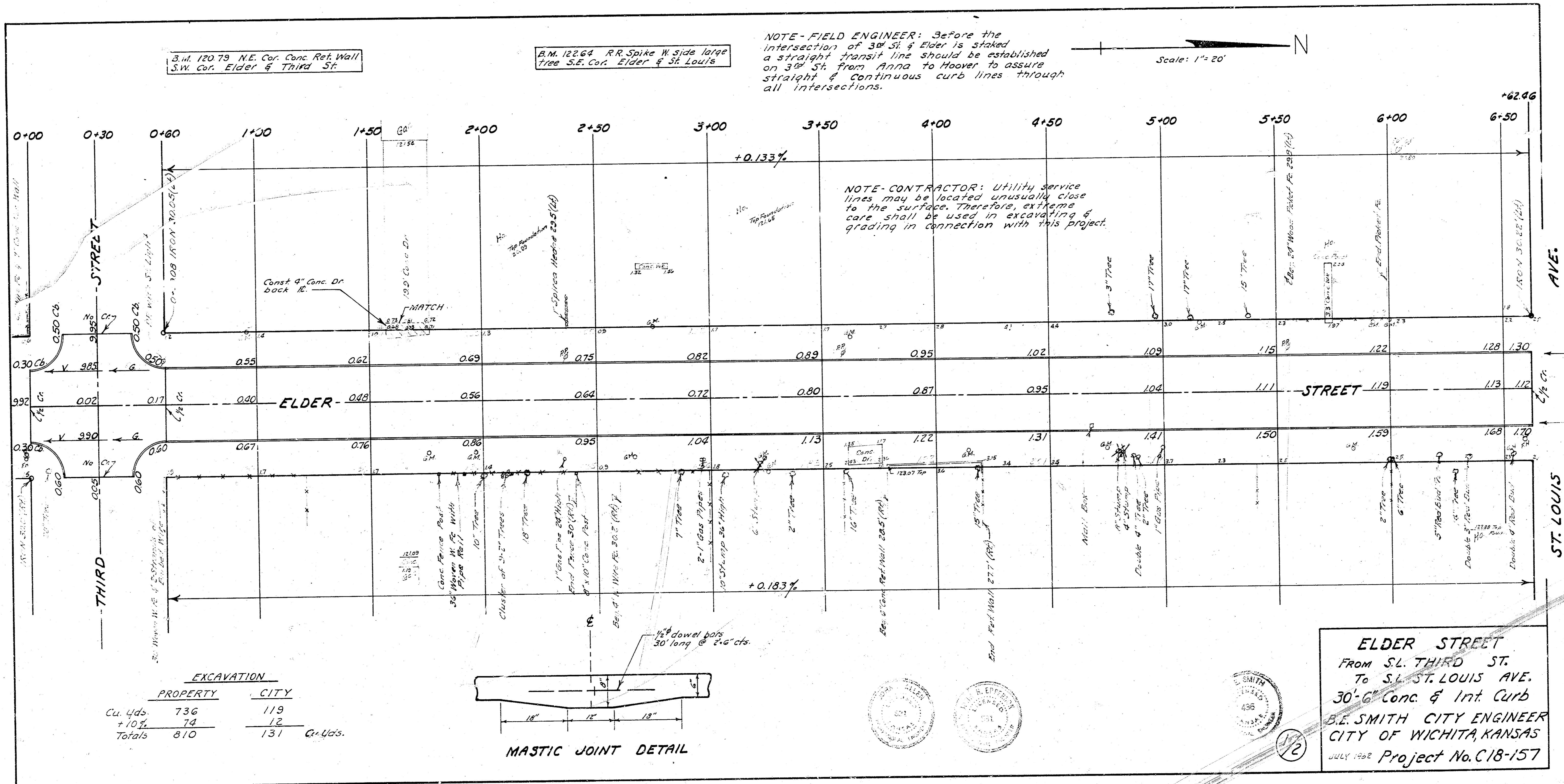

NOTE - CONTRACTOR: Utility service
lines may be located unusually close
to the surface. Therefore, extreme
care shall be used in excavating &
grading in connection with this project.

| EXCAVATION | |
|--------------|--------------|
| PROPERTY | CITY |
| Cu. Yds. 736 | 119 |
| + 10% 74 | 12 |
| Totals 810 | 131 Cu. Yds. |

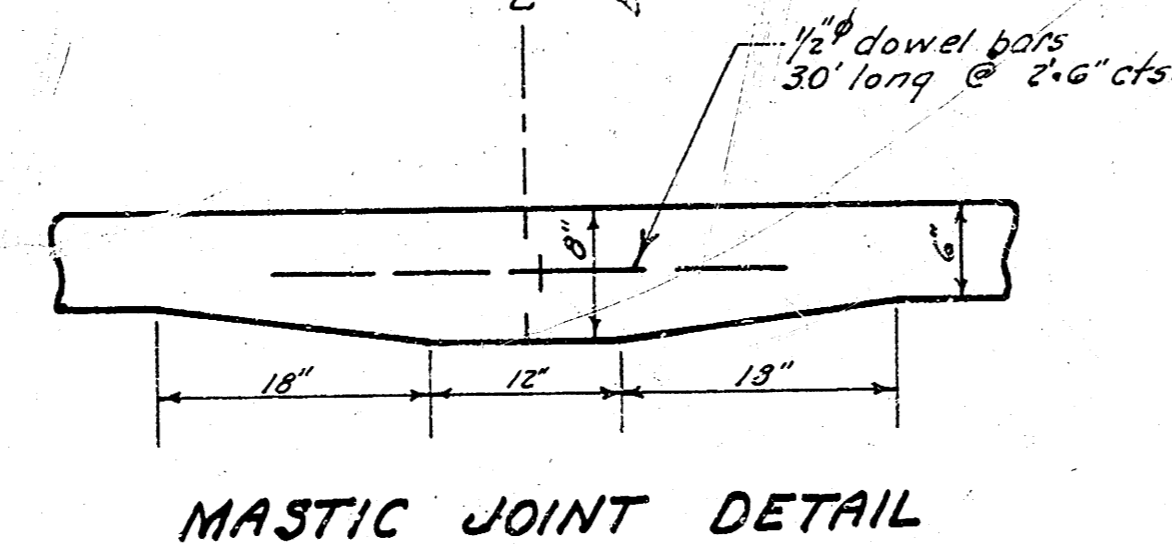

ELDER STREET
FROM S.L. THIRD ST.
TO S.L. ST. LOUIS AVE.
30" CONC. & INT. CURB
B.E. SMITH CITY ENGINEER
CITY OF WICHITA, KANSAS
JULY 1922 Project No. C18-157

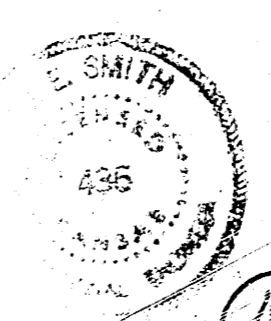
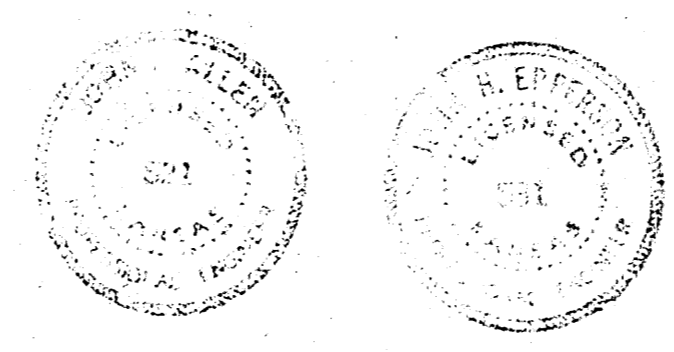

12