

B.M. 3423 N.E. COR. CONC. PAVCH. NW 3425 SO. ELIZABETH
 SIGHTING BASED ON ULL. ELIZABETH

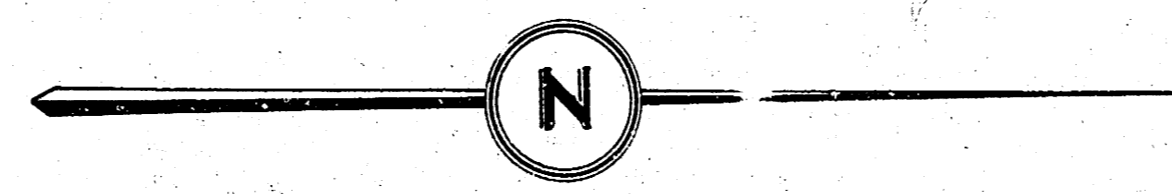

Scale 1" = 20'

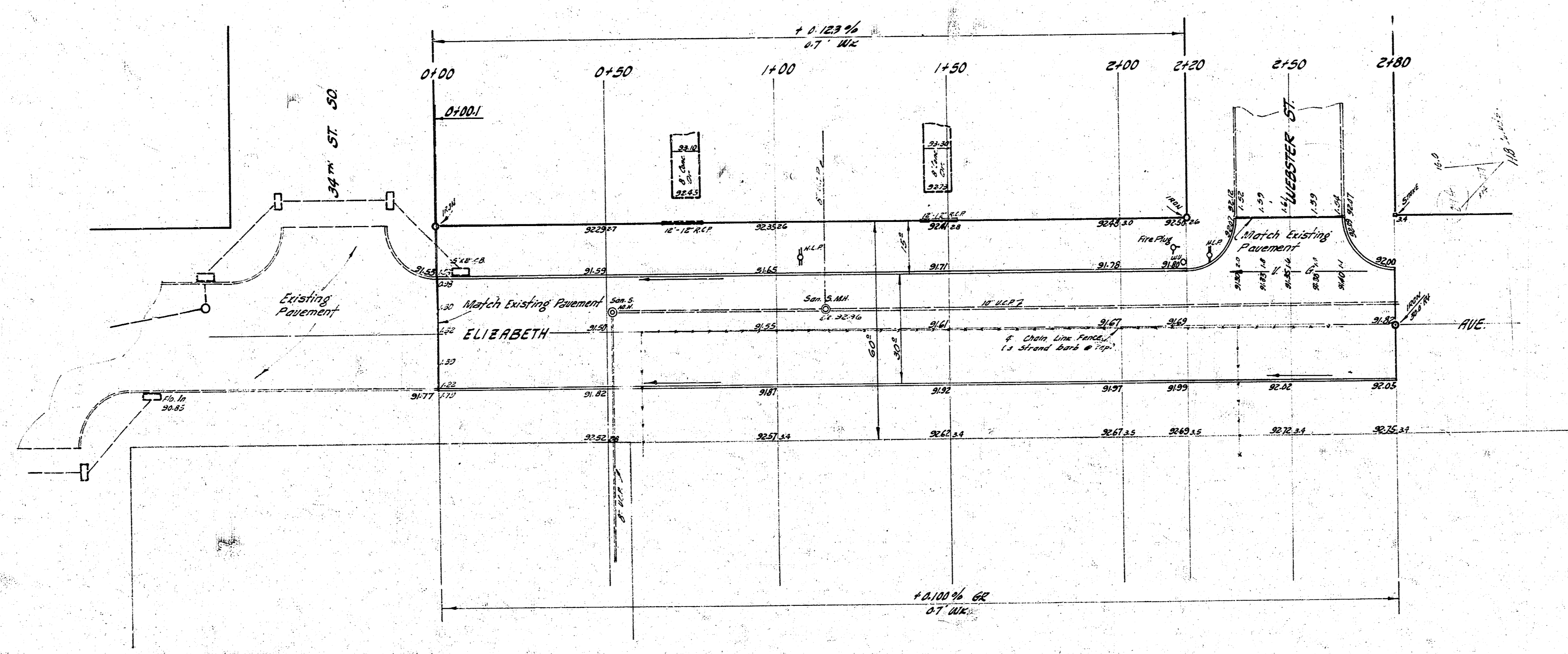

Summary of Proposed Work
 Checked by: [Signature]
 Date: [Date]

EXCAVATION		ESTIMATED COMPACTED FILL	
Feet	CU Yds.	Feet	CU Yds.
623.6	62.5	50	20.465
206.0	20.6		
826.0	83.1		

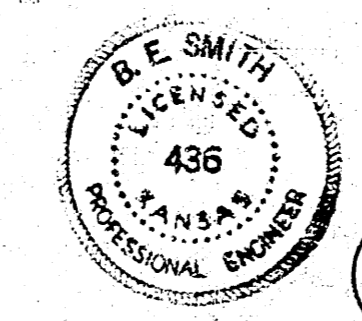

1/2

ELIZABETH AVE.
 N.E. 34TH ST. SO. TO N.E. WEBSTER ST.
 30' CONC. & CB.
 CITY OF WICHITA, KANSAS
 B.E. SMITH CITY ENGINEER
 DATE July 1941 PROJ. NO. C-13-186