

B.M. 104.90 S.E. COR. BRICK PLANTER ON S.E. COR. HOUSE #1549 ELIZABETH.
 B.M. 106.23 R.R. SPIKE, N. SIDE LARGE ELM TREE AT S.E. COR. FIGG & ELIZABETH.
 BASE LINE ON C OF ELIZABETH.

SCALE: 1" = 20'

CAUTION
 CONTRACTOR TO EXCAVATE WITH CARE OVER THE
 30" SANITARY SEWER.

S.E. SMITH
 CIVIL ENGINEER
 436
 1000 W. HARRIS
 WICHITA, KANSAS

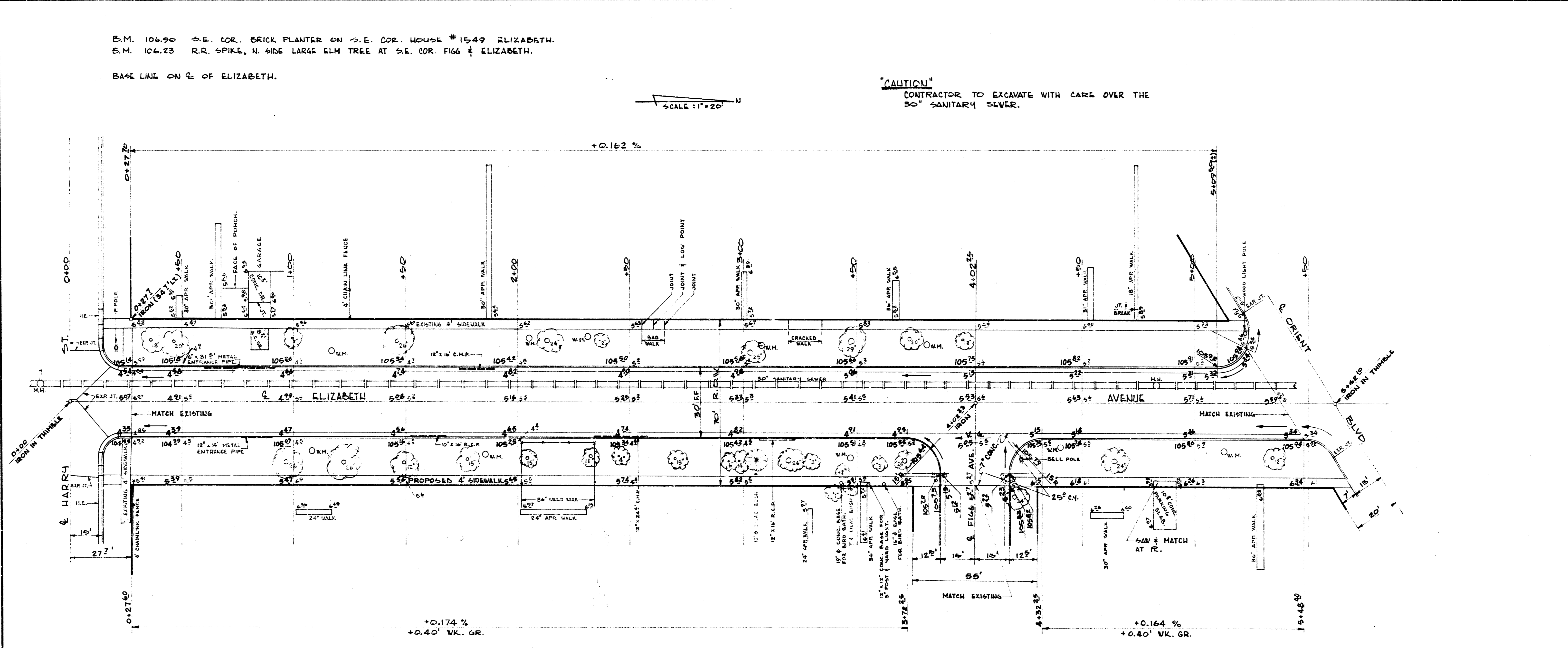

- NOTES:**
- 1) GRADE PARKING & CLEAR R.O.V. FOR PROPOSED SIDEWALKS. COMPACT FILL IN SIDEWALK AREA. SIDEWALKS TO BE CONSTRUCTED BY OTHERS.
 - 2) REMOVAL OF SMALL CONC. BASES TO BE INCIDENTAL TO PROJECT.
 - 3) CONTRACTOR TO ADJUST MANHOLE TO FINISHED GRADE.

EARTHWORK		
	EXCAVATION	COMPACTED FILL
PROPERTY	409.6 C.Y.	44.0 C.Y.
ADD 10%	41.0	4.0
Total	450.6 C.Y.	50.6 C.Y.



ELIZABETH AVENUE - N.L. HARRY STREET TO
 S.L. ORIENT BLVD.
 26'-2'-30" ASPH. CONC. & CURB.
 CITY OF WICHITA, KANSAS.
 B.E. SMITH - CITY ENGINEER
 DATE: SEPT. 1968 PROJECT # C.18-90
 SHEET 1 of