

DOUGLAS AVENUE
350 FT. E.-EL. ARMOUR DR.-WL. ROCK ROAD
R.W. LINN CITY ENGINEER
DATE APRIL 1974 PROJ. NO. DAKS 573059

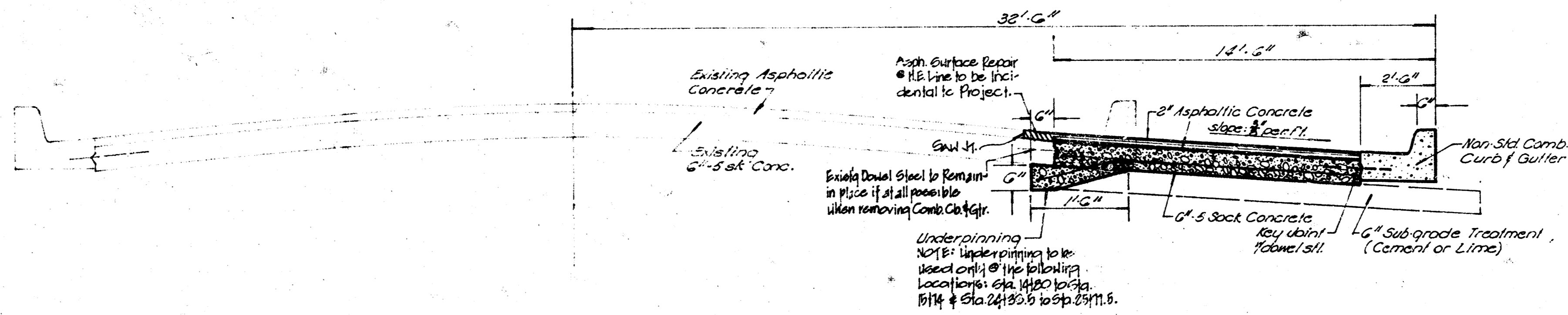

TYPICAL SECTION

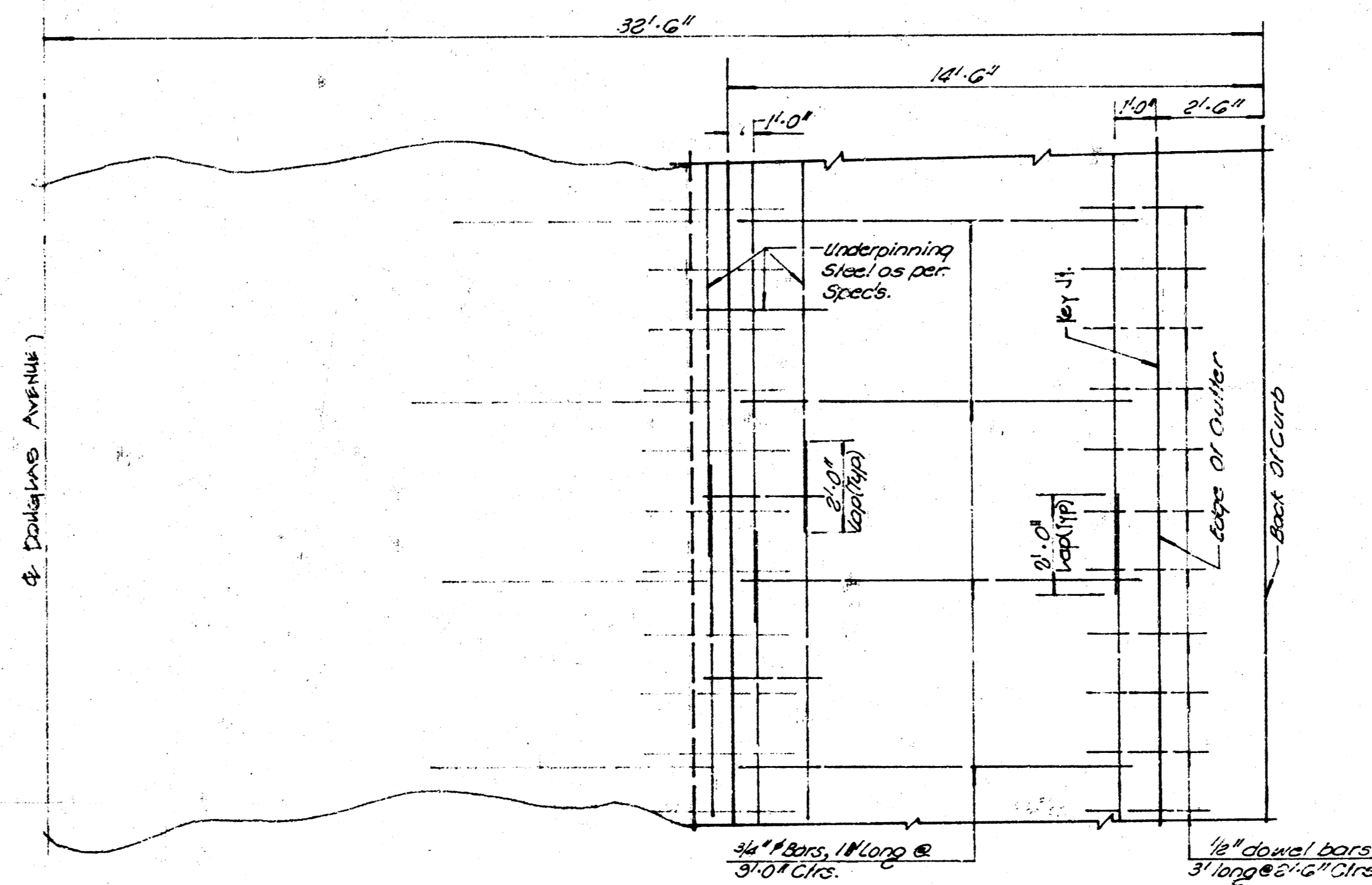

STEEL PATTERN

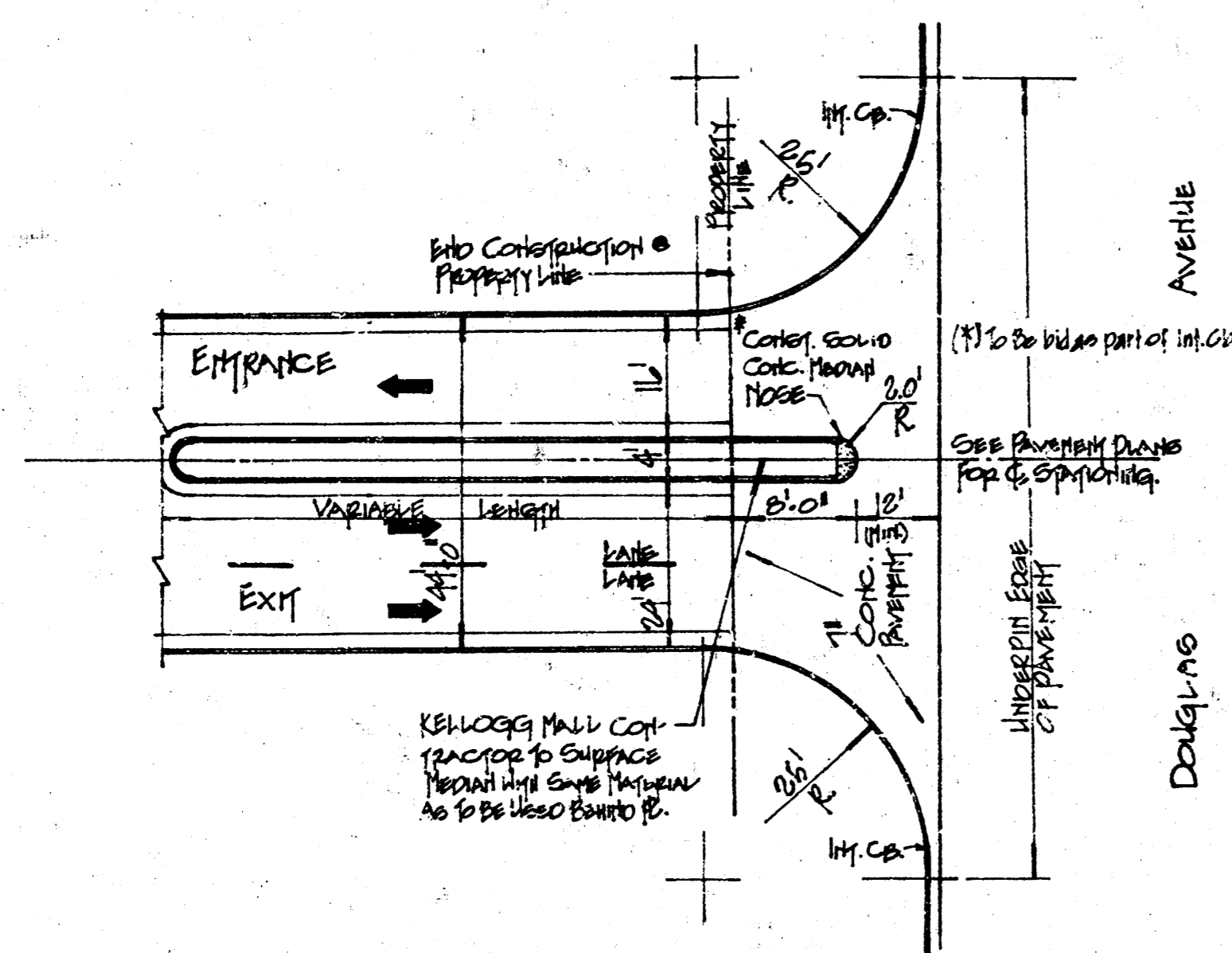

TYPICAL MAJOR APPROACH
(to occur)

GENERAL NOTES

NOTE: CONTRACTOR TO REMOVE THE MINIMUM AMOUNT OF TREES NECESSARY TO COMPLETE THIS PROJECT. THE REMOVAL OF TREES AND FENCES WILL BE BID AS THEIR OWN AND "CLEARING-OF-ROAD".

ALL EXISTING AND PROPOSED UTILITY LINES ON PLANS ABOVE OR BELOW GRADE AS INDICATED ARE FOR INFORMATION AND IDENTIFICATION PURPOSES ONLY. CONTRACTOR'S SHALL HAVE THE RESPONSIBILITY IN OBTAINING SAID RESPECTIVE UTILITY COMPANY, RECORD OR NEW SIGNS.

TYPE OF SURGRADE TREATMENT SHALL BE DETERMINED BY THE FIELD ENGINEER. SURGRADE TREATMENT MAY CONSIST OF LIME, GROUT, SURGRADE MODIFICATION OR ANY COMBINATION OF THESE.

Survey DALLAS
 Plan 574
 Checked

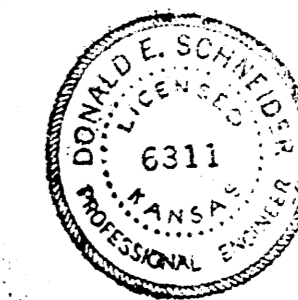

APRIL 1974



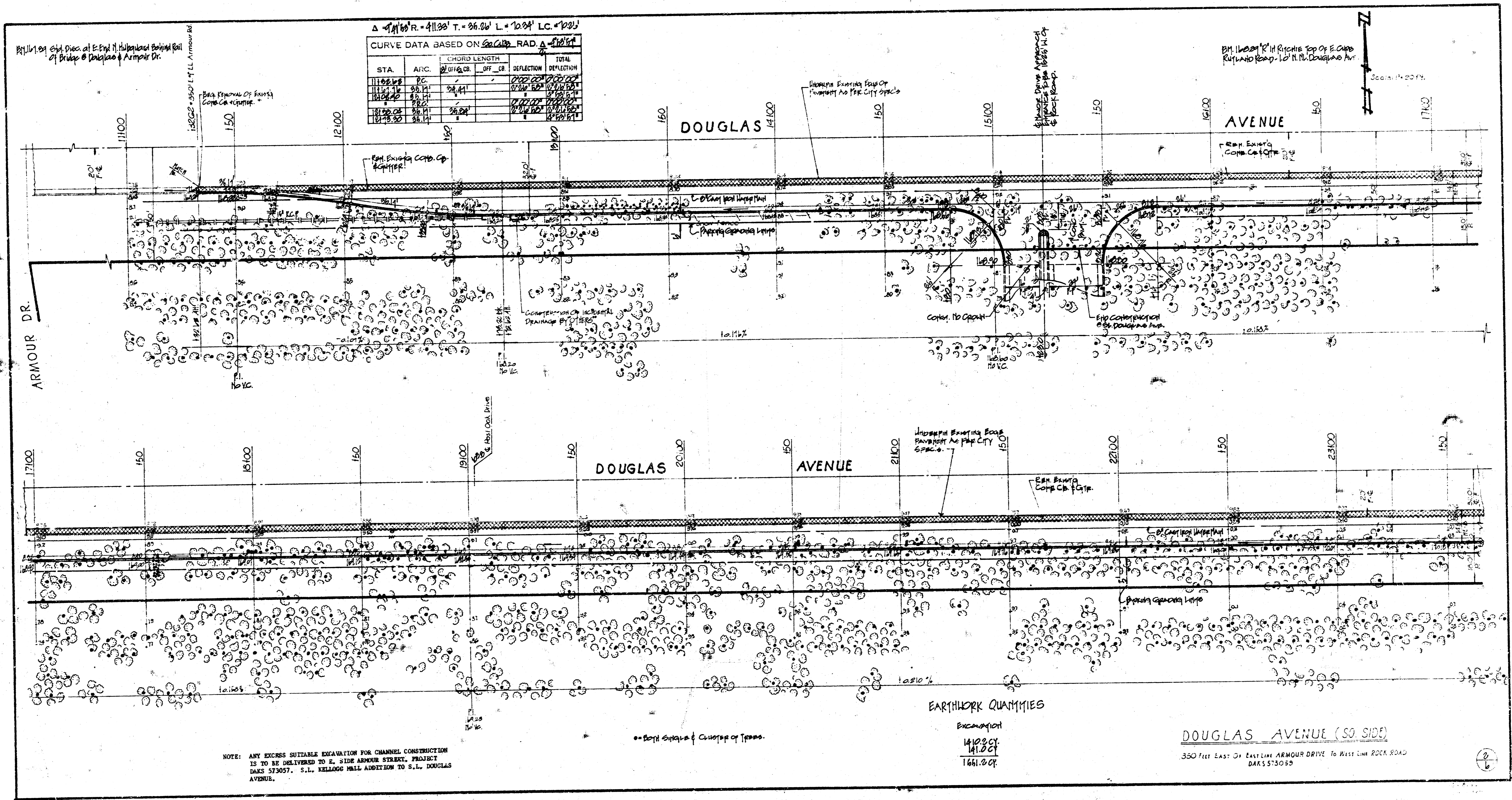

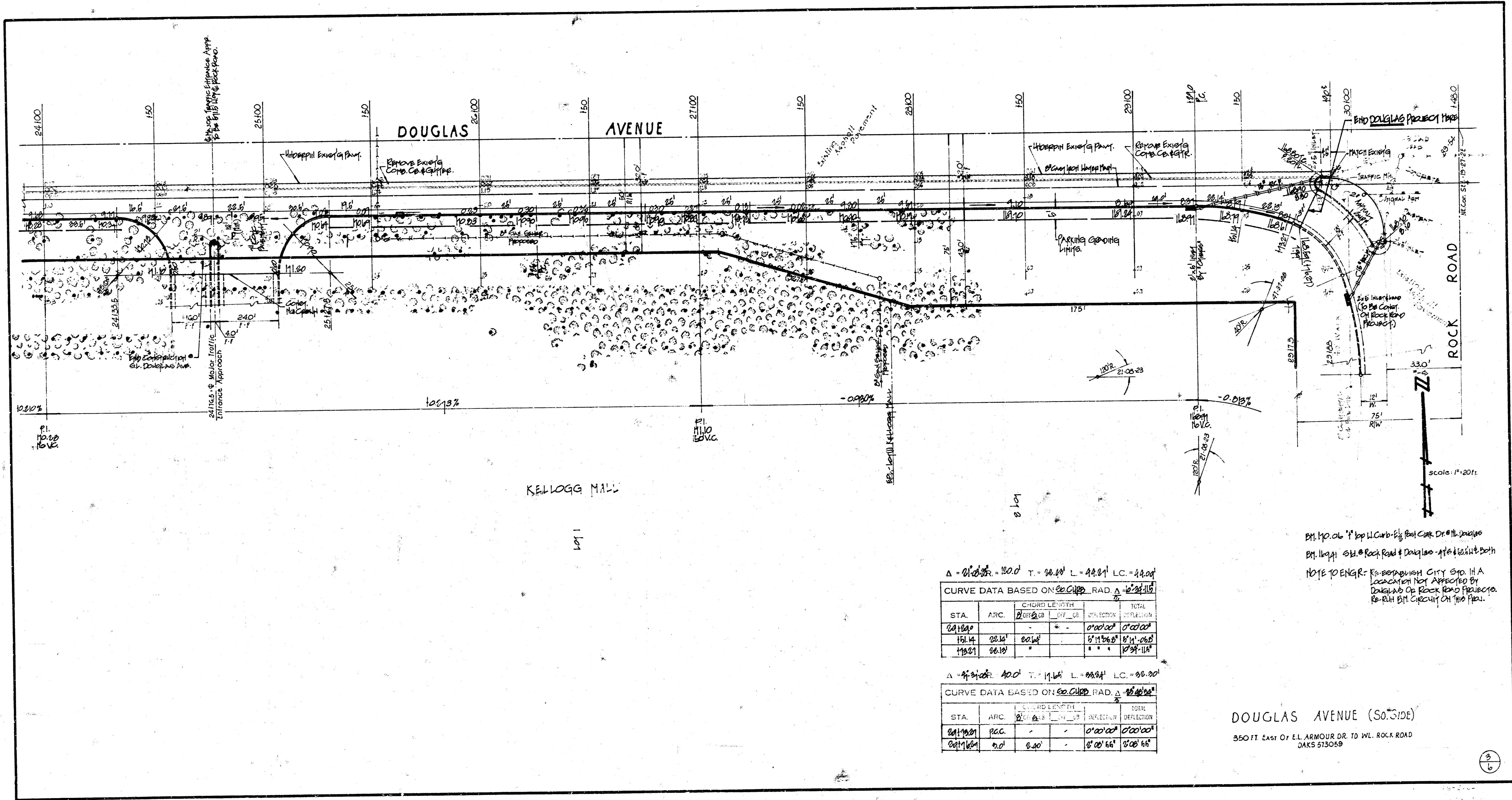

$\Delta = 91.02^\circ$ $R = 120.0'$ $T = 26.18'$ $L = 44.81'$ $LC = 44.04'$

CURVE DATA BASED ON 20' CURVE RAD $\Delta = 91.02^\circ$

STA.	ARC	CHORD	CHORD	CHORD	TOTAL
		LENGTH	LENGTH	LENGTH	LENGTH
24100	0.00	0.00	0.00	0.00	0.00
24114	26.18	26.18	11.16	11.16	26.18
24121	26.18	26.18	0.00	0.00	26.18

$\Delta = 91.02^\circ$ $R = 100'$ $T = 11.64'$ $L = 22.94'$ $LC = 22.20'$

CURVE DATA BASED ON 20' CURVE RAD $\Delta = 91.02^\circ$

STA.	ARC	CHORD	CHORD	CHORD	TOTAL
		LENGTH	LENGTH	LENGTH	LENGTH
24121	0.00	0.00	0.00	0.00	0.00
24129	11.64	11.64	5.00	5.00	11.64
24134	11.64	11.64	0.00	0.00	11.64

BT 140.06 "1" Top 11" Curbed by Road Curb Dr. @ 11' Distance
 BT 140.01 "5/8" Rock Road @ Douglas Ave @ 12' Distance
 NOTE TO ENGINEER: RE-CONSTRUCTION CITY STD. H.A. LOCATION NOT APPROVED BY DAKOTA OR ROCK ROAD PROJECTS. RE-RIT BIT CURB ON "1" ROAD.

DOUGLAS AVENUE (SOUTH SIDE)
 550 FT EAST OF E.L. ARMOUR DR. TO W.L. ROCK ROAD
 DAKS 513059

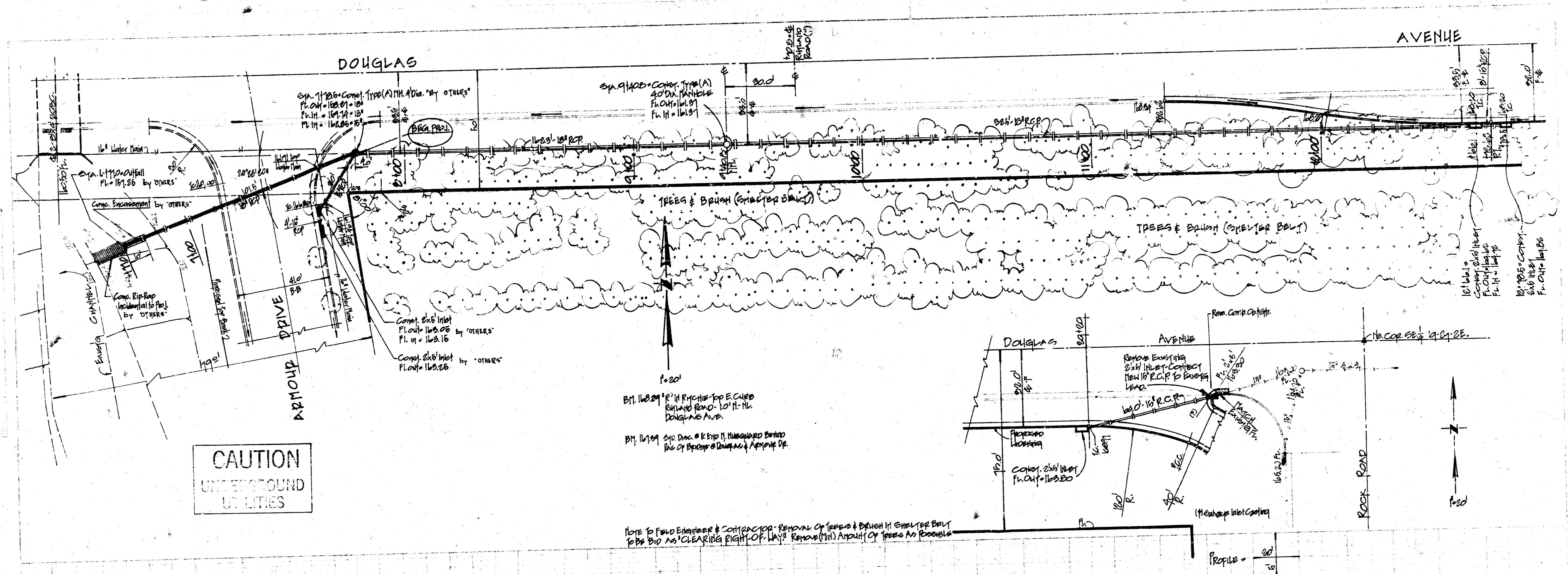

CAUTION
UNDERGROUND
UTILITIES

BY 11/29/14 12" R.C.P. TOP E. CURB
EXTENDED FROM 10' TO 11' IN
DOUGLAS AVE.

BY 11/19/14 6" DIA. R.C.P. 11' UNDEGROUND BEHIND
R/W OF DRIVE @ END OF ARMOUR DR.

NOTE TO FIELD ENGINEER & CONTRACTOR: REMOVAL OF TREES & BUSHES IN SHOWN AREAS
TO BE BID AS CLEARING RIGHT-OF-WAY! REMOVE (11) AMOUNT OF TREES AS POSSIBLE

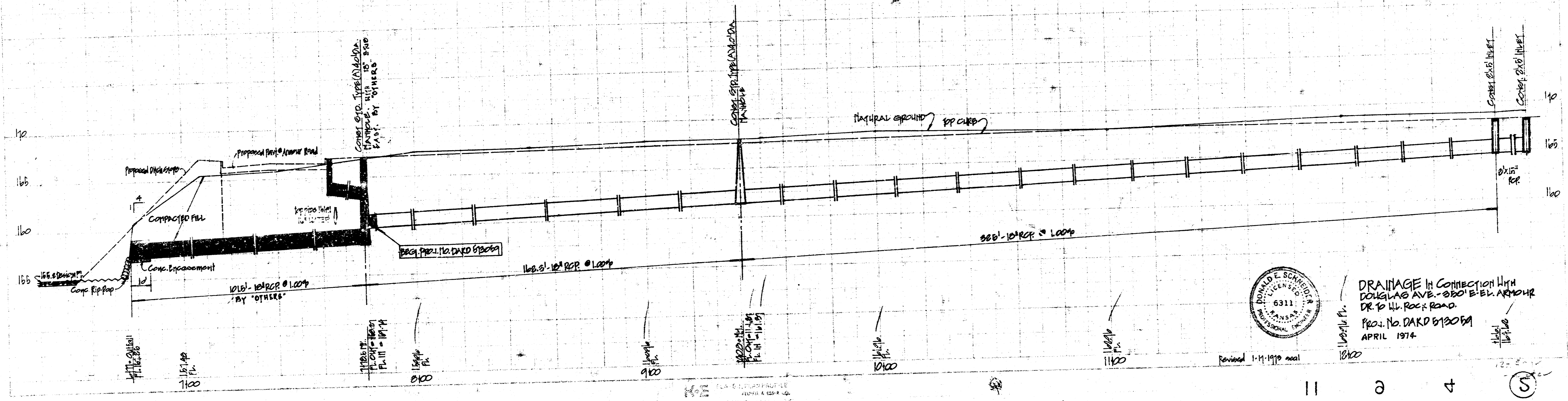

DRAINAGE IN CONNECTION WITH
DOUGLAS AVE. - 320' E. BLV. ARMOUR
DR. TO RR. ROCK ROAD
PROJ. NO. DAKD 012054
APRIL 1974

Revised 1-11-1970 asst

11 3 4 (S)