

B.M. 98.044 Standard SW Glenn & 27th St So.  
 B.M. 99.45 120' Spike E.S. P.Pole NW Glenn & Anita W.  
 B.M. 100.22 S.E. cor. conc. porch No. 1720 Anita.

Sta. on E

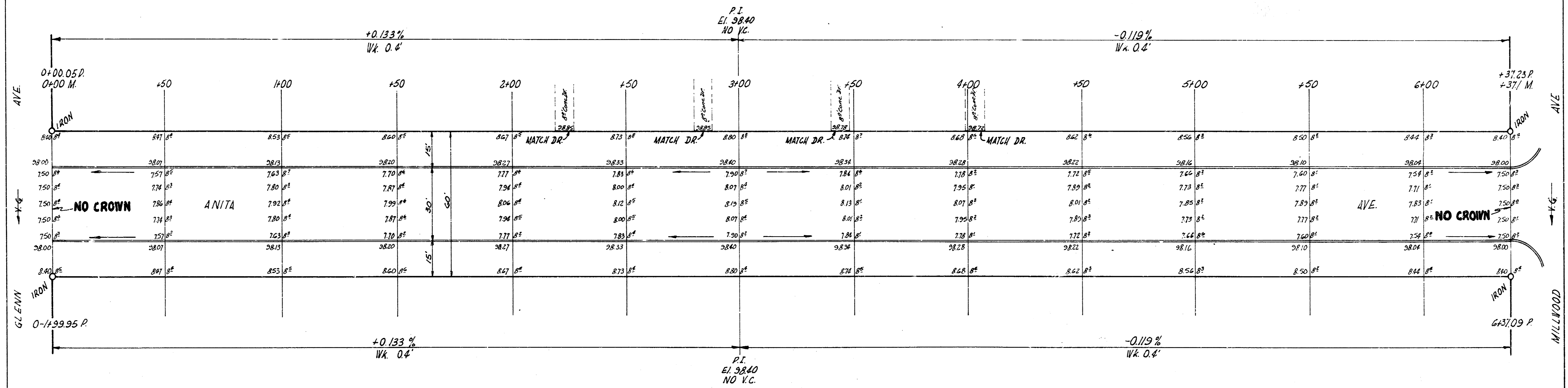

ANITA AVE.  
 E.L. GLENN - W.L. ELIZABETH  
 30' CONC. & CB.  
 CITY OF WICHITA, KANS.  
 B.E. SMITH CITY ENGINEER  
 March 1956 PROJ. NO. C15-21

1/2

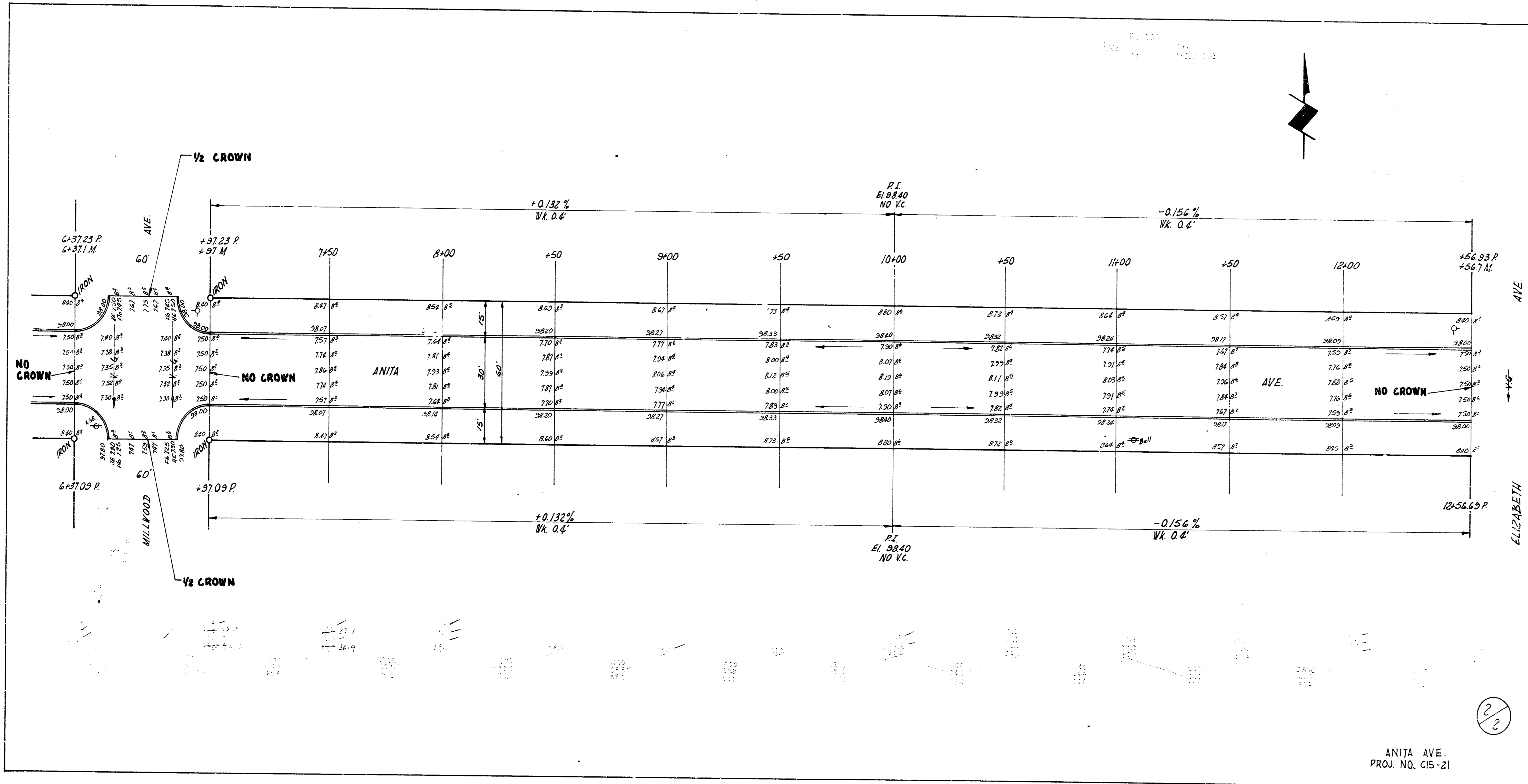

2/2

ANITA AVE.  
PROJ. NO. C15-21