

NOTE: C.B.'S TO BE INSTALLED WITH S.W.S. #44.

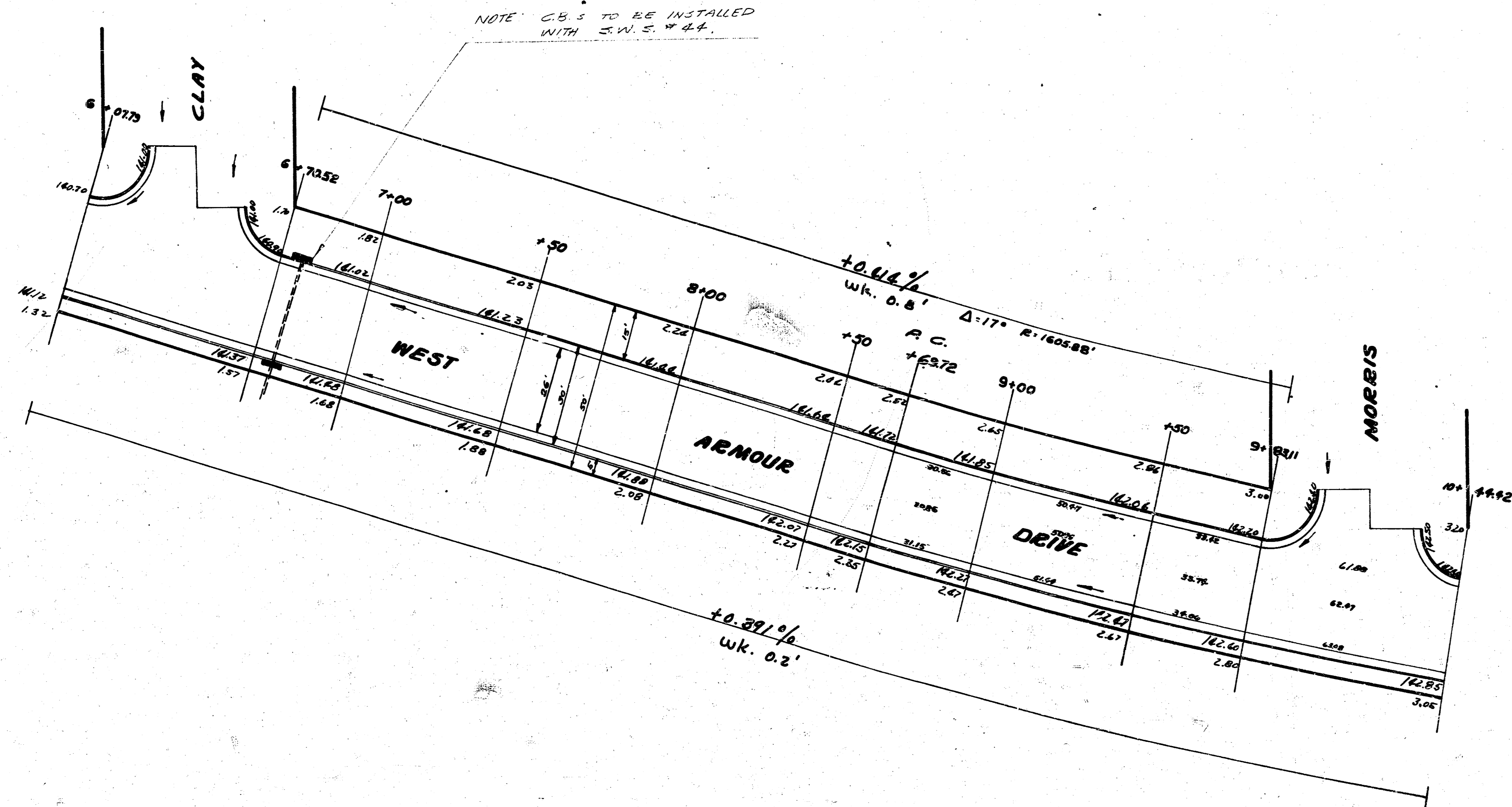

WEST ARMOUR DRIVE

2
8

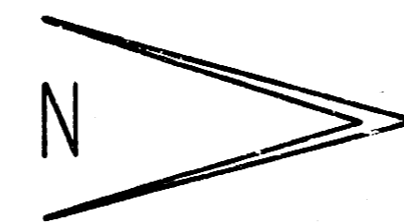

NOTE: ALL C.B.'s & LEAPS TO BE
INSTALLED WITH S.W.S. #22.

NOTE: C.C.'s TO BE INSTALLED WITH S.W.S. #2.

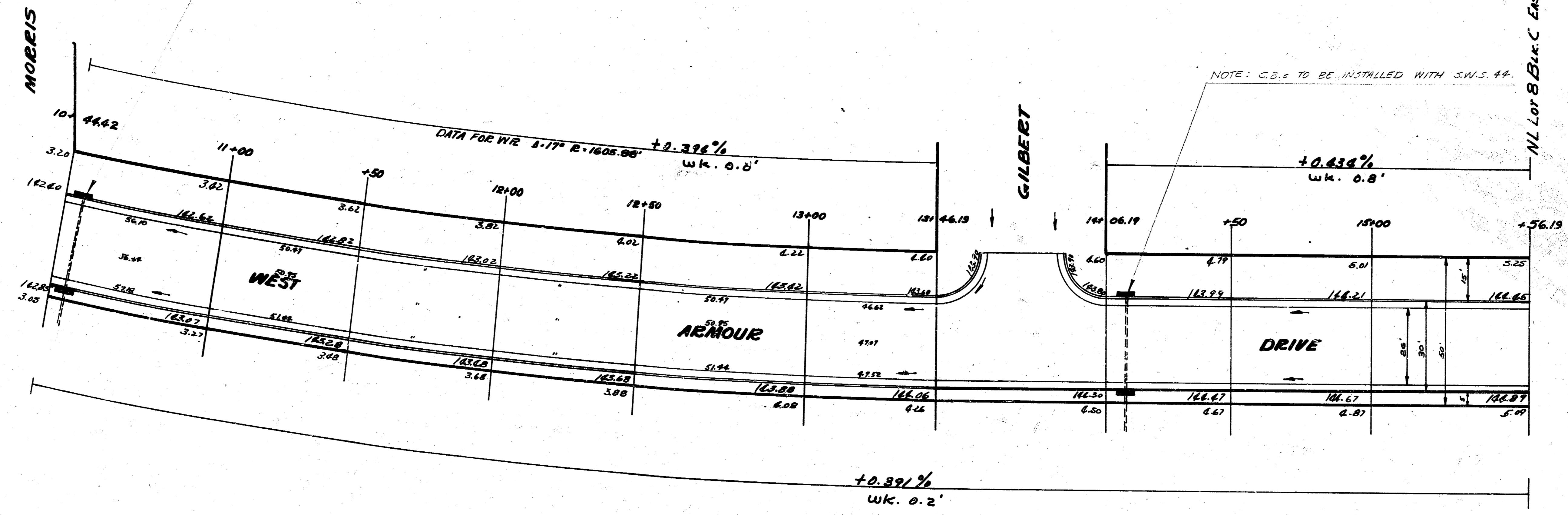

WEST ARMOUR DRIVE

3
8