

25.70
 23.0
 2.70
 26.80
 2.70
 26.80
 2.70
 26.80

BATTIN AVE. S.L. 3rd - S.L. Central
1" Sheet Asphalt on Black Base
S.L. Central to Slab - Concrete

B.M. elev. 179.25 4' on SW coping Conc. Curb on Central E. of Stebbins Dr.
 181.32 6' in Globe 15' 4" x 36" Central

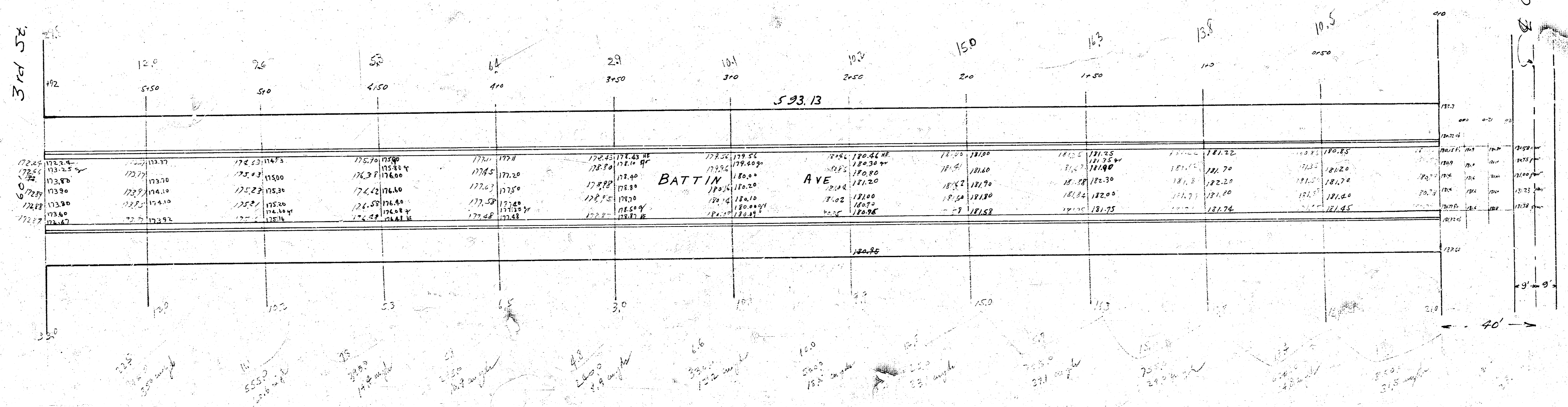

Central Ave