

B.M. 150.85 'R' IN RITCHIE N END OF NW CORNER OF EAST ST OF GOVERNEUR @ N.L. BAYLEY
 B.M. 153.92 'R' IN RITCHIE S. CR. CASTLE EL. GOVERNEUR.
 B.M. 150.32 SPIKE IN N SIDE RD. S.W. COR. LINCOLN & GOVERNEUR.
 B.M. 149.57 'R' IN RITCHIE E LUG DRIVE APPTS Hs # 7220 BAYLEY
 B.M. 149.70 'R' IN RITCHIE E LUG DRIVE APPTS Hs # 7314 BAYLEY
 STATIONING & BASE LINE @ OF BAYLEY

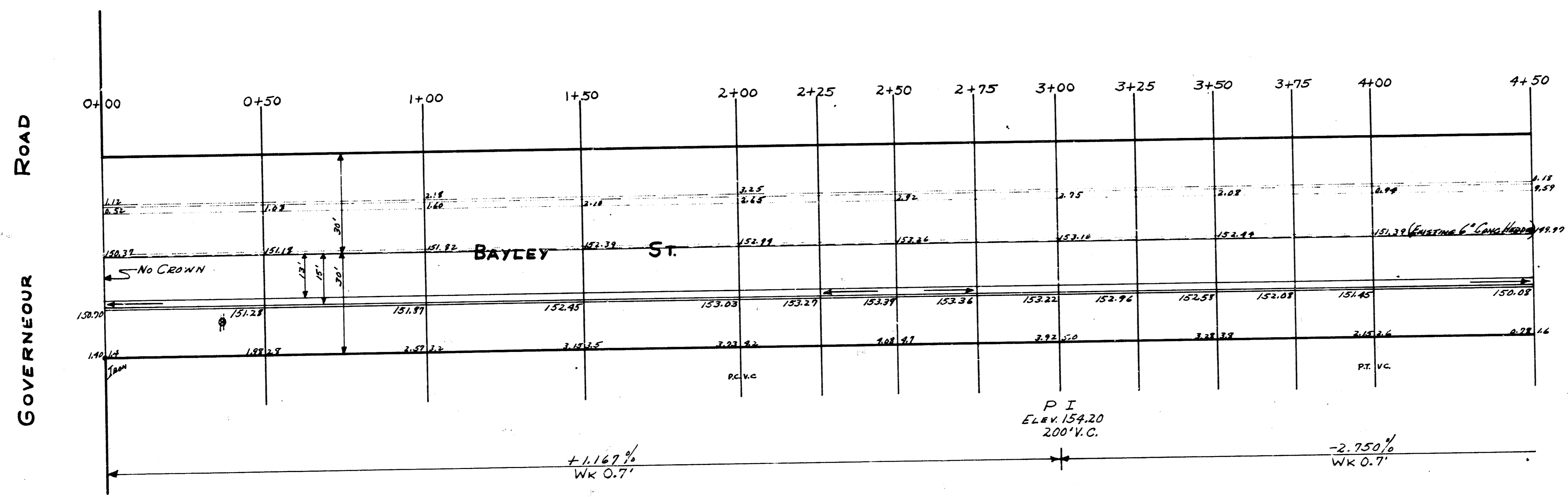

1/3

S 1/2 BAYLEY
 EL. GOVERNEUR TO EL. WEST ARMOUR DR.
 13-2-15-AC.
 CITY OF WICHITA KAN.
 B.E. SMITH CITY ENGINEER
 1955 PROJ. NO. C14-303



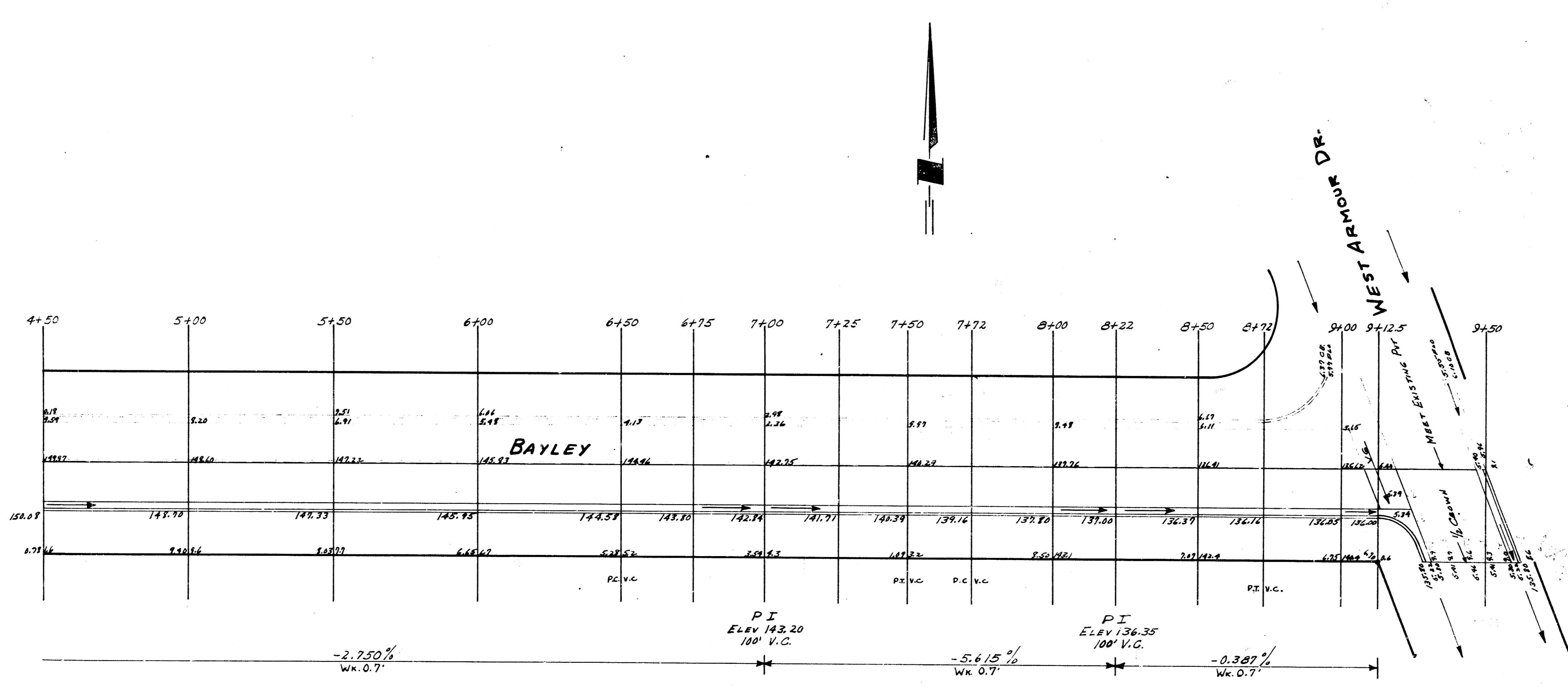

2/13

S 1/2 BAYLEY
EL. GOVERNEUR TO EL. WEST ARMOUR DR.