

BATTIN AVENUE  
N.L. LOOMAN TO S.L. ARLENE

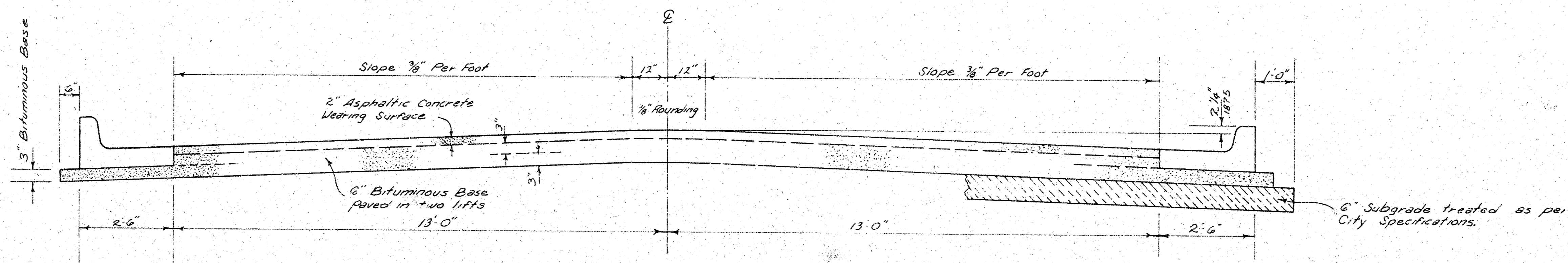

TYPICAL SECTION

31' ASPHALTIC CONCRETE PAVEMENT WITH BITUMINOUS BASE

The A.C. pavement between the Comb. Curb & Gutter shall be paid as  $\$2.16$ . B" A.C. Pavement (6" Bituminous Base). The Bituminous Base under the Comb. Curb & Gutter shall be paid as  $\$2.16$ . 3" Bituminous Base.

A TACK COAT OF EMULSIFIED ASPHALT (SS-1H) SHALL BE APPLIED AT AN APPROXIMATE RATE OF 0.05 GALLONS PER SQ. YD. BETWEEN LIFTS OF ASPHALTIC MATERIALS WHEN ORDERED BY THE ENGINEER. TACK COAT WILL NOT BE PAID FOR DIRECTLY AND SHALL BE CONSIDERED AS SUBSIDIARY TO PRICE BID FOR ASPHALTIC PAVEMENT. BITUMINOUS BASE AND ASPHALTIC CONCRETE WEARING SURFACE SHALL BE PLACED WITH A LAYDOWN MACHINE HAVING AUTOMATIC ELECTRONIC CONTROLS FOR CROWN AND GRADE. CONSTRUCTION JOINTS IN EACH LIFT SHALL BE STAGGERED A MINIMUM DISTANCE OF 1' WITH JOINTS IN PRECEDING LIFTS AND SUCH THAT A JOINT WILL BE CONSTRUCTED ON THE PAVEMENT CENTERLINE IN THE TOP LIFT.

DETAIL OF TRANSVERSE CONSTRUCTION JOINTS

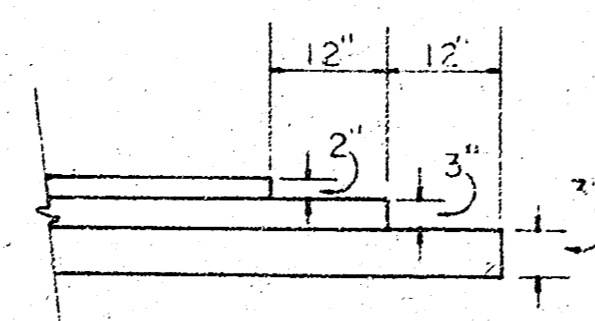

TRANSVERSE CONSTRUCTION JOINTS SHALL BE CONSTRUCTED IN FLEXIBLE BASE PAVEMENTS AT LOCATIONS WHERE PAVEMENT TEMPORARILY ENDS TO FACILITATE FUTURE PAVEMENT CONSTRUCTION AS SHOWN BY DETAIL. THE COST OF CONSTRUCTING THE TRANSVERSE CONSTRUCTION JOINTS SHALL NOT BE MEASURED OR PAID FOR DIRECTLY BUT SHALL BE INCLUDED IN THE BID PRICE FOR SQUARE YARDS OF ASPHALTIC CONCRETE PAVEMENT.

COMBINED CURB & GUTTER

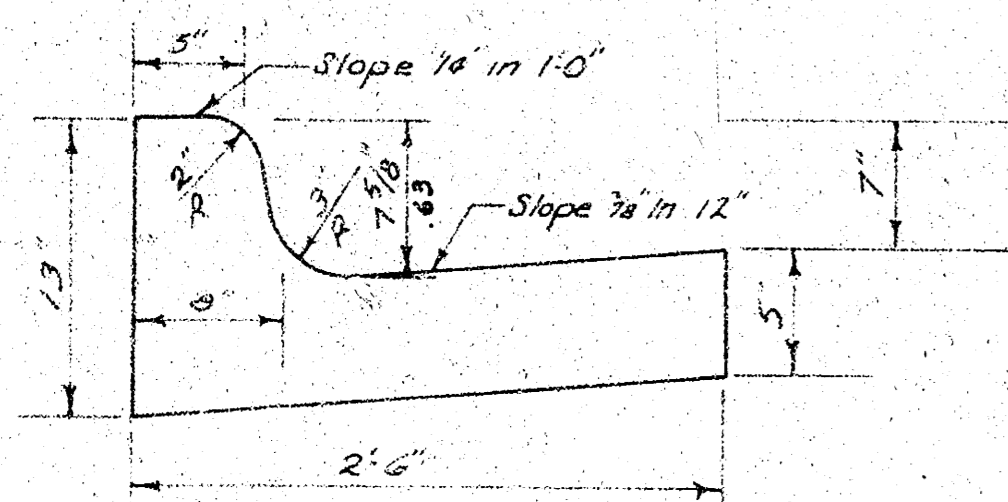

ROLL TYPE CURB & GUTTER

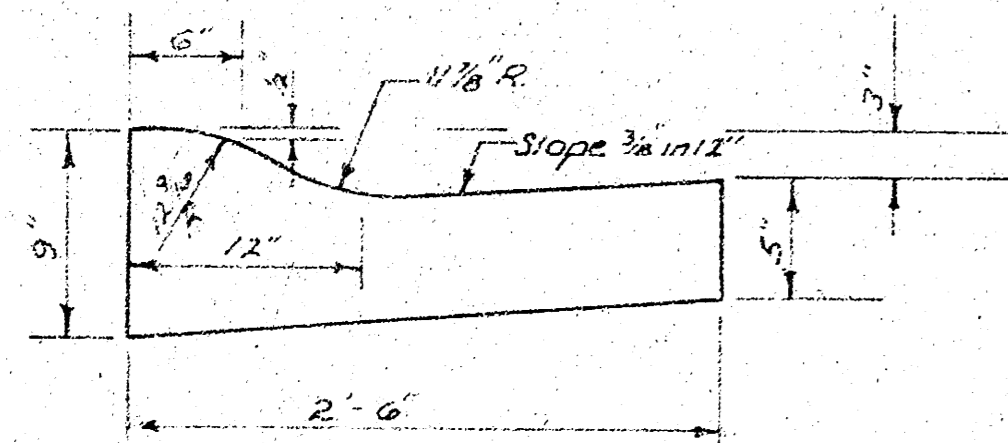

CITY OF WICHITA, KANSAS

DEPARTMENT OF PUBLIC WORKS — ENGINEERING

R. W. LINN CITY ENGINEER

DATE: SEPT 1976 PROJ. NO. DAKS 574080

BASELINE IS CTR. OF BATTIN AVENUE.

B.M. 186.39 S.W. COR. CONC. PARCH. No. #4914 E. 24<sup>TH</sup> ST. N.

NOTE: NO MORE THAN 12-20' DRIVES TO BE CONST. ON THIS PROJECT.

SCALE 1" = 20'

**CAUTION**  
**UNDERGROUND**  
**UTILITIES**  
 Please check with K.G. & E. or  
 Southwestern Bell  
 Telephone Co. for Location.

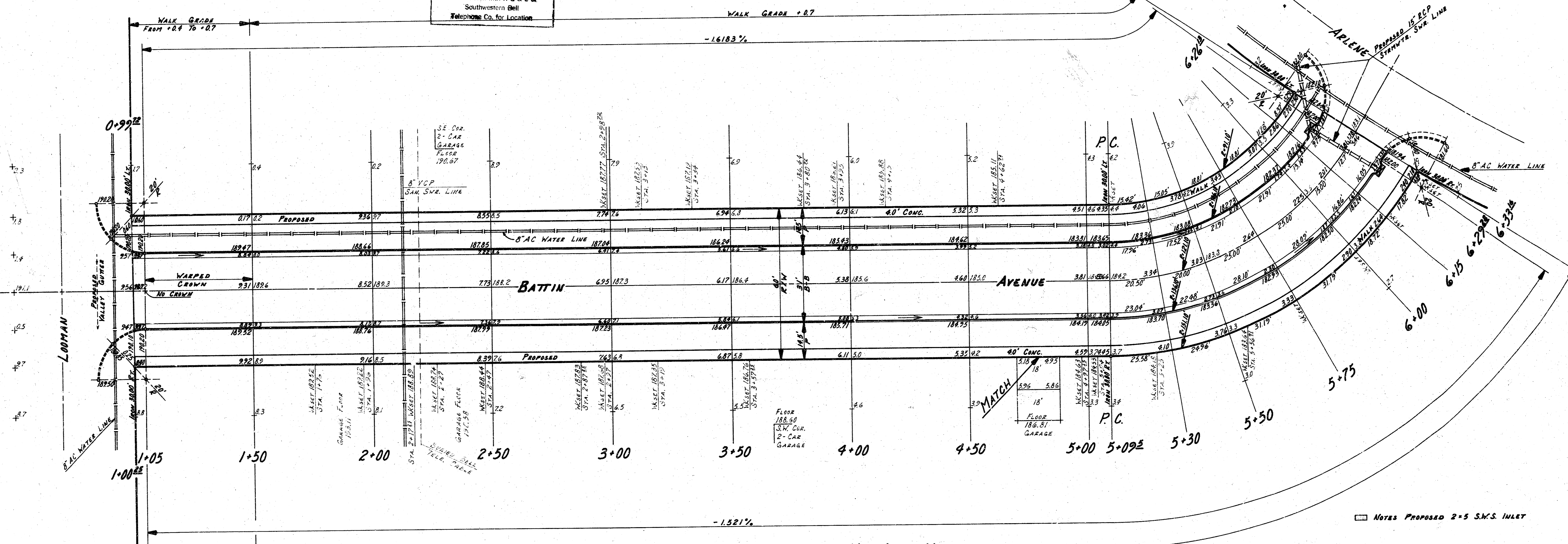

Survey Area  
 Plan Revised  
 Exc. Checked

NOTES PROPOSED 25' S.M.S. INLET

WALK GRADE +0.8  
 $\Delta = 38'34''$  R. = 1211 T. = 67.83 L. = 123.66 LC. = 118.36

CURVE DATA BASED ON  $\frac{1}{4}$  RAD.  $\Delta = 29'15'15''$

STA.	ARC.	CHORD LENGTH:		DEFLECTION	
		OFF. CH.	OFF. CH.	DEFLECTION	TOTAL DEFLECTION
5+09.4				0' 00" 00"	0' 00" 00"
5+30	20.50	16.59	24.36	4' 50' 38"	4' 50' 58"
5+50	20.00	16.18	23.77	4' 43' 33"	9' 34' 51"

5+75	25.00	20.22	29.70	5' 54' 31"	15' 29' 42"
6+00	25.00	20.22	29.70	5' 54' 31"	21' 24' 33"
6+15	15.00	12.14	17.84	3' 32' 54"	24' 57' 27"
6+26.48	11.13	9.01	13.24	2' 37' 59"	27' 35' 26"
6+29.88	3.15	2.55	3.75	0' 44' 42"	28' 20' 08"
6+33.48	3.88	3.14	4.62	0' 55' 05"	29' 15' 13"

DEFL. FT. = 14.19383473 MIN.

**EARTHWORK PROPERTY**

EXCAVATION 1044.8 Cu. Yds.	COMPACTED FILL 57.5 Cu. Yds.
+10% 104.5 Cu. Yds.	+10% 5.7 Cu. Yds.
<b>TOTAL 1149.3 Cu. Yds.</b>	<b>TOTAL 63.2 Cu. Yds.</b>

1955.0 Sq. Yds. MANIPULATION (6" LIFT)

**SUB-GRADE**  
 TYPE OF SUB-GRADE TREATMENT SHALL BE DETERMINED BY THE FIELD ENGINEER. SUB-GRADE TREATMENT MAY CONSIST OF LIME TREATMENT, CEMENT TREATMENT, SUB-GRADE MODIFICATION, OR ANY COMBINATION OF THESE.

NOTE TO FIELD ENGINEER & CONTRACTOR  
 Grade parking and clear right-of-way for proposed sidewalk. Compact fill in sidewalk area to be constructed by "OTHERS".

**BATTIN AVENUE**  
 N.L. LOOMAN TO S.L. ARLENE  
 26-2-30 ASPHALTIC CONC.  
 CITY OF WICHITA, KANSAS  
 R. W. LINN CITY ENGINEER  
 PROJECT No. DAKS 574080  
 DATE: Sept. 76  
 (214)

FILMED FROM THE BEST AVAILABLE COPY.....