

B.M. 10738 T<sup>m</sup> in Tron, File Hya. NW. Coe. Santa Fe & Bayley

Note: Walk on S.S. is in poor shape in reference to elevations.

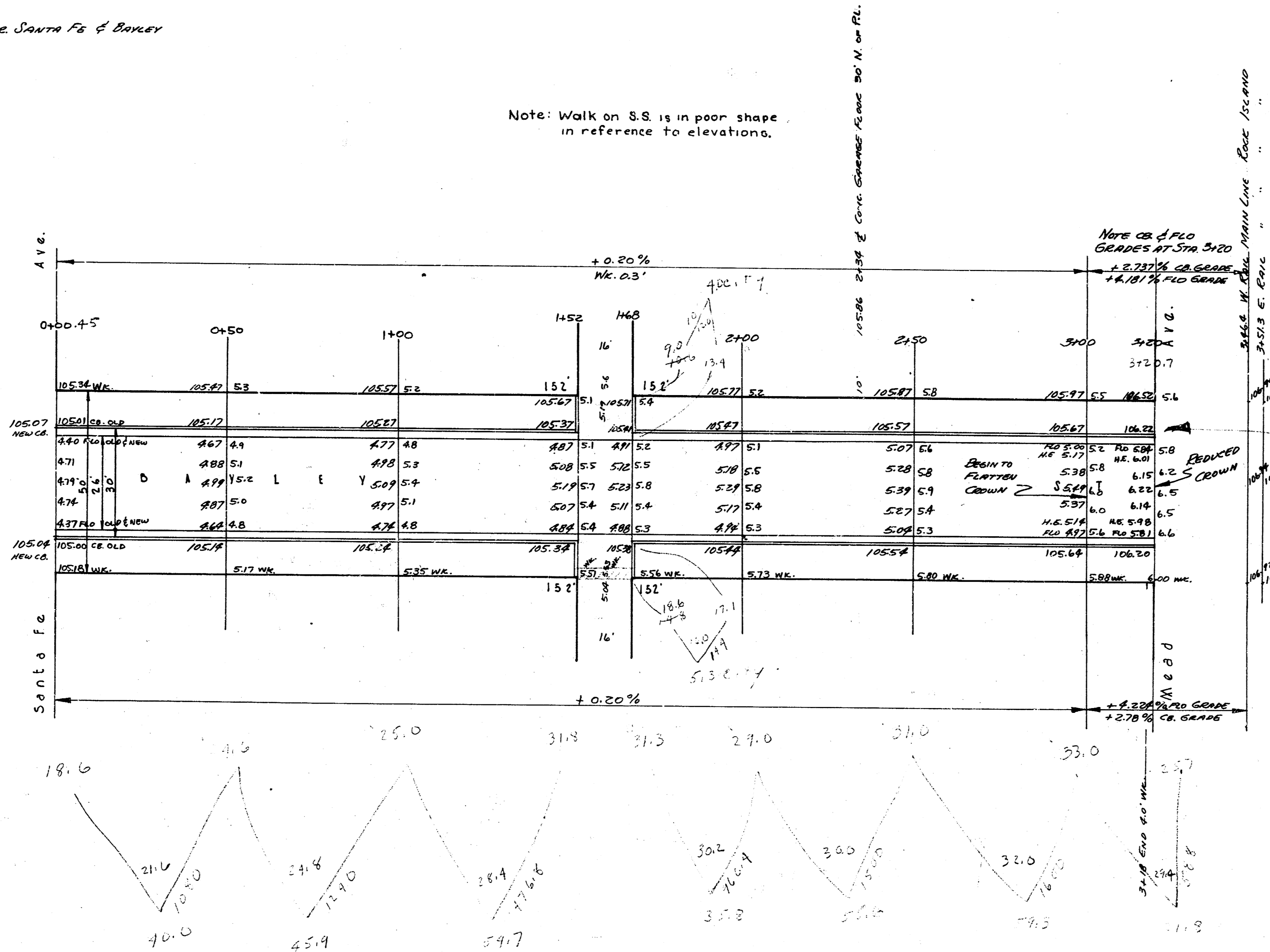

152.0
152.1
152.2
152.3
152.4
152.5
152.6
152.7
152.8
152.9
153.0
153.1
153.2
153.3
153.4
153.5
153.6
153.7
153.8
153.9
154.0
154.1
154.2
154.3
154.4
154.5
154.6
154.7
154.8
154.9
155.0
155.1
155.2
155.3
155.4
155.5
155.6
155.7
155.8
155.9
156.0
156.1
156.2
156.3
156.4
156.5
156.6
156.7
156.8
156.9
157.0
157.1
157.2
157.3
157.4
157.5
157.6
157.7
157.8
157.9
158.0
158.1
158.2
158.3
158.4
158.5
158.6
158.7
158.8
158.9
159.0
159.1
159.2
159.3
159.4
159.5
159.6
159.7
159.8
159.9
160.0
160.1
160.2
160.3
160.4
160.5
160.6
160.7
160.8
160.9
161.0
161.1
161.2
161.3
161.4
161.5
161.6
161.7
161.8
161.9
162.0
162.1
162.2
162.3
162.4
162.5
162.6
162.7
162.8
162.9
163.0
163.1
163.2
163.3
163.4
163.5
163.6
163.7
163.8
163.9
164.0
164.1
164.2
164.3
164.4
164.5
164.6
164.7
164.8
164.9
165.0
165.1
165.2
165.3
165.4
165.5
165.6
165.7
165.8
165.9
166.0
166.1
166.2
166.3
166.4
166.5
166.6
166.7
166.8
166.9
167.0
167.1
167.2
167.3
167.4
167.5
167.6
167.7
167.8
167.9
168.0
168.1
168.2
168.3
168.4
168.5
168.6
168.7
168.8
168.9
169.0
169.1
169.2
169.3
169.4
169.5
169.6
169.7
169.8
169.9
170.0
170.1
170.2
170.3
170.4
170.5
170.6
170.7
170.8
170.9
171.0
171.1
171.2
171.3
171.4
171.5
171.6
171.7
171.8
171.9
172.0
172.1
172.2
172.3
172.4
172.5
172.6
172.7
172.8
172.9
173.0
173.1
173.2
173.3
173.4
173.5
173.6
173.7
173.8
173.9
174.0
174.1
174.2
174.3
174.4
174.5
174.6
174.7
174.8
174.9
175.0
175.1
175.2
175.3
175.4
175.5
175.6
175.7
175.8
175.9
176.0
176.1
176.2
176.3
176.4
176.5
176.6
176.7
176.8
176.9
177.0
177.1
177.2
177.3
177.4
177.5
177.6
177.7
177.8
177.9
178.0
178.1
178.2
178.3
178.4
178.5
178.6
178.7
178.8
178.9
179.0
179.1
179.2
179.3
179.4
179.5
179.6
179.7
179.8
179.9
180.0
180.1
180.2
180.3
180.4
180.5
180.6
180.7
180.8
180.9
181.0
181.1
181.2
181.3
181.4
181.5
181.6
181.7
181.8
181.9
182.0
182.1
182.2
182.3
182.4
182.5
182.6
182.7
182.8
182.9
183.0
183.1
183.2
183.3
183.4
183.5
183.6
183.7
183.8
183.9
184.0
184.1
184.2
184.3
184.4
184.5
184.6
184.7
184.8
184.9
185.0
185.1
185.2
185.3
185.4
185.5
185.6
185.7
185.8
185.9
186.0
186.1
186.2
186.3
186.4
186.5
186.6
186.7
186.8
186.9
187.0
187.1
187.2
187.3
187.4
187.5
187.6
187.7
187.8
187.9
188.0
188.1
188.2
188.3
188.4
188.5
188.6
188.7
188.8
188.9
189.0
189.1
189.2
189.3
189.4
189.5
189.6
189.7
189.8
189.9
190.0
190.1
190.2
190.3
190.4
190.5
190.6
190.7
190.8
190.9
191.0
191.1
191.2
191.3
191.4
191.5
191.6
191.7
191.8
191.9
192.0
192.1
192.2
192.3
192.4
192.5
192.6
192.7
192.8
192.9
193.0
193.1
193.2
193.3
193.4
193.5
193.6
193.7
193.8
193.9
194.0
194.1
194.2
194.3
194.4
194.5
194.6
194.7
194.8
194.9
195.0
195.1
195.2
195.3
195.4
195.5
195.6
195.7
195.8
195.9
196.0
196.1
196.2
196.3
196.4
196.5
196.6
196.7
196.8
196.9
197.0
197.1
197.2
197.3
197.4
197.5
197.6
197.7
197.8
197.9
198.0
198.1
198.2
198.3
198.4
198.5
198.6
198.7
198.8
198.9
199.0
199.1
199.2
199.3
199.4
199.5
199.6
199.7
199.8
199.9
200.0

Notes:  
Non-Standard  
Comb. Cl. & Gr.

Bayley Street  
 E.L. Santafe W.L. Mead  
 26'-2'-30" AC.  
 City of Wichita, Ks.  
 L.K. White City Engineer  
 Date 12-4-48 Proj No. C18-167

6 sheets

4 14 4 52