

B.M. 153.43 Standard N.E. Woodlawn & Lincoln
 B.M. 152.97 "E" in Electric N. of Lincoln, E.L. Woodlawn
 B.M. 151.60 "X" on W. coping conc. box on Woodlawn, N. of Bayley

Excav.	
Prop.	City
60.7	81.9
61.5	38.1
74.1	120.0
85.2	117.0
86.1	
84.8	
46.2	
584.3	
410.7	53.4
Total	442.7

Survey C.H.M. Bickham
 from W.D.D. 228
 checked S.F.

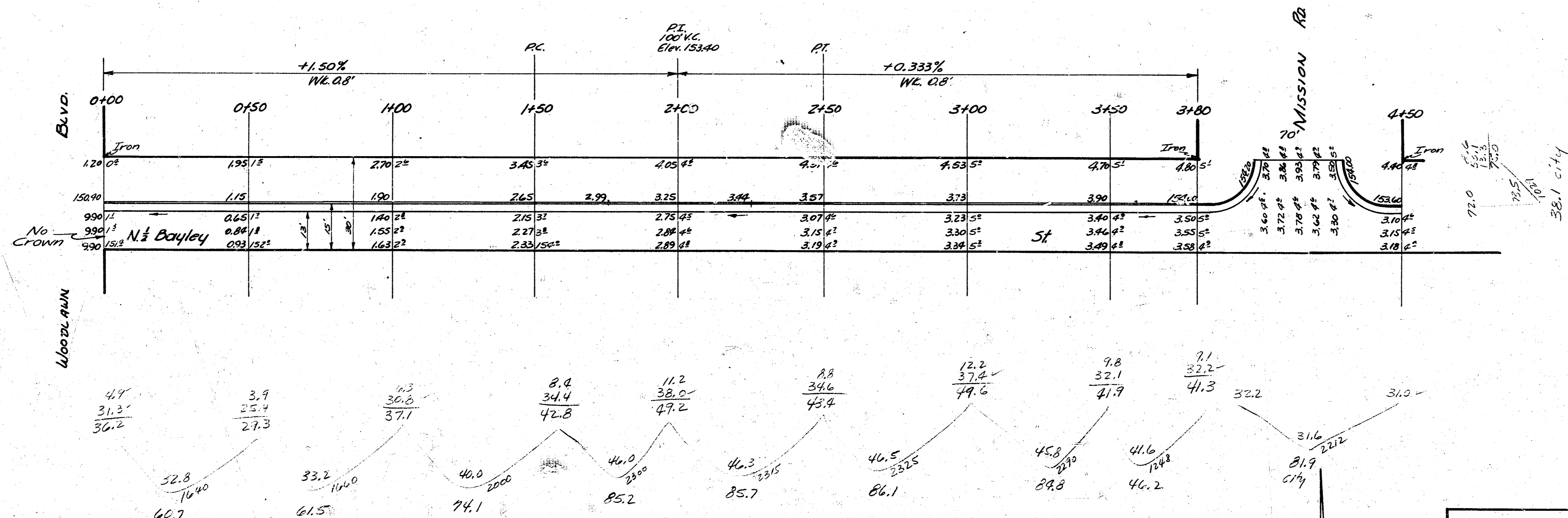

N 1/2 BAYLEY ST.
 EL. WOODLAWN TO CL. MISSION
 13-2-15 AC

CITY OF WICHITA, KANSAS
 B.E. SMITH CITY ENGINEER
 Jan. 26, 1953 Proj. No. C12-236.

1"=20'