

B.M. 147.68 12' IN RITCHIE W.C.B. WICKER S. LINE LEVITT  
 B.M. 159.18 12' IN RITCHIE W.L. BALKWILL N. CB. ZIMMERLY

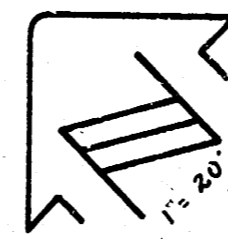

Survey done under 1176-20  
 11/1/12  
 11/1/12  
 11/1/12

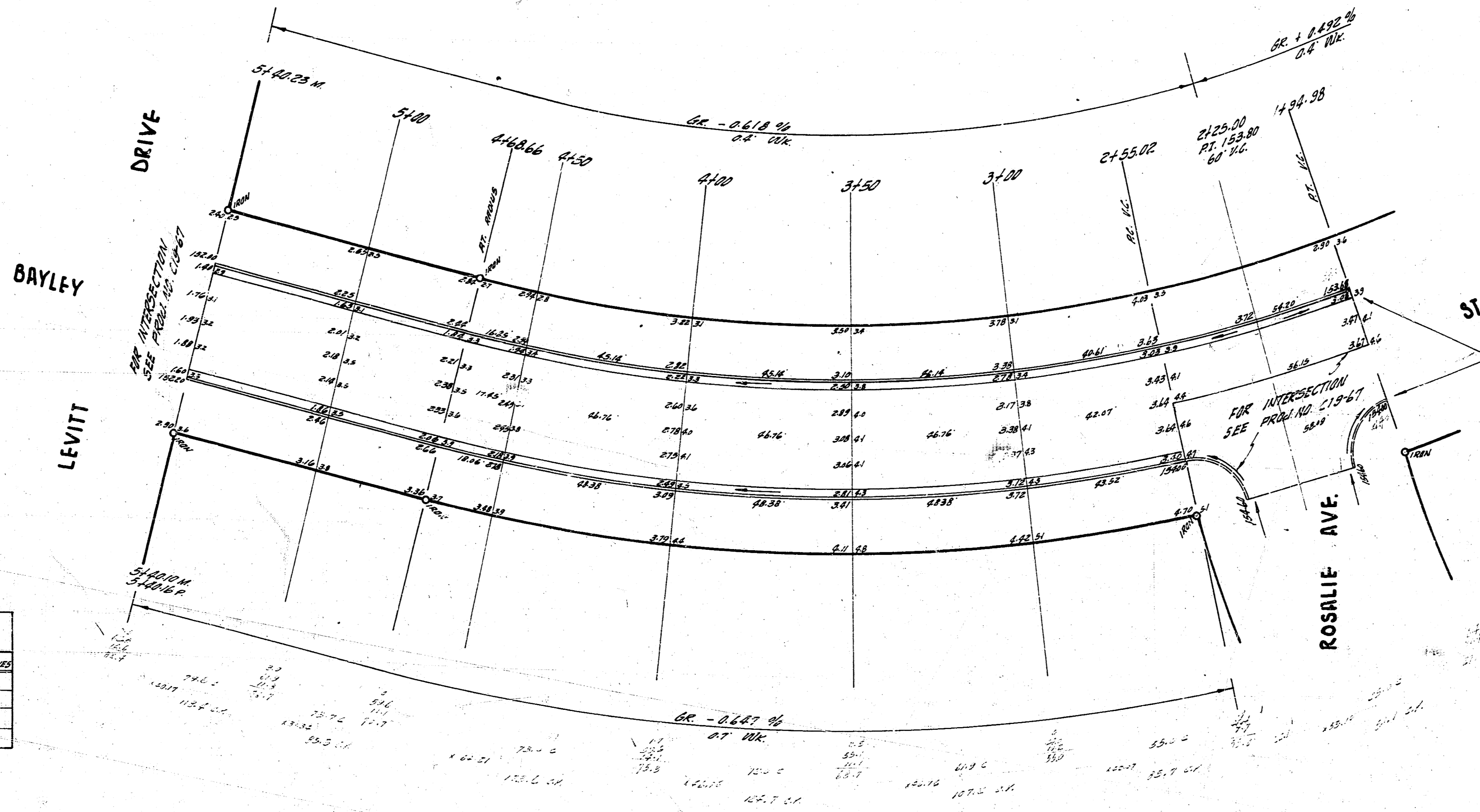

CURVE DATA STA. 14+00.00 TO STA. 21+65.26  
 BASED ON SOUTH & 115° 12' 12"  
 $\Delta = 53^{\circ} 20'$   $\Delta L = 29^{\circ} 00'$   
 $R = 462.97$   $RCL = 273.68$   
 $MIN. DEFL. 1/2\Delta = 3.7167$

STATION	DEFL. L	TOTAL DEFL. L	CHORD S. CB. SET S. CB.	CHORD B. W. SET N. CB.	ARC CH. SET N. CB.
11+00.00					
21+65.26	17.5127	17.5127	22.96	22.96	30.00
21+00.00	17.5127	35.0254	22.96	22.96	30.00
20+00.00	25.4701	60.4955	49.28	49.28	60.00
19+00.00	33.4275	93.9230	89.82	89.82	90.00
18+00.00	41.3849	135.3079	149.82	149.82	120.00
17+00.00	49.3423	184.6502	239.82	239.82	150.00
16+00.00	57.2997	241.9499	359.82	359.82	180.00
15+00.00	65.2571	307.2070	509.82	509.82	210.00
14+00.00	73.2145	380.4215	689.82	689.82	240.00

ESTIMATE OF QUANTITIES  
 NO. DRIVEWAYS FLAGGED IN ESTIMATE

QUANTITIES	UNIT	1 YEAR	5 YEAR
54.3	Sq. Yds.	Asph. Conv. Pavement	2100
594.3	Lin. Ft.	Curb, Ed. & Gutter	2100
746.2	Sq. Yds.	Excavation	2100
216.0	Lbs.	Reinf. Steel	2100

NOTE TO FIELD ENGINEER & CONTRACTOR:  
 CONTRACTOR TO CONSTRUCT APPROX.  
 125 FT. OF SIDEWALK DURING  
 INCIDENTAL TO PRIVATE CONTRACT

NOTE TO CONTRACTOR  
 This project will be constructed under  
 the supervision of the CITY ENGINEER  
 and conforming to the SPECIFICATIONS  
 of the CITY OF WICHITA. The CON-  
 TRACTOR will reimburse the City of  
 Wichita for all cost of Engineering, Plans  
 and Inspection.



**BAYLEY STREET**  
 S.L. LEVITT ~ E.L. ROSALIE  
*(No. 1176-20)*  
 26-2-30 A.C.  
**CITY OF WICHITA, KANSAS**  
 B.E. SMITH CITY ENGINEER  
 DATE: PRIVATE CONTRACT