

PAVING PLAN 1943
 BEVERLY DR. - S.L. Morris to N.L. Lincoln St.
 Comb. only

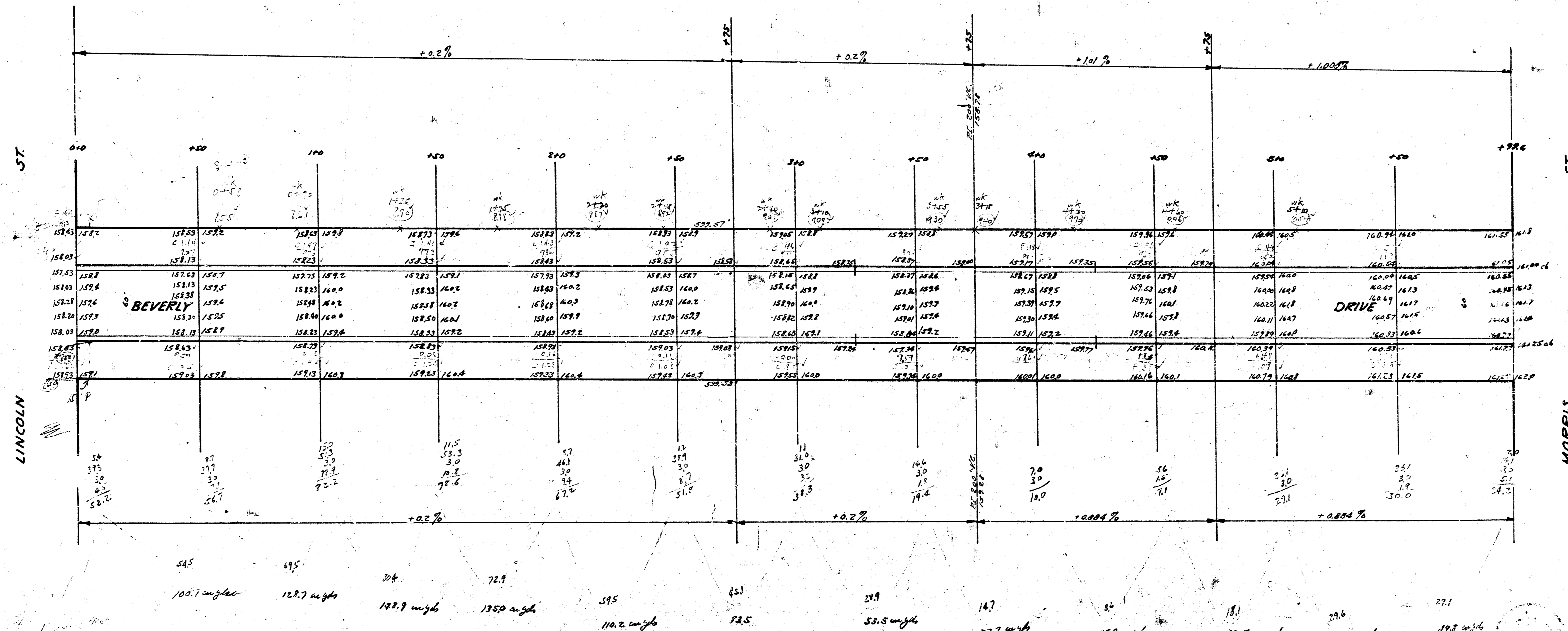

94.9 cu yds
 103.6 cu yds
 B.T. Elev. 143.85 - at cor. lower stp. on house @ RR cor. Box D. of Morris
 21' 15" ELEV. 143.85 IS IN LINE 40' N of N.L. Lincoln