

B.M. RR spike S-face street lite pole NW cor Benjamin Ct. & Benjamin Dr. 1282.  
 B.M. NW cor conc. porch House #3027 Benjamin Ct. 13134

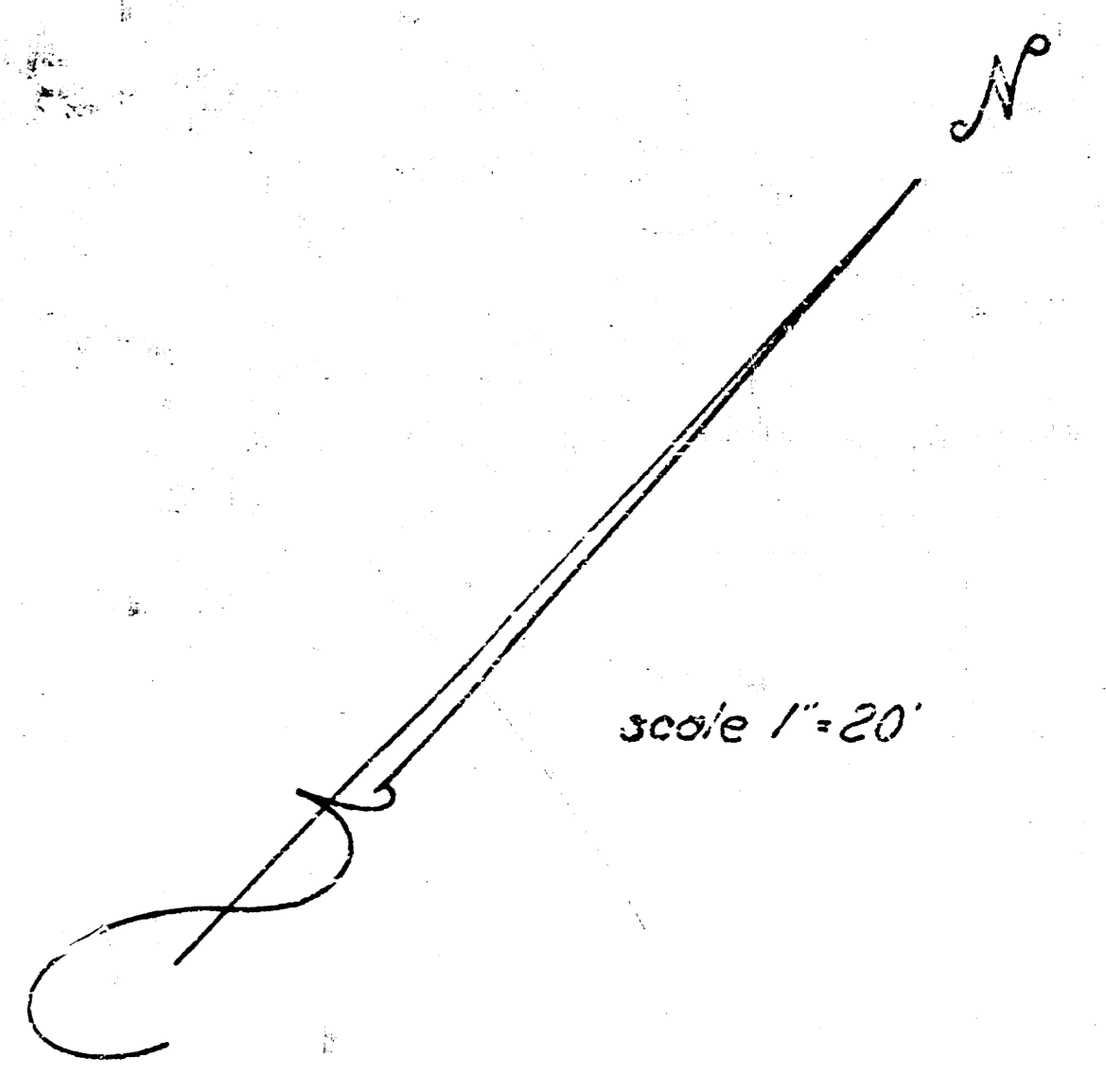
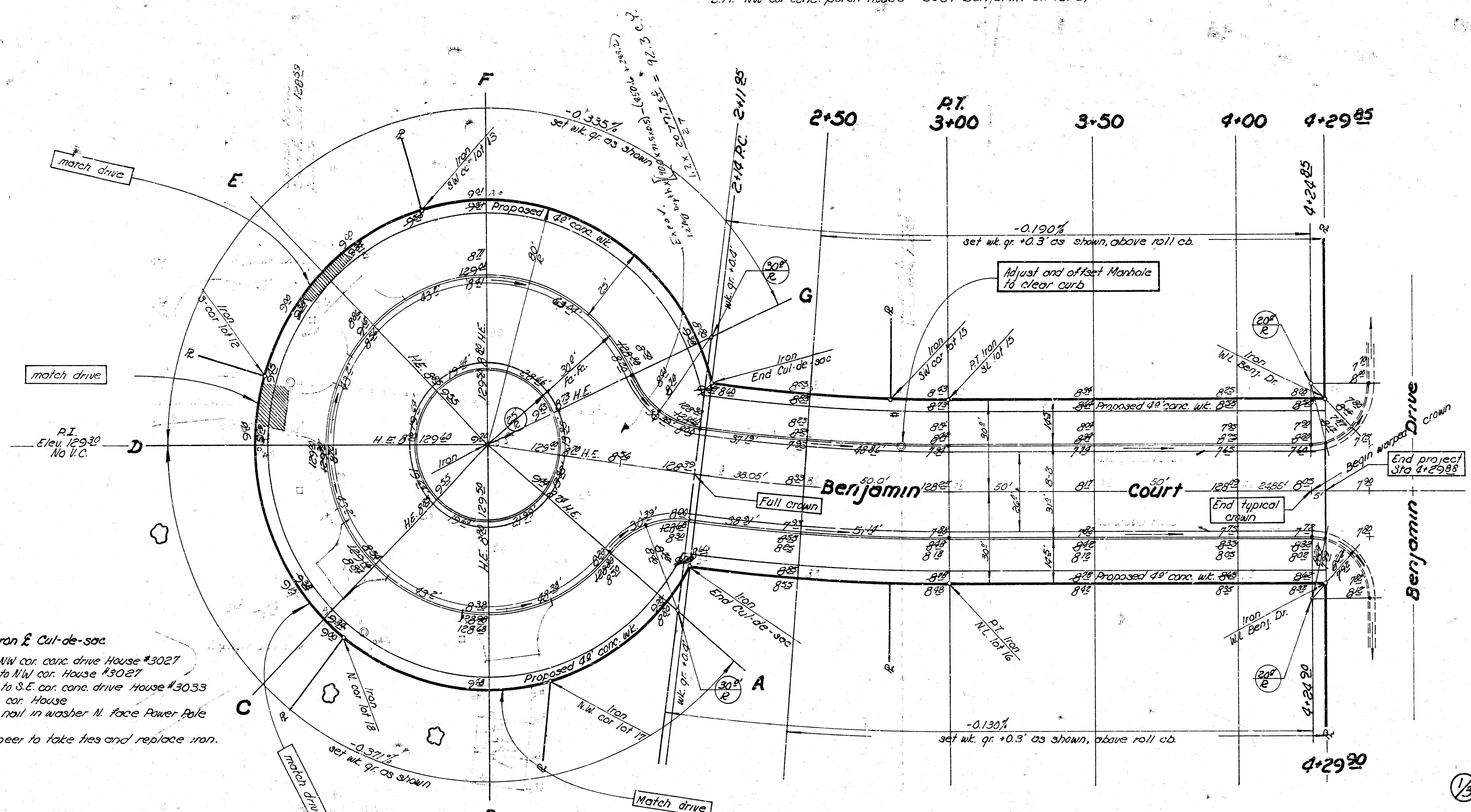

- General Notes
- Contractor to clear Right-of-way, grade parking and compact fill in sidewalk areas. Sidewalk to be constructed by others.
  - Type of subgrade treatment shall be as determined by the Field Engineer. Subgrade treatment may consist of lime treatment, cement treatment, subgrade modification, or any combination of the above.
  - Contractor to fill median area with select excavated material and grade to drain as shown by plan.
  - Contractor to overlay existing asphalt drive approach surface material to adjust drive elevations to match proposed walk elevations. Exact limits of asphalt overlay shall be determined by the Field Engineer, such as to provide adequate driveway drainage.
  - Median curb shall be paid for as standard combined curb and gutter. (See detail)
  - All irons on this project affected by any construction shall be protected by both the Engineer and contractor.
  - Item of "Barrow Material" is to include all costs of acquiring, excavating, and delivering material to the project for the use of compacted and loose fill.
  - Construct roll curb except an island in cul-de-sac.
  - Roll curb shall be depressed through drives constructed as in conjunction with this project.

Ties to Iron & Cul-de-sac

- 80' S. to NW cor. conc. drive House #3027
- 128' S.W. to NW cor. House #3027
- 140' N.W. to S.E. cor. conc. drive House #3033
- 123' N. to cor. House
- 141' E. to nail in washer N. face Power Pole

Field Engineer to take ties and replace iron.

$\Delta = 72.43^\circ R = 660.34' T = 43.06' L = 86' LC = 85.94'$

CURVE DATA BASED ON $\frac{Q}{R}$				RAD. $\Delta = 3.4352^\circ$	
STA.	ARC.	CHORD LENGTH	CHORD BEARING	DEFLECTION	TOTAL DEFLECTION
		$\frac{C}{2}$ OFF N.C.B.	$\frac{C}{2}$ OFF S.C.B.		
2+14	—	—	—	0°00'00"	0°00'00"
2+50	36'	34.74'	37.25'	1°33'43"	1°33'43"
3+00	50'	48.25'	51.73'	2°10'09"	3°43'52"

Earthwork

Excavation $397.5 \text{ Cu. yds.}$	Camp. Fill $53.2 \text{ Cu. yds.}$
+10% $437.3 \text{ Cu. yds.}$	+10% $5.3 \text{ Cu. yds.}$
<b>Total 437.3 Cu. yds.</b>	<b>Total 58.5 Cu. yds.</b>

Barrow Excavation  
100 Cu. yds.

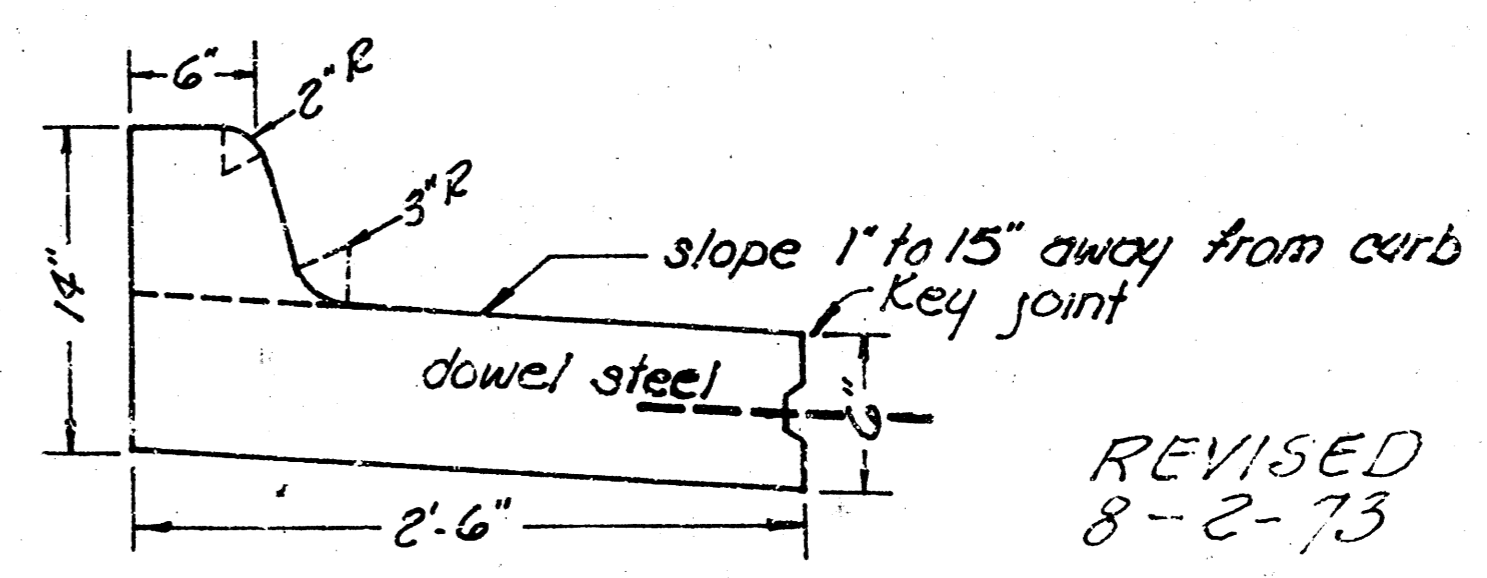

Detail of full curb-comb. curb & gutter to be used in center of Cul-de-sac

Benjamin Court  
 W. Benjamin Drive to and including Cul-de-sac  
 Asphaltic concrete Pavement  
 3" B-B with comb. cb. & gr.  
 City of Wichita, Kansas  
 R.W. Linn City Engineer  
 Project No. DAK5573010  
 Date: June 1973