

B.M. 102.34 = 40 Nail SS 1/8" Cap on SW Cor. Pulpit f. Bellaire  
 B.M. 102.47 = SE Cor North Porch E.S. Ho. on Bellaire Court

BELLAIRE AVENUE

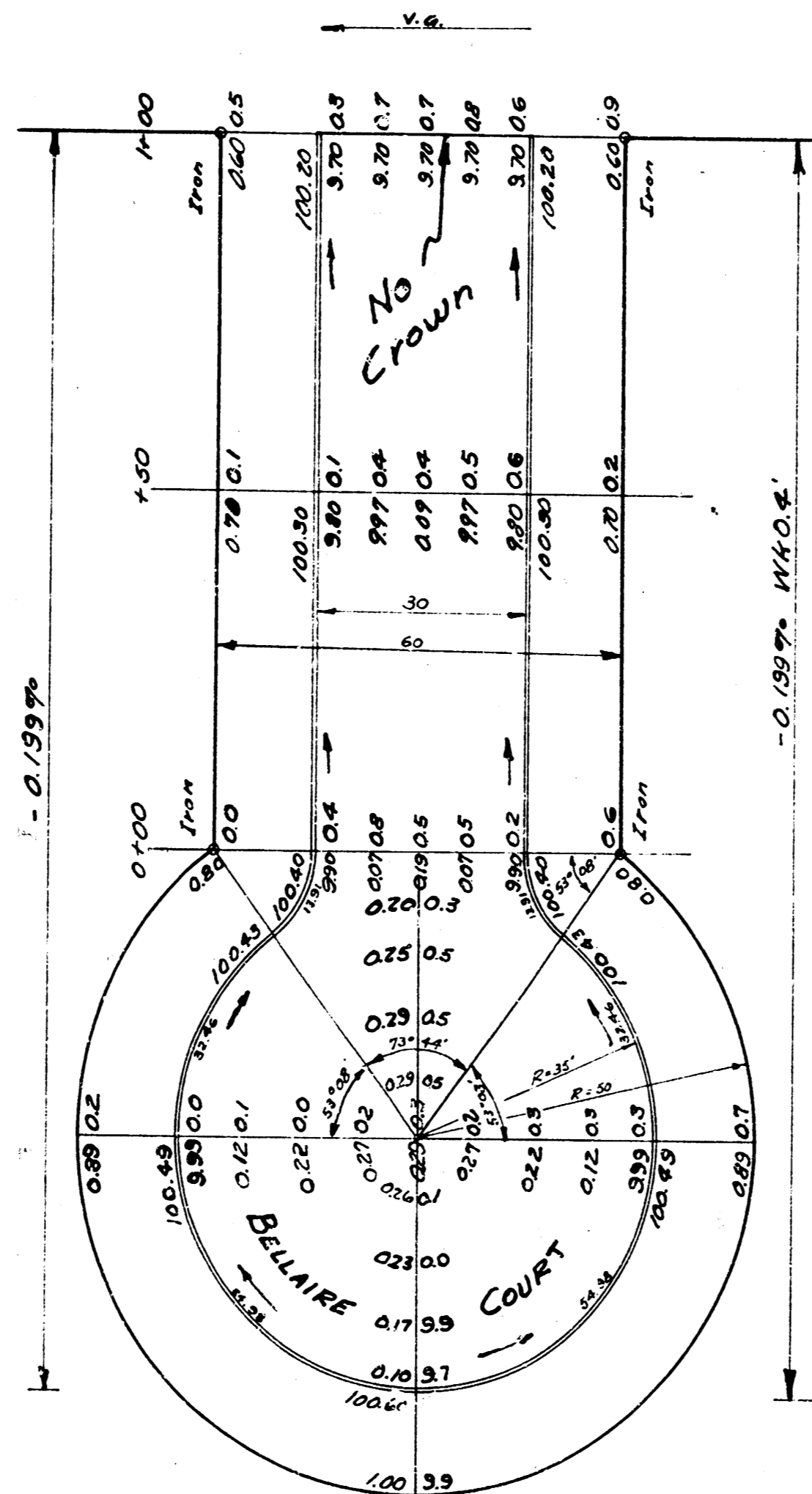

BELLAIRE COURT  
 30' CONCRETE CURB  
 CITY OF WICHITA  
 BE SMITH CITY ENGINEER  
 APRIL 1954 PROJ. No. C13-206

APR 1954  
 D.S.