

STATE	PROJECT NO.	FISCAL YEAR	SHEET NO.	TOTAL SHEETS
KANSAS		1957	1	8



BRIDGE & GRADING  
BRIDGE NO. 823-K-2160

**INDEX OF SHEETS.**

SHEET NO.	TITLE SHEET
1	TITLE SHEET
2	PLAN & PROFILE
3	CONSTRUCTION LAYOUT
4	REINFORCING DETAILS
5	AUXILIARY DETAILS
6	STANDARD PILE DETAIL
7	SUPPORTS, SPACERS AND EXCAVATION
8	CROSS SECTIONS

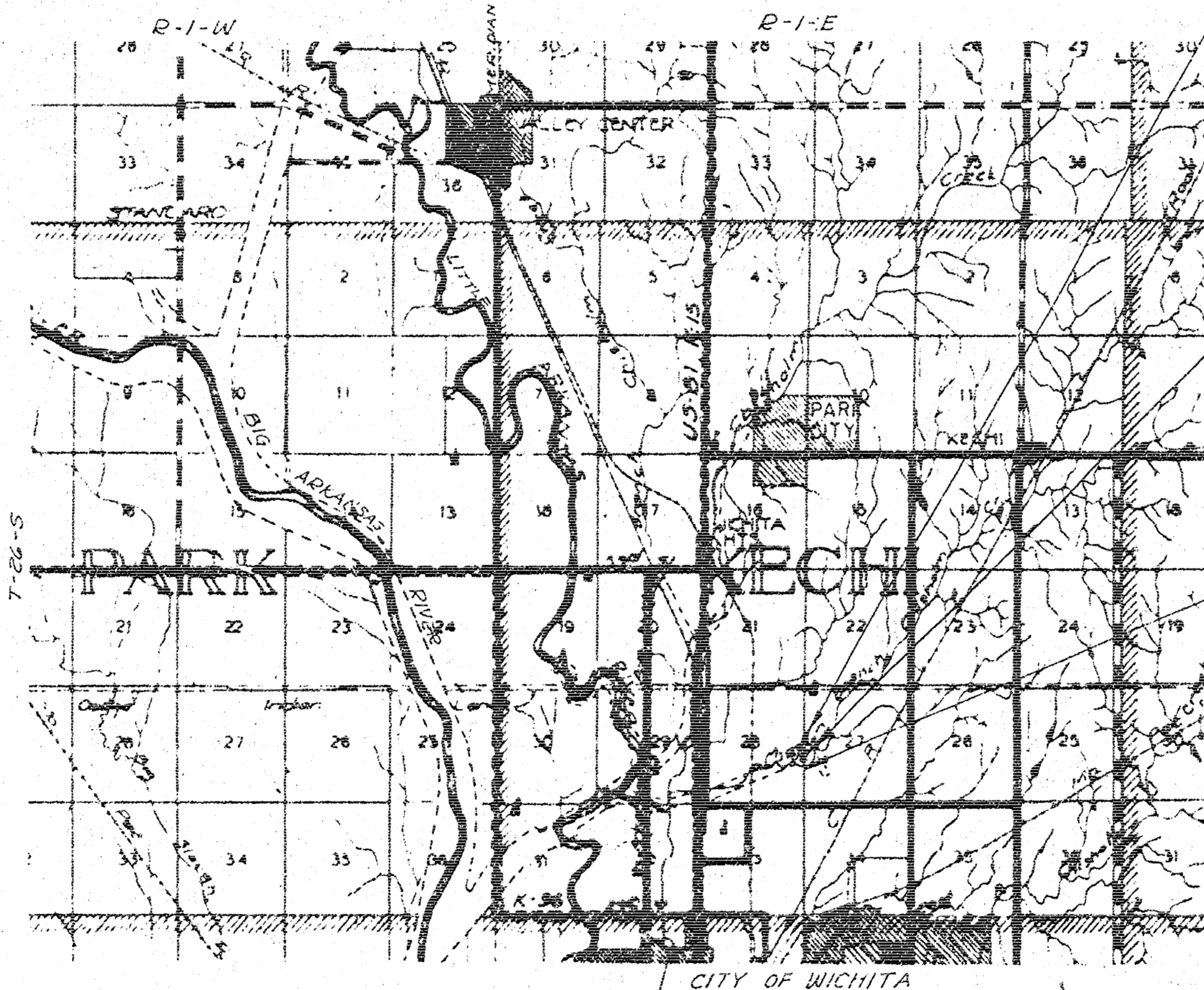
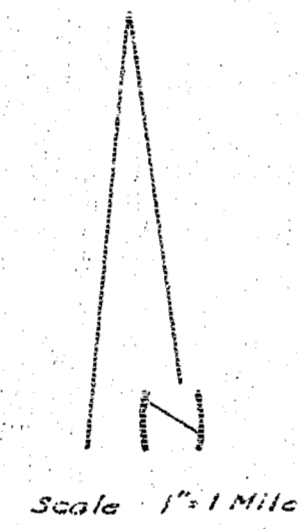

PROJECT ENDS  
STA. 14+95

Sta. 21+59.67 Const. 34'-3@37'0"-34'-  
Continuous Prestressed Concrete Beam Bridge,  
On Precast Or Prestressed Concrete Piling,  
Open Type Abutment & Piers.  
26' Roadway - Concrete Railing.

TRAFFIC COUNT - 333 CARS PER DAY

PROJECT BEGINS  
STA. 27+14

APPROVED FOR CORPS OF ENGINEERS  
TULSA DISTRICT  
*(Signature)* DATE 21 May 57

**CONVENTIONAL SIGNS**

COUNTY LINE	-----
SECTION LINE	- - - - -
WIRE FENCE	=====
HEDGE ROW	~~~~~
RAILROADS	-----
SURVEY LINE	-----
RIGHT OF WAY	-----
TELEPHONE POLE	-----
POWER POLE	-----
TRAVELED WAY	-----

NET LENGTH OF PROJECT	1350 FT	.255 MILES
NET LENGTH OF BRIDGES	181.5 FT	.03437 MILES
NET LENGTH OF ROAD	1168.5 FT	.221 MILES
EXCEPTIONS	NONE FT	NONE MILES
ADDITONS	NONE FT	NONE MILES
GROSS LENGTH OF PROJECT	1356 FT	.255 MILES

PLANS PREPARED BY

Sedgwick County Engrg. Dept.

DATE February 1957

APPROVED

*(Signature)*  
CHAIRMAN  
BOARD OF COUNTY COMMISSIONERS

APPROVED

*(Signature)*  
COUNTY ENGINEER

DATE

APPROVED

DATE



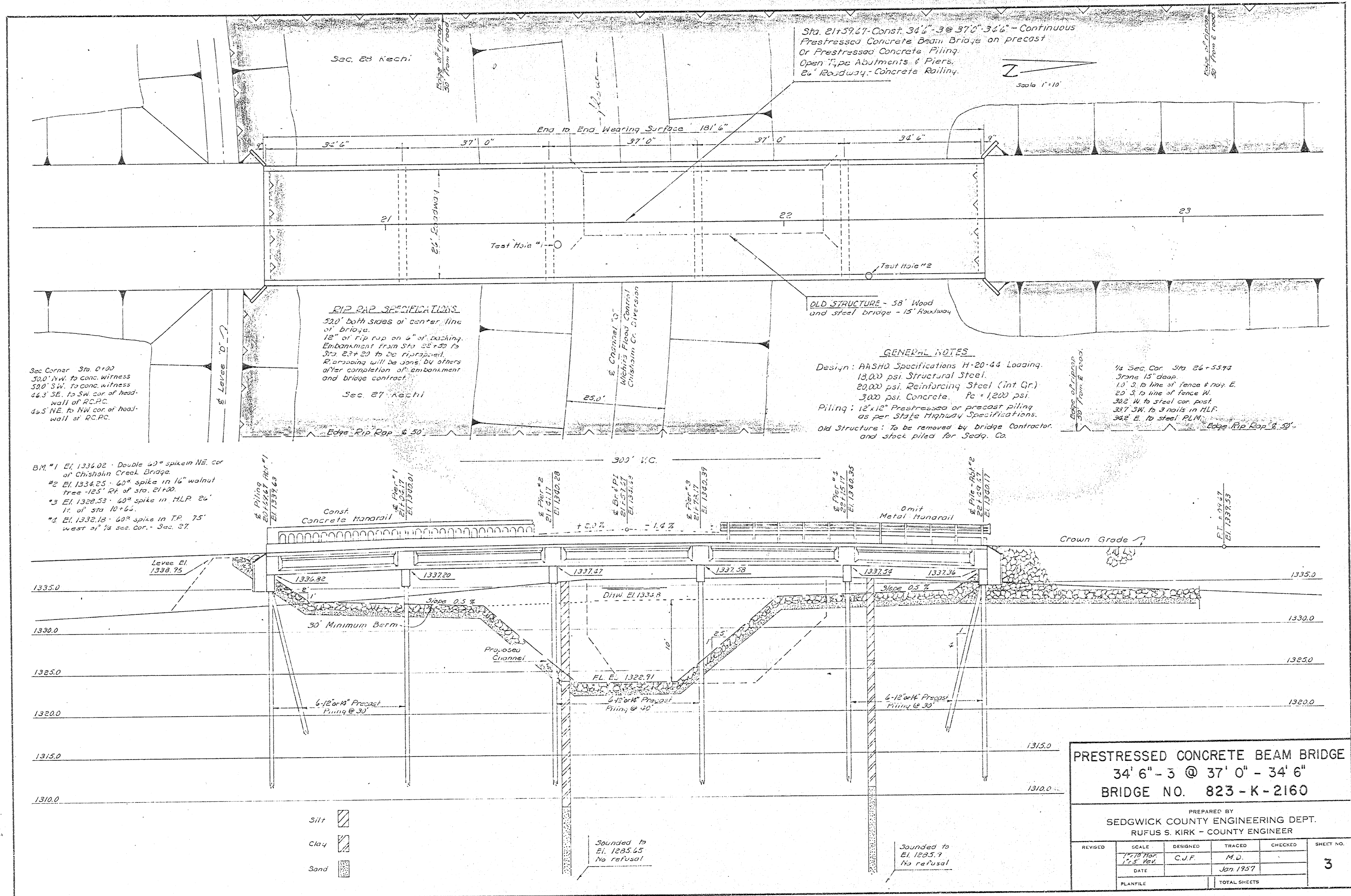

Sta. 21+59.67 Const. 34' 6" - 3 @ 37' 0" - 34' 6" - Continuous Prestressed Concrete Beam Bridge on precast Or Prestressed Concrete Piling. Open Type Abutments & Piers. 6" Roadway - Concrete Railing.

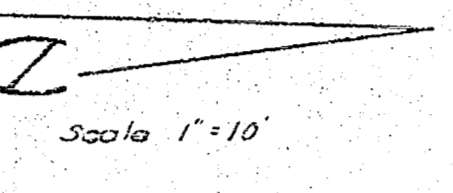

**RIP RAP SPECIFICATIONS**  
 50' both sides of center line of bridge.  
 12" of rip rap on 4" of backing.  
 Embankment from Sta 22+50 to Sta 23+20 to be riprapped.  
 Riprapping will be done by others after completion of embankment and bridge contract.

**GENERAL NOTES**  
 Design: AASHTO Specifications H-20-44 Loading.  
 18,000 psi Structural Steel.  
 20,000 psi Reinforcing Steel (int Gr)  
 3,000 psi Concrete.  $f_c = 1,200$  psi.  
 Piling: 12"x12" Prestressed or precast piling as per State Highway Specifications.  
 Old Structure: To be removed by bridge contractor and stock piled for Sedg. Co.

1/4 Sec. Cor. Sta 26+53.12  
 3rns 15' deep.  
 15' 3" to line of fence & noy. E.  
 29' 3" to line of fence W.  
 30' 2" W. to steel cor post.  
 327' SW. to 3 nails in HLP.  
 348' E. to steel PLM.

Sec Corner Sta. 0+00  
 50.0' NW. to conc. witness  
 50.0' SW. to conc. witness  
 44.3' SE. to SW cor of head-wall of R.C.P.C.  
 46.5' NE. to NW cor. of head-wall of R.C.P.C.

**PRESTRESSED CONCRETE BEAM BRIDGE**  
 34' 6" - 3 @ 37' 0" - 34' 6"  
 BRIDGE NO. 823 - K - 2160

PREPARED BY  
 SEDGWICK COUNTY ENGINEERING DEPT.  
 RUFUS S. KIRK - COUNTY ENGINEER

REVISED	SCALE	DESIGNED	TRACED	CHECKED	SHEET NO.
	1" = 10' Hor	C.J.F.	M.D.		3
	12" = 12' Ver				
	DATE	Jan 1957			
	PLANFILE	TOTAL SHEETS			

