

Scale: 1"=100'

**BLECKLEY DRIVE
DRAINAGE PROJECT**
CITY OF WICHITA KANSAS

BLECKLEY DRIVE DRAINAGE PROJECT CITY OF WICHITA KANSAS

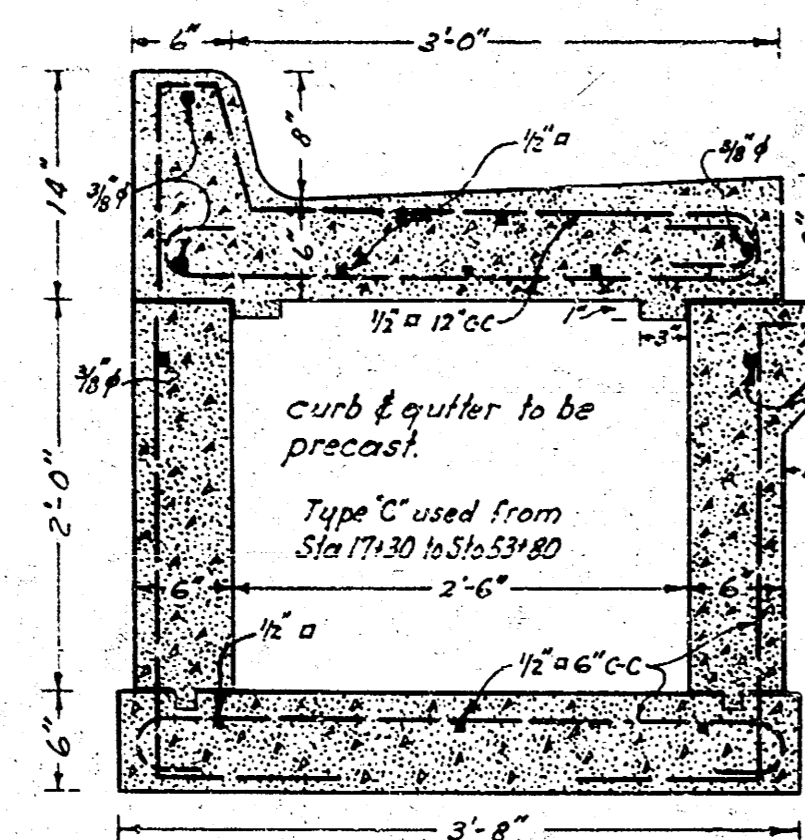

CROSS SECTION OF TYPE 'C'
Scale: 1"=1'-0"

Note: Curb & gutter is to be replaced with 1" slab across intersections.

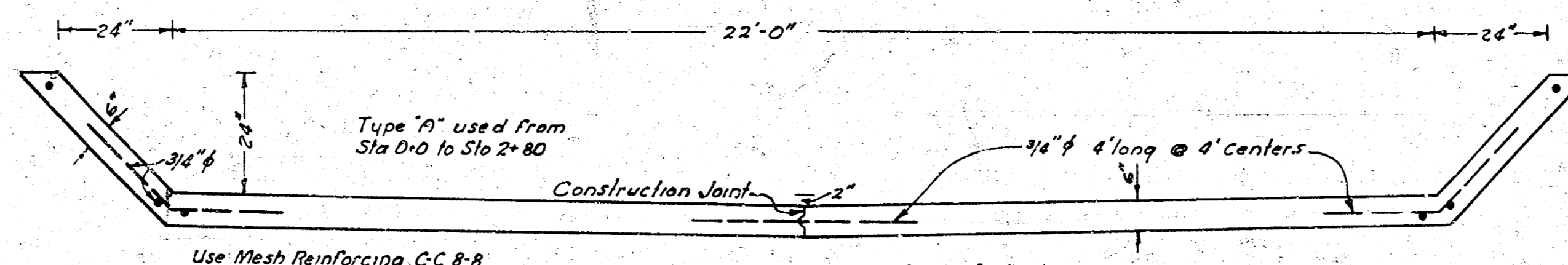

CROSS SECTION OF TYPE 'A'
Scale: 1/2"=1'-0"

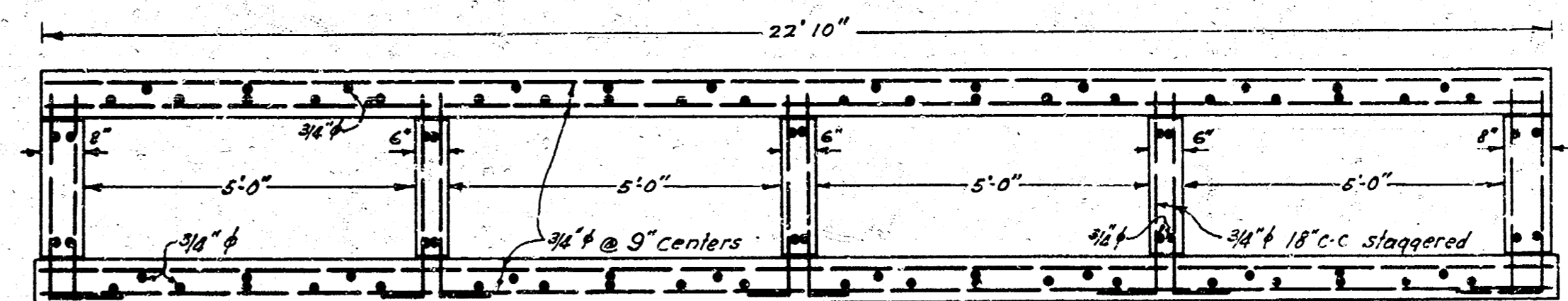

CROSS SECTION OF CULVERT
Scale: 1/2"=1'-0"
100' Long
Sta 59+50 to Sta 60+50

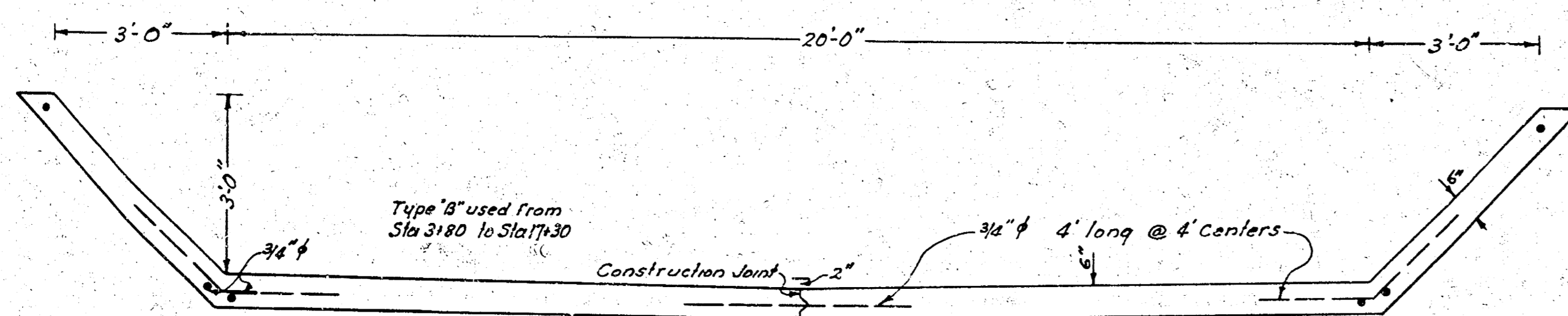

CROSS SECTION OF TYPE 'B'
Scale: 1/2"=1'-0"

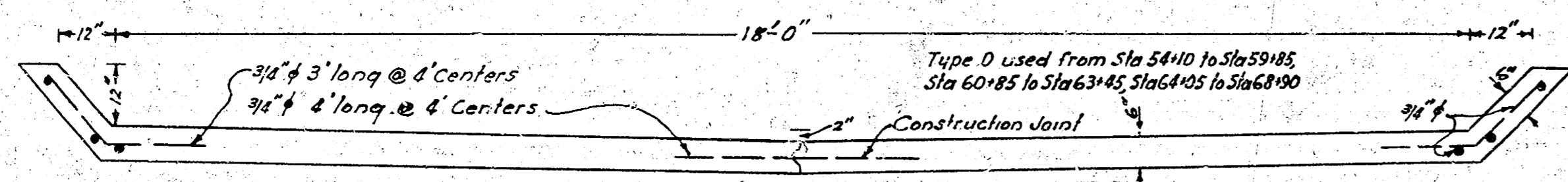

CROSS SECTION OF TYPE 'D'
Scale: 1/2"=1'-0"

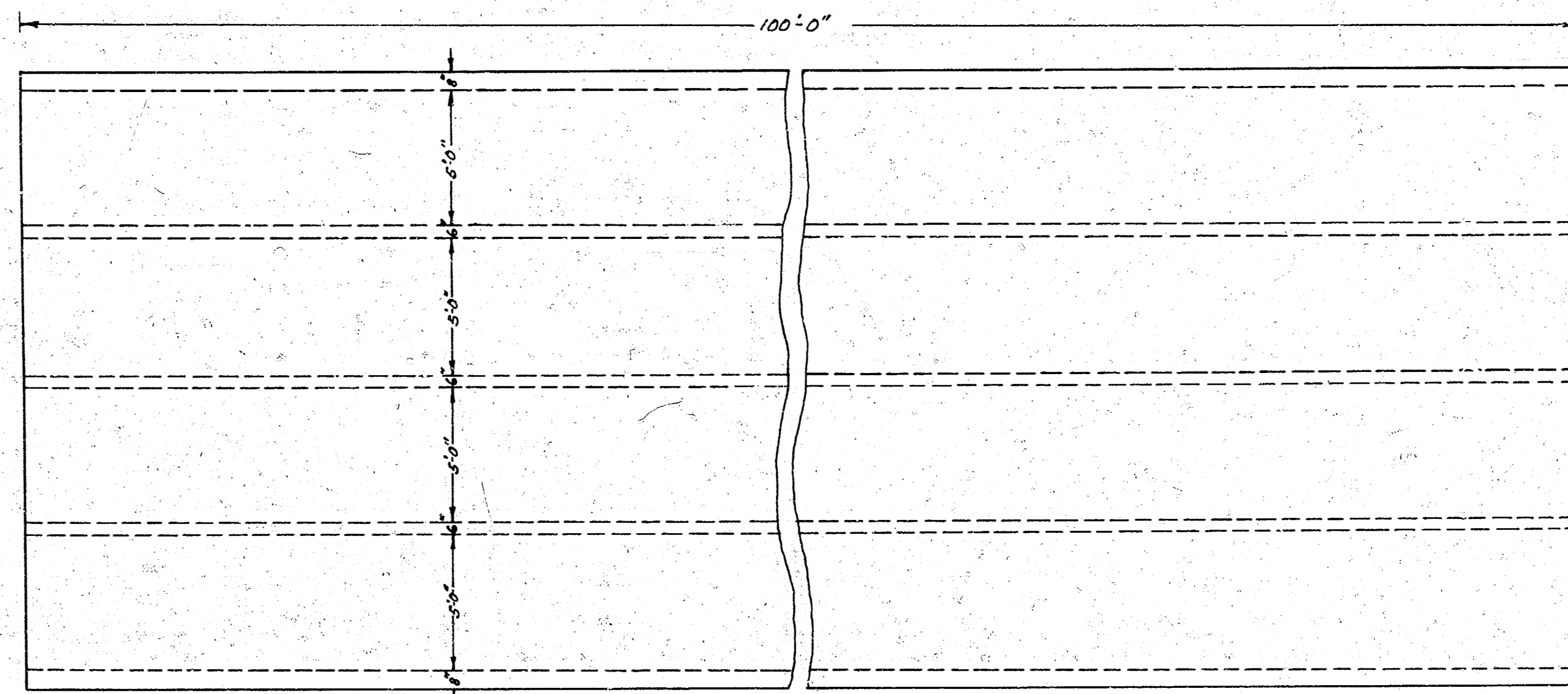

PLAN OF CULVERT
Scale: 1/2"=1'-0"
Sta 59+50 to Sta 60+50

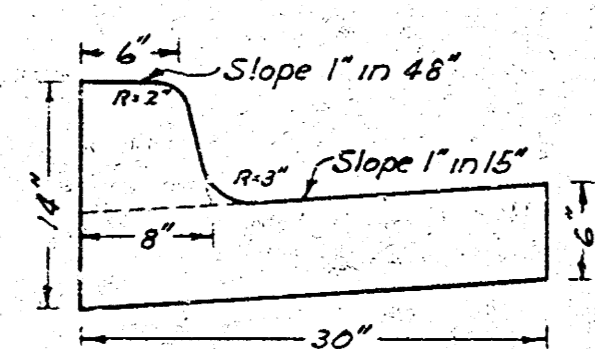

STANDARD SECTION OF COMBINED CURB & GUTTER
Scale: 1"=1'-0"

Sta 4 to Sta 19 Sta 24 to Sta 25
Sta 30 to Sta 31 Sta 3180 to Sta 3180
Sta 37+50 to 38+50 Sta 42 to Sta 44
Sta 46 to Sta 48+50 Sta 52 to Sta 60 (on Bleckley Drive)
600' C&G on Elm St. 600' C&G on Pine St.
Sta 71 to Sta 74 on Harding Ave.

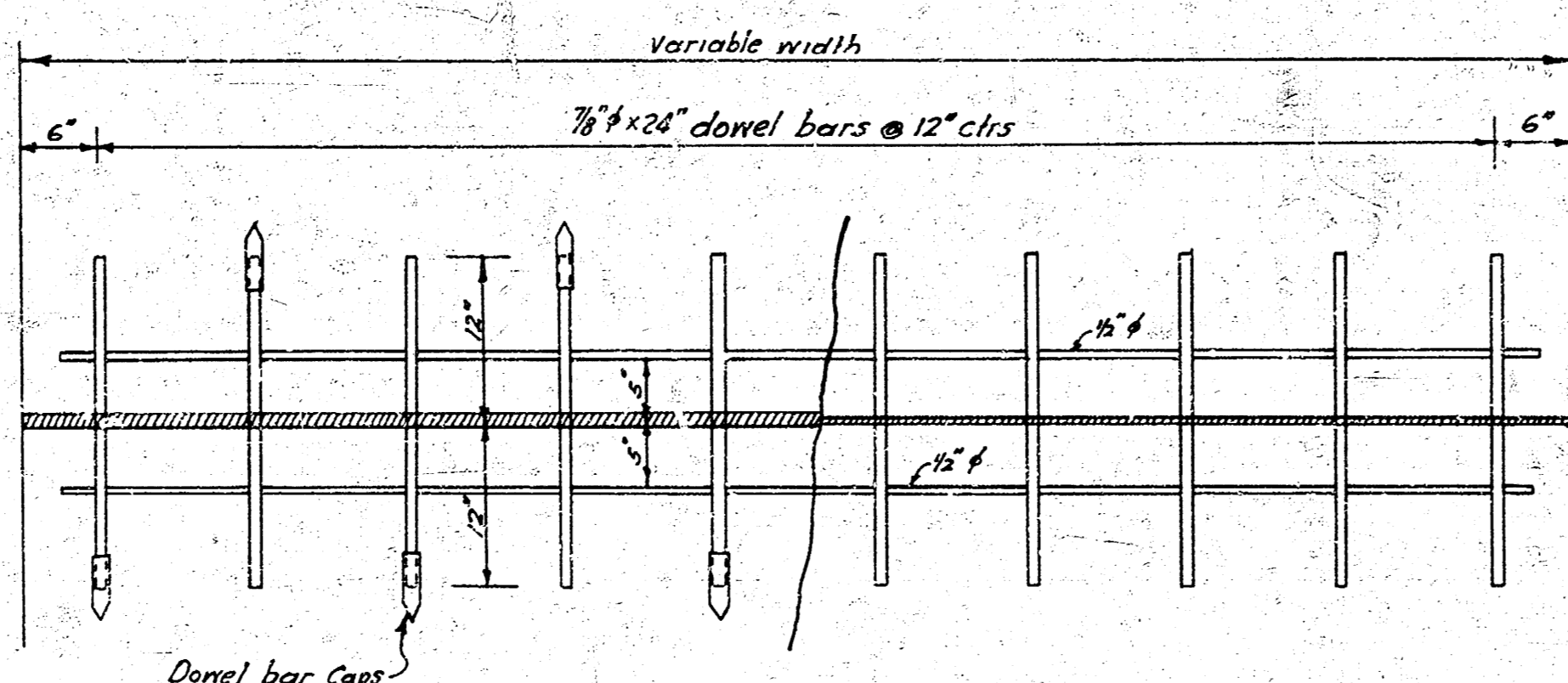

PART PLAN OF EXPANSION JOINT
120' C-C

PART PLAN OF CONTRACTION JOINT
40' C-C

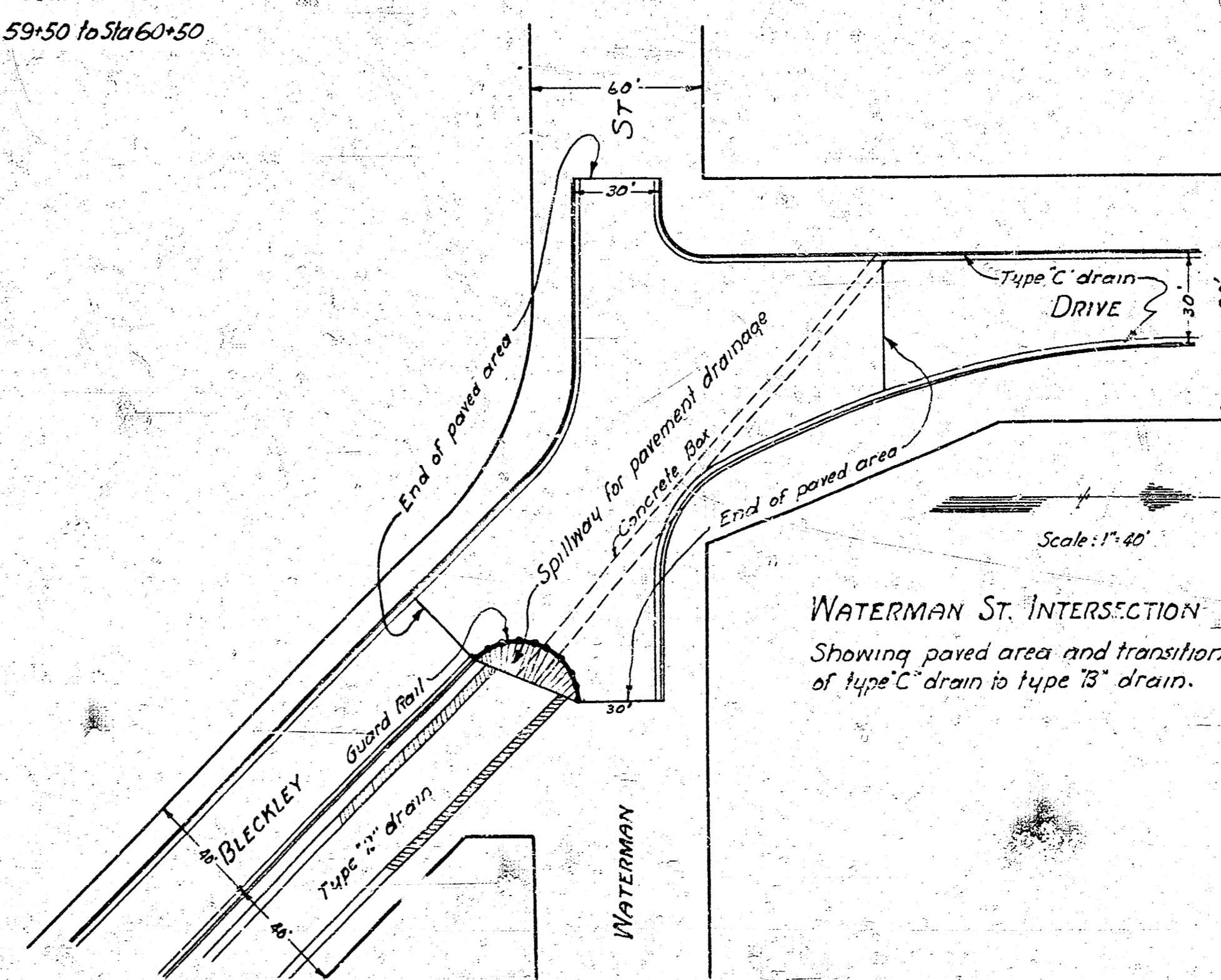

WATERMAN ST. INTERSECTION
Showing paved area and transition of Type 'C' drain to Type 'B' drain.
Scale: 1"=40'

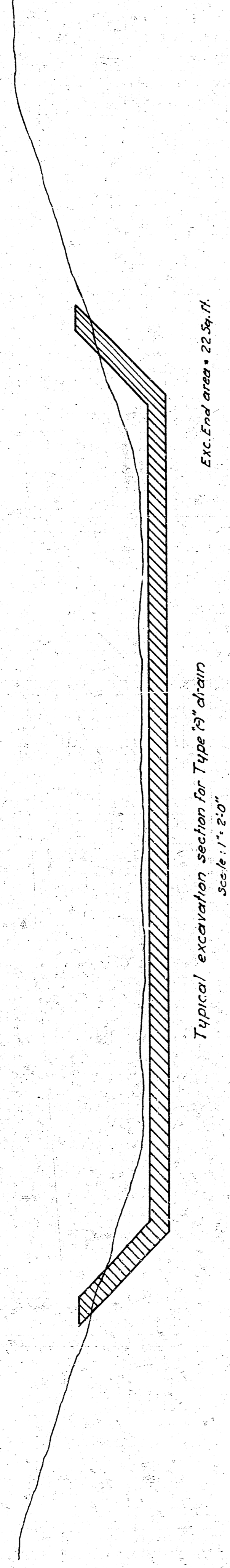

Typical excavation section for Type "B" drain

Scale: 1" = 2'-0"

Exc. End area = 22 Sq. Ft.

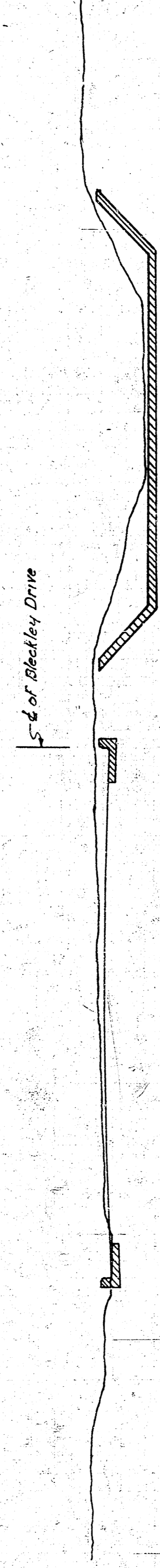

Typical excavation section for Type "C" drain and standard curb splitter.

Scale: 1" = 2'-0"

Exc. End area = 45 Sq. Ft.

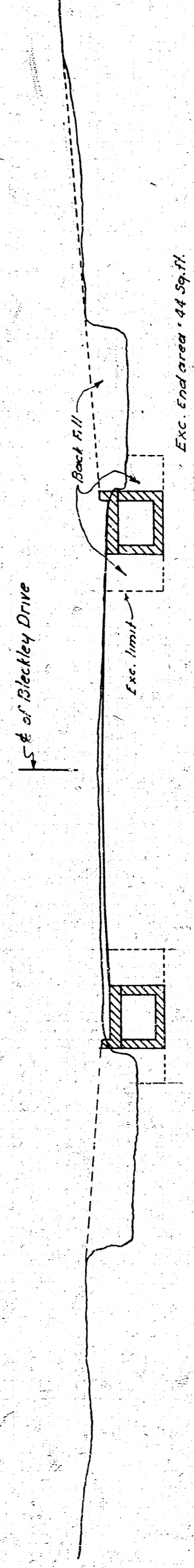

Typical excavation section for Type "C" drain

Scale: 1" = 2'-0"

Exc. End area = 44 Sq. Ft.

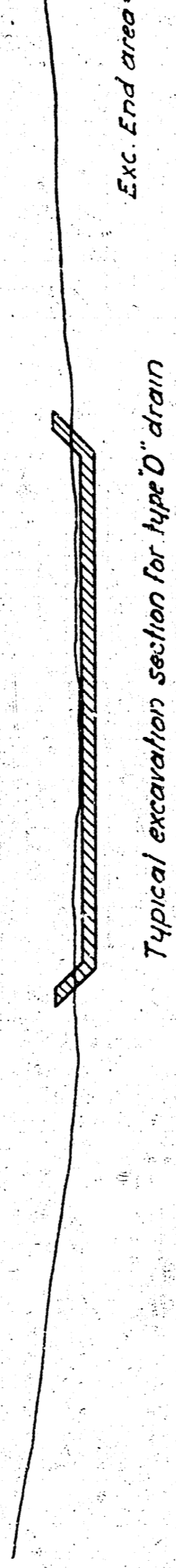

Typical excavation section for Type "D" drain

Scale: 1" = 2'-0"

Exc. End area = 20 Sq. Ft.

**BLECKLEY DRIVE
DRAINAGE PROJECT
CITY OF WICHITA KANSAS**

BLECKLEY DRIVE DRAINAGE PROJECT CITY OF WICHITA KANSAS

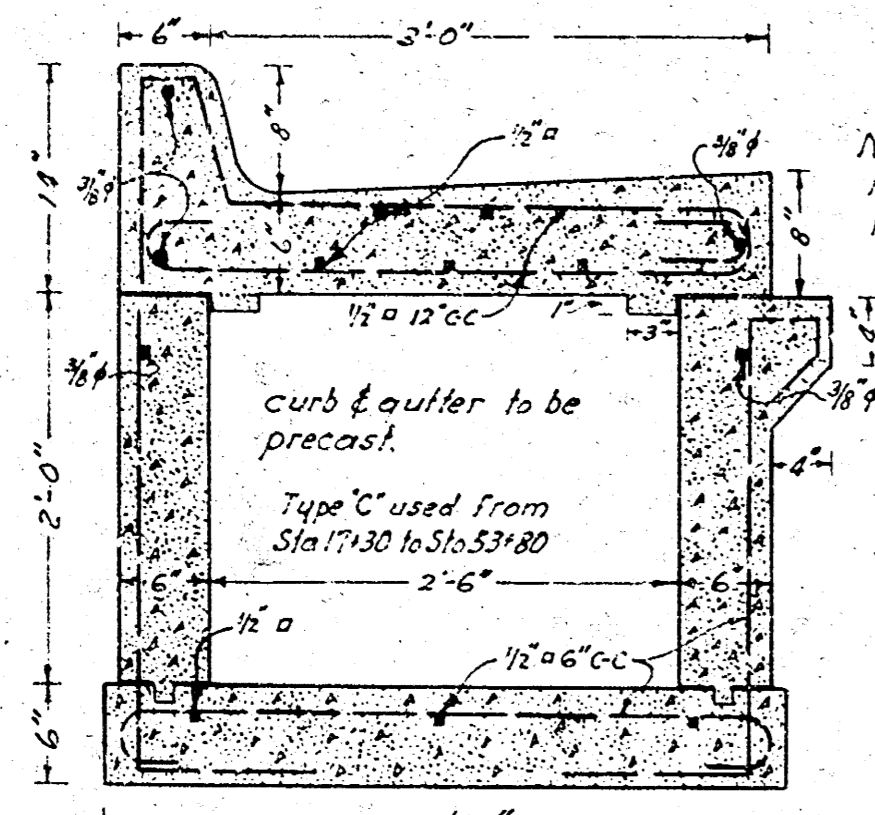

CROSS SECTION OF TYPE 'C'
Scale: 1"=1'-0"

Note: Curb & gutter is to be replaced with 1" slab across intersections.

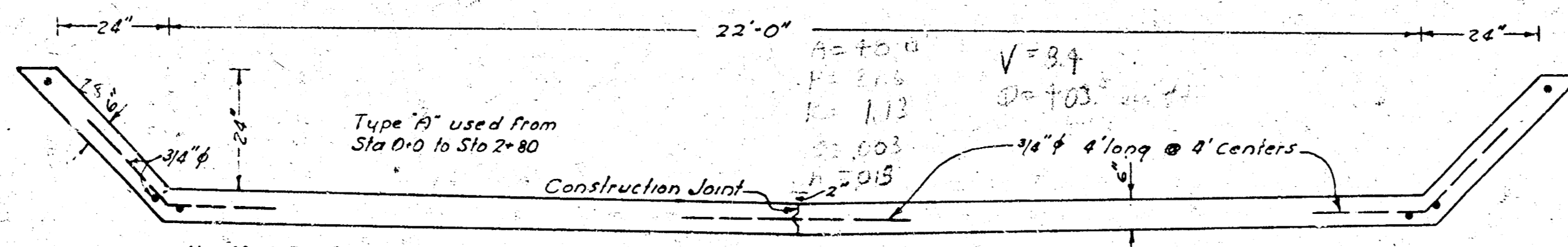

CROSS SECTION OF TYPE 'A'
Scale: 1"=1'-0"

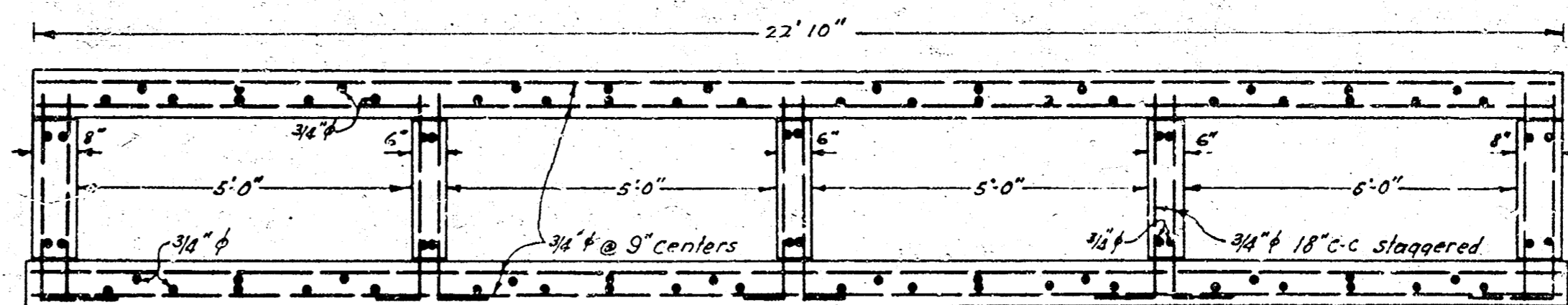

CROSS SECTION OF CULVERT
Scale: 1/4"=1'-0"
100' Long
Sta 59+50 to Sta 60+50

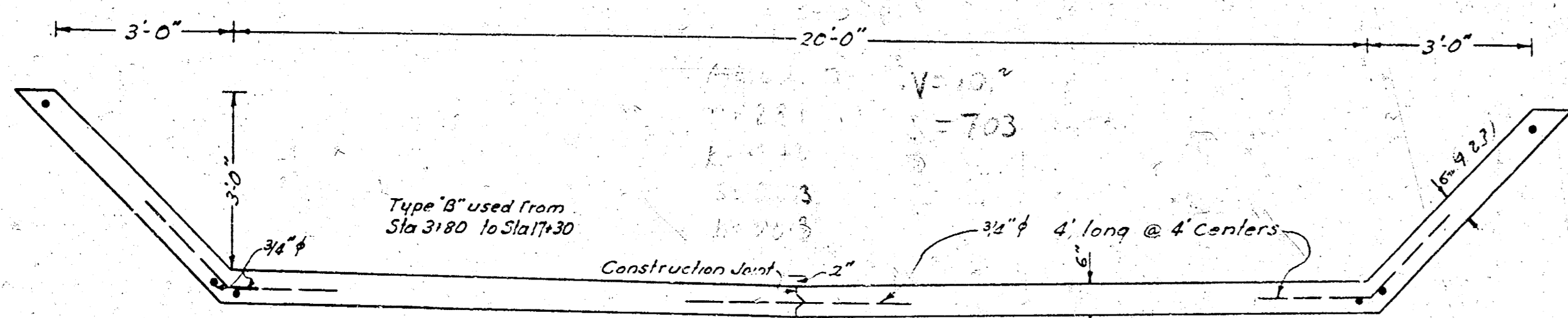

CROSS SECTION OF TYPE 'B'
Scale: 1"=1'-0"

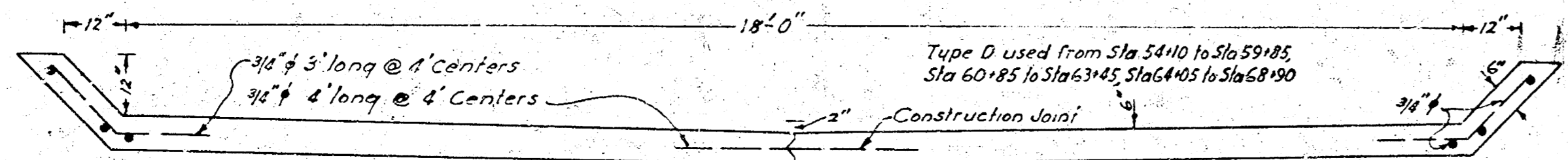

CROSS SECTION OF TYPE 'D'
Scale: 1"=1'-0"

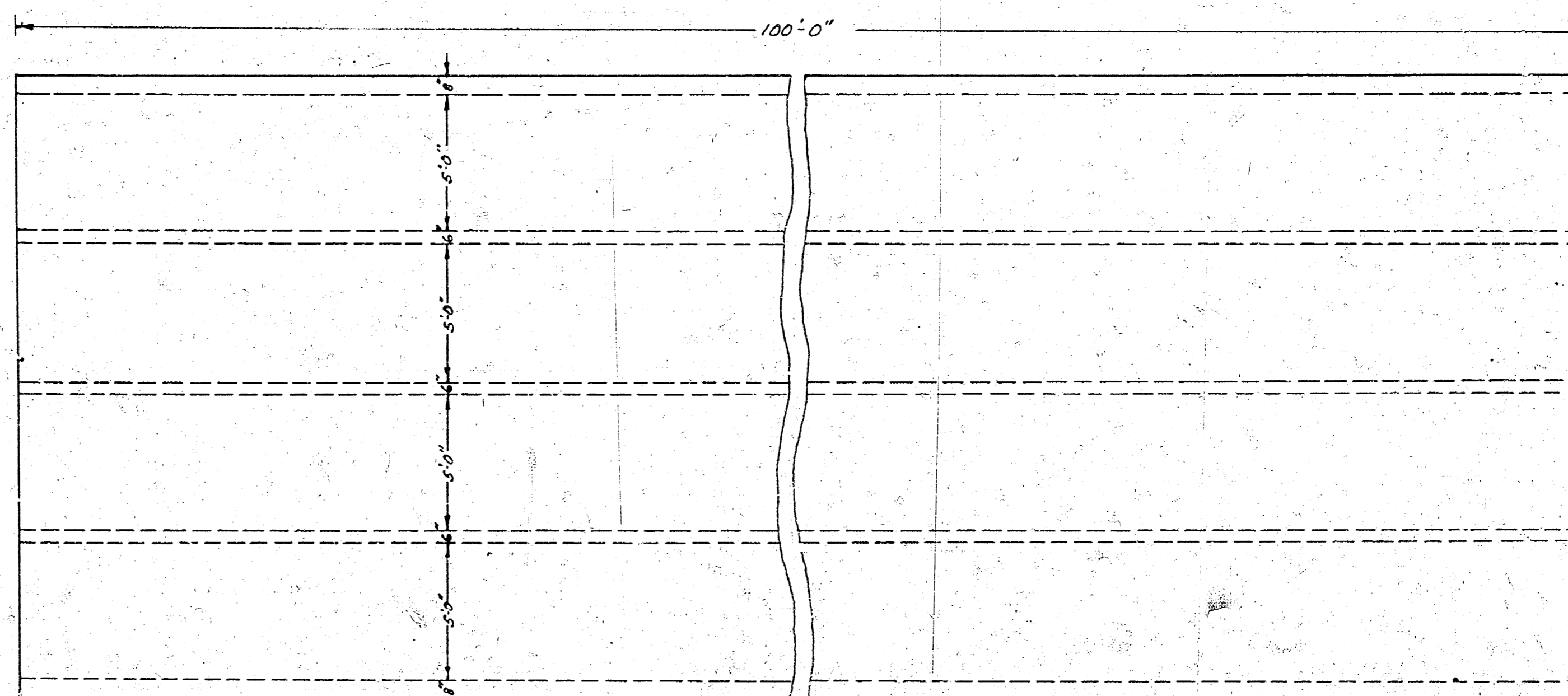

PLAN OF CULVERT
Scale: 1/4"=1'-0"
Sta 59+50 to Sta 60+50

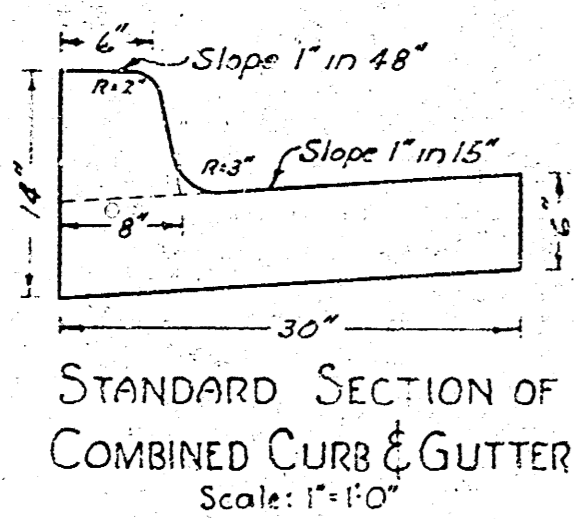

STANDARD SECTION OF COMBINED CURB & GUTTER
Scale: 1"=1'-0"

Sta 2 to Sta 19 Sta 24 to Sta 25
Sta 30 to Sta 31 Sta 31 to Sta 32
Sta 32 to Sta 33 Sta 33 to Sta 34
Sta 44 to Sta 45 Sta 52 to Sta 60 (on Bleckley Drive)
60' C&G on Elm St. 80' C&G on Pine St.
Sta 71 to Sta 74 on Harding Ave.

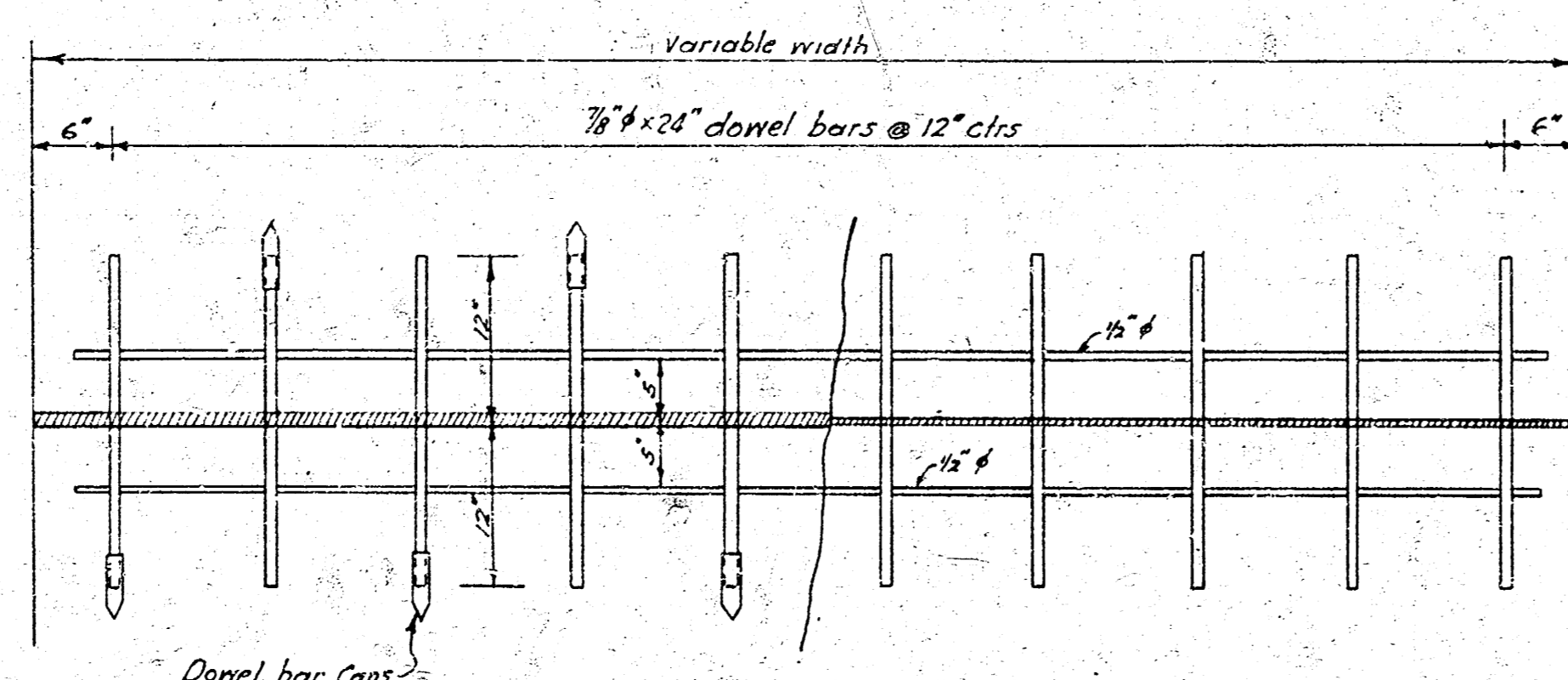

PART PLAN OF EXPANSION JOINT
120' C-C

PART PLAN OF CONTRACTION JOINT
40' C-C

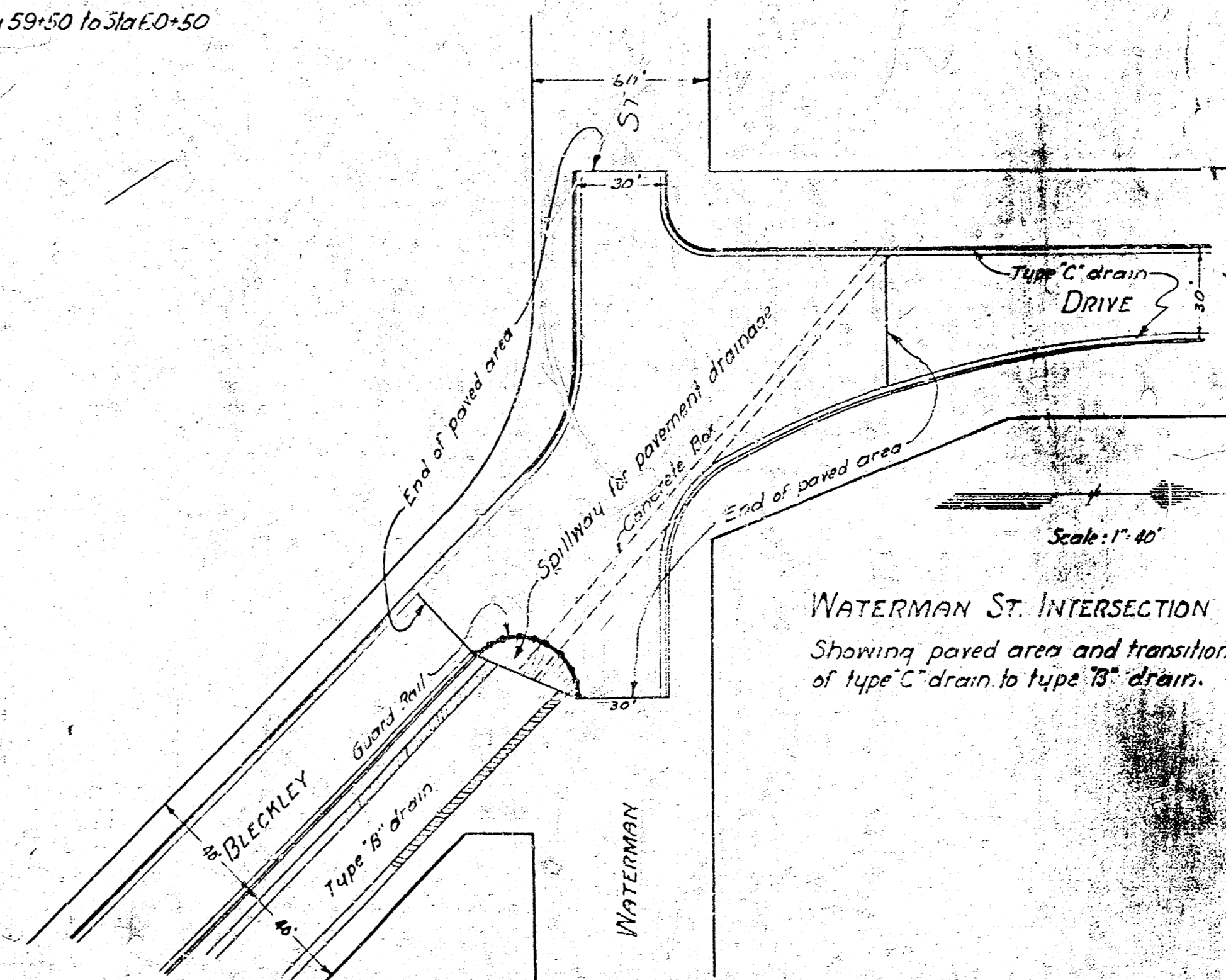

WATERMAN ST. INTERSECTION
Showing paved area and transition
of type 'C' drain to type 'B' drain.