

CITY PLANNING COMMISSION
PREPARED BY WORKS PROGRESS ADMINISTRATION

DRAWN BY R.E.FRIZZELLE. CHECKED BY L.K.WHITE.

SUPERVISED BY H.S.DENISON

1936 INST. MAN L. HANDLEY SCALE 1"=100 FEET

N.W. $\frac{1}{4}$ SEC 14 T. 27 S. R. 1 E.

BM#2 NAIL IN FIRST TELEPHONE POLE EAST OF R.R.
TRACKS ON 13TH ST. ELEV. 1977

BM#12 CROSS ON S.E. CURB AT YALE & 9TH ELEV. 18405

BM#13 NAIL IN TEL. POLE S.E. CORNER 9TH & ROOSEVELT
ELEV. 183.38

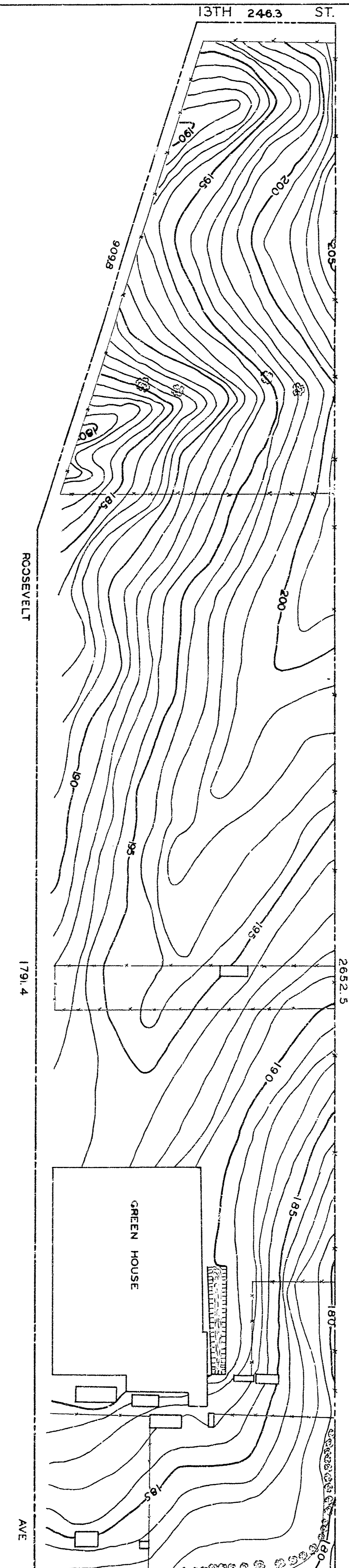
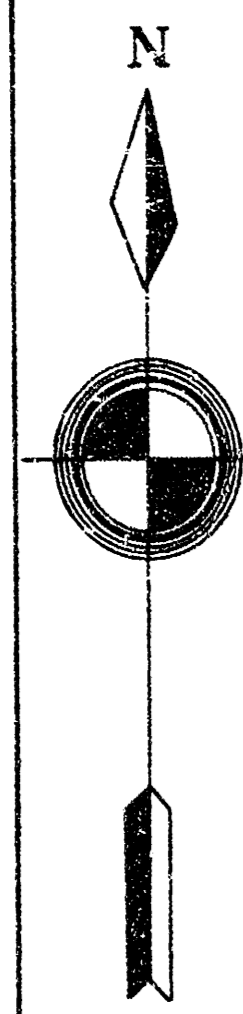

CITY PLANNING COMMISSION
PREPARED BY WORKS PROGRESS ADMINISTRATION
DRAWN BY R.E. FRIZZELLE CHECKED BY L.K. WHITE
SUPERVISED BY H.S. DENISON
1936 INST. MAN L. HANDLEY SCALE 1"=100 FEET

N.W. 1/4 SEC 14 T. 27 S. R. 1 E.

- BM#2 NAIL IN FIRST TELEPHONE POLE EAST OF R.R. TRACKS ON 13TH ST. ELEV. 197.7
- BM#12 CROSS ON S.E. CURB AT YALE & 9TH ELEV. 184.05
- BM#13 NAIL IN TEL. POLE S.E. CORNER 9TH & ROOSEVELT ELEV. 183.38

