

**KELLOGG STREET
(U.S. 54 HIGHWAY)**

W.L. CHAUTAUQUA AVENUE TO E.L. EDGEWOOD DR.

PROJECT NO. C18-16

STATE PROJECT NO. 54-87K 5204(2) Agreement No. 46-67

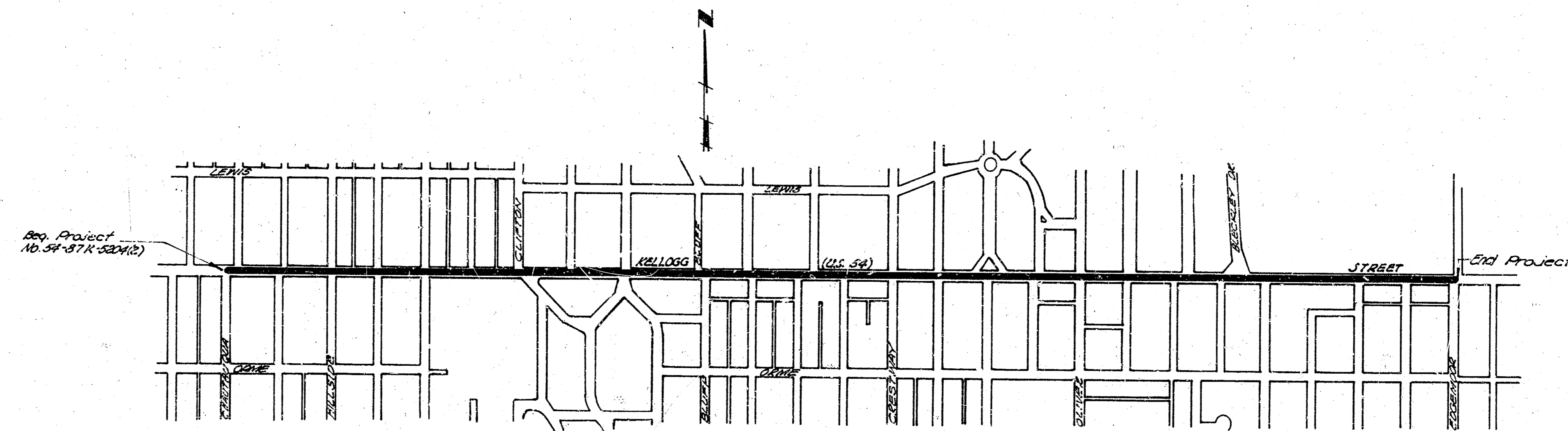

Approved _____ Date _____
STATE HIGHWAY ENGINEER
State Highway Commission of Kansas

Approved _____ Date 5-23-68
CITY ENGINEER
Department of Public Safety
City of Wichita, Kansas

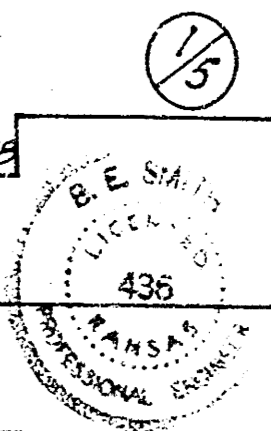

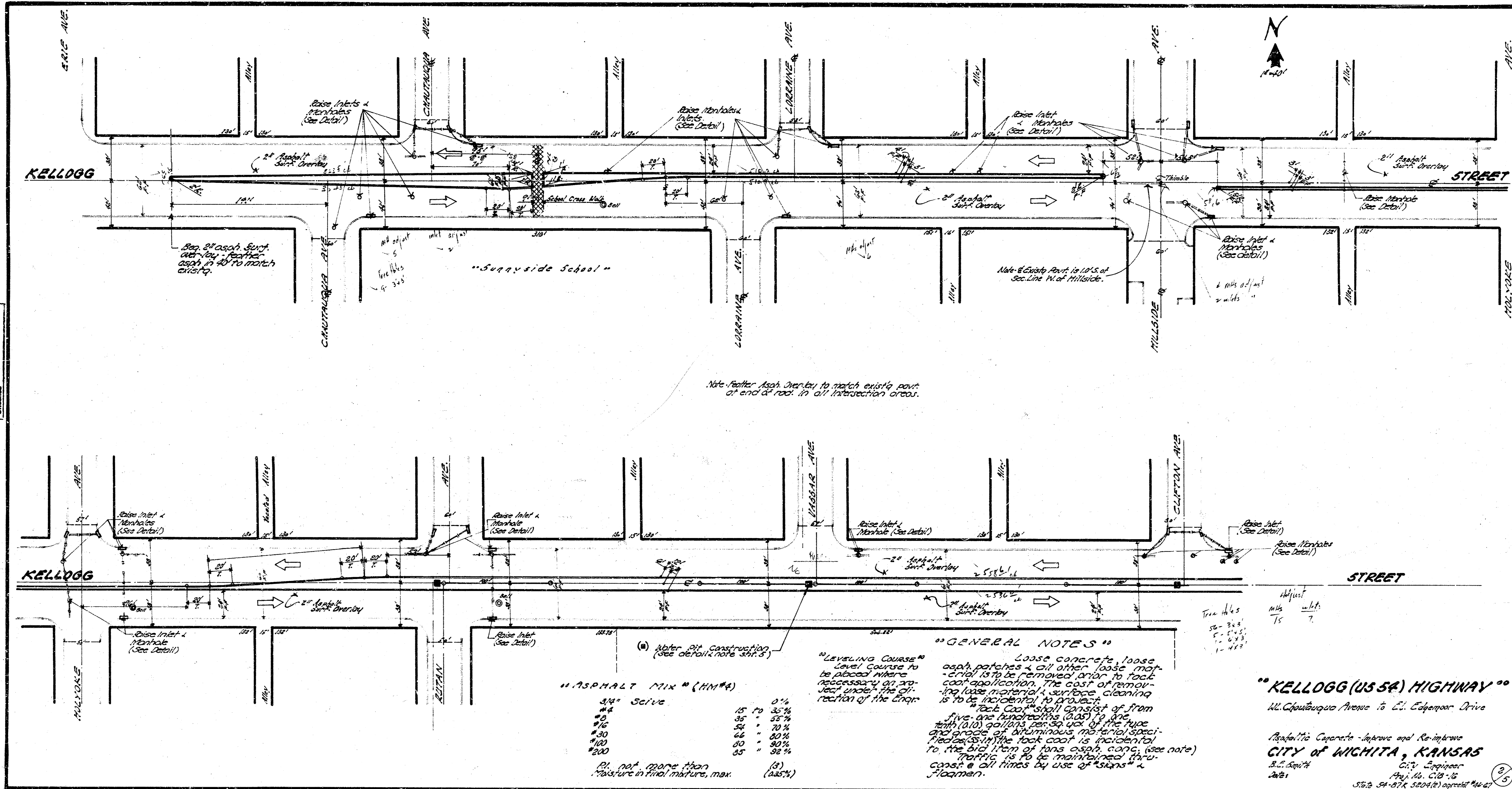

Survey
 Plan
 City of
 Wichita
 Kansas

Note: Better Asphalt Overlay to match existing point of end of road in all intersection areas.

(a) Water for construction (See detail note 347.5)

ASPHALT MIX (HM#4)

| | | |
|------------|----|-----|
| 3/4" Sieve | 15 | 35% |
| #4 | 35 | 55% |
| #10 | 55 | 70% |
| #30 | 65 | 80% |
| #100 | 80 | 90% |
| #200 | 85 | 92% |

P. not more than
Moisture in final mixture, max. (3) (max)

"GENERAL NOTES"

"Leveling Course"
Level Course to be placed where necessary on project under the direction of the Engineer.

Loose concrete, loose asphalt patches & all other loose material is to be removed prior to tack coat application. The cost of removing loose material & surface cleaning is to be incidental to project.

Tack coat shall consist of from five one hundredths (0.05) to one tenth (0.10) gallons per sq. yd. of the type and grade of bituminous material specified. The tack coat is incidental to the application of final asphalt concrete (see note).

Traffic is to be maintained throughout all times by use of "skips" & "flamers".

"KELLOGG (US 54) HIGHWAY"
 Ill. Chautauque Avenue to El. Leeper Drive
 Asphalt Concrete - Improve and Re-improve
CITY OF WICHITA, KANSAS
 S. L. Smith
 City Engineer
 Proj. No. C18-15
 Date: 5/23/54-5/27/54 (2) (3) (4) (5) (6) (7) (8) (9) (10) (11) (12) (13) (14) (15) (16) (17) (18) (19) (20) (21) (22) (23) (24) (25) (26) (27) (28) (29) (30) (31) (32) (33) (34) (35) (36) (37) (38) (39) (40) (41) (42) (43) (44) (45) (46) (47) (48) (49) (50) (51) (52) (53) (54) (55) (56) (57) (58) (59) (60) (61) (62) (63) (64) (65) (66) (67) (68) (69) (70) (71) (72) (73) (74) (75) (76) (77) (78) (79) (80) (81) (82) (83) (84) (85) (86) (87) (88) (89) (90) (91) (92) (93) (94) (95) (96) (97) (98) (99) (100)

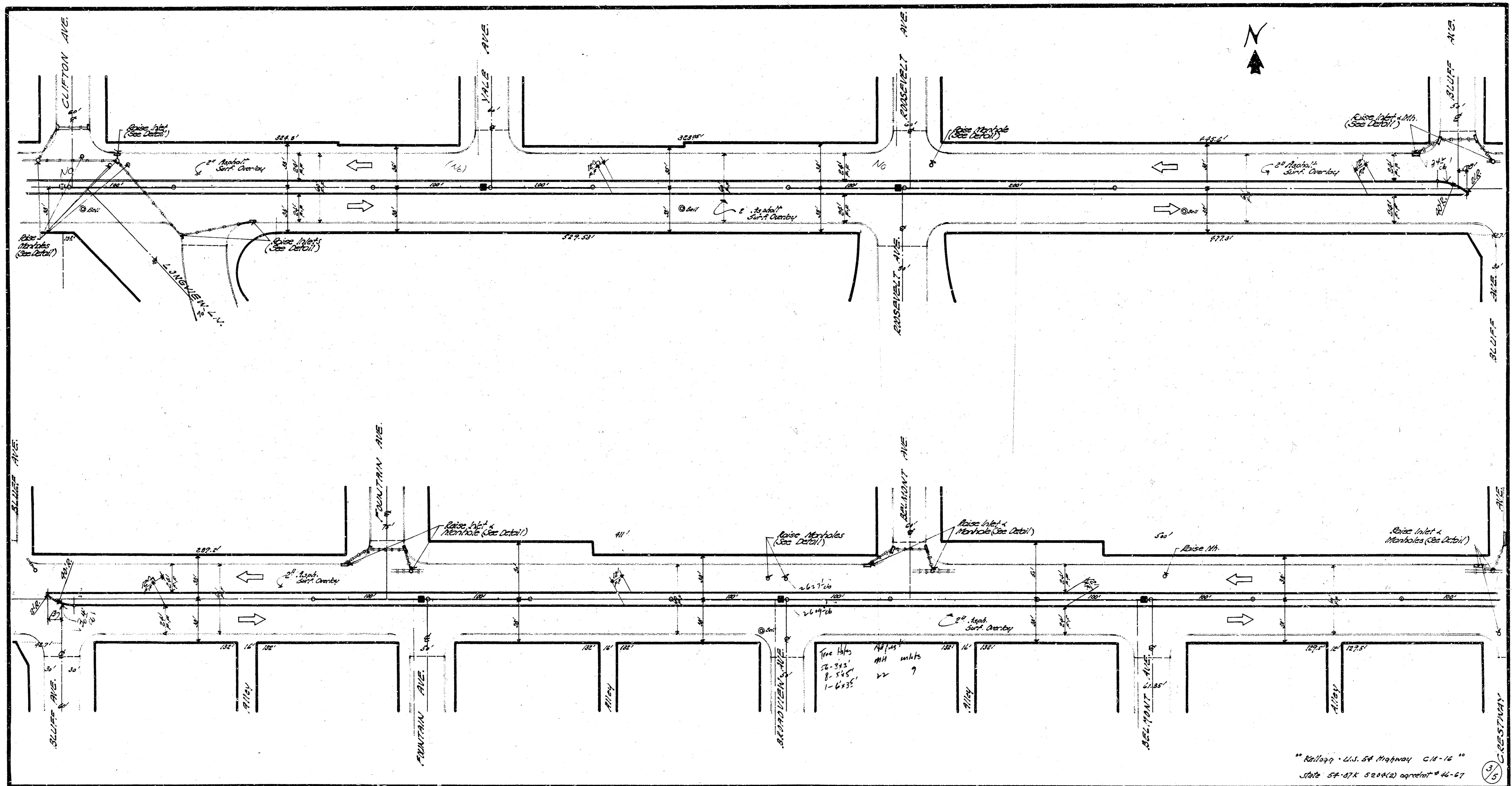

20-335'
 8-545'
 1-635'

"Rellogg - U.S. 54 Highway C.M. - 16"
 State 54-574 520420 agreement # 46-57

3
 5
 C. RESTANY

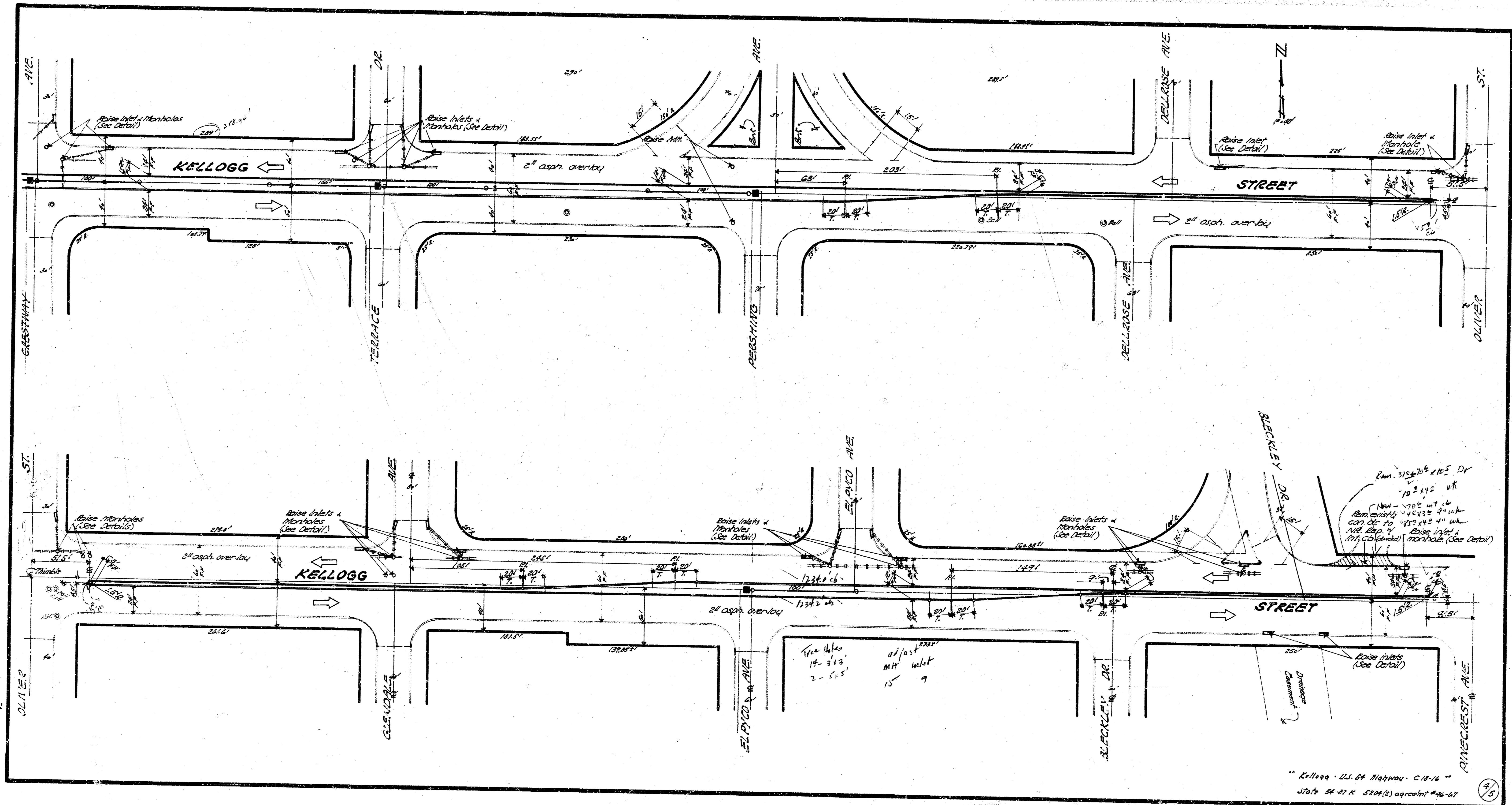

"Kellogg - W. St Highway - C. 10-16"
 State St-27 K 5804(2) approved #46-47

4/5

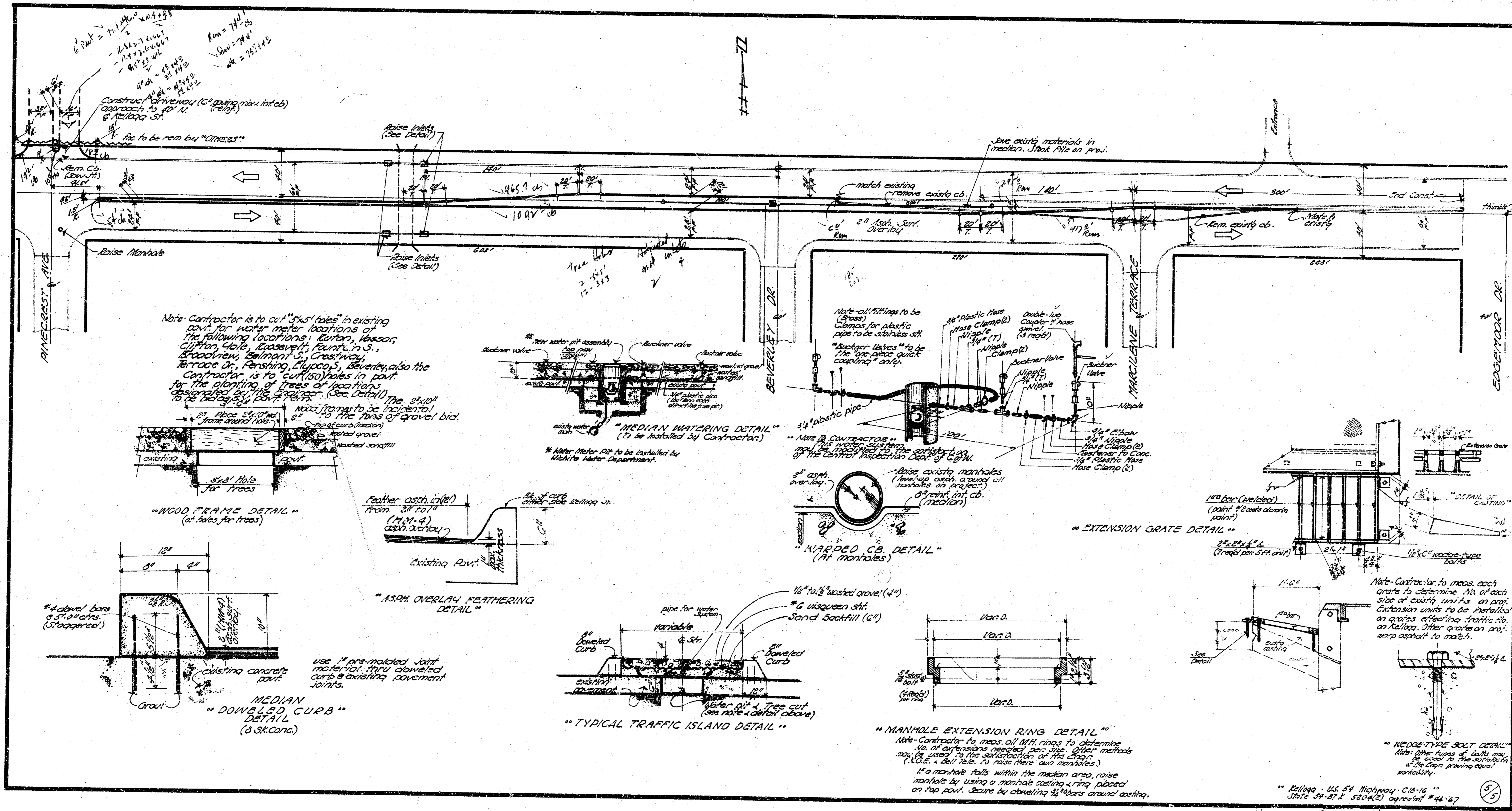

Note: Contractor is to cut "5x5" holes in existing curb for water meter locations at the following locations: Linton, Vassar, Clifton, Dale, Roosevelt, Point, in S., Broadview, Belmont St, Crestway Terrace Dr, Pershing, Lyndon, Beverly also the Contractor is to cut (50) holes in pavement for the planting of trees at locations designated by the Engineer (See Detail) to be done by the Contractor.

WOOD FRAME DETAIL (at hole for trees)

ASPH OVERLAY FEATHERING DETAIL

MEDIAN WATERING DETAIL (To be installed by Contractor)

MIDDED CB DETAIL (At Manholes)

EXTENSION GRATE DETAIL

MEDIAN DOWNED CURB DETAIL (3 St. Conc)

TYPICAL TRAFFIC ISLAND DETAIL

MANHOLE EXTENSION RING DETAIL

WEDGE TYPE SOFT CURB DETAIL