

ELEVATION

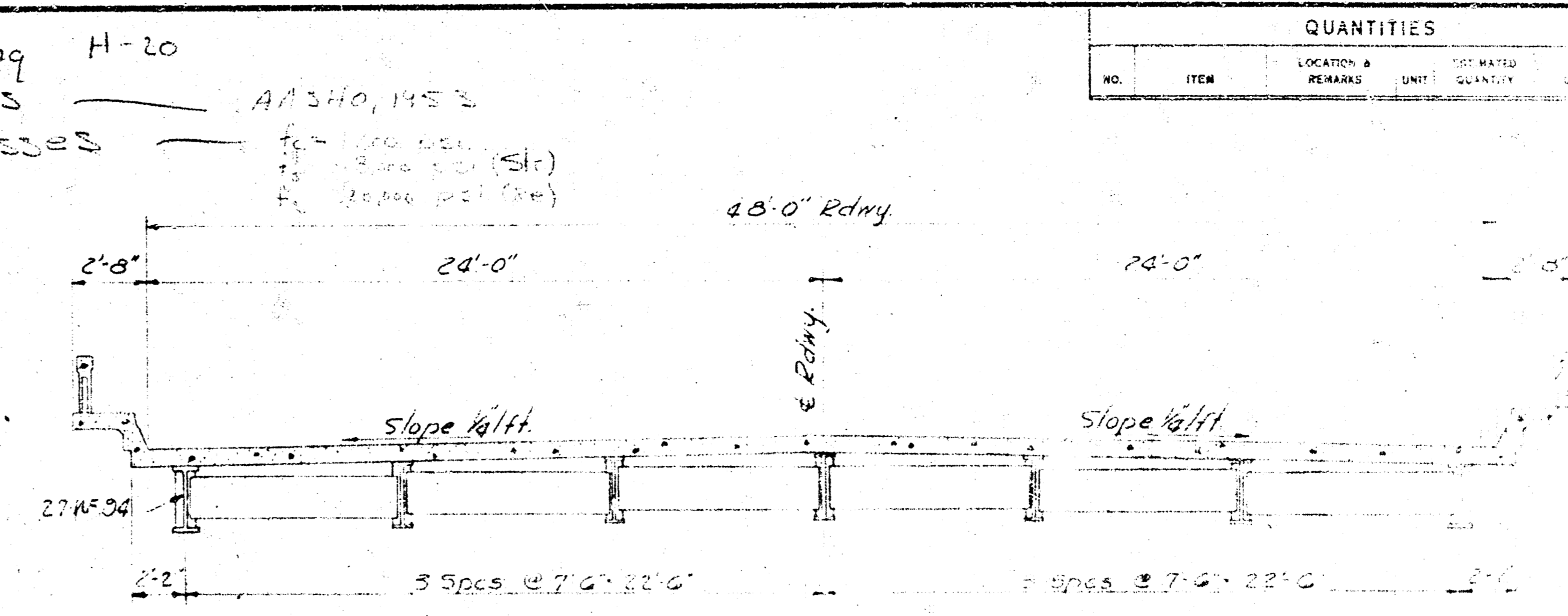

TYPICAL CROSS SECTION  
Scale 1/4" = 1'-0"

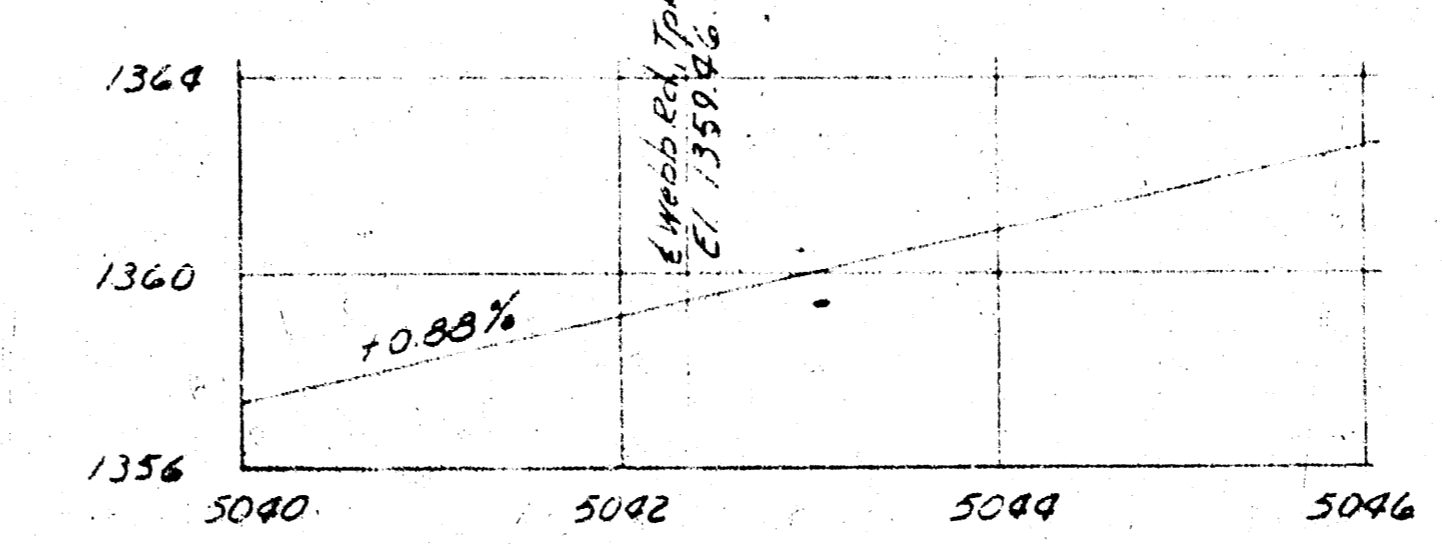

TURNPIKE PROFILE

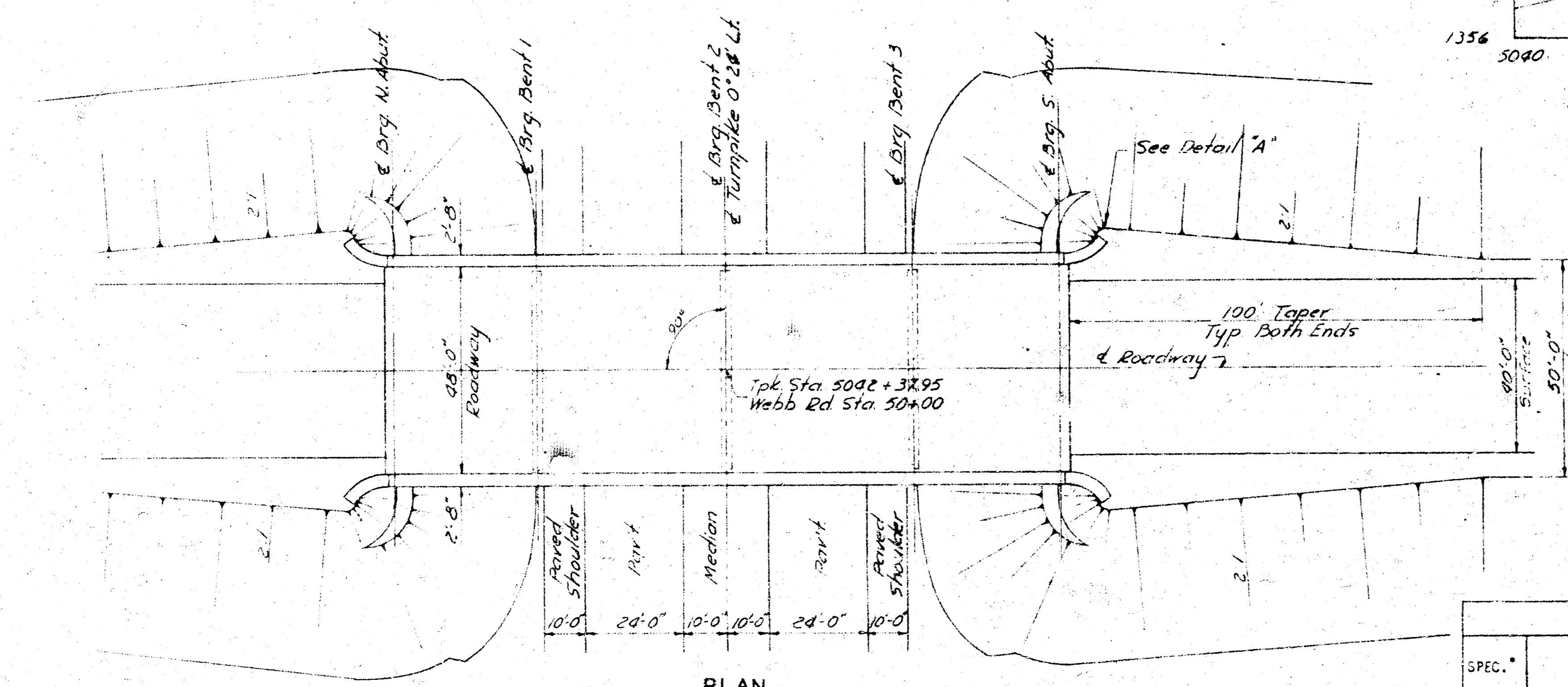

PLAN

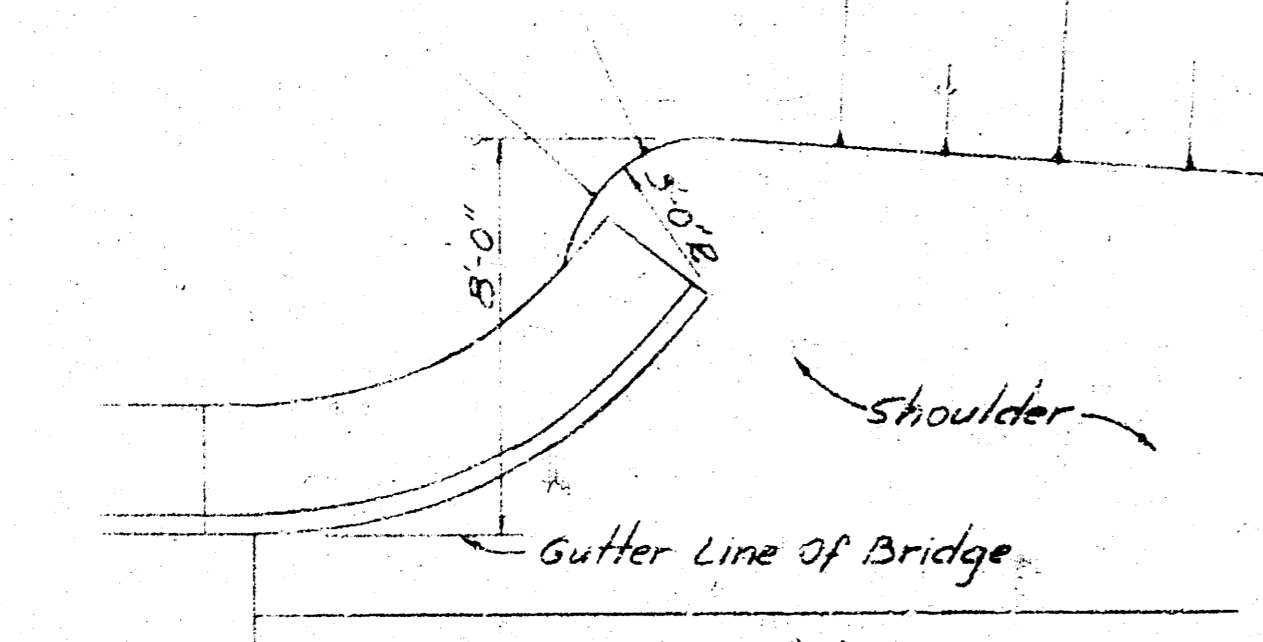

DETAIL "A"

Design Loading H-20  
Design Specs AASHTO, 1952  
Design Stresses

QUANTITIES				
NO.	ITEM	LOCATION & REMARKS	ESTIMATED QUANTITY	FINAL QUANTITY

DESIGNED BY *F. J. Wilson* 11 Nov 53  
FOR WILSON & COMPANY DATE  
APPROVED BY *W. J. ...* 1/1/54  
FOR EDWARD, HOBBS, TAYLOR & HICKS DATE  
APPROVED BY *Charles ...*  
FOR SEDGWICK COUNTY DATE  
APPROVED BY \_\_\_\_\_  
FOR KANSAS TURNPIKE AUTHORITY DATE

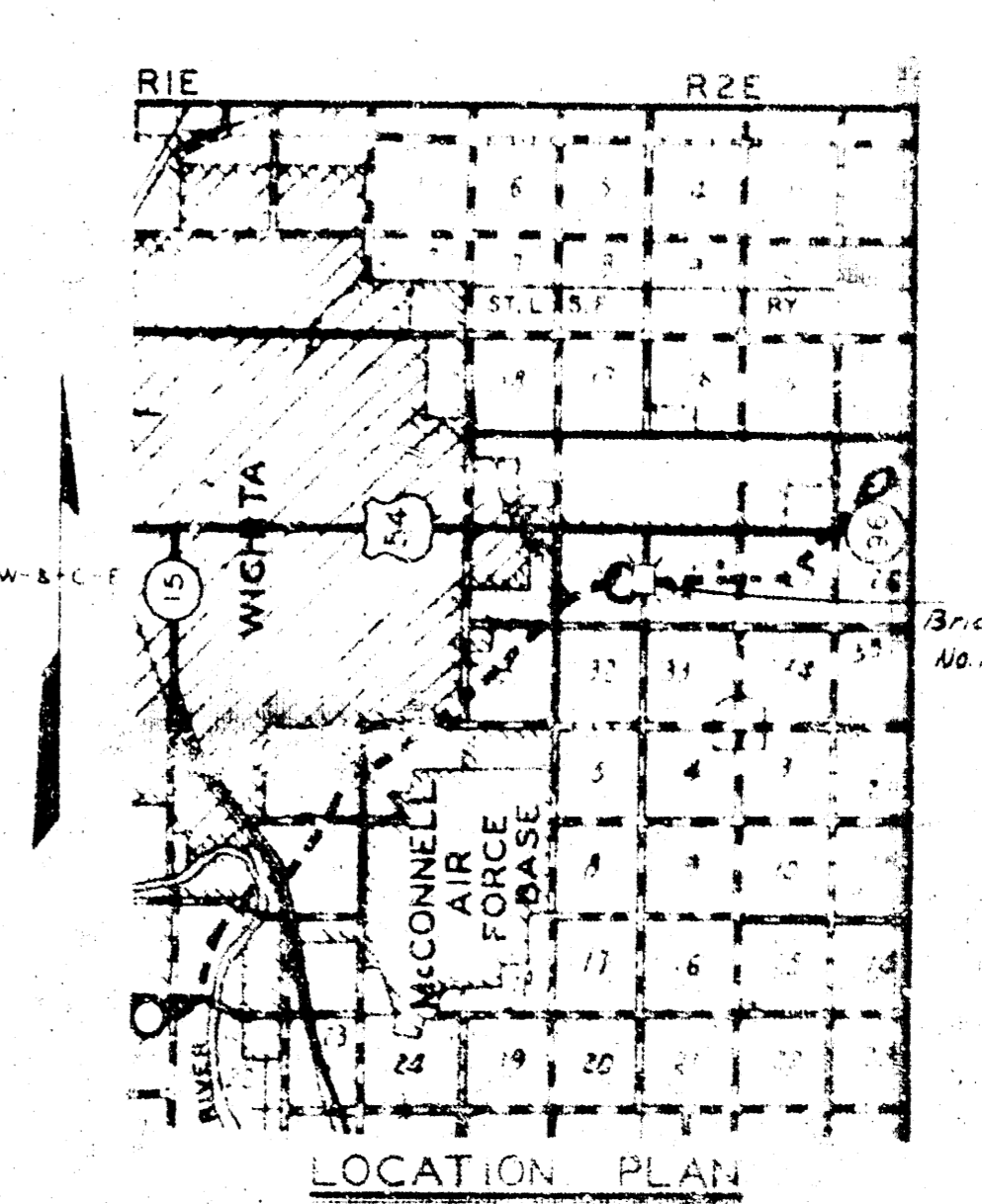

LOCATION PLAN

SPEC. #	ITEM	UNIT	TOTAL SUMMARY OF QUANTITIES		
			SUPER. EST.	SUPER. FINAL	TOTAL
30	CLASS A CONCRETE	CU. YDS.			
30	CLASS A CONCRETE (A6)	CU. YDS.			
32	REINFORCING STEEL	LBS.			
31	STRUCTURAL STEEL	LBS.			
51	BEARING DEVICES	LBS.			
125	HANDRAIL (CONCRETE)	LIN. FT.			
59	PILES	LIN. FT.			
16	CLASS 1 ELEVATION	CU. YDS.			

\* APPLICABLE SECT. KANSAS STATE HIGHWAY SPECS.

NO. \_\_\_\_\_ REVISION \_\_\_\_\_ BY \_\_\_\_\_ DATE \_\_\_\_\_

KANSAS TURNPIKE AUTHORITY  
OKLAHOMA BORDER TO KANSAS CITY

BRIDGE NO. 72  
SEDGWICK COUNTY  
WEBB ROAD TPK. STA. 5042+37.95  
BRIDGE DATA

WILSON & COMPANY ENGINEERS-ARCHITECTS  
SECTION ENGINEER \_\_\_\_\_ SECTION \_\_\_\_\_

MADE BY *M. R.* DATE *2-28-55* TRACED \_\_\_\_\_ DATE \_\_\_\_\_  
CHECKED \_\_\_\_\_ DATE \_\_\_\_\_ SCALE *AS SHOWN*

CONTRACT NO. 2-8-9(1) SHEET 72.01.07