

DLK-105  
D. Chamber

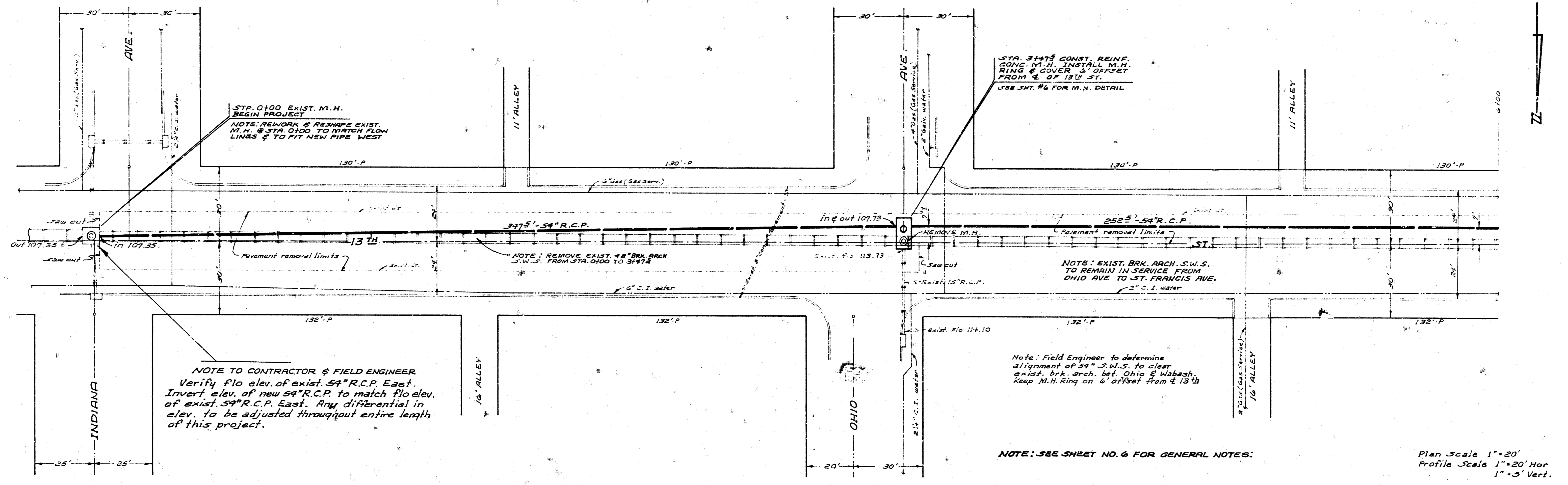

**NOTE TO CONTRACTOR & FIELD ENGINEER**  
 Verify fio elev. of exist. 54\"/>

**NOTE: SEE SHEET NO. 6 FOR GENERAL NOTES:**

Plan Scale 1\"/>

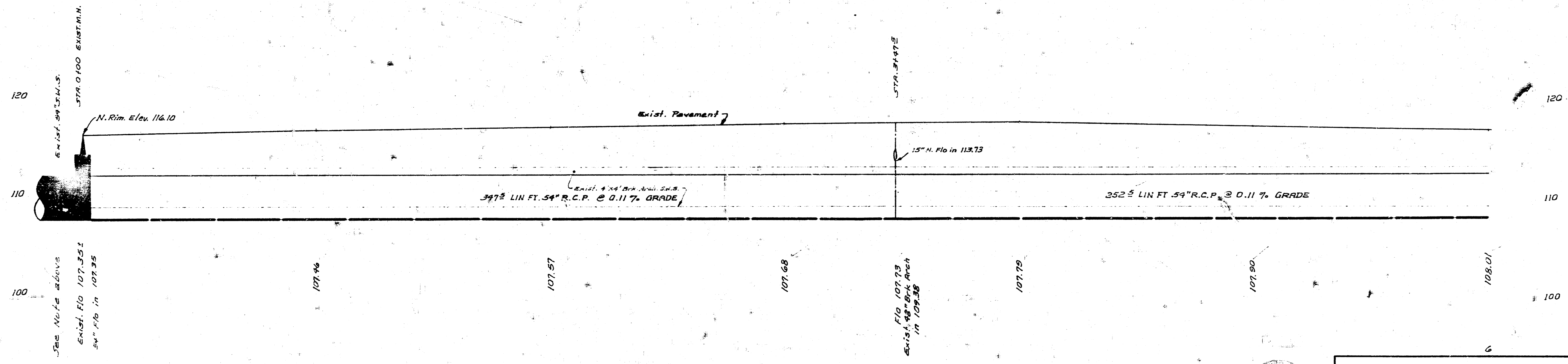

See Note above  
 Exist. fio 107.351  
 54\"/>

fio 107.73  
 Exist. 48\"/>

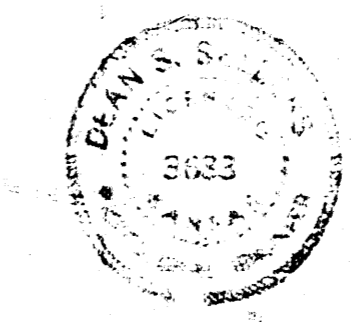

**RECONSTRUCTION OF A PORTION OF 13TH ST.  
 S.W.S. BET. ST. FRANCIS AVE. & INDIANA AVE.**  
 CITY OF WICHITA, KANSAS  
 R.W. LINN, CITY ENGINEER  
 PROJ. NO. DBKAS72012  
 DATE: 3-14-12 SHEET 1 OF 8

D.14-105

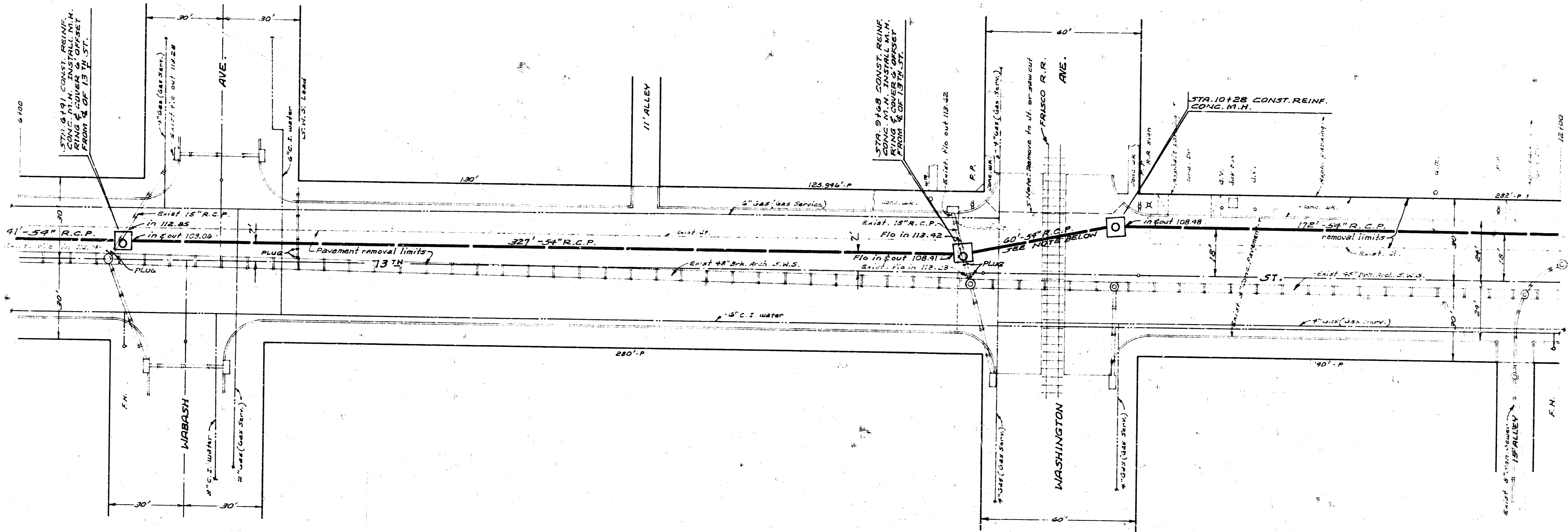

B.M. 116.89 STD. S.W. COR. WASHINGTON & 13TH ST S. OF & 24' W. OF & BOTH

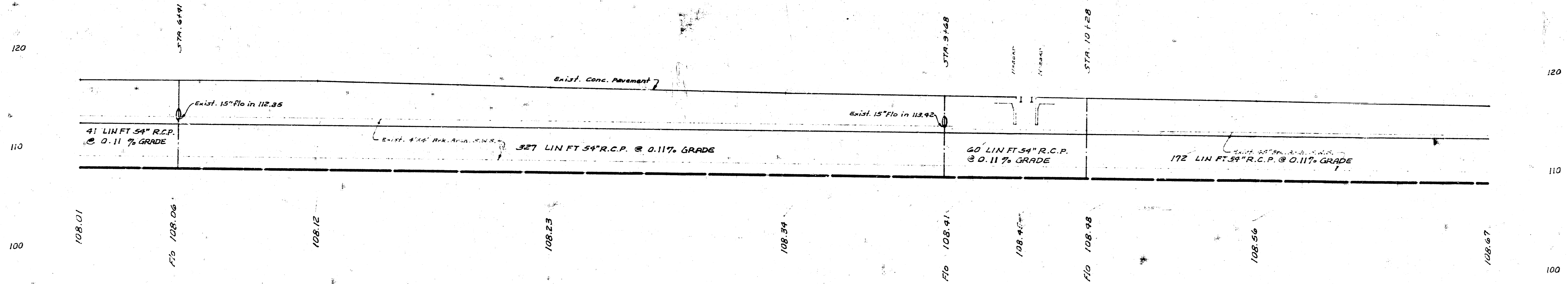

NOTE :  
30 LIN FT 54" CLASS I R.C.P. UNDER R.R.  
BY JACKING METHOD

12  
RECONSTRUCTION OF A PORTION OF 13TH ST.  
S.W.S. BET ST FRANCIS AVE & INDIANA AVE.  
PROJECT NO. DBKAS72012  
SHEET 2 OF 8

D14-105

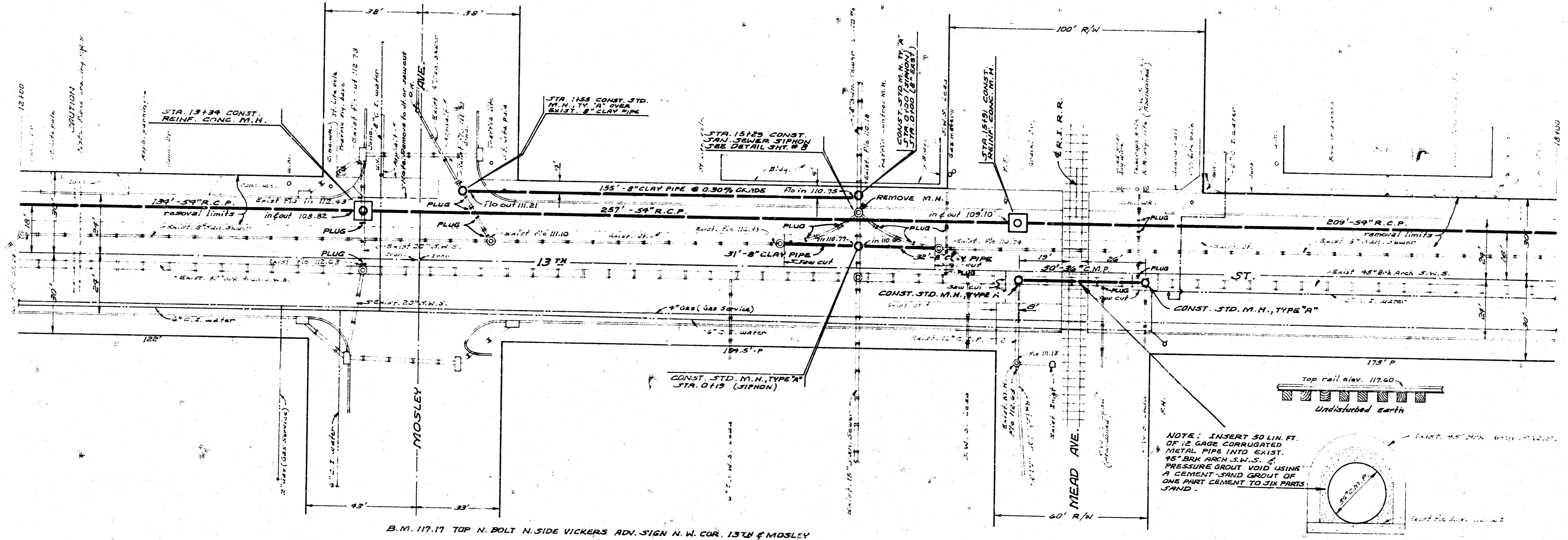

B.M. 117.17 TOP N. BOLT N. SIDE VICKERS ADV. SIGN N.W. COR. 13TH & MOSLEY

NOTE: INSERT 50 LIN. FT. OF 12 GAUGE CORRUGATED METAL PIPE INTO EXIST. 45\"/>

SECTION REPAIR OF 45\"/>

120

110

100

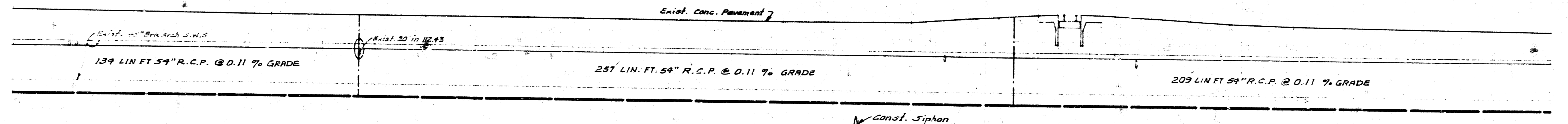

Const. Siphon See detail shi. #8

NOTE:

30 LIN. FT. 54\"/>

12

13

14

15

16

17

18  
 RECONSTRUCTION OF A PORTION OF 13TH ST. S.W.S. BET. ST. FRANCIS AVE. & INDIANA AVE. PROJECT NO. DBKAS12012 SHEET 3 OF 8





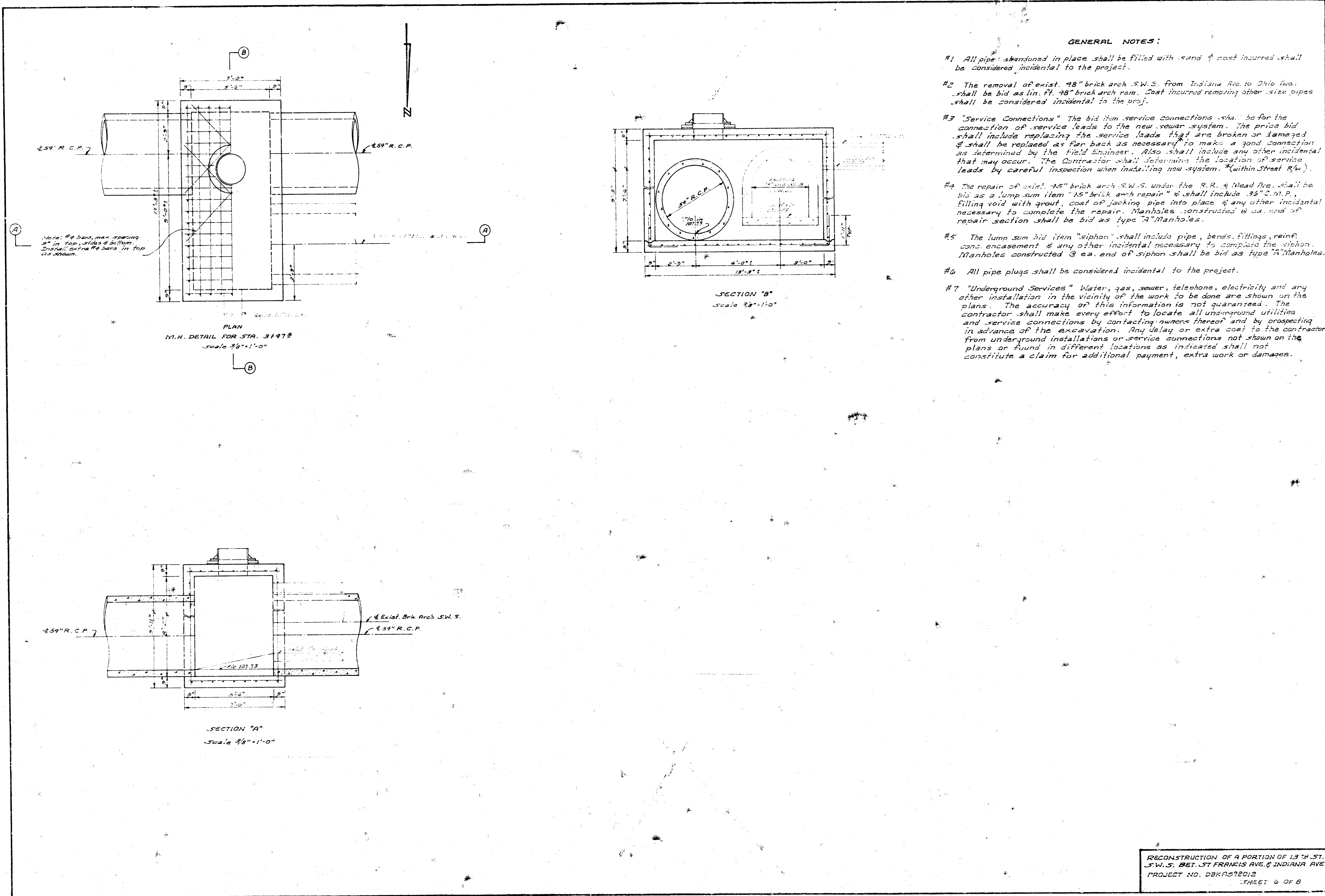

**GENERAL NOTES:**

- #1 All pipe abandoned in place shall be filled with sand & cost incurred shall be considered incidental to the project.
- #2 The removal of exist 48" brick arch S.W.S. from Indiana Ave. to Ohio Ave. shall be bid as lin. ft. 48" brick arch rem. Cost incurred removing other size pipes shall be considered incidental to the proj.
- #3 "Service Connections" The bid item service connections shall be for the connection of service leads to the new sewer system. The price bid shall include replacing the service leads that are broken or damaged & shall be replaced as far back as necessary to make a good connection as determined by the Field Engineer. Also shall include any other incidental that may occur. The Contractor shall determine the location of service leads by careful inspection when installing new system. (within Street R/W).
- #4 The repair of exist 48" brick arch S.W.S. under the R.R. & Mead Ave. shall be bid as a lump sum item "48" brick arch repair" & shall include 36" C.M.P. filling void with grout, cost of jacking pipe into place & any other incidental necessary to complete the repair. Manholes constructed @ ea. end of repair section shall be bid as type "A" Manholes.
- #5 The lump sum bid item "siphon" shall include pipe, bends, fittings, reinf. conc. encasement & any other incidental necessary to complete the siphon. Manholes constructed @ ea. end of siphon shall be bid as type "A" Manholes.
- #6 All pipe plugs shall be considered incidental to the project.
- #7 "Underground Services" Water, gas, sewer, telephone, electricity and any other installation in the vicinity of the work to be done are shown on the plans. The accuracy of this information is not guaranteed. The contractor shall make every effort to locate all underground utilities and service connections by contacting owners thereof and by prospecting in advance of the excavation. Any delay or extra cost to the contractor from underground installations or service connections not shown on the plans or found in different locations as indicated shall not constitute a claim for additional payment, extra work or damages.

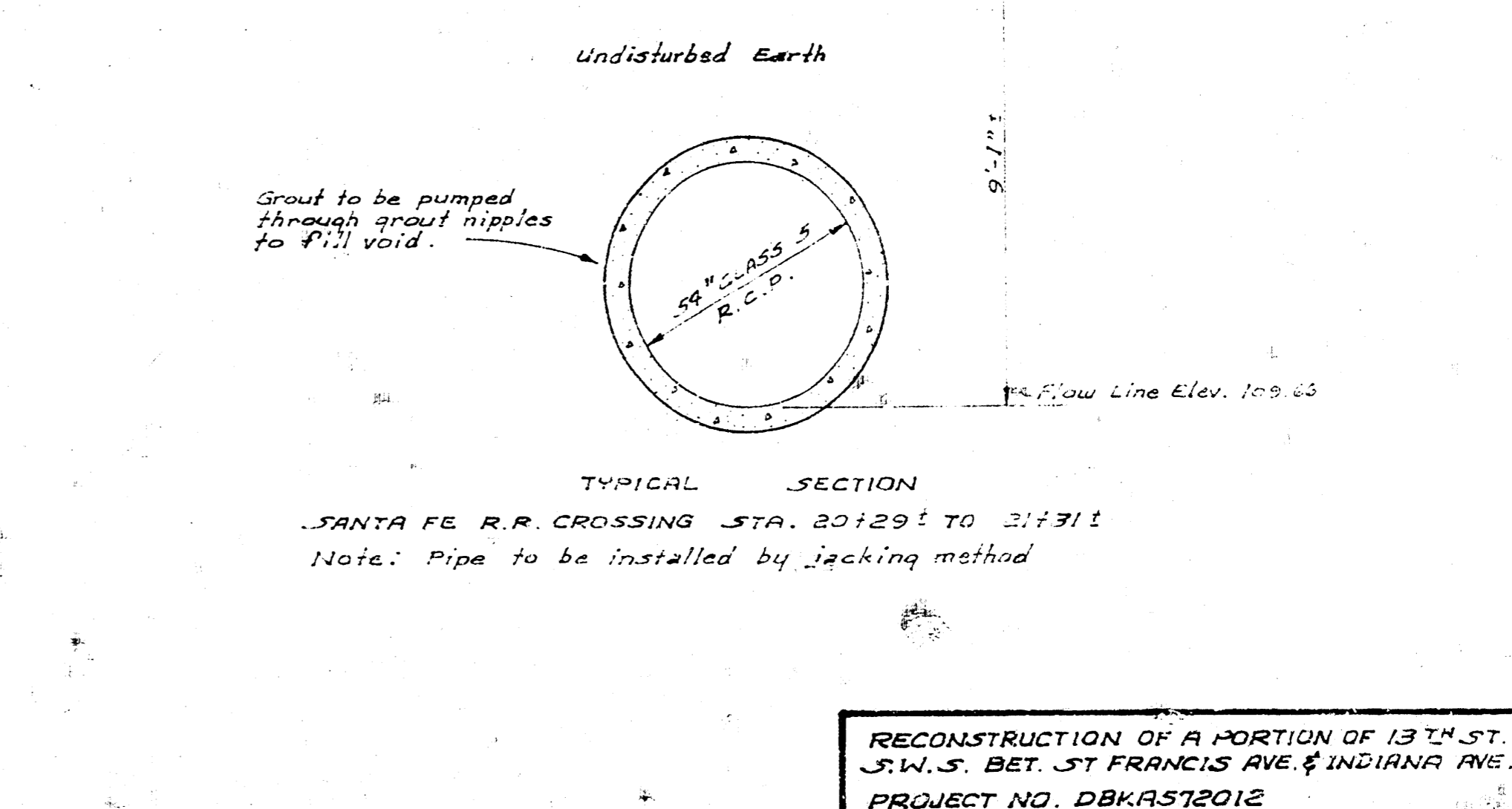
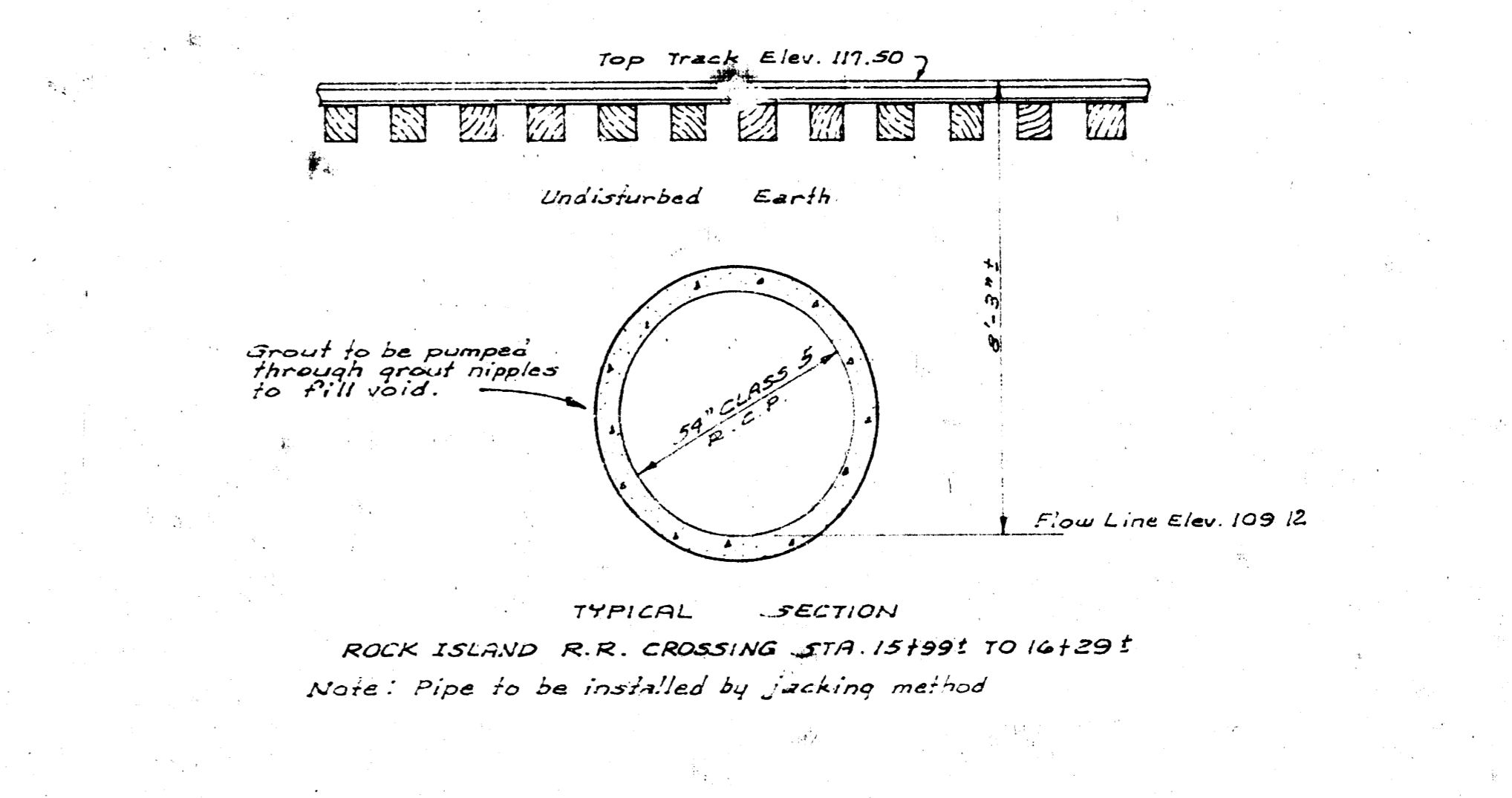
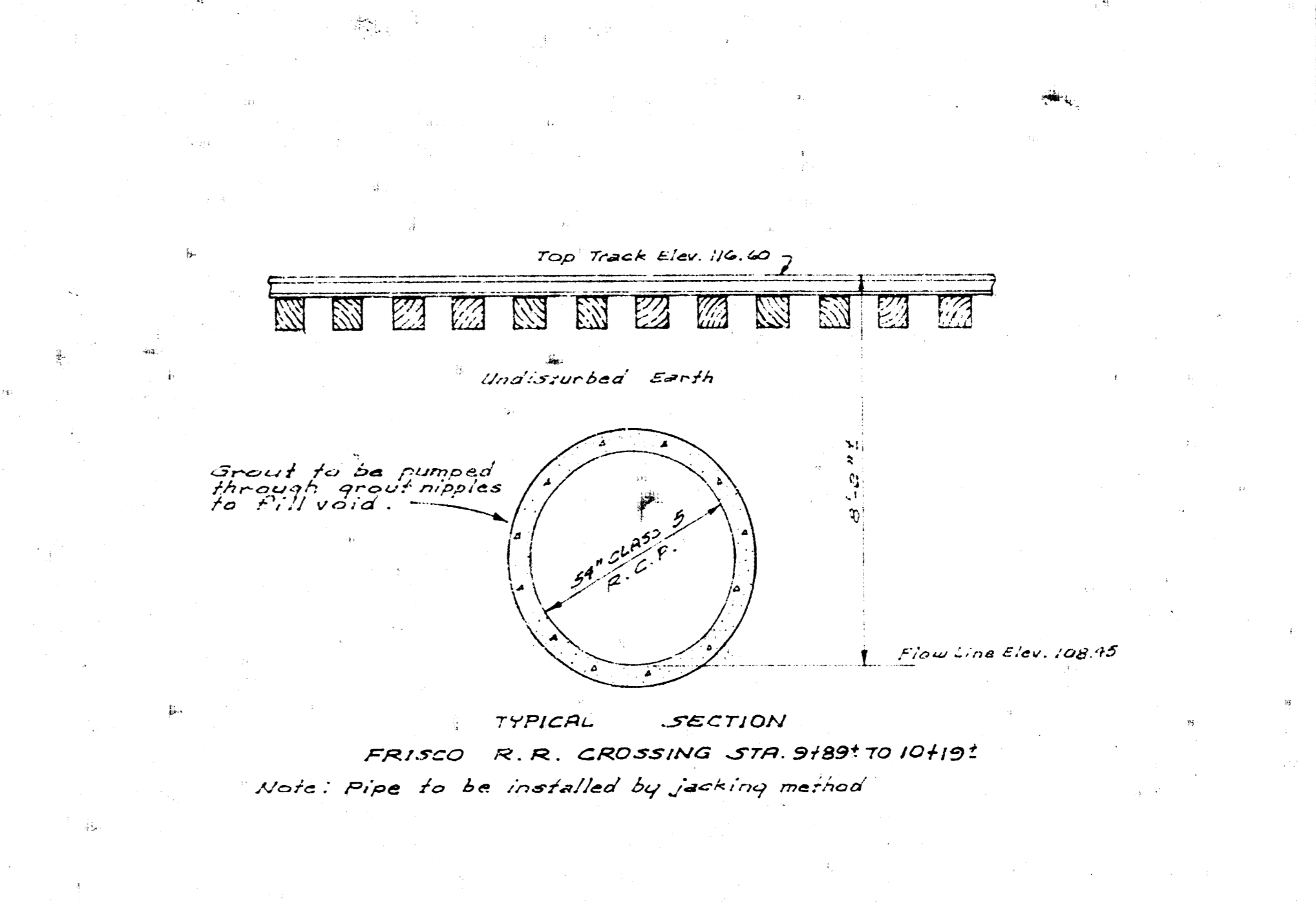
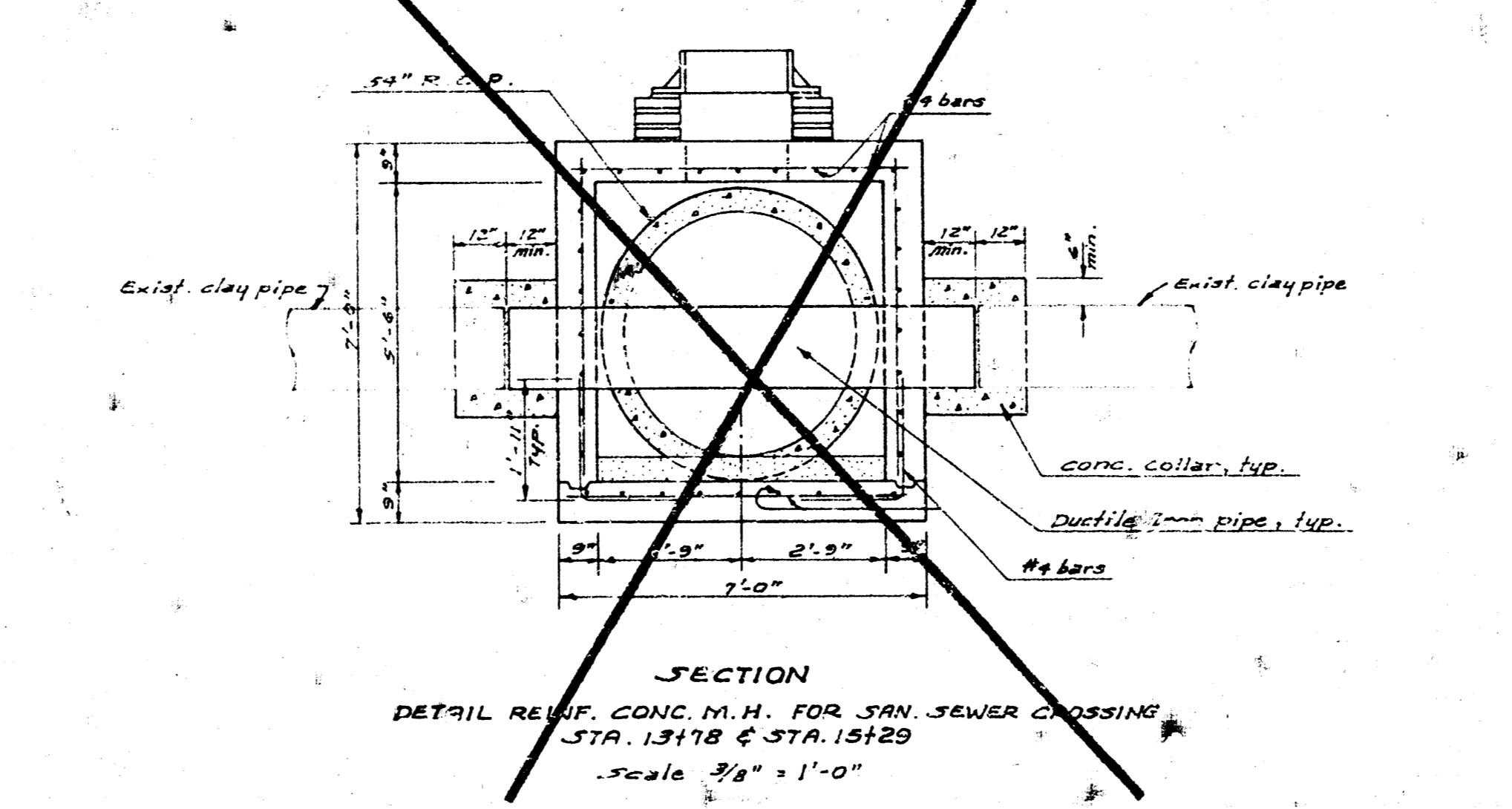
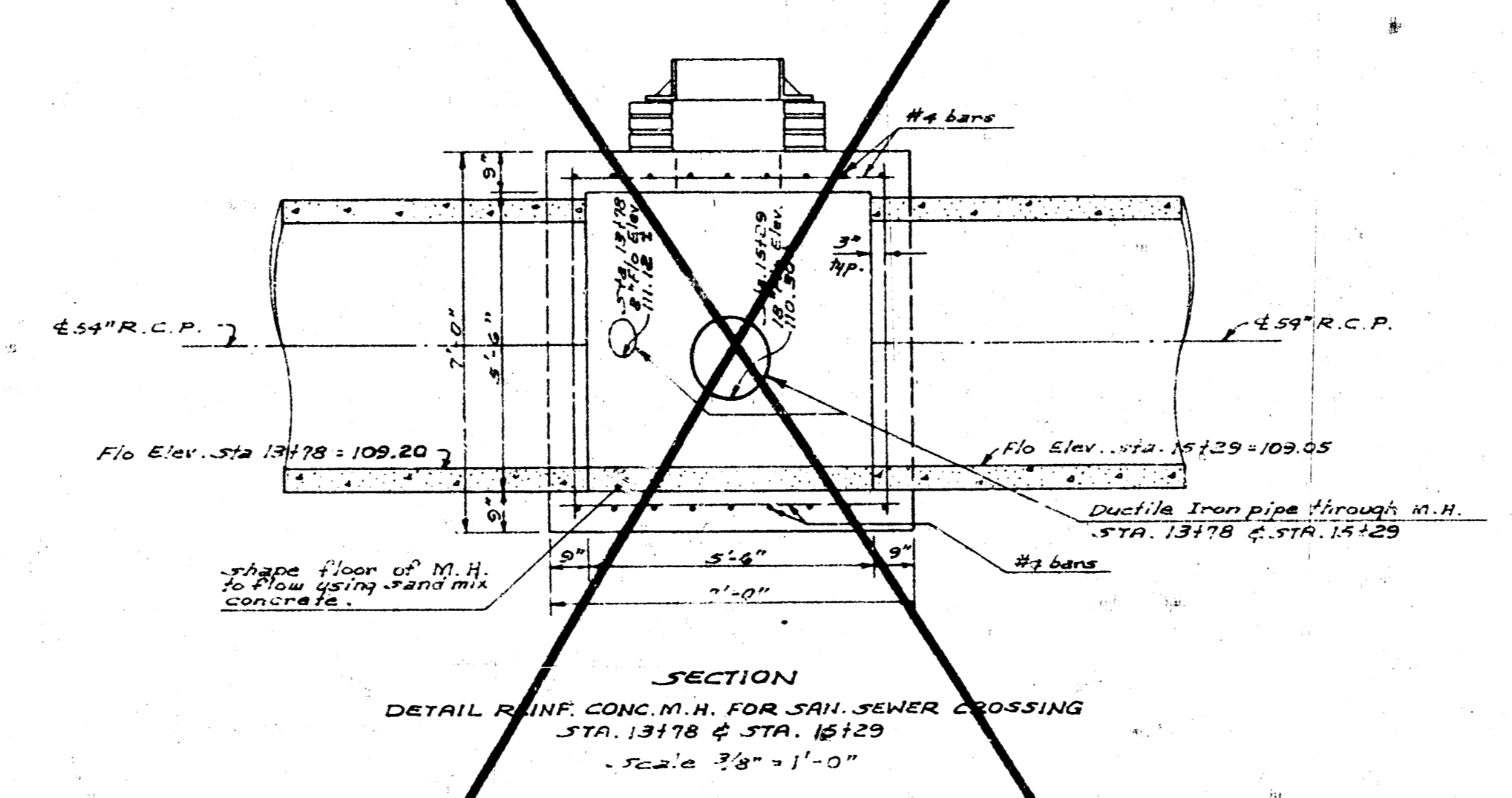
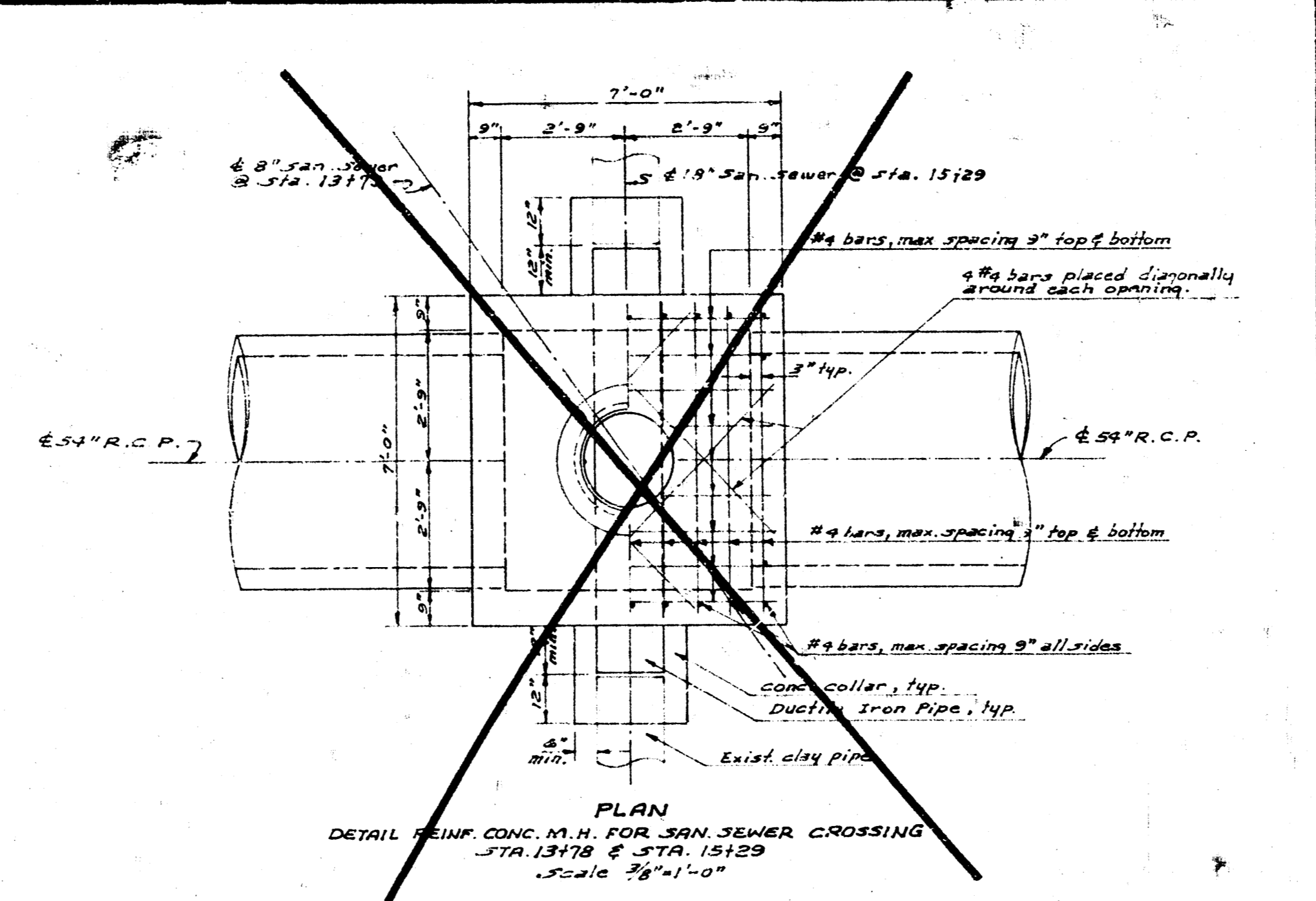
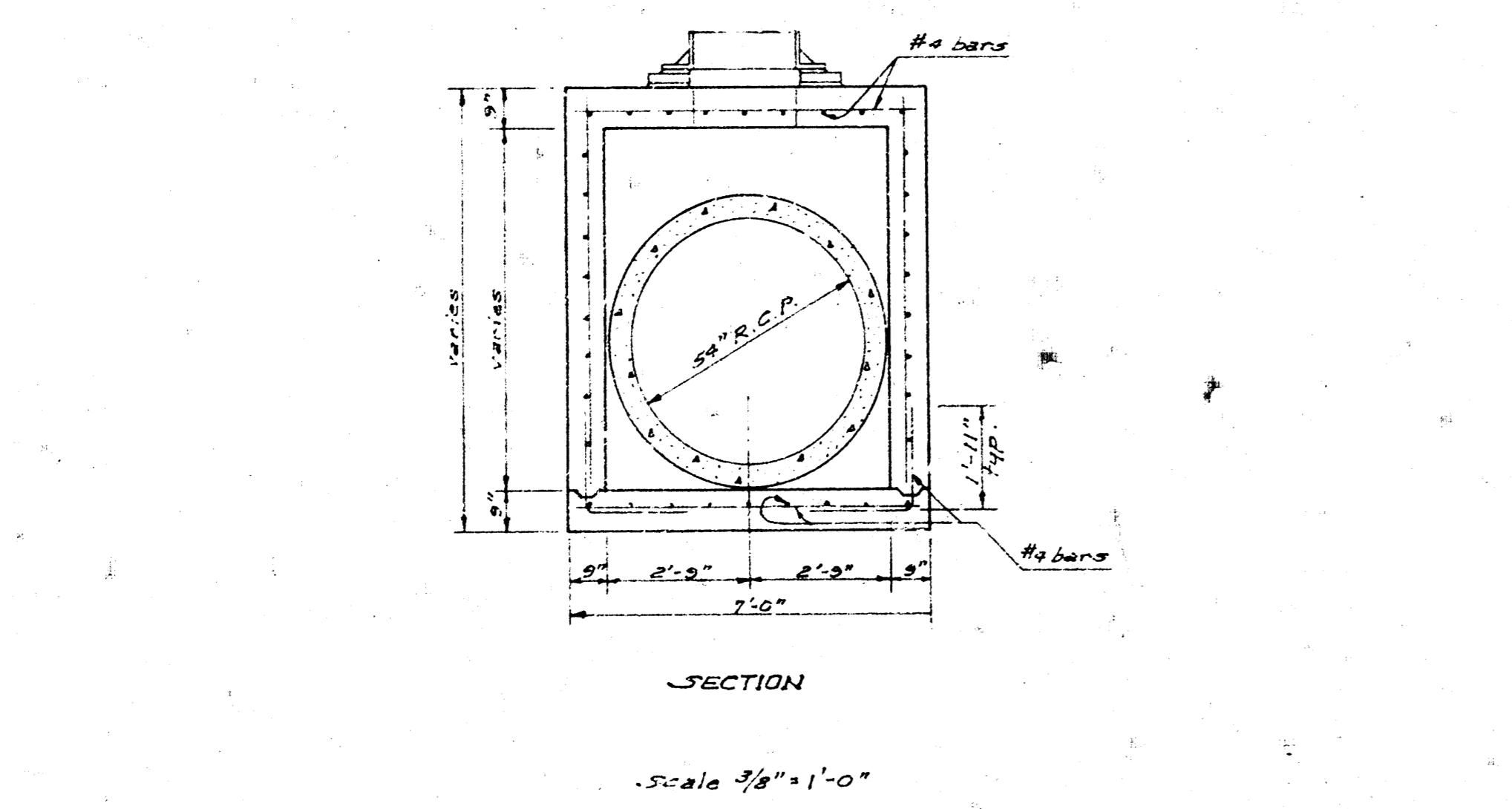
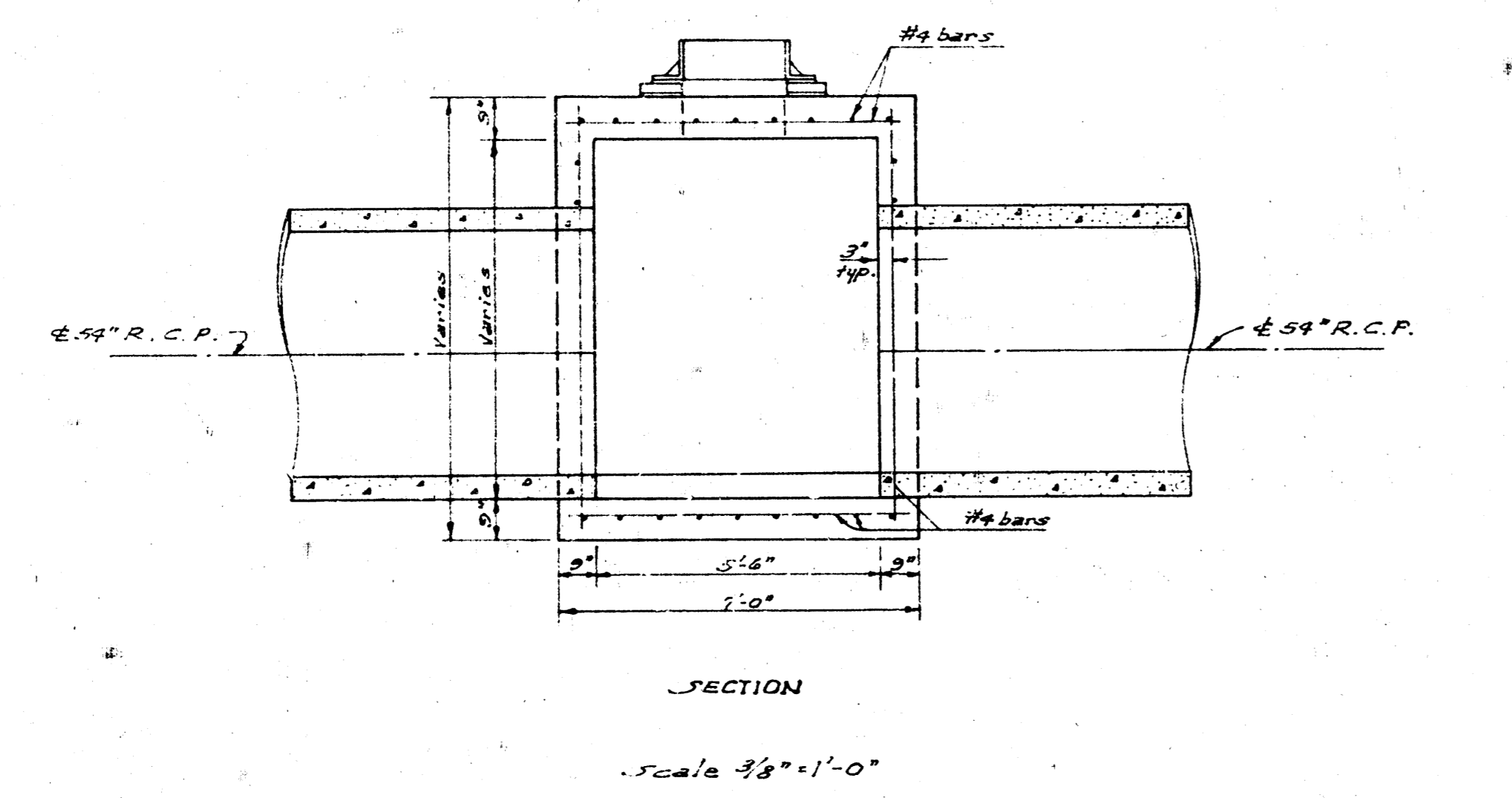
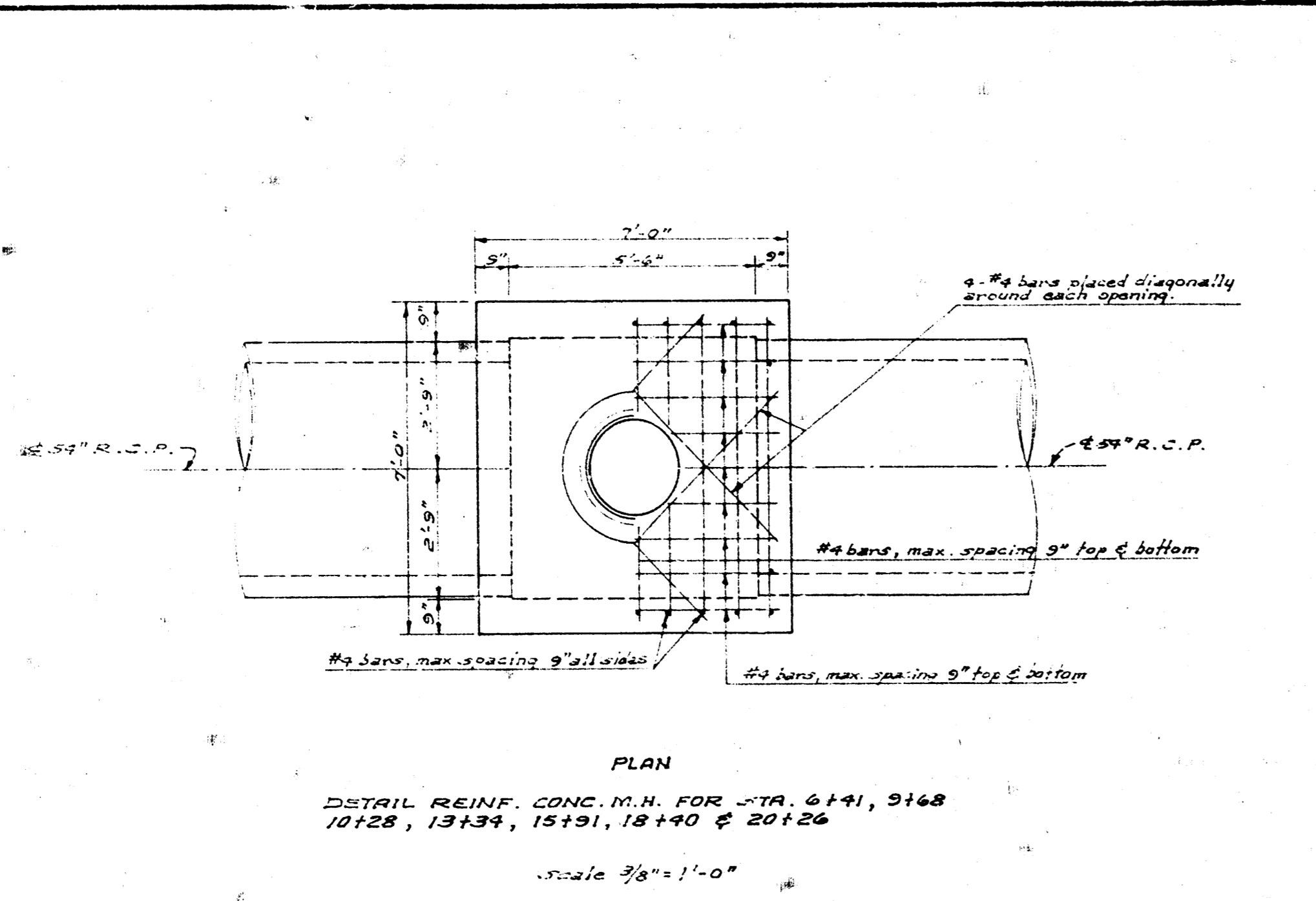

RECONSTRUCTION OF A PORTION OF 13<sup>TH</sup> ST.  
314.5' BET. ST. FRANCIS AVE & INDIANA AVE.  
PROJECT NO. DBKAST2012  
SHEET 7 OF 8

