

**PLAN & PROFILE**  
 OF  
**PROPOSED RELOCATION**  
 OF  
**STORM SEWERS**  
**ON KELLOGG STREET**  
 BETWEEN EMPORIA & WASH. AVE.  
 (CLEARING R/W FOR US 54 CONSTRUCTION)  
 OFFICE OF CITY ENGINEER  
 JAN. 1952 WICHITA, KANS.

DATE: \_\_\_\_\_  
 PLAN: \_\_\_\_\_  
 SHEET: \_\_\_\_\_  
 CHECKED: \_\_\_\_\_  
 BY: \_\_\_\_\_

DATE: \_\_\_\_\_  
 PROFILE: \_\_\_\_\_  
 SHEET: \_\_\_\_\_  
 CHECKED: \_\_\_\_\_  
 BY: \_\_\_\_\_

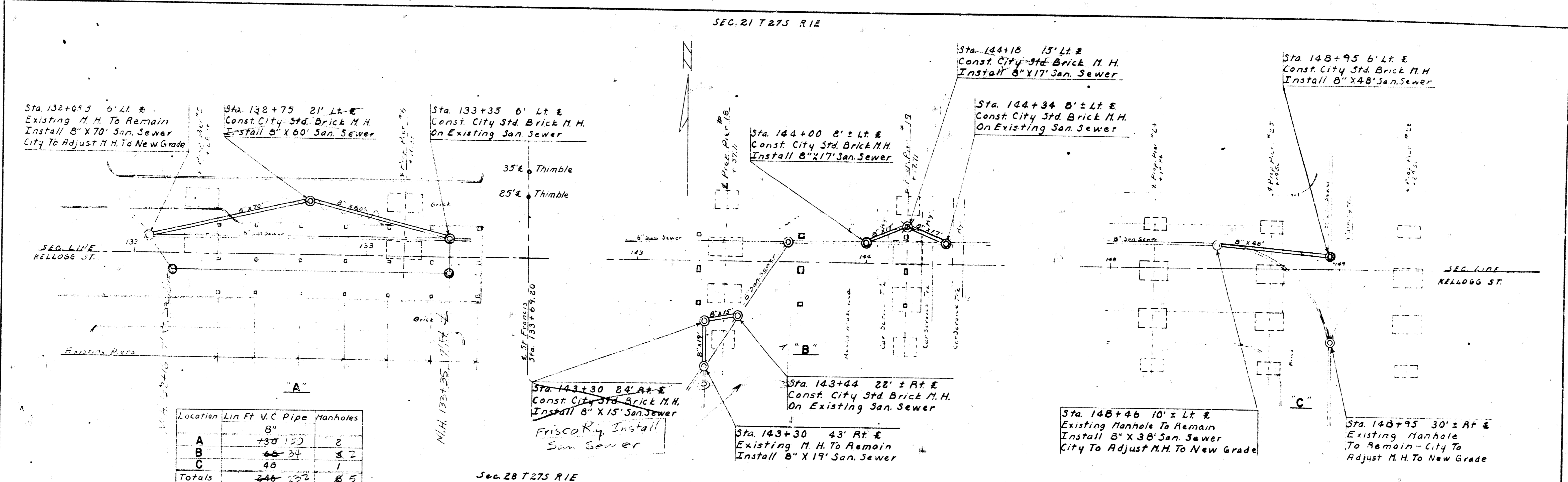

Location	Lin. Ft.	V.C. Pipe	Manholes
A	730	15"	2
B	40	34"	2
C	40	19"	1
Totals	810	32"	5

B.M. # 44 Pin In Thimble  
 W 78 Kellogg & Emporia  
 Elev. 105.62

B.M. Top Thimble B,  
 St. Francis & N. R.  
 Kellogg Elev. 105.60

B.M. # 45 "X" Cut Top Of  
 Guard Rail At Commerce  
 St. & S.E. Pier Elev. 108.97

B.M. # 46 N. Edge 6" Pipe  
 Approx. Sta 137+40 #  
 Kellogg Elev. 109.31

B.M. # 4B City Standard  
 S.E. Cor. Washington &  
 Kellogg Elev. 109.10

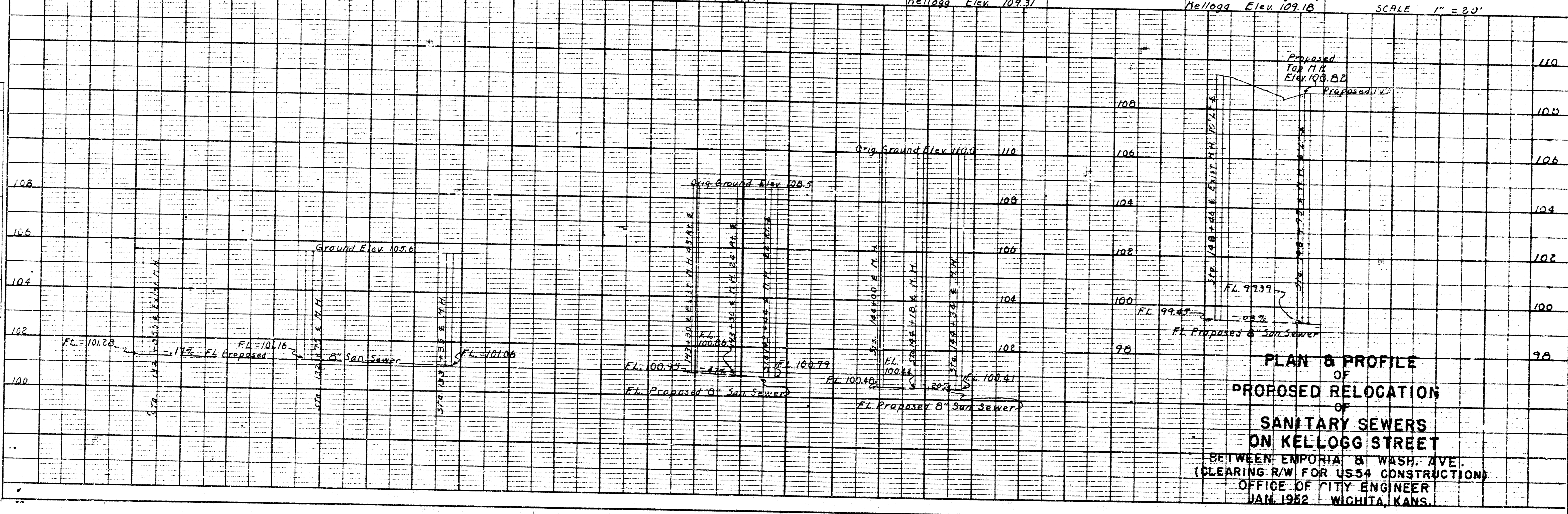

SCALE 1" = 20'

**PLAN & PROFILE  
 OF  
 PROPOSED RELOCATION  
 OF  
 SANITARY SEWERS  
 ON KELLOGG STREET  
 BETWEEN EMPORIA & WASH. AVE.  
 (CLEARING R/W FOR US54 CONSTRUCTION)  
 OFFICE OF CITY ENGINEER  
 JAN 1952 WICHITA, KANS.**



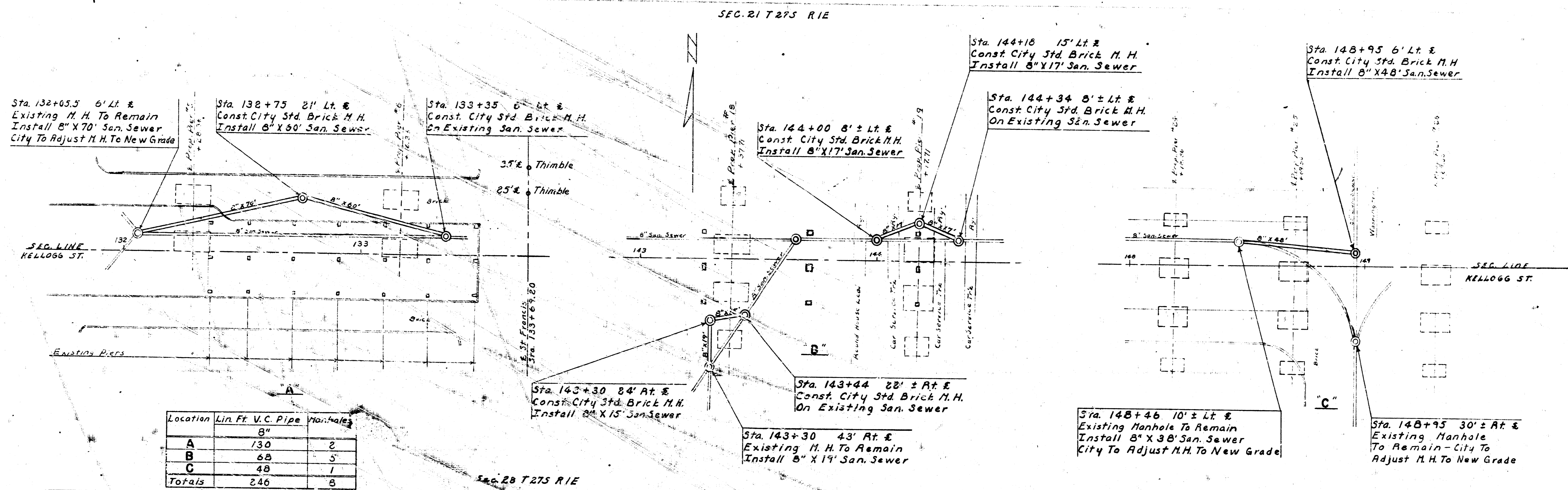

Location	Lin. Ft.	V.C. Pipe	Manholes
A	130	8"	2
B	68	15"	3
C	48	17"	1
Totals	246		6

B.M. # 44 Pin In Thimble  
N.E. Kellogg & Emporia  
Elev. 103.62

B.M. Top Thimble B  
S.W. Cor. Kellogg & N. R.  
Kellogg Elev. 105.60

B.M. # 45 "X" Cut Top Of  
Guard Rail At Corner  
S.E. & S.E. Pier Elev. 108.97

B.M. # 46 N. Edge 6" Pipe  
Approx. Sta. 137+40 &  
Kellogg Elev. 109.31

B.M. # 48 City Standard  
S.E. Cor. Washington &  
Kellogg Elev. 109.18

SCALE 1" = 20'

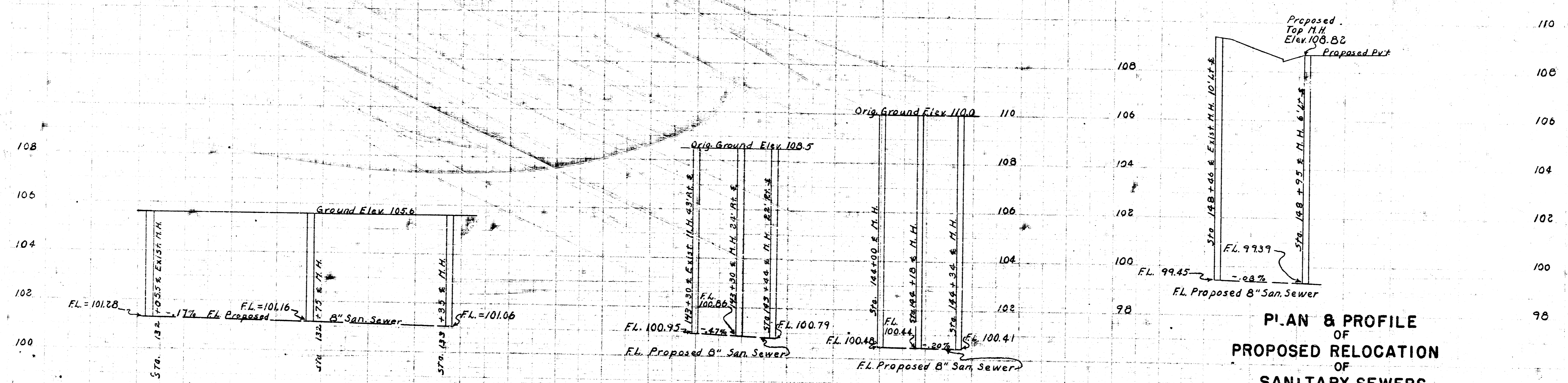

**PLAN & PROFILE  
OF  
PROPOSED RELOCATION  
OF  
SANITARY SEWERS  
ON KELLOGG STREET  
BETWEEN EMPORIA & WASH. AVE.  
(CLEARING R/W FOR US54 CONSTRUCTION)  
OFFICE OF CITY ENGINEER  
JAN. 1952 WICHITA, KANS.**