

State of Kansas)
 County of Sedwick) SS July 1, 1985

We, Baughman Company, P.A., Surveyors in aforesaid county and state do hereby certify that we did on this 1st day of July, 1985, survey Lots 31-33-35-37-39-41- and 43 on Market, together with the east 1/2 of vacated alley adjacent to said lots on the west, and Lots 38-40-42- and 44 on Main, together with the west 1/2 of vacated alley adjacent to said lots on the east, all in Griffensteins Addition to Wichita, Kansas, Sedwick County, Kansas.

The accompanying plat is a true and correct exhibit of said survey.

William S. Kober
 Surveyor

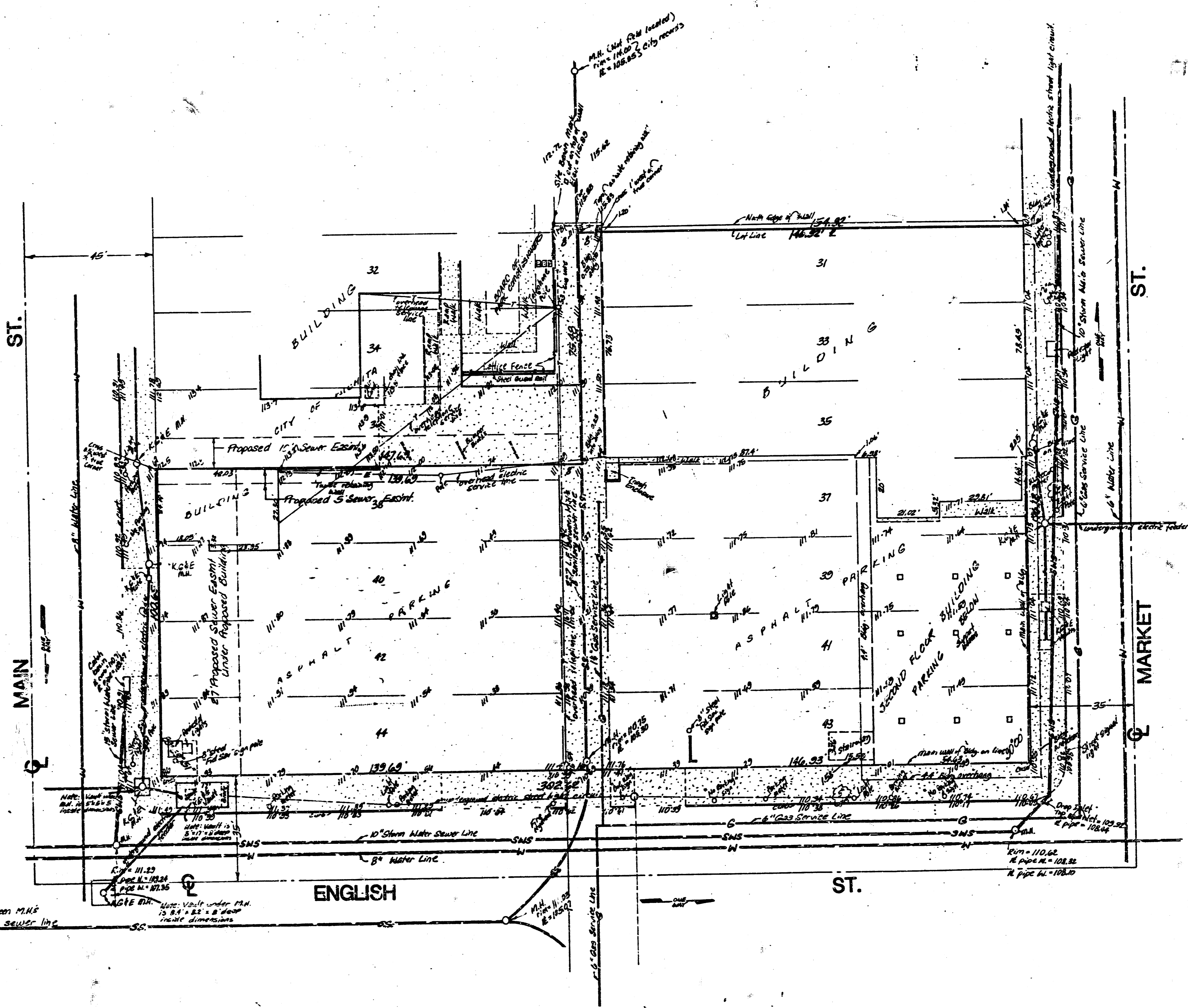

Private Storm Sewer Est. to Serve Fidelity Savings
 468-76-245-80001-000-000-029

BAUGHMAN COMPANY, P.A. Revised July 23, 1985
 SURVEYING & ENGINEERING July 16, 1985
 318-282-7271 • 330 LAURA • WICHITA, KANSAS 67211 Revised July 24, 1985
 July 17, 1985

FILMED FROM THE BEST

