

TOWNE EAST SHOPPING CENTER

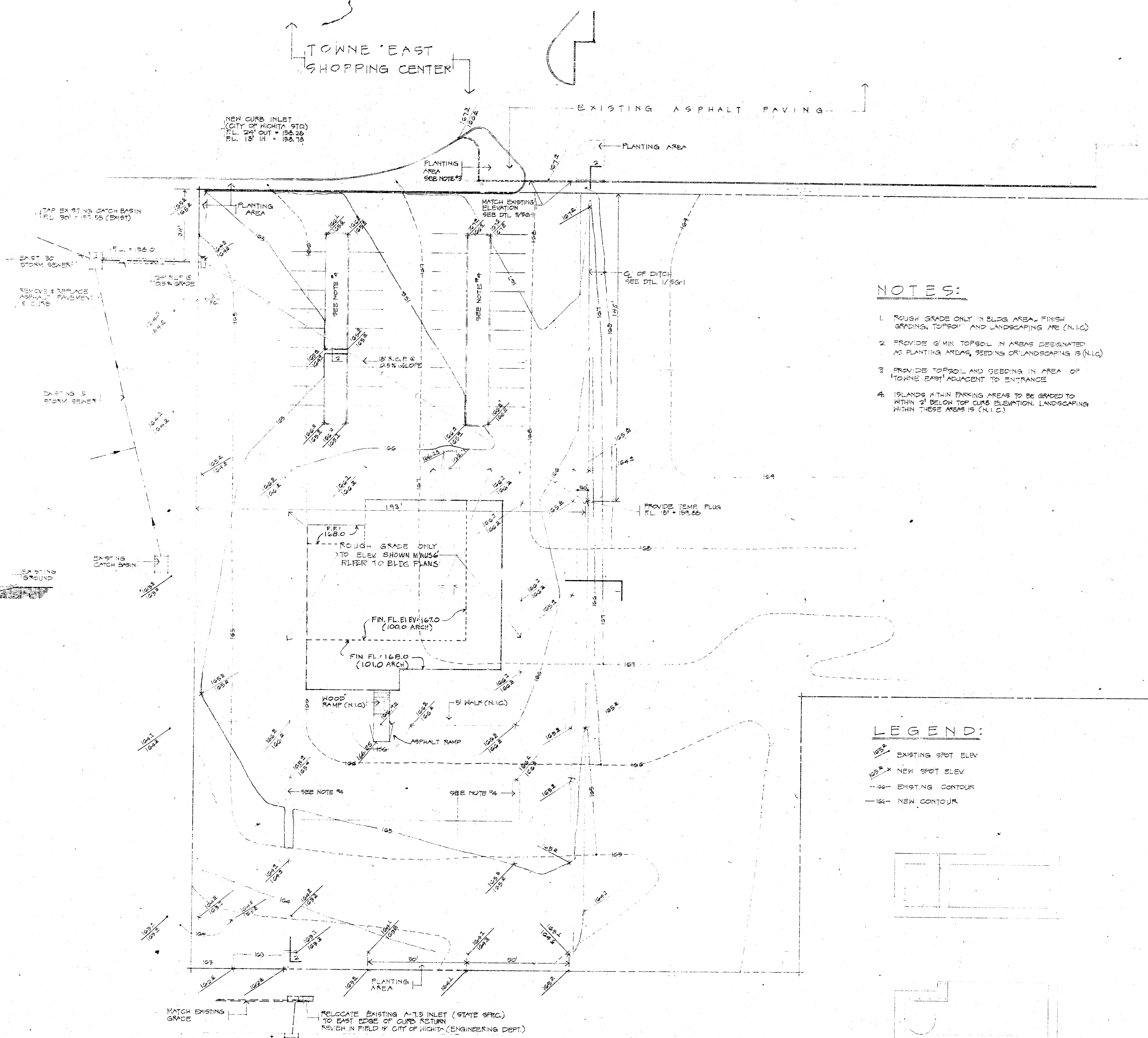

NEW CURB INLET
(CITY OF NICHITA STD.)
FL. 24" OUT = 158.26
FL. 18" IN = 158.78

TAP EX ST 30 CATCH BASIN
FL. 30" IN = 157.55 (EXIST)

REMOVE & REPLACE
ASPHALT PAVEMENT
& CURB

EXISTING 30
STORM SEWER

EXISTING
CATCH BASIN

PLANTING
AREA
SEE NOTE 3

PLANTING AREA

MATCH EXISTING
ELEVATION
SEE DTL 2/56-1

C. OF DITCH
SEE DTL 1/56-1

18" R.C.P. @
0.5% SLOPE

PROVIDE TEMP PLUG
FL. 18" = 157.55

ROUGH GRADE ONLY
TO ELEV SHOWN MINUS 6"
REFER TO BLDG PLANS

FIN. FL. ELEV. = 167.0
(100.0 ARCH)

FIN. FL. = 168.0
(101.0 ARCH)

HOOD
RAMP (N.I.C.)

5' WALK (N.I.C.)

ASPHALT RAMP

SEE NOTE 4

SEE NOTE 4

MATCH EXISTING
GRADE

RELOCATE EXISTING A-7.5 INLET (STATE SPEC.)
TO EAST EDGE OF CURB RETURN
REVENUE IN FIELD BY CITY OF NICHITA (ENGINEERING DEPT.)

NOTES:

1. ROUGH GRADE ONLY IN BLDG. AREA. FINISH GRADING, TOPSOIL AND LANDSCAPING ARE (N.I.C.)
2. PROVIDE 6" MIN TOPSOIL IN AREAS DESIGNATED AS PLANTING AREAS. SEEDING OR LANDSCAPING IS (N.I.C.)
3. PROVIDE TOPSOIL AND SEEDING IN AREA OF TOWNE EAST ADJACENT TO ENTRANCE
4. ISLANDS WITHIN PARKING AREAS TO BE GRADED TO WITHIN 2" BELOW TOP CURB ELEVATION. LANDSCAPING WITHIN THESE AREAS IS (N.I.C.)

LEGEND:

- 167.2 EXISTING SPOT ELEV
- 168.0 NEW SPOT ELEV
- 166 EXISTING CONTOUR
- 166 NEW CONTOUR

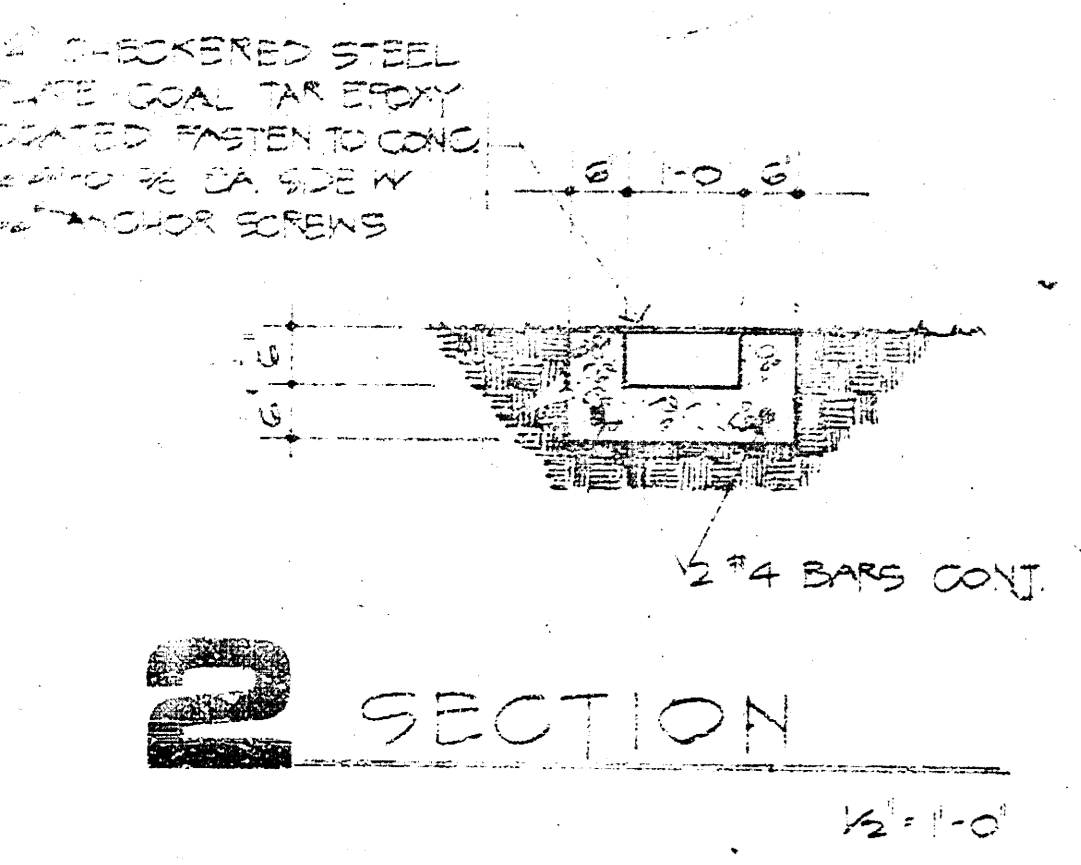
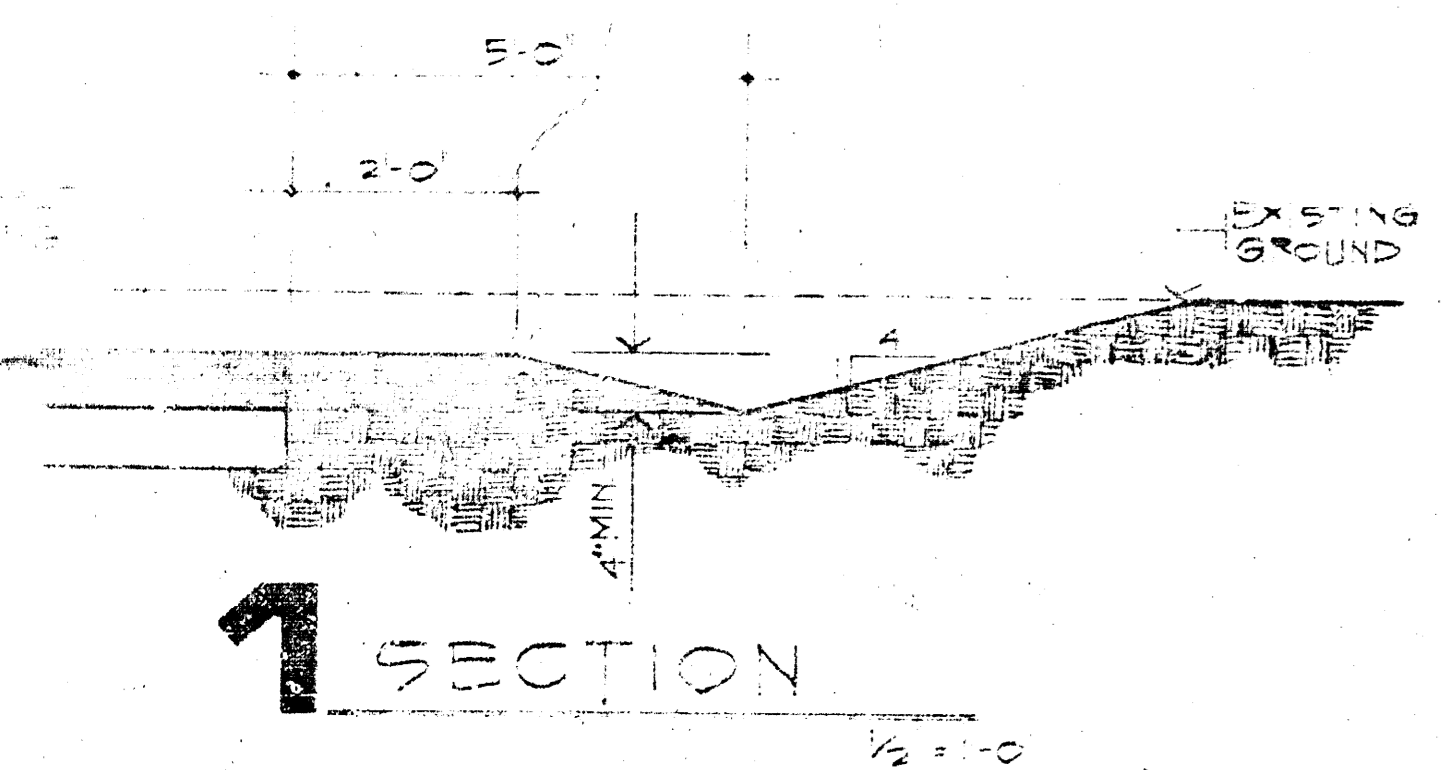

DATE	BY	REVISION
2/15/16	FOR OWNER FINAL APPR.	
2/15/16	FOR OWNER FINAL APPR.	
2/15/16	FOR BIDDING	

FOR CONSTRUCTION

DATE	REVISION
3-15-16	BIDD. GRADE

DRAWN	CHECKED
R.P.F.	B.L.K.H.

RELATED DRAWINGS	
SHEET	
DETAILS	
PROFILES	
PLAN	
SECTION	
AS BUILT	