

PLAN REF.  
CHECKED

Note:  
Field Engineer to Establish Grade  
of New 12" RCP to Insure Drainage  
of Catch Basin.  
Sand Fill or Flush all Excavation

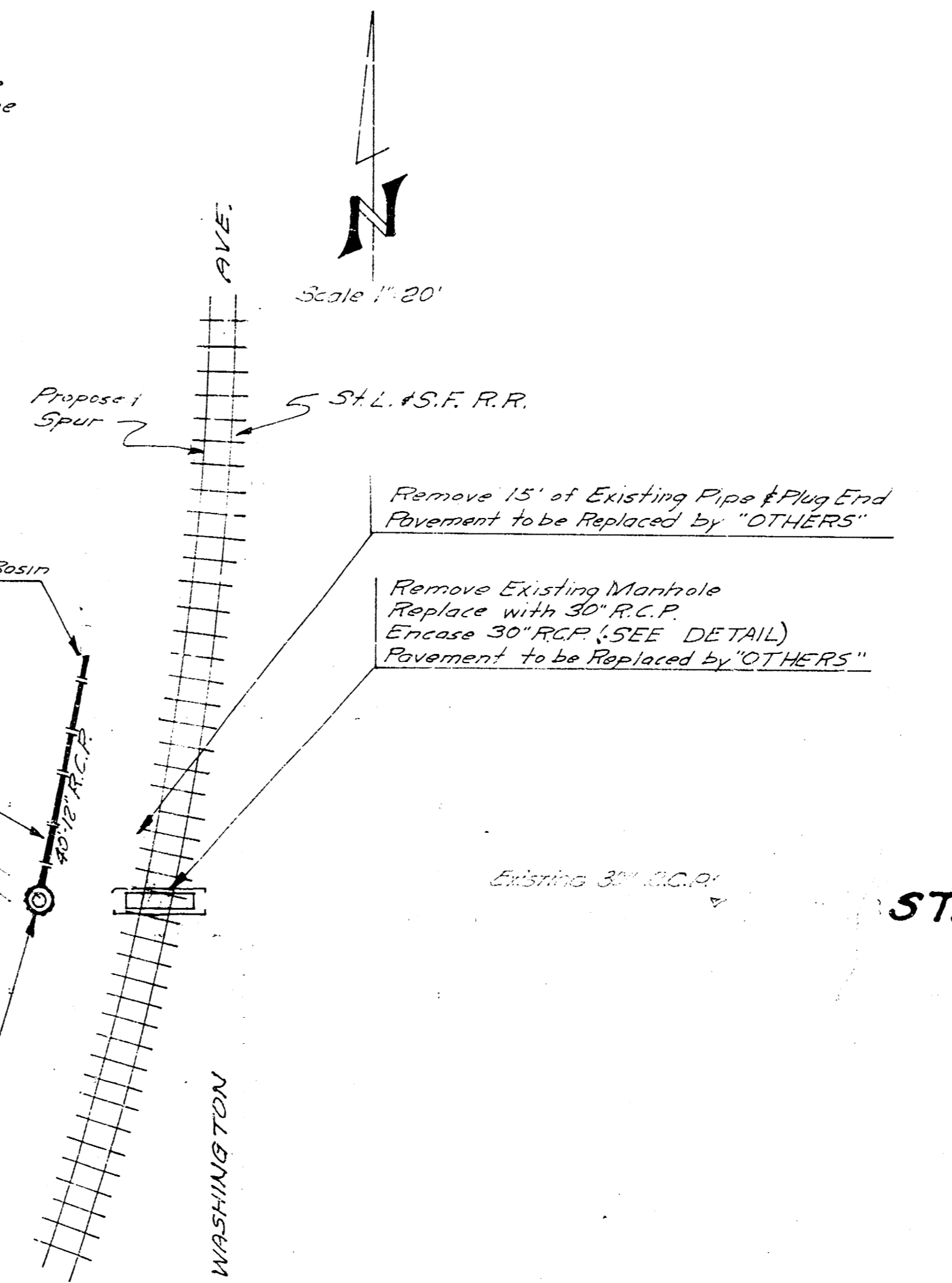

**\* BILL OF MATERIALS \***

Quant.	Unit	Item
40	L.F.	12" Reinforced Conc. Pipe
16	L.F.	30" " "
1	ea.	Type "B" Std. M.H.
130	L.F.	Saw Joint
2	ea.	Pipe Plugs
	S.Y.	Pavement Remove
	C.Y.	6 in. Conc. Encasement

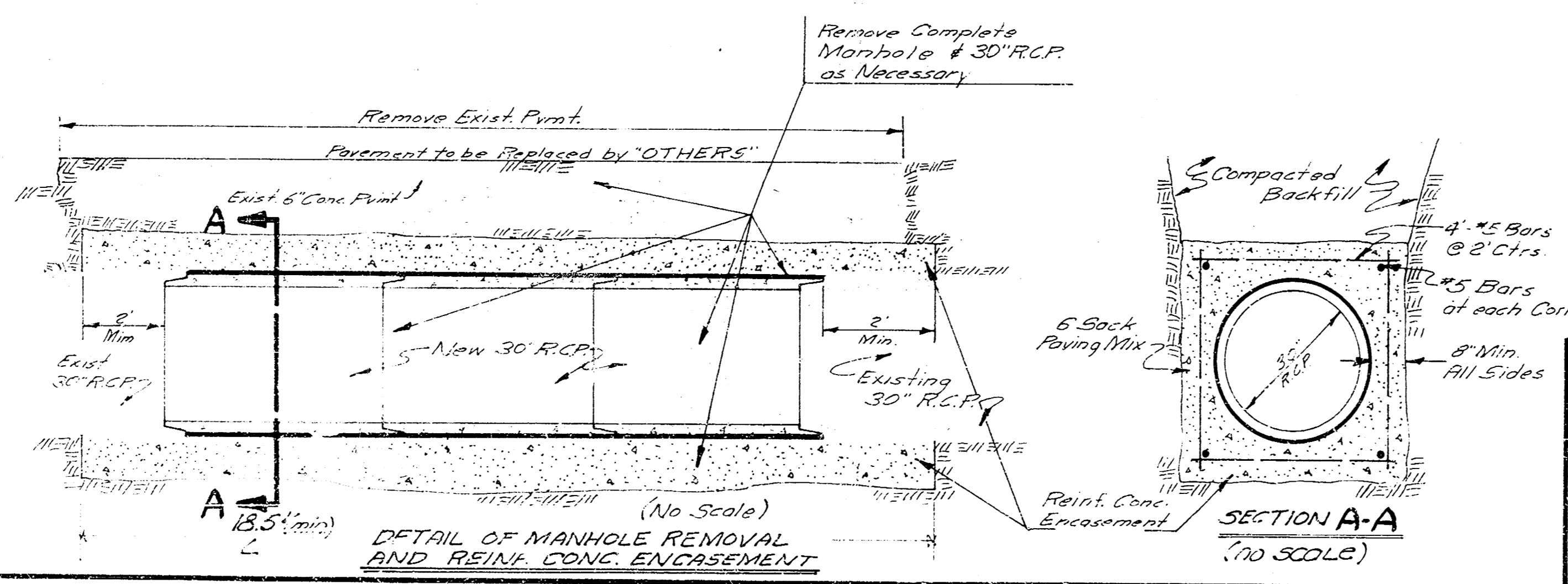

**MANHOLE RELOCATION**  
IN CONNECTION WITH  
PROPOSED SPUR OF  
S.L. & S.F. R.R.  
16<sup>TH</sup> ST. & WASHINGTON AVE.  
CITY OF WICHITA, KANS.  
DATE OCT. 67 PRIVATE JOB

C. G. F. P. Co.