

HARRY STREET

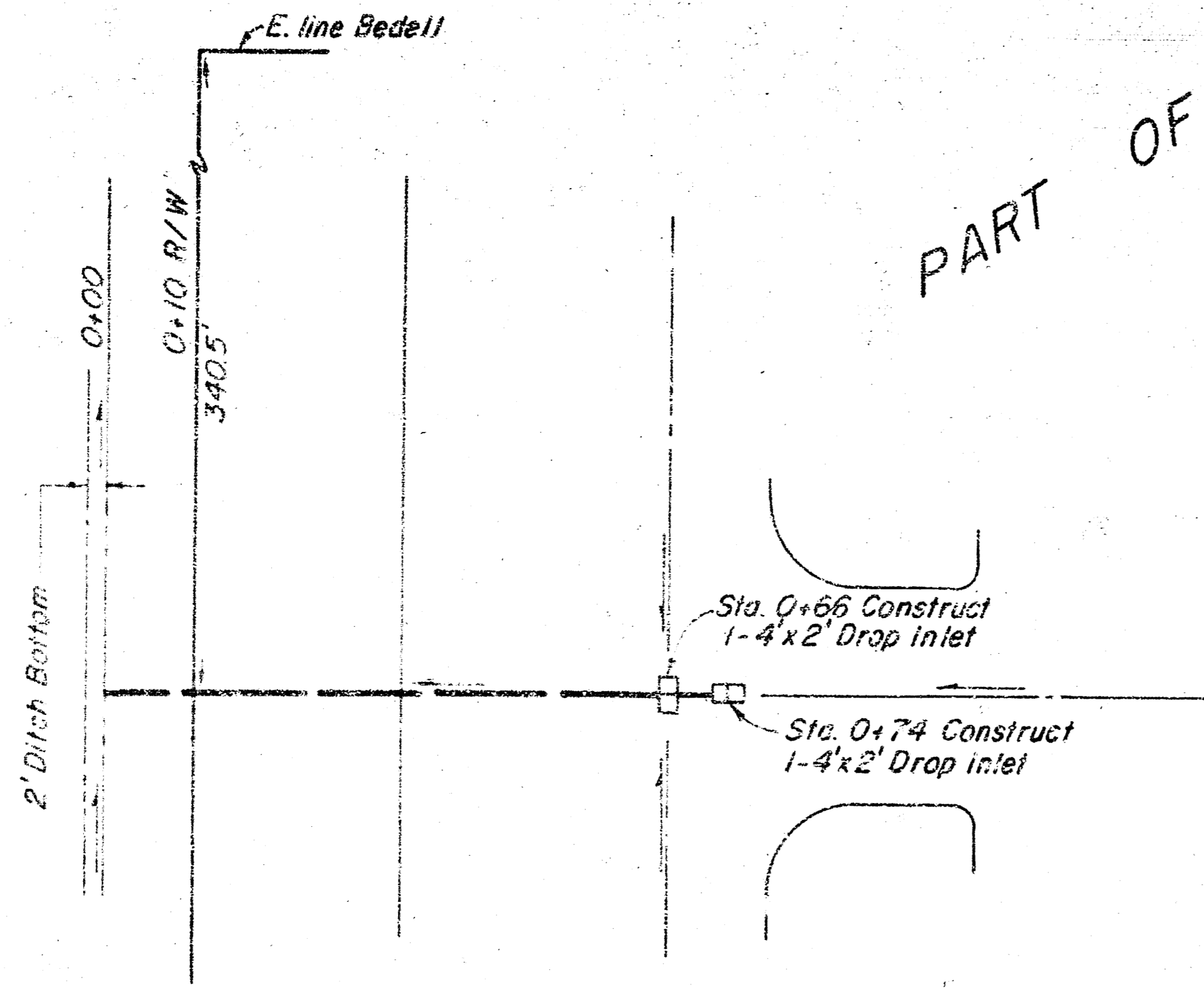

PART OF

LOT 1 BLOCK 6

QUAIL MEADOWS 2nd ADDITION

2-19-76

APPROVED BY THE BOARD OF ENGINEERS

D.E.S.

SCALE

1" = 20' Horz.
1" = 5' Vert.

Bench Mark - "a" on N.E. Corner of N. Hubbard on R.C.B.C.,
Approx. 300' E. of E. Bedell Street.
Elev. 167.95, City Datum.

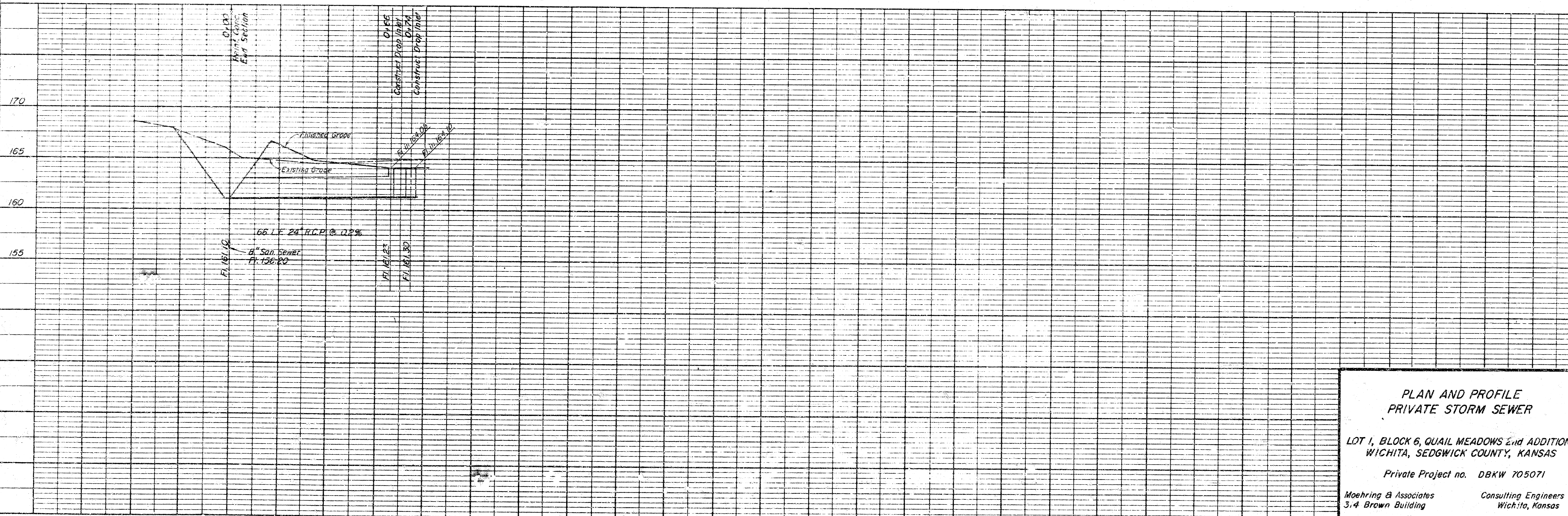

PLAN AND PROFILE
PRIVATE STORM SEWER

LOT 1, BLOCK 6, QUAIL MEADOWS 2nd ADDITION
WICHITA, SEDGWICK COUNTY, KANSAS

Private Project no. DBKW 705071

Moehring & Associates
314 Brown Building

Consulting Engineers
Wichita, Kansas