

EXCEPTION (unplatted)
 owned L.R. & LAHNA RUD
 APPROVED AS NOTED
 By CITY ENGINEER OF WICHITA
 Sanitary Sewers _____
 Storm Sewers VRH 1/25/91
 Driveway Approaches _____
 Water Mains _____
 Paving _____

NOTE TO CONTRACTOR
 INSPECTION AND TESTING FOR THIS PROJECT IS TO BE PROVIDED BY A LICENSED CONSULTING ENGINEERING FIRM UNDER CONTRACT WITH THE OWNER/DEVELOPER. SAID INSPECTION TO BE IN ACCORDANCE WITH THE CITY OF WICHITA STANDARD CONSTRUCTION ENGINEERING PRACTICES AND CERTIFIED BY A LICENSED PROFESSIONAL ENGINEER. NO WORK SHALL BE PERFORMED IN DEDICATED EASEMENTS OR PUBLIC RIGHT-OF-WAY BY THE CONTRACTOR WITHOUT SUCH INSPECTION NOR SHALL ANY WORK BE COMMENCED WITHOUT WRITTEN AUTHORIZATION BY THE CITY ENGINEER.

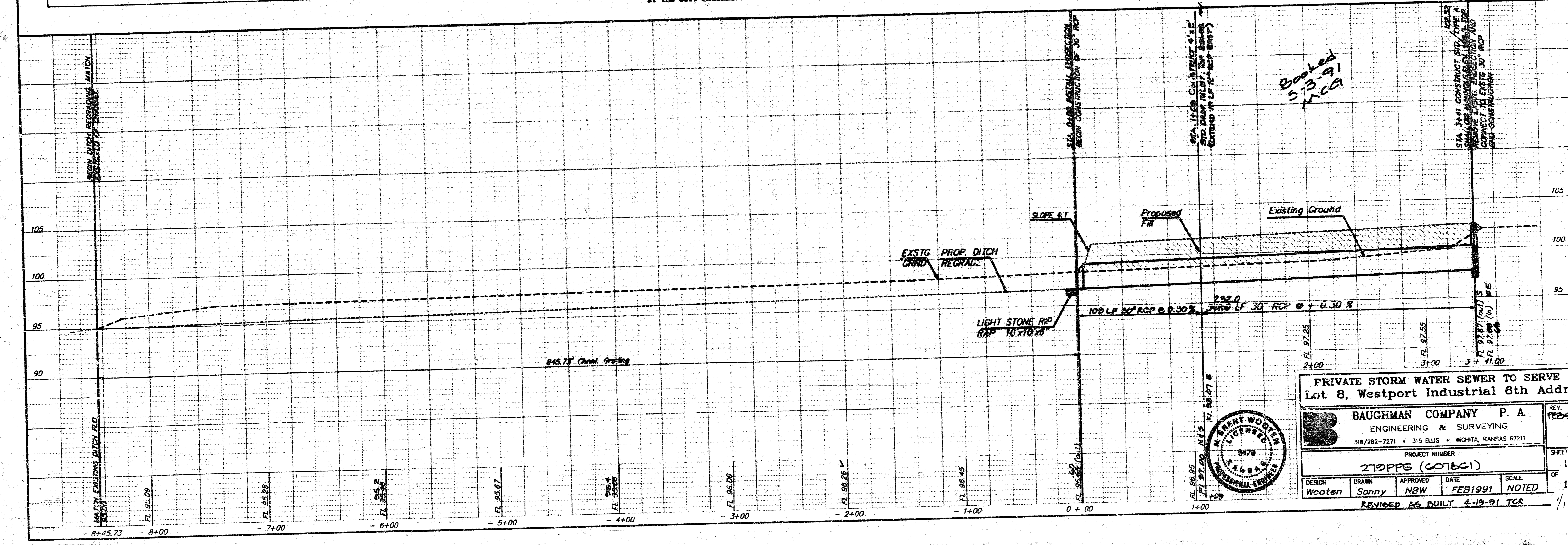

PRIVATE STORM WATER SEWER TO SERVE
 Lot 8, Westport Industrial 8th Addn.

BAUGHMAN COMPANY P. A.
 ENGINEERING & SURVEYING
 316/282-7271 • 315 ELLIS • WICHITA, KANSAS 67211

PROJECT NUMBER
270PPS (GOTBC1)

DESIGN: Wooten
 DRAWN: Sonny
 APPROVED: NBW
 DATE: FEB 1991
 SCALE: NOTED

REV. FEB 91
 SHEET 1 OF 1
 Revised As BUILT 4-19-91 TCR

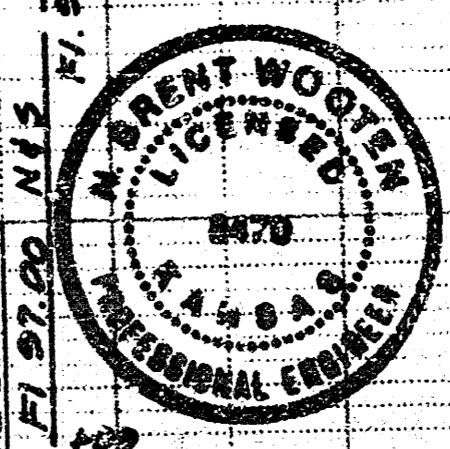

FILMED FROM THE BEST AVAILABLE COPY